



Vifa-Speak A/s
DK-6920 Videbæk
Denmark

Fabrikation af kvalitetshøjttalere
Production of Quality Loudspeakers

6½" WOOFER

SPECIAL FEATURES:

- MAGNESIUM BASKET
- MINERAL FILLED POLYCONE
- HIGH DAMPING RUBBER SURROUND
- VERY SMOOTH FREQUENCY RESPONSE
- IDEAL FOR BASS REFLEX

NOMINAL IMPEDANCE	8 Ω
VOICE COIL RESISTANCE	5.8 Ω
NOMINAL POWER (IEC 268-5)	40 W ¹⁾
SHORT TERM MAX. POWER (IEC 268-5)	350 W ²⁾
LONG TERM MAX. POWER (IEC 268-5)	150 W ³⁾
MUSIC POWER (DIN 45500)	120 W
OPERATING POWER	6.3 W
SENSITIVITY (1W, 1m)/(2.83V, 1m)	88/88 dB
FREQUENCY RANGE	37-5000 Hz
FREE AIR RESONANCE	37 Hz
VOICE COIL DIAMETER	32 mm
VOICE COIL HEIGHT	14 mm
AIR GAP HEIGHT	6 mm
VOICE COIL INDUCTANCE	0.55 mH
EFFECTIVE CONE AREA	136 cm ²
MOVING MASS (incl. air)	14 g
MAGNET WEIGHT (14.6 oz)	415 g
FORCE FACTOR, B x L	6.5 Txm
Vas	34.7 ltr
Qms	1.55
Qes	0.45
Qts	0.35

P17WJ-00-08

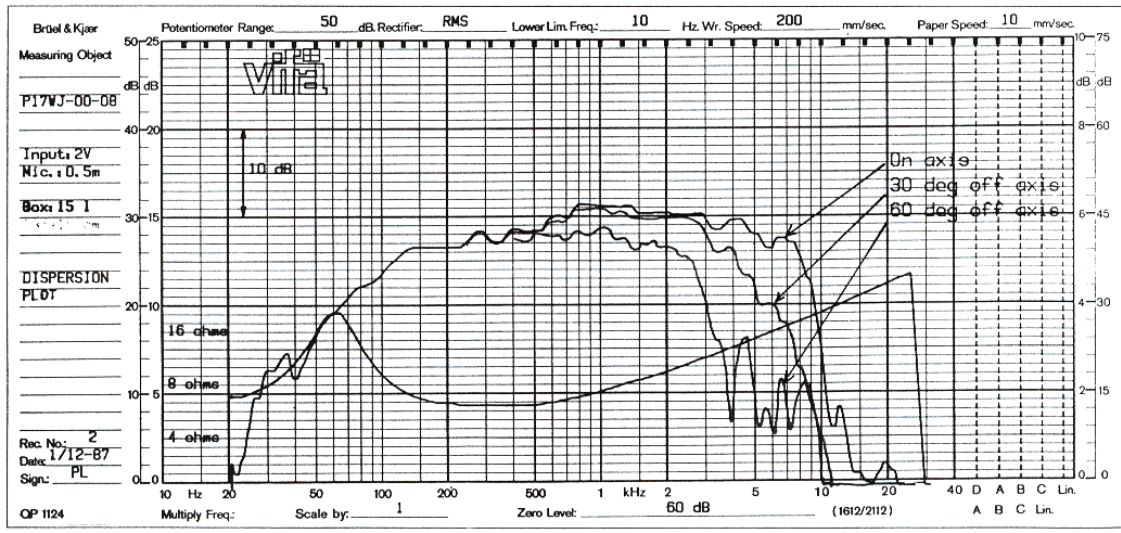
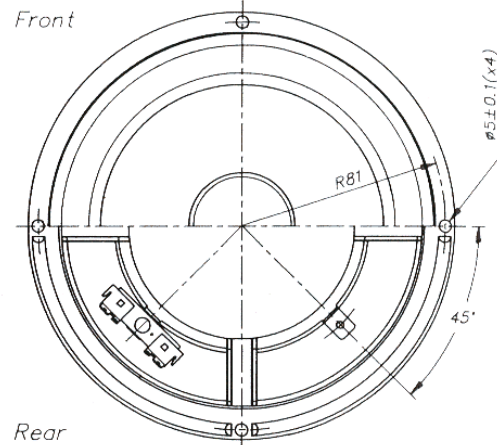
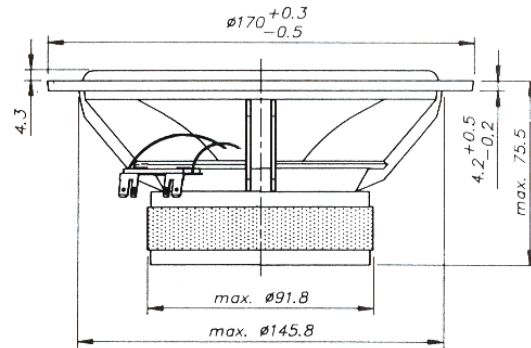

P17WJ-00-08

Applications

BASS REFLEX SYNTHESIS

	Vb [litre]	Fb [Hz]	Dp [cm]	Lp [cm]
1 —	10	50	5,0	13,8
2 ---	15	50	5,0	8,3
3 - -	22	48	5,0	5,4
4 - - -	30	45	5,0	4,0

Vb: Box Volume
Fb: Tuning Frequency
Dp: Port Diameter
Lp: Port Length

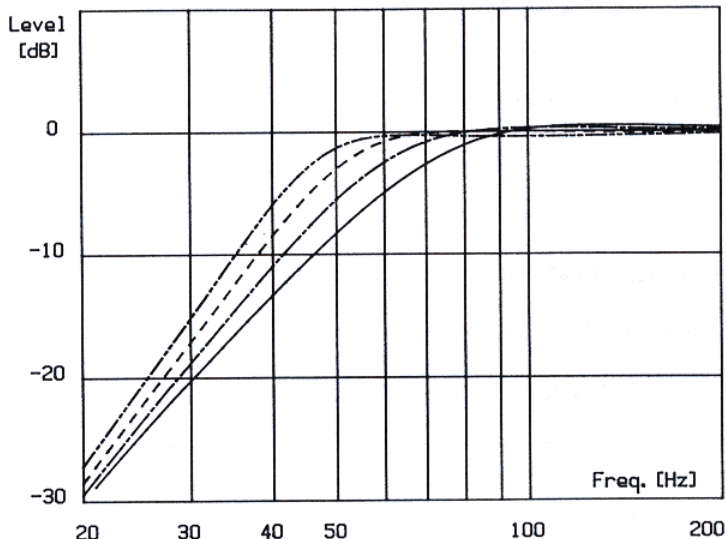

The P17WJ-00-08 is intended for bass reflex enclosures of 10-30 litre. A response having a moderate peak is obtainable in the same volume by choosing a higher tuning frequency Fb while a lower Fb gives a damped response.

Note 1-3) Power test conditions: Amb. temp. $21 \pm 3^\circ\text{C}$, 30 litre, vented box. Note 1) 100 hours continuous.
Note 2) Signal 1 sec., pause 1 min., repeated 60 times. Note 3) Signal 1 min., pause 2 min., repeated 10 times.

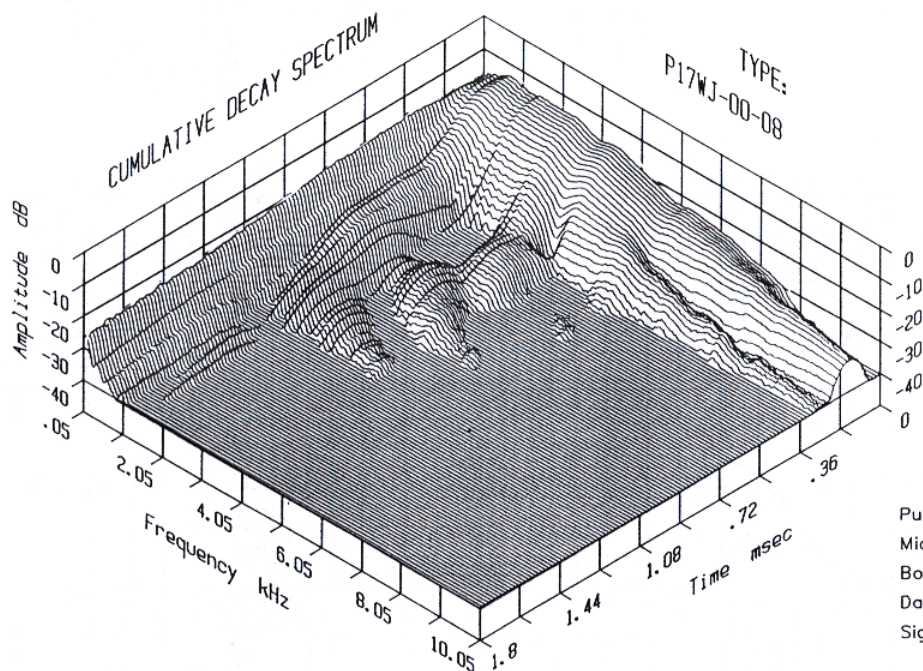

Pulse: 10V/25 μ S
Mic.: 0.15 m
Box: 15 l
Date: 02.12.87
Sign.: PL

Stationsvej 5 • Postbox 39 • DK-6920 Videbæk • Tlf. 97 17 17 22 • Int. tel.: +45 97 17 17 22 • Telefax: +45 97 17 16 96
Postgiro 9 03 79 50 • Akts. reg.nr.: 209648 • Bank: A/S Ringkjøbing Bank, Videbæk afd. • SWIFT address RIBA DK 22, Telex: 62442