

P-26

SERVICE MANUAL

KENWOOD

©1990-11 PRINTED IN JAPAN
B51-4256-00(T) 1941

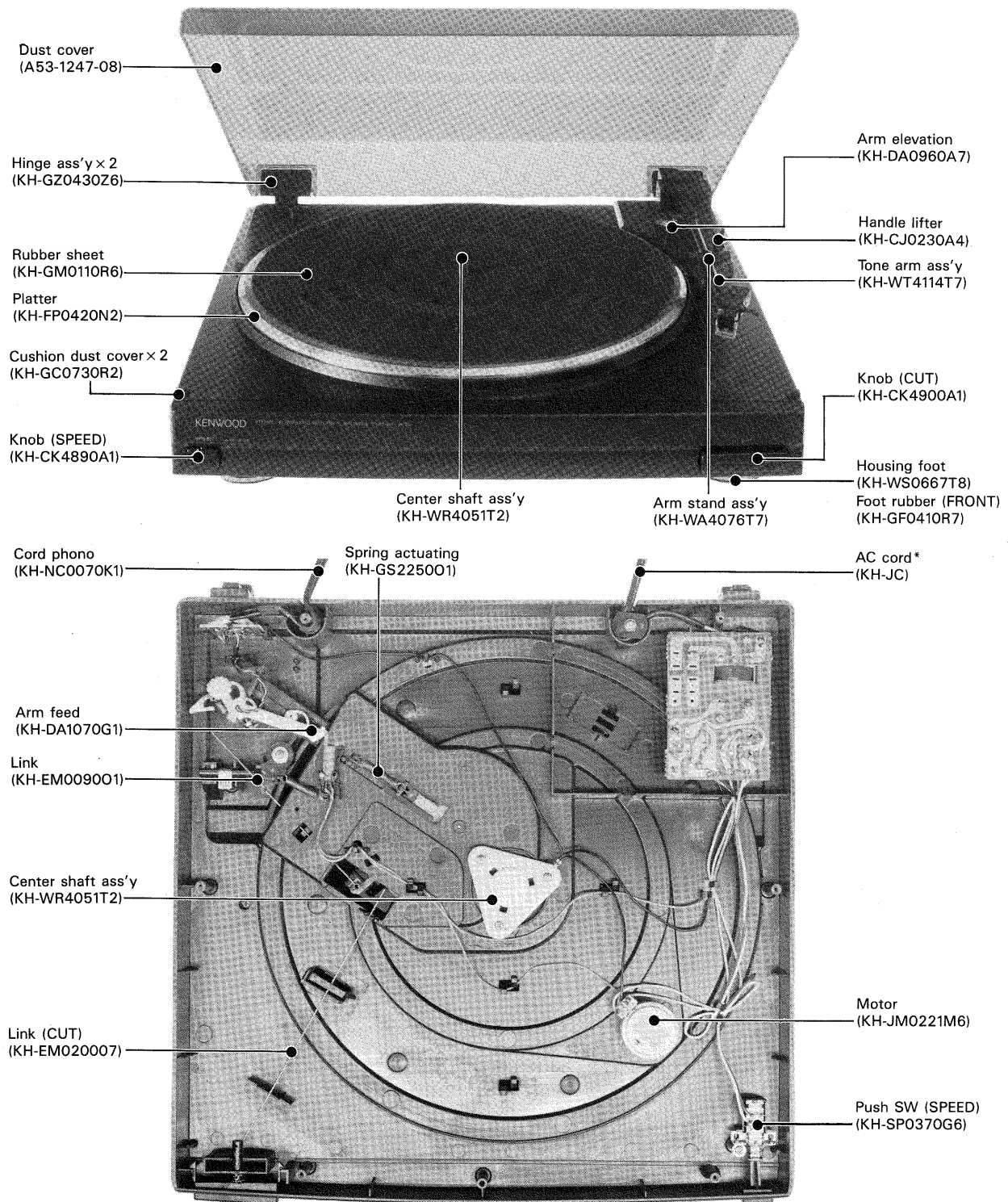

* Refer to parts list on page 9.

MECHANISM DESCRIPTION

Operation

1. Motor ON

When the tonearm is moved down on the surface of the record, the feed arm ① moves in the direction of an arrow so that SW2 turns ON to start the motor.

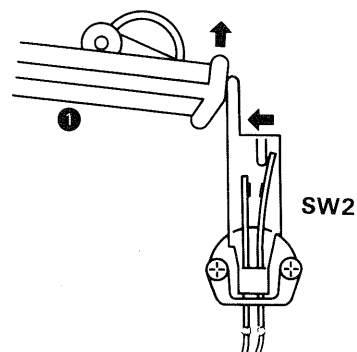

2. Tonearm return

When the tonearm arrives at the end of the record, an operation as shown on the right is performed. Thus, the gear of the center shaft is engaged with the ring gear to start counterclockwise rotation.

By the ring gear assy alone, the tonearm actuator moves in the direction of arrows to return the tonearm.

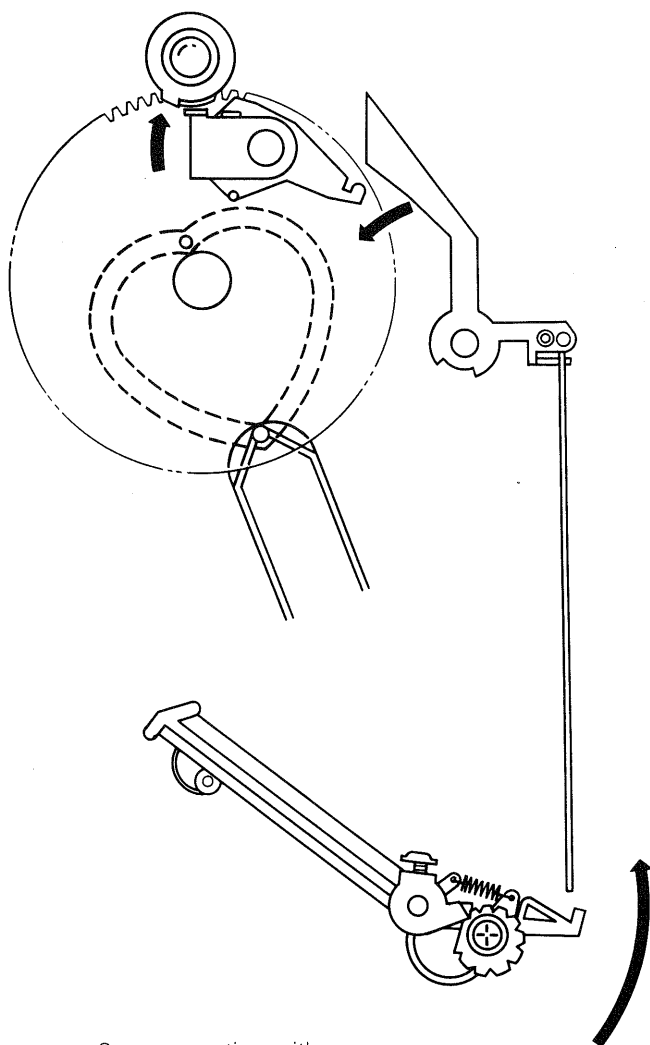

Same operation with arm

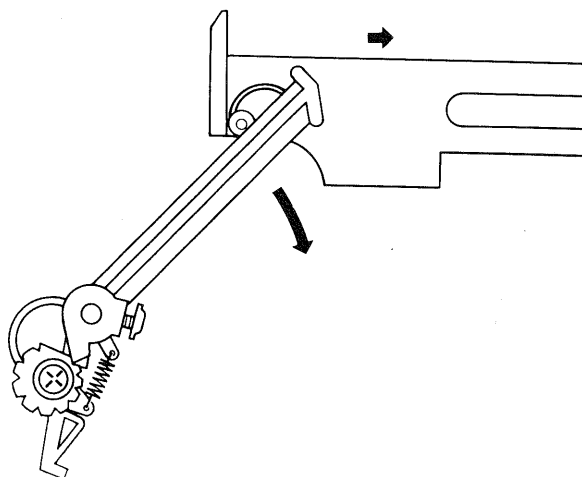

MECHANISM DESCRIPTION

3. Cueing

- For manual cueing, the lifter and the elevator work.
- For auto return, the tonearm actuator and the elevator work.

(a) Manual cueing

(b) Auto return

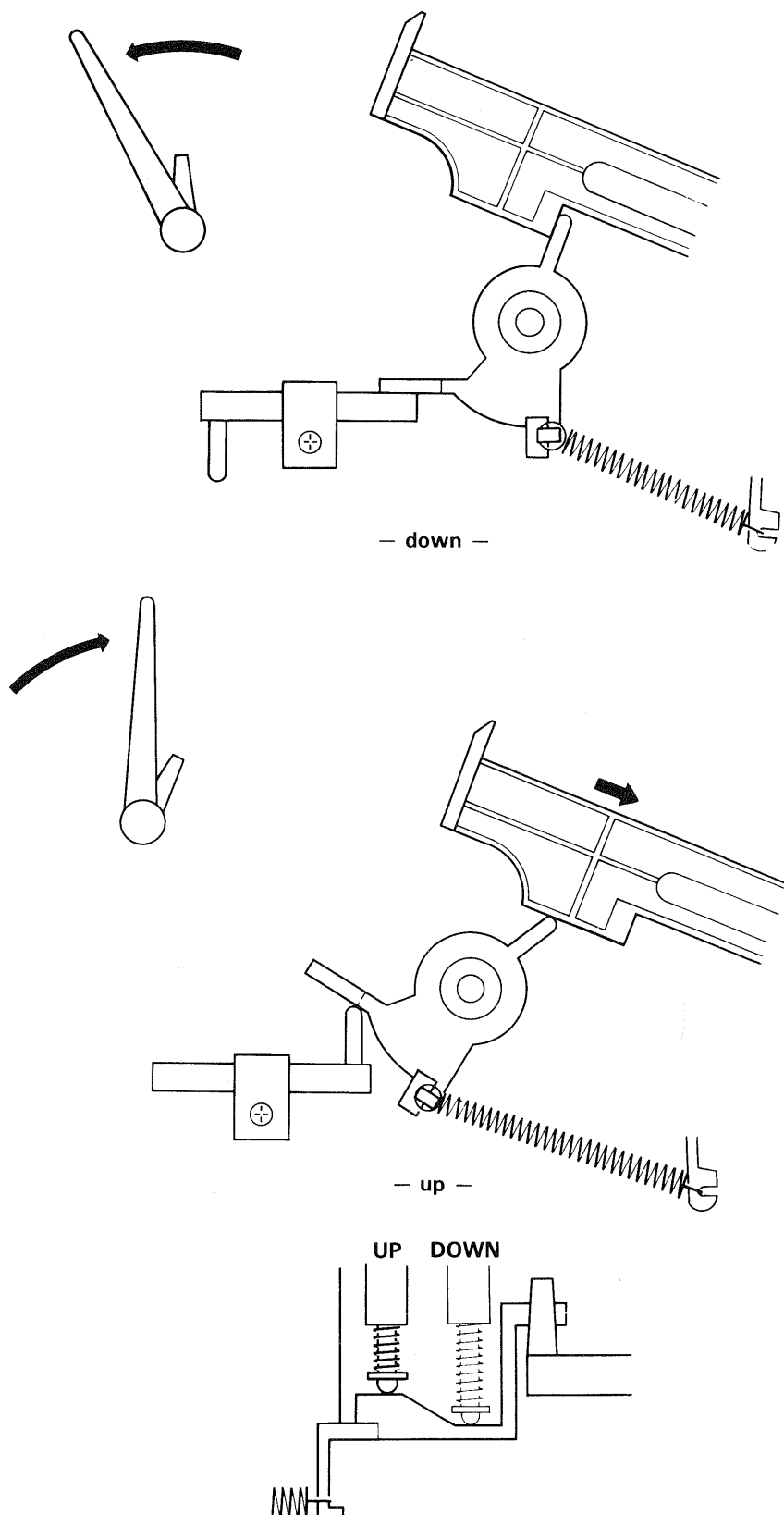

ADJUSTMENT

1. Auto-return position adjustment

For this, adjust the cam as shown on the right.

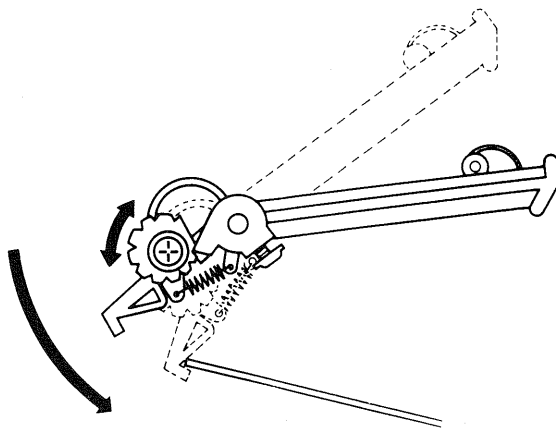

2. Speed adjustment

First, adjust the 33 RPM by VR1, then the 45 RPM by VR2.

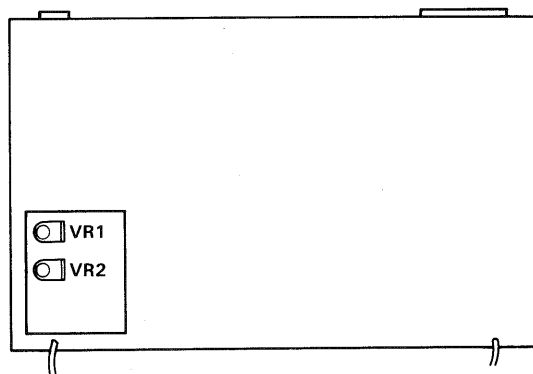

REGLAGES

1. Ajustement de la position de retour automatique

Pour ceci, ajuster la came comme indiqué sur la droite.

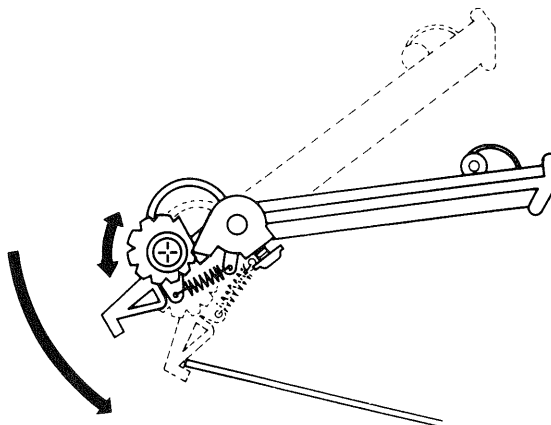

2. Ajustement de la vitesse

D'abord ajuster les 33 tours avec RV1 puis les 45 tours avec RV2.

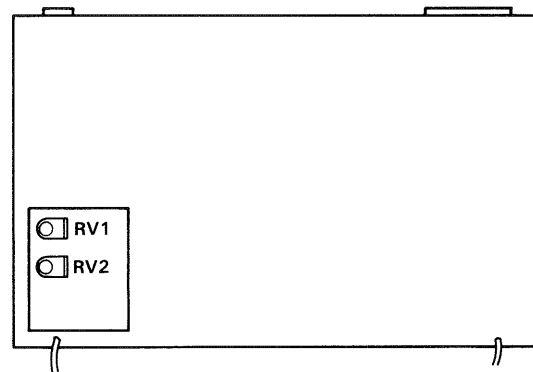

ABGLEICH

1. Einstellung der automatischen Rückkehrposition

Hierfür den Nocken wie rechts abgebildet einstellen.

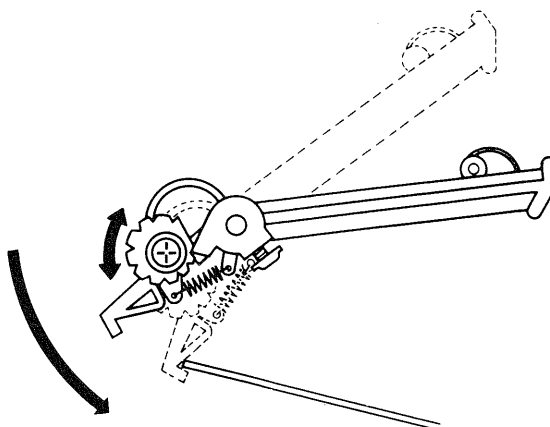

2. Drehzahl-Einstellung

Zuerst 33 Upm mit VR1 und dann 45 Upm mit VR2 einstellen.

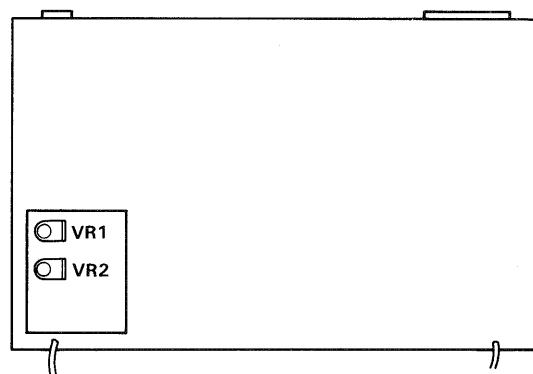

PC BOARD (Component side view)

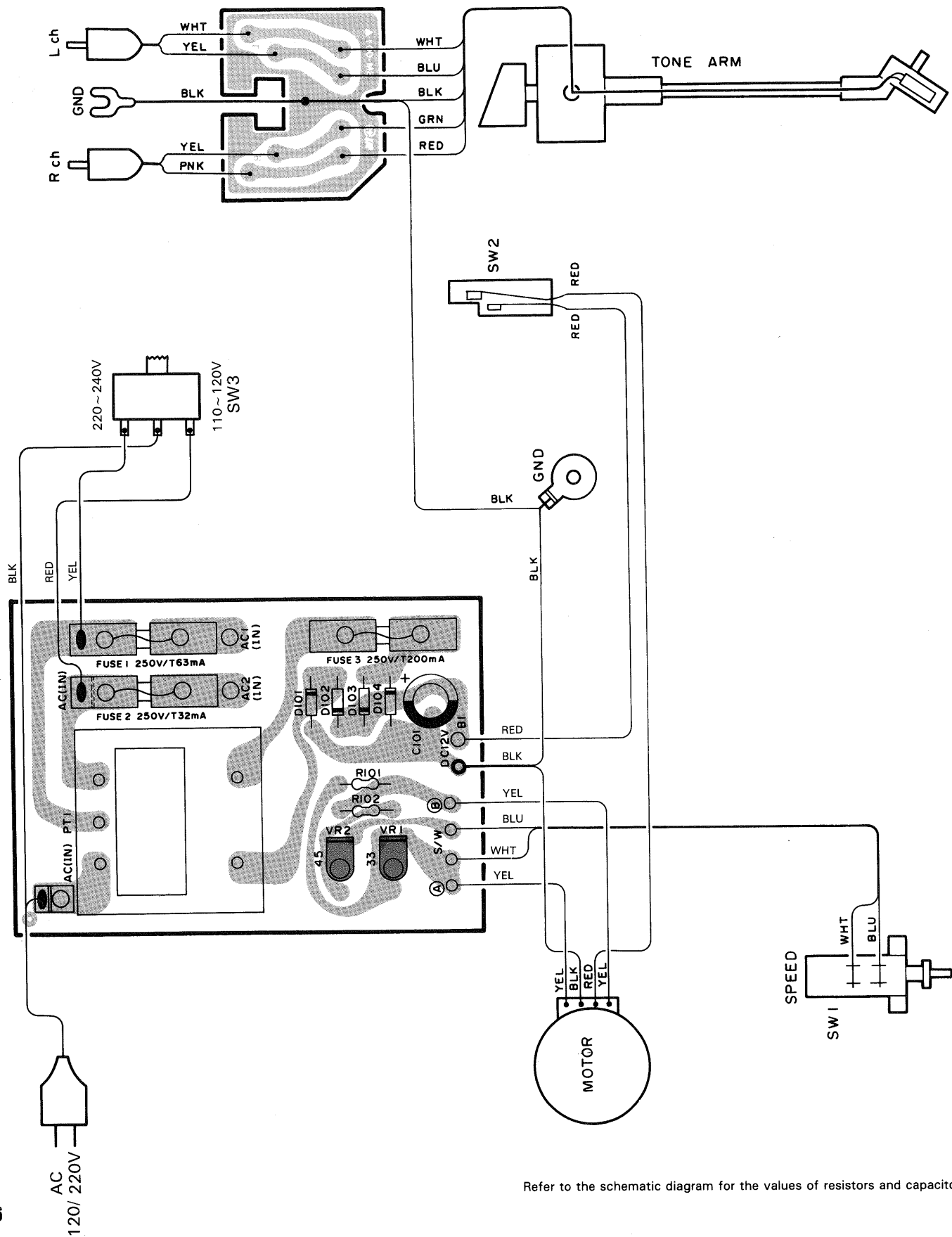

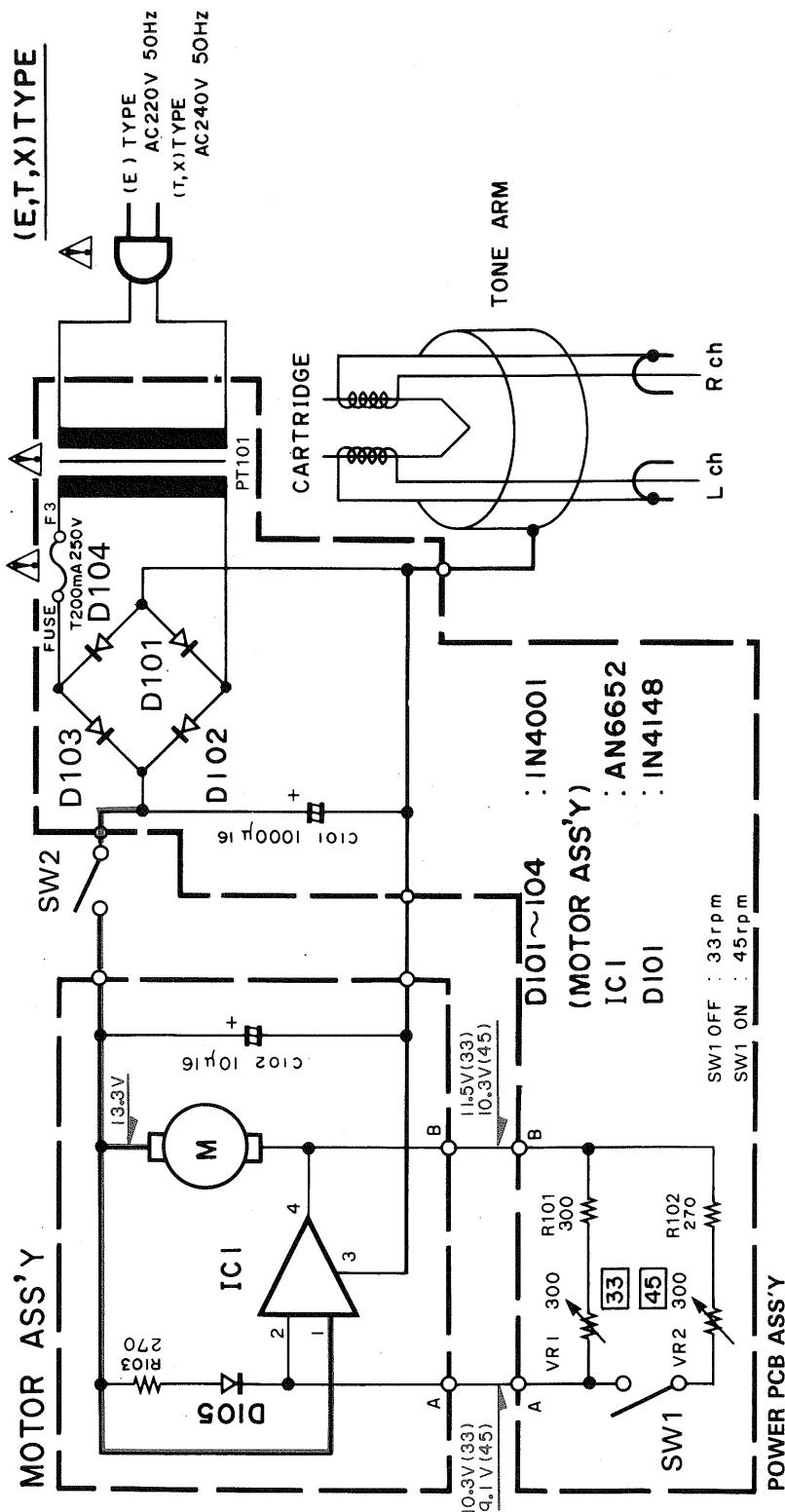

DC voltages are as measured with a high impedance voltmeter at 33-1/3 r.p.m. mode. Values may vary slightly due to variations between individual instruments or/and units.

CAUTION: For continued safety, replace safety critical components only with manufacturer's recommended parts (refer to parts list).  Indicates safety critical components. To reduce the risk of electric shock, leakage-current or resistance measurements shall be carried out (exposed parts are acceptably insulated from the supply circuit) before the appliance is returned to the customer.

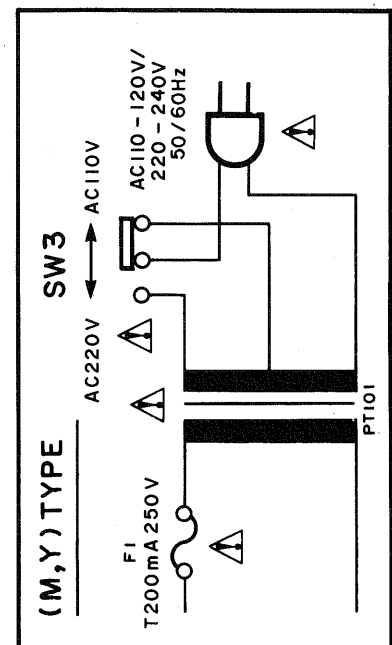

GND LINE
+B LINE

Y21-3230-20

EXPLODED VIEW

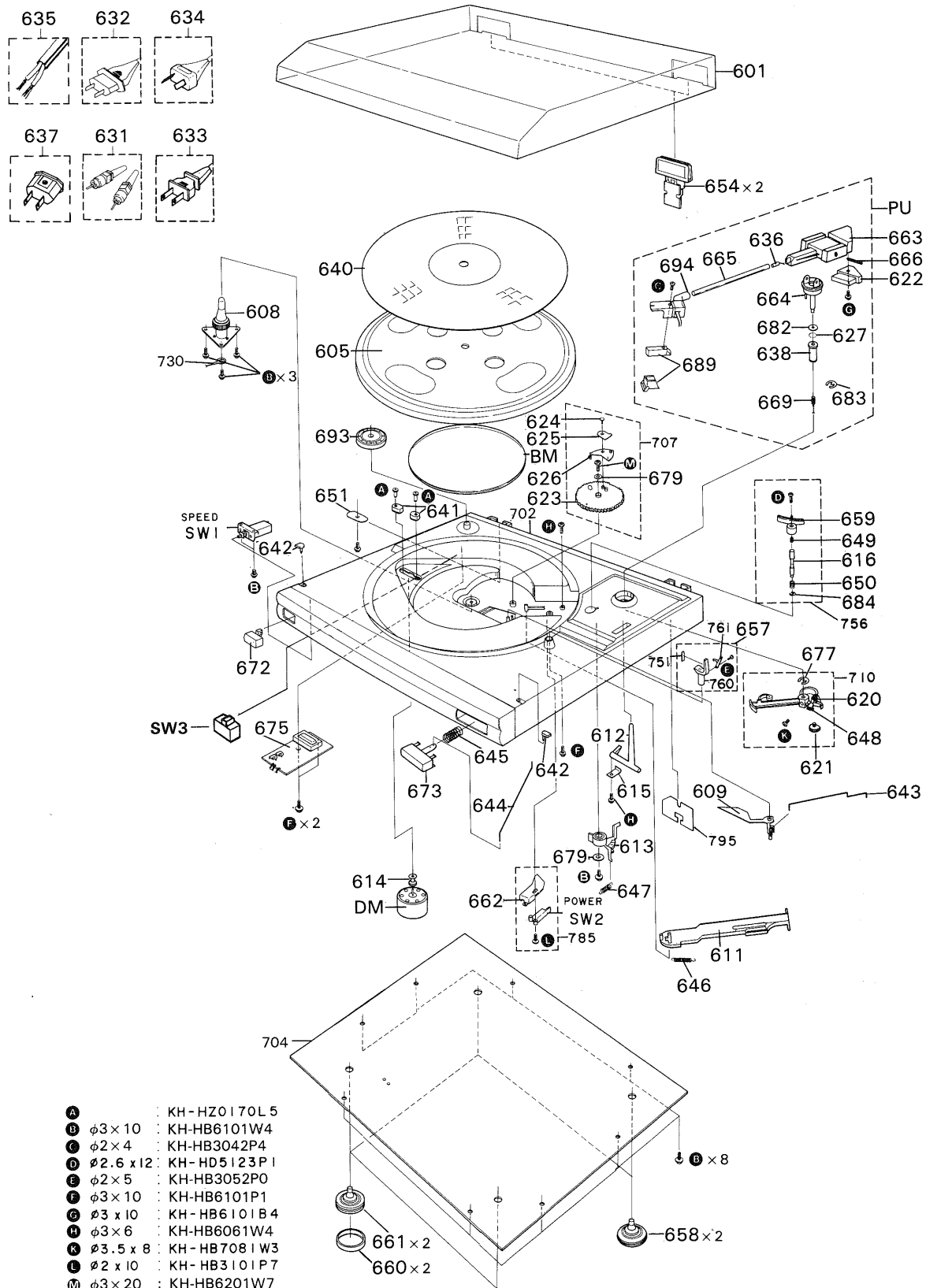

Parts with the exploded numbers larger than 700 are not supplied.

PARTS LIST

* New Parts

Parts without Parts No. are not supplied.

Les articles non mentionnés dans le Parts No. ne sont pas fournis.

Teile ohne Parts No. werden nicht geliefert.

* 新規部品

(注) 部品番号がないものは修理用部品として扱いません。

Ref. No. 参照番号	Address 位置	New Parts 新	Parts No. 部品番号	Description 部品名 / 規格	Desti- nation 仕向	Re- marks 備考
P-26						
601	1B		A53-1247-08	DUST COVER		
-			B46-0094-03	WARRANTY CARD	Y	
-			B46-0095-03	WARRANTY CARD	Y	
-		*	B46-0096-23	WARRANTY CARD	X	
-			B46-0122-13	WARRANTY CARD	E	
-			B46-0143-13	WARRANTY CARD	T	
-		*	B60-0429-08	INSTRUCTION MANUAL	M	
-		*	B60-0430-08	INSTRUCTION MANUAL	YXT	
-		*	B60-0431-08	INSTRUCTION MANUAL	E	
605	1A		KH-FP0420N2	PLATTER		
608	1A	*	KH-WR4051T2	CENTER SHAFT ASSY		
609	2B		KH-DL0420A0	LEVER REJECT		
611	3B		KH-AD0970A3	ARM ACTUATING		
612	2B		KH-CJ0230A4	HANDLE LIFTER		
613	2B		KH-DK0160G6	ELEVATOR		
614	2A		KH-DQ0120G7	PULLEY MOTOR		
615	2B		KH-ES0240M6	HOLDER LEVER		
616	2B		KH-FS1730M8	SHAFT ELEVATION		
620	2B		KH-DA1070G1	ARM FEED		
621	2B		KH-DE0050G4	CAM ADJUST		
622	1B		KH-GW0390P6	WEIGHT T/A		
623	2B	*	KH-DG0720G1	GEAR RING		
624	2B		KH-DS0400G7	LOCK CLUTCH		
625	1B		KH-EP081000	PLATE CLUTCH		
626	2B		KH-DI0270G4	GUIDE CLUTCH		
627	1B	*	KH-IZ028007EL	BALL STEEL		
BM	2B		KH-GB0110R5	BELT RUBBER		
631	1A		KH-NC0070K1	CORD PHONO		
△ 632	1A		KH-JC0066K8	AC CORD	ME	
△ 633	1A		KH-JC0038K7	AC CORD	Y	
△ 634	1A		KH-JC0114K8	AC CORD	X	
△ 635	1A		KH-JC0114K8	AC CORD	T	
636	1B		KH-ET0021M2	PLATE EARTH		
△ 637	1A		E03-0038-05	AC PLUG ADAPTOR	M	
638	1B		KH-FC0640C1	CYLINDER		
640	1A		KH-GM0110R6	RUBBER SHEET		
641	2A		KH-GC1400R3	CUSHION MOTOR		
642	2A, 2B		KH-GC0730R2	CUSHION DUST COVER		
643	2B		KH-EM009001	LINK		
644	2B	*	KH-EM020007	LINK (CUT)		
645	2A		KH-GS075002	SPRING CUT		
646	3B		KH-GS225001	SPRING ACTUATING		
647	2B		KH-GS256006	SPRING ELEVATOR		
648	2B		KH-GS251008	SPRING SENSER PCB		
649	2B		KH-GS162000	SPRING ADJUST (E/V)		
650	2B		KH-GS088002	SPRING ELEVATION		
-		*	H10-5033-08	POLYSTYRENE FOAMED FIXTURE		
-			H50-0050-08	ITEM CARTON CASE		
-			KH-BQ0010Z5	POLY BAG-ACCESSORY		
-			KH-BQ0960Z3	POLY BAG-MANUAL		

E: Scandinavia & Europe K: USA P: Canada W: Europe

Y: PX(Far East, Hawaii) T: England M: Other Areas

Y: AAFES(Europe) X: Australia

△ 印は安全部品

△ indicates safety critical components.

PARTS LIST

× New Parts

Parts without Parts No. are not supplied.

Les articles non mentionnés dans le Parts No. ne sont pas fournis.

Teile ohne Parts No. werden nicht geliefert.

× 新規部品

(注) 部品番号がないものは修理用部品として扱いません。

Ref. No. 参照番号	Address 位置	New Parts 新	Parts No. 部品番号	Description 部品名 / 規格	Desti- nation 仕 向	Re- marks 備考
-			KH-BQ1580Z8	POLY BAG-SET		
651	2A		KH-DS0410G3	STOPPER CORD		
654	1B		KH-GZ0430Z6	HINGE ASSY		
657	2B		KH-WA4076T7	ARM STAND ASSY		
658	3B		KH-GF0320R0	FOOT RUBBER(REAR)		
659	2B		KH-DA0960A7	ARM ELEVATION		
660	3B		KH-WS0667T8	HOUSING FOOT		
661	3B	*	KH-GF0410R7	FOOT RUBBER(FRONT)		
662	2B		KH-DH1220A8	HOLDER SW		
663	1B		KH-DH1380A5	HOLDER PIPE		
664	1B		KH-WA0638T0	ARM HOLDER ASSY		
665	1B		KH-GP0530A1	PIPE TONE ARM		
666	1B		KH-FS1161Q0	PIN PIVOT		
669	1B		KH-ET0040M5	RING EARTH		
PU	1B		KH-WT4114T7	TONE ARM ASSY		
672	2A	*	KH-CK4890A1	KNOB (SPEED)		
673	2A	*	KH-CK4900A1	KNOB (CUT)		
△ 675	2A		KH-MB3501N1	POWER TRANSFORMER	XT	
△ 675	2A	*	KH-MV3506N3	POWER TRANSFORMER	E	
△ 675	2A		KH-MZ3501N4	POWER TRANSFORMER	Y	
△ 675	2A		KH-MZ3506N3	POWER TRANSFORMER	M	
677	2B		KH-IA0900Q7	E-RING		
679	2B	*	KH-IZ1030L7	WASHER PLAIN (3.2X10X0.5)		
682	1B		KH-LZ0390Q6	PLATE BEARING (6X10X0.5)		
683	1B		KH-IA0400Q1	E-RING		
684	2B		KH-IA0250Q2	E-RING		
A	2A		KH-HZ0170L5	SCREW MOTOR SETTING		
B	3B		KH-HB6101W4	SCREW TAP WPH (3X10)		
C	1B		KH-HB3042P4	SCREW TAP PH (2X4)		
D	2B		KH-HD5123P1	SCREW PH (2.6X12)		
E	2B		KH-HB3052P0	SCREW TAP PH (2X5)		
F	2A	*	KH-HB6101P1	SCREW TAP WPH (3X10)		
G	1B		KH-HB6101B4	SCREW TAP PH (3X10)		
H	2B	*	KH-HB6061W4	SCREW TAP WPH (3X6)		
K	2B		KH-HB7081W3	SCREW TAP WPH (3.5X8)		
L	3B		KH-HB3101P7	SCREW TAP PH (2X10)		
M	2B	*	KH-HB6201W7	SCREW TAP PH (3X20)		
SW1	2A		KH-SP0370G6	PUSH SW (SPEED)		
SW2	2B		KH-SL0011M8	LEAF SW (POWER)		
△ SW3	2A		KH-SS0279J0	VOLTAGE SELECTOR SW	MY	
689	1B		T21-0155-05	CARTRIDGE (V-74)		
DM	2A		KH-JM0221M6	MOTOR		
693	1A		KH-D00051A7	ADAPTOR EP		
694	1B		KH-DA1160A8	HEAD SHELL		
C101			CE04KW1C102J	ELECTRO 1000UF 16WV		
-			KH-JH0010S8	FUSE CLIP		
△ F3			KH-JF1048S4	FUSE(T200mA/250V)		
VR1 ,2			KH-VH0930I6	SEMI FIXED(3000HM)33RPM,45RPM		
D101-104			1N4001	DIODE		

E: Scandinavia & Europe K: USA P: Canada W: Europe

△ 印は安全部品

Y: PX(Far East, Hawaii) T: England M: Other Areas

Y: AAFES(Europe) X: Australia

△ indicates safety critical components.

PACKING

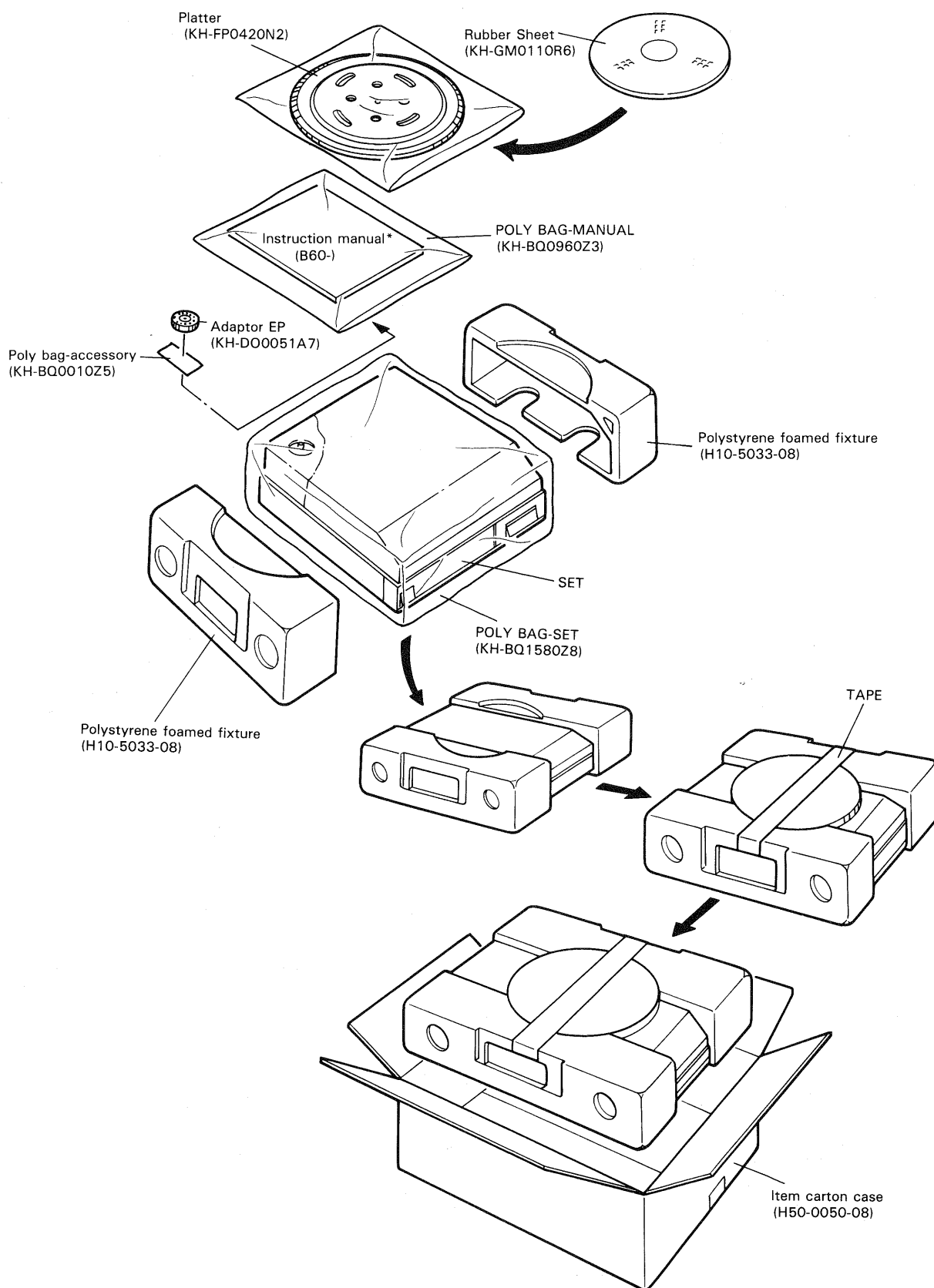

* Refer to parts list on page 9.

SPECIFICATIONS

Motor and turntable

Drive System.....Belt-Drive System
Motor.....DC Servo Motor
Turntable Platter.....29.6 cm Diameter
 0.41 kg weight
Speeds2 Speeds, 33-1/3 and
 45 rpm.
Wow & Flutter.....Less than 0.05% (WRMS)
S/N (Rumble).....DIN: 68 dB (DIN B)

Tonearm

Type.....Integrated Straight Tonearm
Effective Arm Length.....205 mm
Over-Hang.....14 mm
Tracking Error.....+ 4° 14' ~ - 1° 31'
Tracking Force.....2.5 g

Cartridge

Type.....VM type (V-74 or V-76)
Stylus.....N-74 with 0.6 mill diamond
 or N-76 with 0.6 mill diamond
Frequency Response.....20 Hz to 20,000 Hz
Output Voltage.....2.5 mV (1,000 Hz,
 5.0 cm/sec)
Load Impedance.....47 kΩ
Compliance4 × 10⁻⁶ cm/dyne

General

Power Consumption.....4 watts
Dimensions.....W: 360 mm
 H: 100 mm
 D: 350 mm
Weight (Net).....2.8 kg

KENWOOD follows a policy of continuous advancements in development. For this reason specifications may be changed without notice.

KENWOOD poursuit une politique de progrès constants en ce qui concerne le développement. Pour cette raison, les spécifications sont sujettes à modifications sans préavis.

KENWOOD strebt ständige, Verbesserungen in der Entwicklung an. Daher bleiben Änderungen der technischen Daten jederzeit vorbehalten.

Note:

Component and circuitry are subject to modification to insure best operation under differing local conditions. This manual is based on the Europe (E) standard, and provides information on regional circuit modification through use of alternate schematic diagrams, and information on regional component variations through use of parts list.

KENWOOD CORPORATION

Shionogi Shibuya Building, 17-5, 2-chome Shibuya, Shibuya-ku, Tokyo 150, Japan

KENWOOD U.S.A. CORPORATION

2201 East Dominguez Street, Long Beach, CA 90810;
 550 Clark Drive, Mount Olive, NJ 07828, U.S.A.

KENWOOD ELECTRONICS CANADA INC.

P.O. BOX 1075, 959 Gana Court, Mississauga, Ontario, Canada L4T 4C2

TRIO-KENWOOD U.K. LTD.

KENWOOD House, Dwight Road, Watford, Herts., Wd1 8eb United Kingdom

KENWOOD ELECTRONICS BENELUX N.V.

Mechelsesteenweg 418 B-1930 Zaventem, Belgium

KENWOOD ELECTRONICS DEUTSCHLAND GMBH

Rembrücker-Str. 15, 6056 Heusenstamm, West Germany

TRIO-KENWOOD FRANCE S.A.

13 Boulevard Ney, 75018 Paris, France

KENWOOD LINEAR S.p.A.

20125, MILANO-VIA ARBE, 50, ITALY

KENWOOD ELECTRONICS AUSTRALIA PTY, LTD.

P.O. BOX 504, 8 Figtree Drive, Australia Centre, Homebush N.S.W. 2140, Australia

KENWOOD & LEE ELECTRONICS, LTD.

Wang Kee Building, 4th Floor, 34-37, Connaught Road, Central, Hong Kong