

Copyright March 21 2021

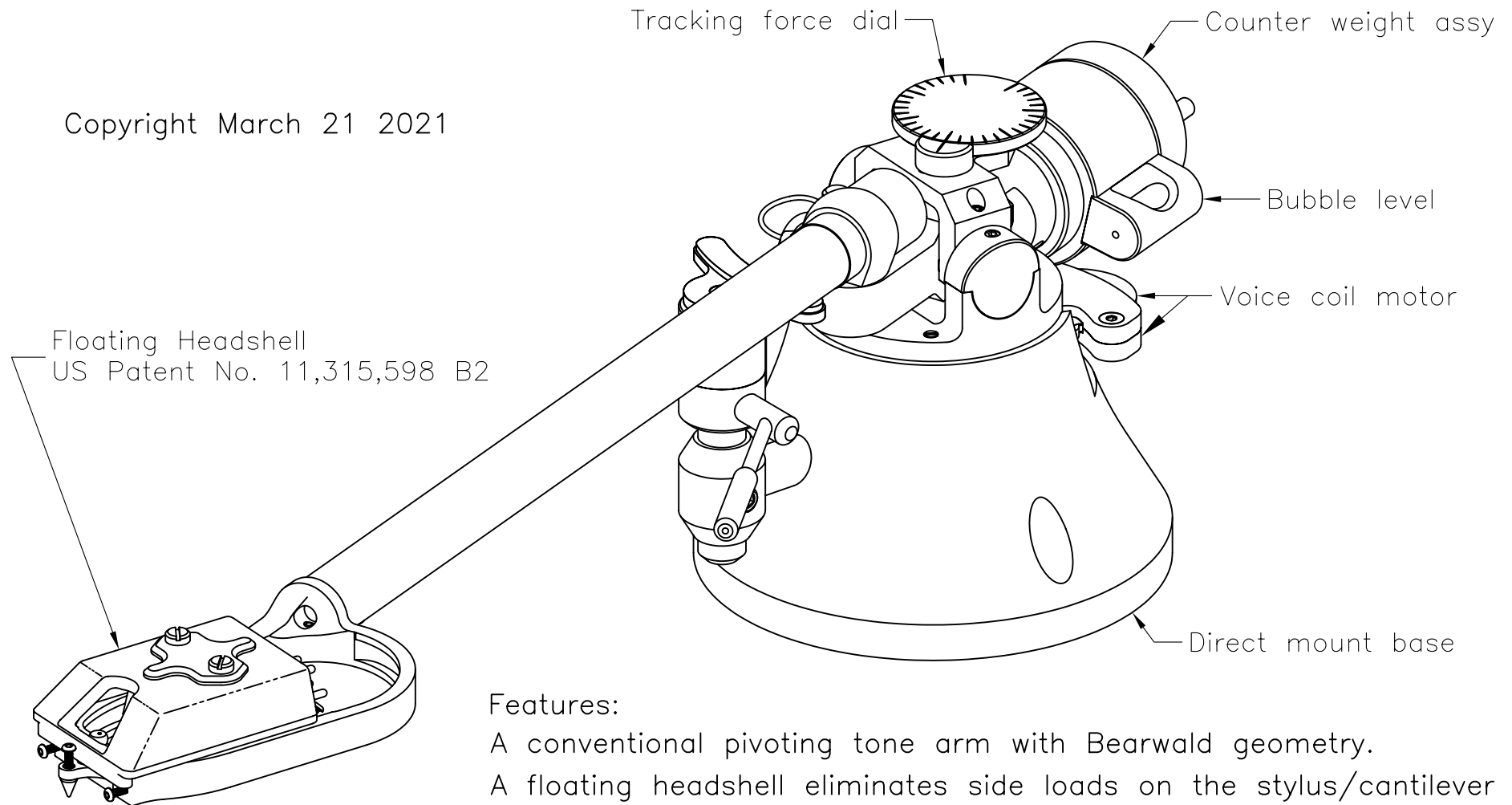

#### Features:

A conventional pivoting tone arm with Bearwald geometry.

A floating headshell eliminates side loads on the stylus/cantilever assembly.

There is no inward force acting on the headshell/cartridge and there is no possibility of skating.

Distance, Tone Arm pivot to turntable spindle is 222mm :-)

Tracking force is adjustable from zero to 3 grams.

The Tone Arm is dynamically balanced.

Bearings for rotation in the vertical plane of the Tone Arm are frictionless flexural pivots that never require lubrication and their center Line is located in the top plane of the vinyl LP.