

Solen

Tigre B50

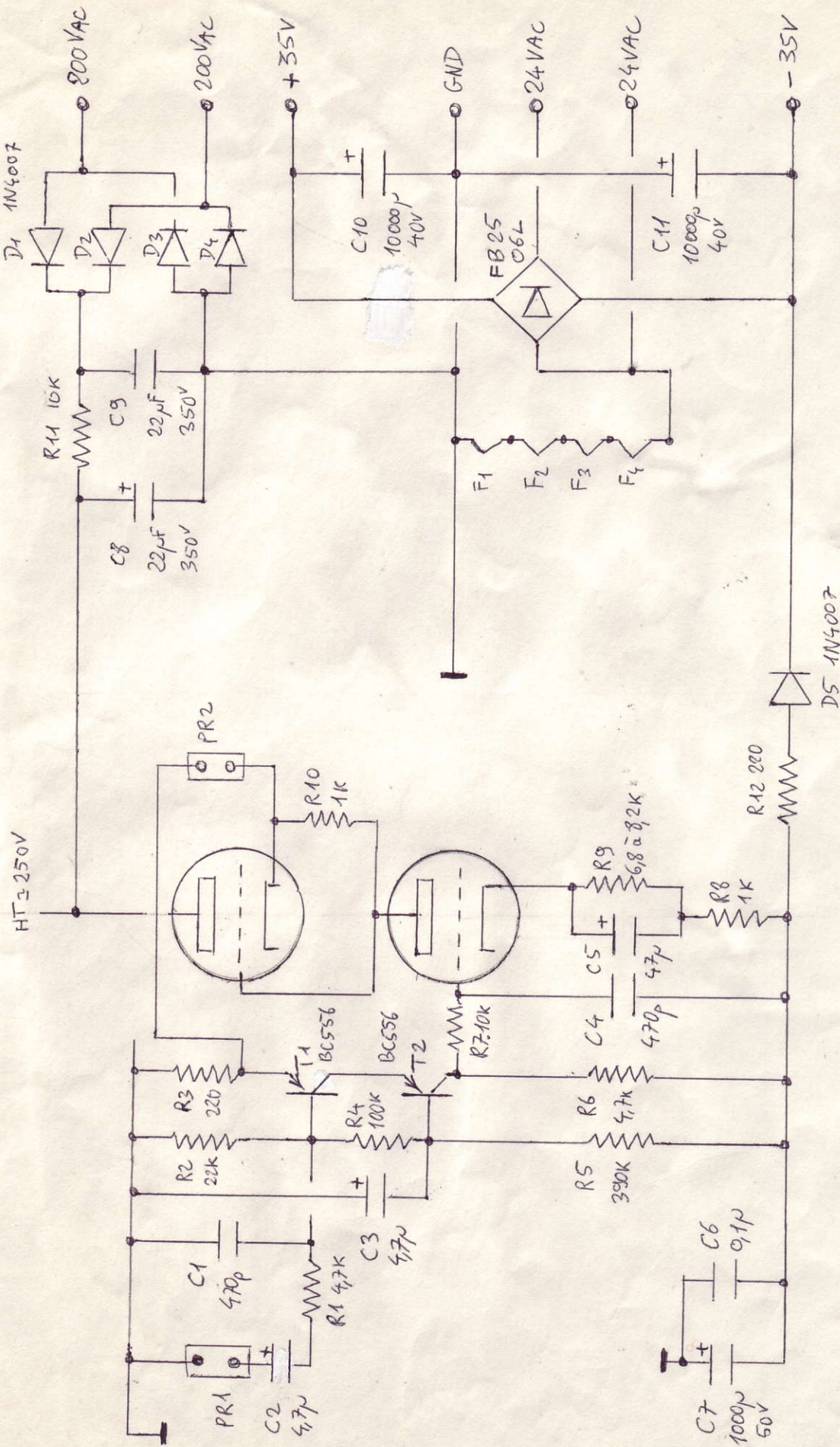

10K Ω (Multiband)
 13K Ω (RSD)
 19K Ω (RSD)
 $t_{PS} = 0.5\mu s$
 $t_{PS} = 1\mu s$
 Gain ≈ 20
 Gain ≈ 50

TIGRE PCS

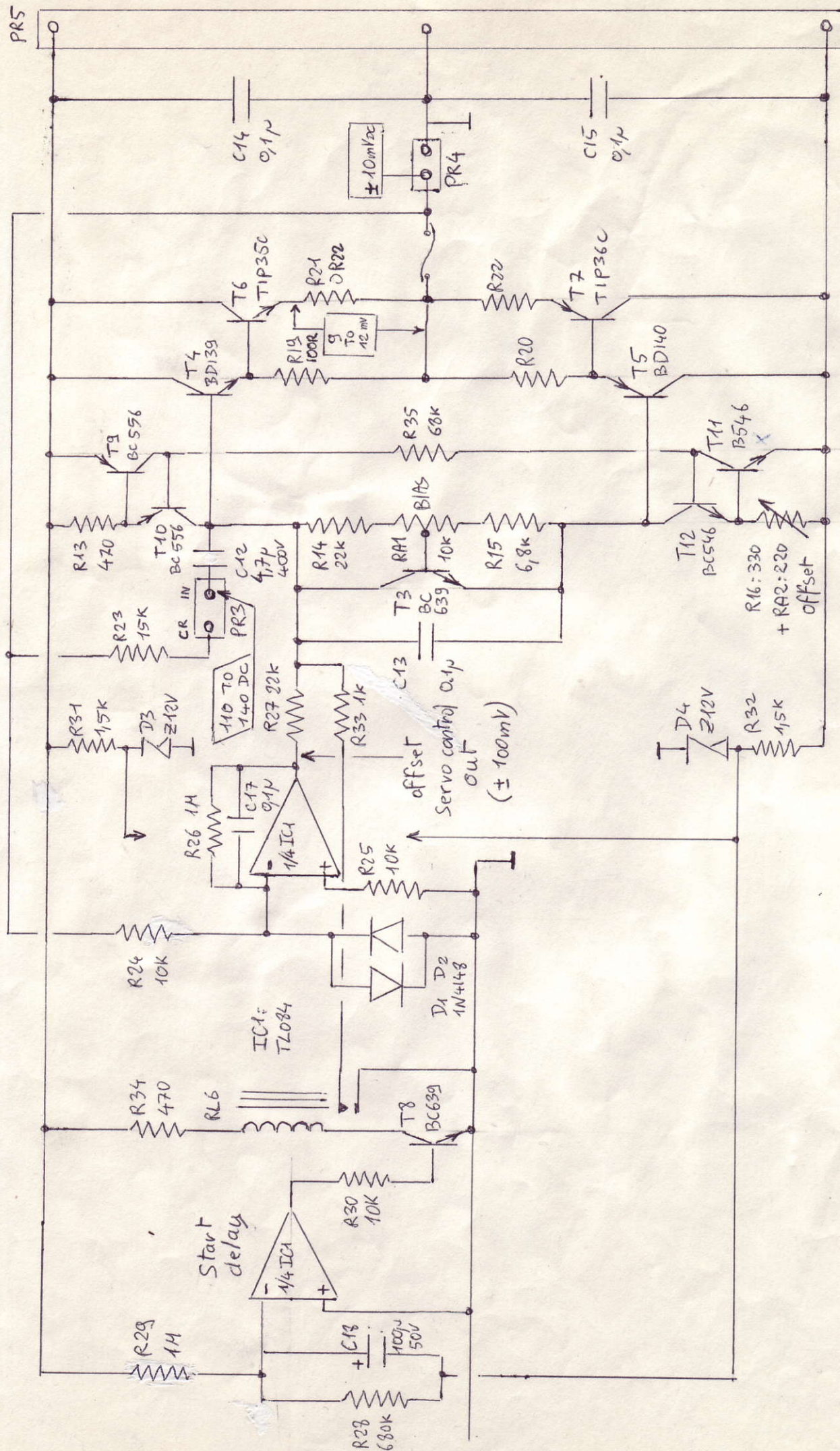

TIGRE B50 PC4

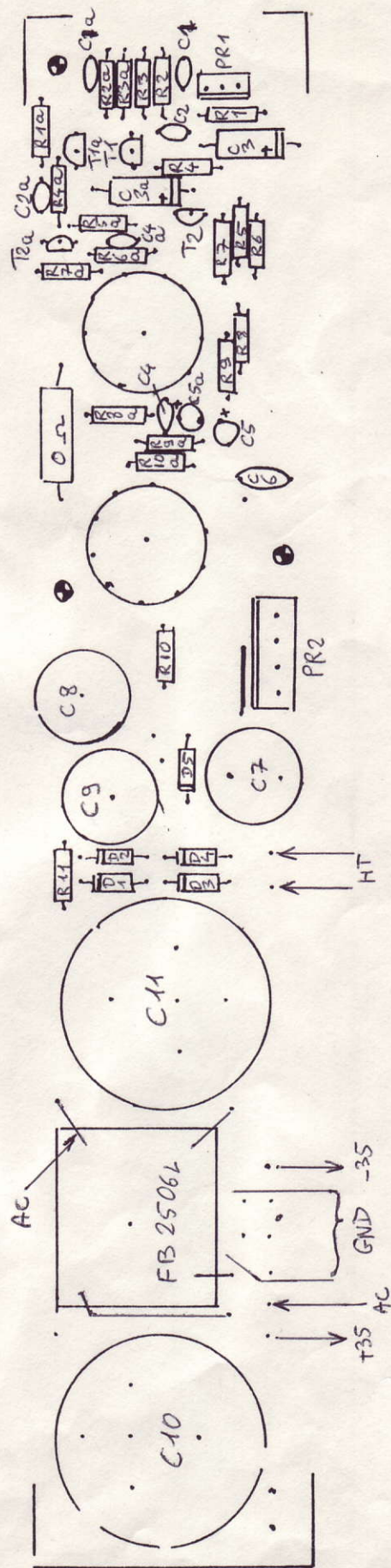
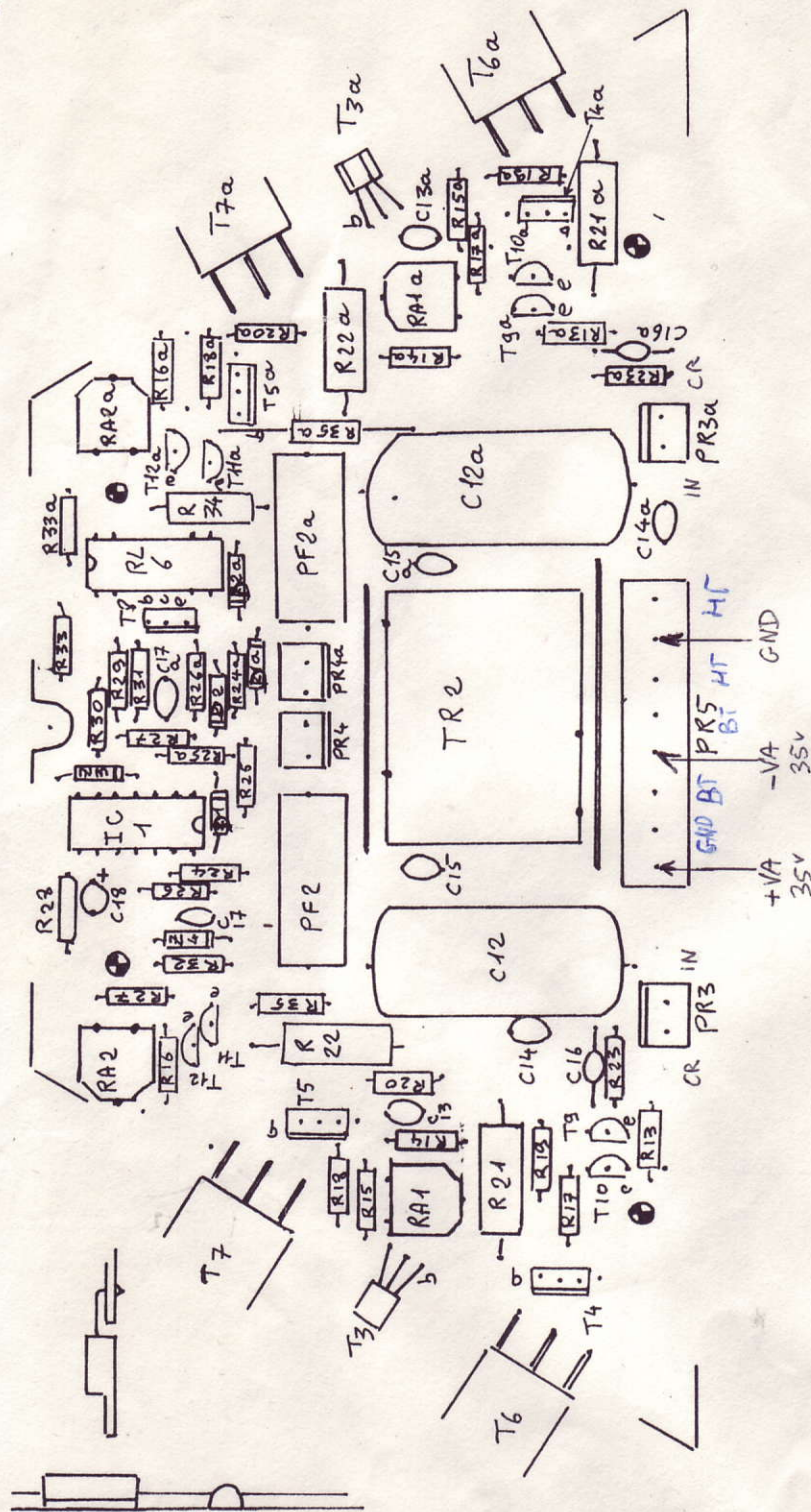

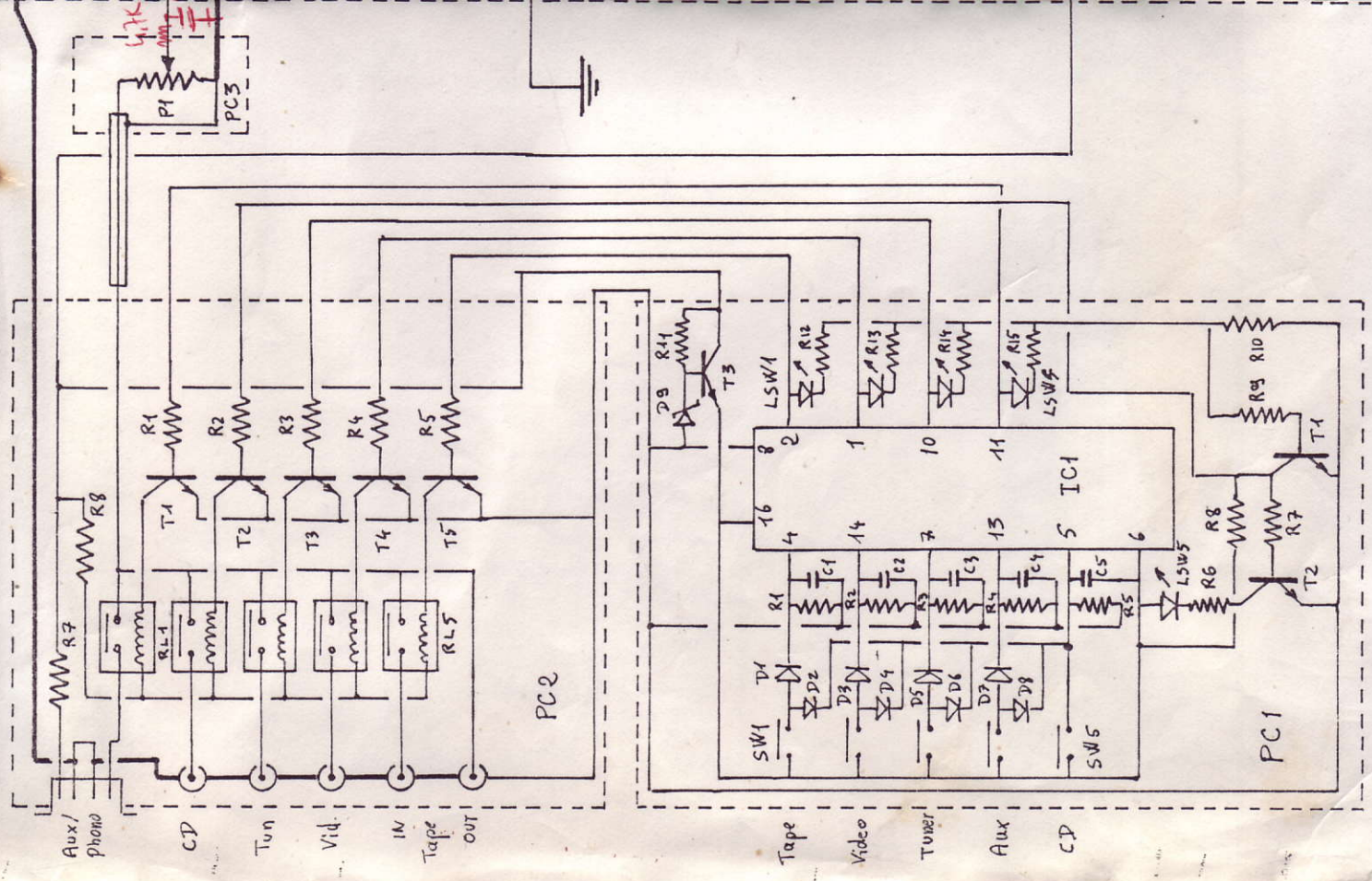

PC2T

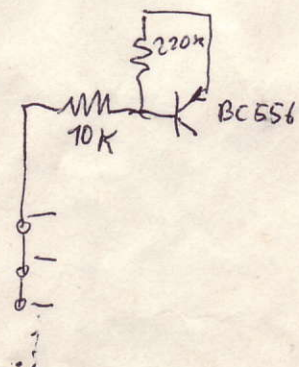
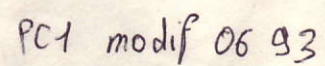
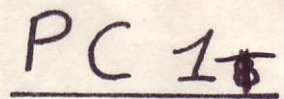

I: Taking off the cover

Solen Tiger

6 screws : - first the large one (1)
Then the small one (2)

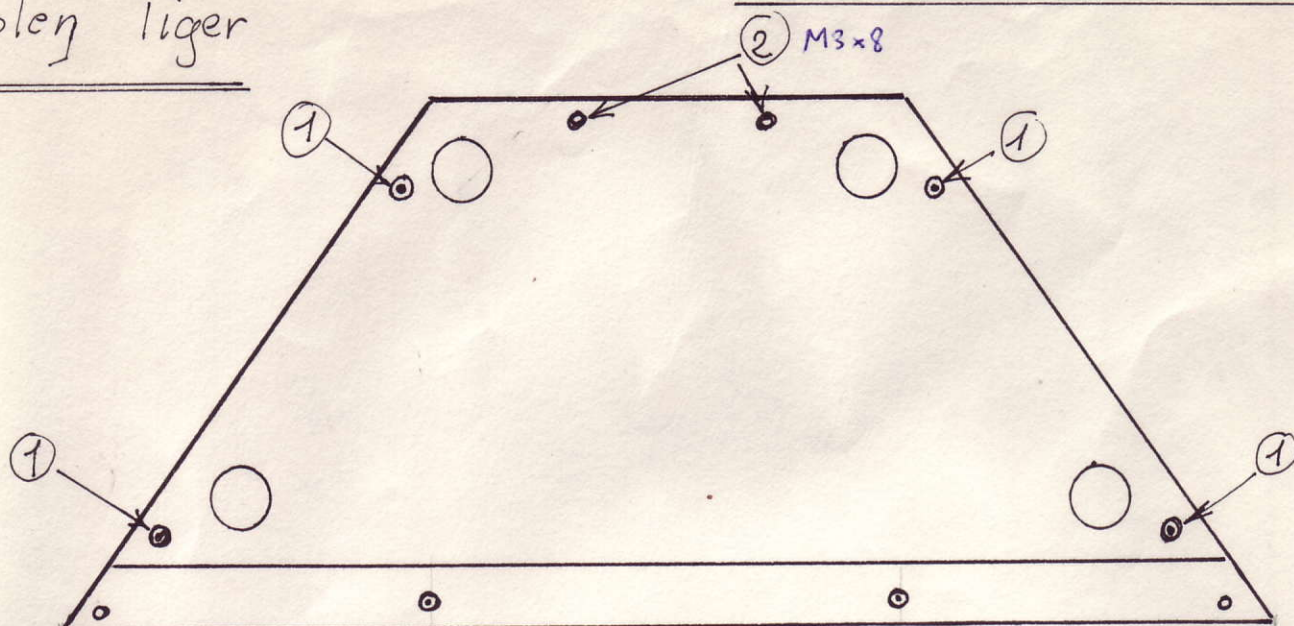

II: taking off the belt part.

- disconnect red wire
- " grey "
- " Main cord.
- Then 4 screws (3)
- disconnect connector (A)
- Then 2 screws (4)

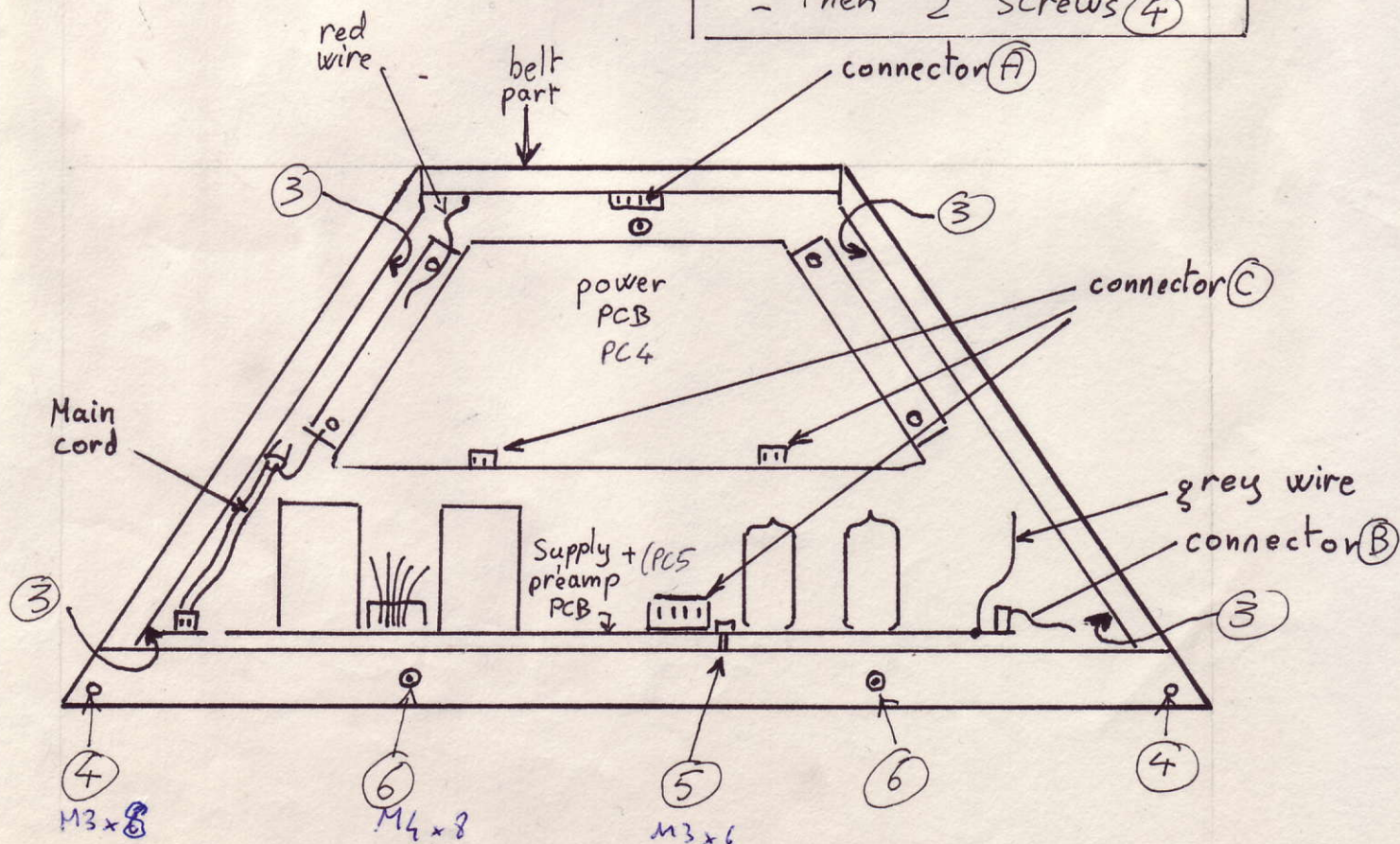

Tiger, first cover off, view.

Verify

- ⊕ a letter ⇒ Left channel.
- ⊕ V1 screw for TA007
- ⊕ V2 screw for cover (access to main transformer)
- ⊕ * 240" serial or some units only.

+VA : Red
-VA : Yel.
GND : Grey

