

TA-N80ES

SERVICE MANUAL

*AEP Model
E Model*



SPECIFICATIONS

AUDIO POWER SPECIFICATIONS

POWER OUTPUT AND TOTAL HARMONIC DISTORTION:

With 4 ohm loads, both channels driven, from 20 - 20,000 Hz; rated 270 watts per channel minimum RMS power, with no more than 0.006 % total harmonic distortion from 250 milliwatts to rated output.

With 8 ohm loads, both channels driven, from 20 - 20,000 Hz; rated 200 watts per channel minimum RMS power, with no more than 0.004 % total harmonic distortion from 250 milliwatts to rated output.

Other specifications

Item	Condition	Model except for North Europe	Model for North Europe
Continuous RMS power output (both channels driven simultaneously)	4 ohms 20 Hz - 20 kHz, THD 0.006 %	270 W + 270 W	—
	6 ohms 20 Hz - 20 kHz, THD 0.005 %	230 W + 230 W	190 W + 190 W
	8 ohms 20 Hz - 20 kHz, THD 0.004 %	200 W + 200 W	160 W + 160 W

Dynamic power	1 ohm	660 W	530 W
	2 ohms	800 W	640 W
	4 ohms	520 W	420 W
	6 ohms	370 W	300 W
	8 ohms	300 W	240 W
Power bandwidth (IHF)	4 ohms, 0.02 %	10 Hz - 100 kHz	—
	8 ohms, THD 0.02 %	10 Hz - 100kHz	
Dynamic headroom ('78 IHF)	4 ohms	2.8 dB	—
	8 ohms	1.8 dB	
Total harmonic distortion	4 ohms, at 10 watt output	0.004 %	—
	6 ohms, at 10 watt output	0.003 %	
	8 ohms, at 10 watt output	0.0018 %	

— Continued on page 2 —



STEREO POWER AMPLIFIER
SONY®

Intermodulation (IM) distortion 60 Hz:7 kHz = 4:1	4 ohms, at rated output	0.006 %	—
	6 ohms, at rated output	0.005 %	
	8 ohms at rated output	0.004 %	
Damping factor	8 ohms, 1 kHz	100	
Slew rate	—	150 V/ μ sec 300 V/ μ sec (inside)	
Residual noise	network A	less than 35 μ V	
Frequency response	—	1 Hz - 200 kHz $^{+0}_{-3}$ dB	
Input sensitivity	—	UNBALANCED: 1 V, 30 kohms	
		BALANCED: 0.5 V, 600 ohms	
S/N (network) '78 IHF	FIXED VARIABLE	120 dB (A)	

General**System**

Super legato linear,
purecomplementary SEPP power amplifier,
powerful power supply

Power requirements

Model for U.S.A. and Canada: 120 V AC, 60 Hz
Model for other countries: 120, 220 or 240V AC
adjustable, 50/60 Hz

Power consumption

Model for U.S.A.: 380 watts
Model for Canada: 950 VA
Model for North European
countries: 310 W
Models for European countries and other
countries: 510 W

Dimensions

Approx. 470 x 185 x 440 mm (w/h/d)
(18 $\frac{5}{8}$ x 7 $\frac{3}{8}$ x 17 $\frac{3}{8}$ inches)
including projecting parts and controls

Weight

Model for European countries:
Approx. 24 kg (52 lb 15 oz), net
other models: Approx. 26.3 kg (58 lb)

Supplied accessories

Power control cord (1)

Design and specifications subject to change without notice.

SAFETY-RELATED COMPONENT WARNING!!



COMPONENTS IDENTIFIED BY MARK  OR DOTTED LINE WITH MARK  ON THE SCHEMATIC DIAGRAMS AND IN THE PARTS LIST ARE CRITICAL TO SAFE OPERATION. REPLACE THESE COMPONENTS WITH SONY PARTS WHOSE PART NUMBERS APPEAR AS SHOWN IN THIS MANUAL OR IN SUPPLEMENTS PUBLISHED BY SONY.

TABLE OF CONTENTS

<u>Section</u>	<u>Title</u>	<u>Page</u>	<u>Section</u>	<u>Title</u>	<u>Page</u>
Specifications		1	3.	ELECTRICAL ADJUSTMENTS	
1.	GENERAL		4.	DIAGRAMS	
	Precautions	3	4-1.	Semiconductor Lead Layouts	11
	Operating Voltage	3	4-2.	Printed Wiring Boards	12
	Function of Controls	4	4-3.	Schematic Diagram	17
	System Connections	5	5.	EXPLODED VIEWS	
2.	DISASSEMBLY		6.	ELECTRICAL PARTS LIST	25
	Top Plate and Ornamental Side Plate (R)				
	Removal	7			
	Front Panel Removal	7			
	Protector Board Removal	8			
	Chemical Condenser Assy Removal	8			
	Main (A) Board Open	9			
	Circuit Boards Location	9			

SECTION 1

GENERAL

English

Precautions

This section is extracted from instruction manual.

- Unplug the unit from the wall outlet if it is not to be used for an extended period of time. To disconnect the cord, pull it out by grasping the plug. Never pull the plug out by the cord.
- Avoid installing or leaving the unit in a location:
 - near heat sources such as radiators, airducts or heaters
 - subject to direct sunlight
 - exposed to rain or moisture
 - where it is liable to come into contact with dust or dirt
 - that is unventilated, such as on a bookcase.
- Should any liquid or solid object fall into the unit, unplug the unit and have the unit checked by qualified personnel before operating it any further.
- AC power cord must be changed only at the qualified service shop.

If you have any question or problem concerning your unit that is not covered in this manual, please consult your nearest Sony dealer.

For the customers in the U.S.A.

For detailed safety precautions, see the leaflet "IMPORTANT SAFEGUARDS".

Operating Voltage

Before connecting the unit to an AC outlet, be sure that the operating voltage of your unit is identical with that of your local power supply.

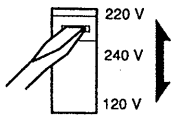
U.S.A. and Canada	Operates on 120 V AC, 60 Hz.
European countries	Operates on 220 V AC, 50/60 Hz.
Other countries 	Operates on either 120 V, 220 V or 240 V AC, 50/60 Hz. The voltage selector is located on the rear panel. If the selector must be reset, disconnect the AC power cord and set the selector to the proper voltage of your local power supply.

Function of Controls

Fonction des commandes

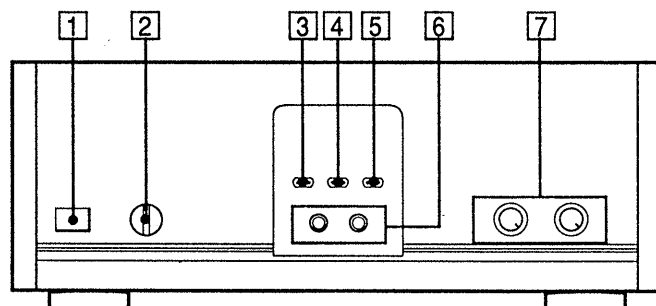

1 POWER switch

2 SPEAKERS selector

Selects speaker system A, B or both (A+B). For headphone monitoring on the connected control amplifier, set the selector to OFF.

3 PROTECTION indicator

Lights up for approximately 7 seconds immediately after turning on the unit. This indicates that the built-in muting circuit is activated.

In normal operating conditions, this does not light. If it lights up (speaker sound is not heard) while operating, an abnormality has occurred. In this case, disconnect the AC power cord and check the connected components and speaker systems.

4 STEREO Indicator

Lights up when OPERATION (STEREO/MONO) is set to STEREO.

5 MONO Indicator

Lights up when OPERATION (STEREO/MONO) is set to MONO.

6 INPUT selectors

Select input source connected to the input jacks on the rear panel; FIXED or VARIABLE.

7 RIGHT and LEFT (MONO) INPUT LEVEL controls

Control input signal sound level from the control amplifier connected to the VARIABLE input jacks. Before turning ON the power, set these INPUT LEVEL controls to the "-20 dB" position.

1 Interrupteur d'alimentation (POWER)

2 Sélecteur d'enceinte (SPEAKERS)

Sélectionne le système d'enceintes A, B ou les deux (A+B). Pour écouter au casque sur l'amplificateur de contrôle raccordé, régler le sélecteur sur OFF.

3 Témoin de protection (PROTECTION)

S'allume pendant environ 7 secondes immédiatement après la mise sous tension de l'appareil. Ceci signifie que le circuit d'assourdissement incorporé est activé. En mode de fonctionnement normal, ce témoin ne s'allume pas.

S'il s'allume (le son de l'enceinte n'est plus perçu) pendant le fonctionnement, quelque chose d'anormal est arrivé. Dans ce cas, déconnecter le cordon d'alimentation secteur et les systèmes d'enceintes.

4 Témoin de stéréo (STEREO)

S'allume lorsque OPERATION (STEREO/MONO) est réglé sur STEREO.

5 Témoin de monophonie (MONO)

S'allume lorsque OPERATION (STEREO/MONO) est réglé sur MONO.

6 Sélecteurs d'entrée (INPUT)

Sélectionne la source d'entrée raccordée aux prises d'entrée sur le panneau arrière; FIXED ou VARIABLE.

7 Réglage gauche et droit (RIGHT et LEFT (MONO) INPUT LEVEL)

Règlent le niveau sonore du signal d'entrée depuis l'amplificateur de contrôle raccordé aux prises d'entrée VARIABLE. Avant de mettre l'appareil sous tension, régler ces commandes INPUT LEVEL sur la position "-20 dB".

System Connections

Connexions du système

Connection Notes

- The power cord should be connected last of all, first making sure that the POWER switch is turned off.
- Cable connectors should be fully inserted into the jacks. A loose connection may cause hum and noise.
- Cord plugs and jacks are color coded. Red plugs and jacks are for the right channel (R) and white ones are for the left channel (L).

Remarques sur les connexions

- Le cordon d'alimentation doit être raccordé en dernier, en s'assurant au préalable que l'interrupteur POWER est sur OFF.
- Les câbles de connexions doivent être entièrement insérés dans les prises, une connexion relâchée pouvant être la cause de bruit et de ronflement.
- Les fiches et prises des cordons sont codés avec une couleur. Les fiches et prises rouges sont destinées au canal droit et les blanches au canal gauche.

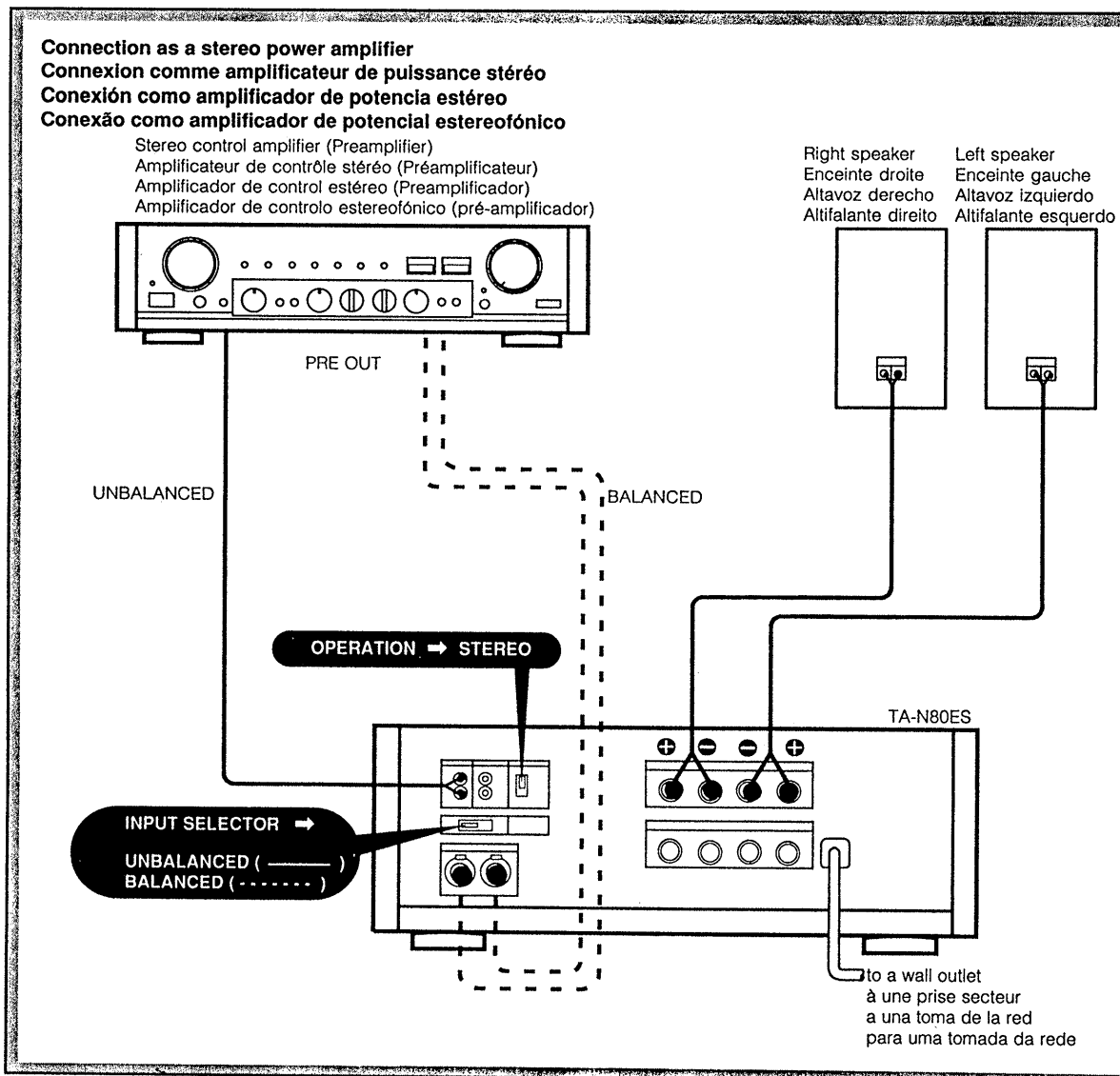

Conexiones del sistema

Notas sobre las conexiones

- El cable de alimentación debe conectarse al final de todo, primero asegurándose de que el interruptor POWER esté en OFF.
- Las clavijas de cables deberán insertarse firmemente en las tomas. Una conexión floja puede causar zumbido y ruido.
- Las clavijas y tomas de los cables están codificadas en color. Las clavijas y las tomas rojas son para el canal derecho y las blancas para el izquierdo.

Ligação do sistema

Notas sobre as ligações

- O cabo de alimentação deve ser ligado por último. Primeiramente, assegure-se de que o interruptor de alimentação (POWER) está desligado.
- As fichas dos cabos devem estar firmemente inseridas nas suas respectivas tomadas.
- Ligações frouxas podem causar zumbidos e ruídos.
- As fichas estão codificadas por cores. As fichas e as tomadas vermelhas são para o canal da direita (R), e as brancas para o canal da esquerda (L).

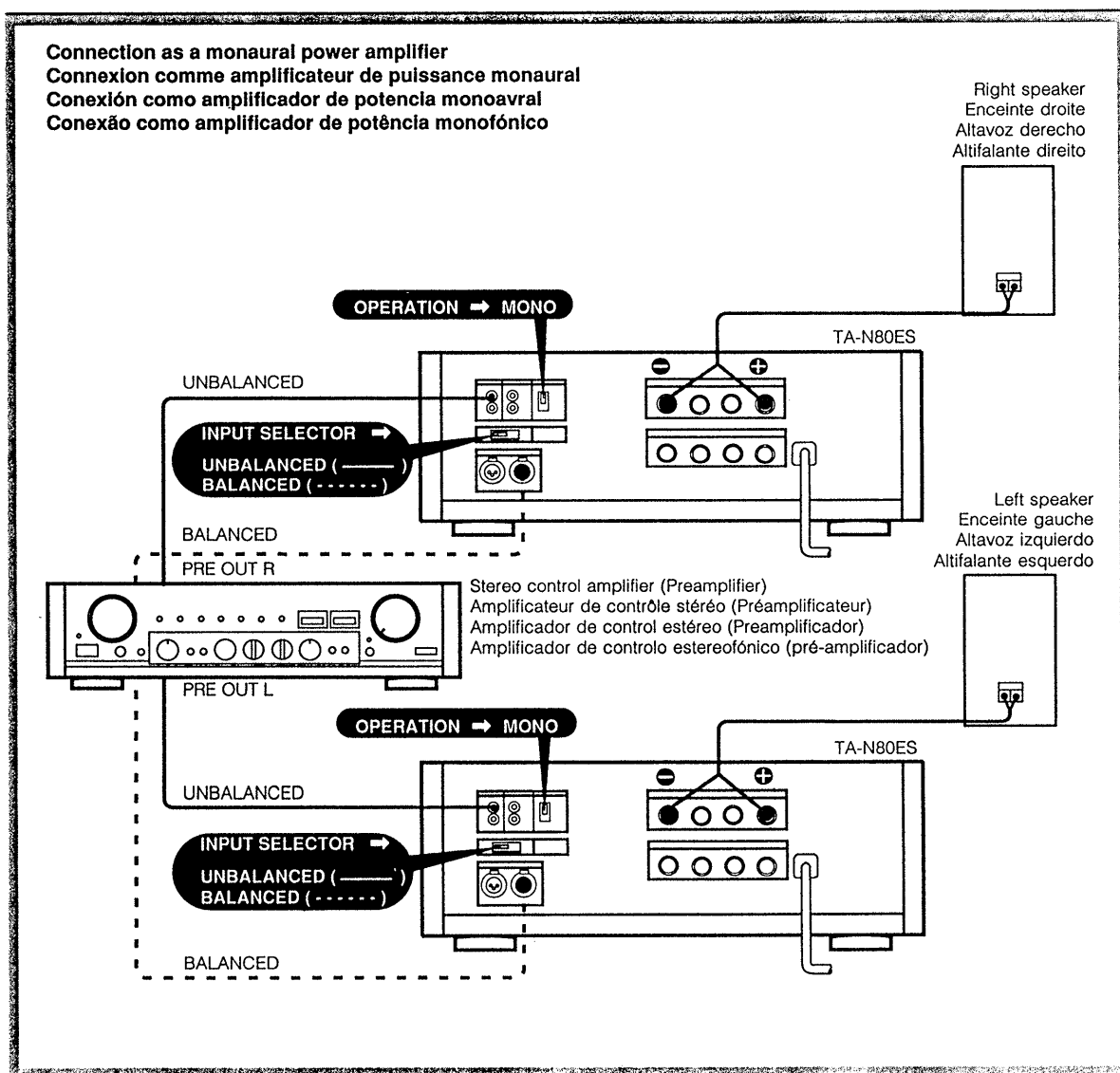

SECTION 2 DISASSEMBLY

Note: Follow the disassembly procedure in the numerical order given.

TOP PLATE AND ORNAMENTAL SIDE PLATE (R) REMOVAL

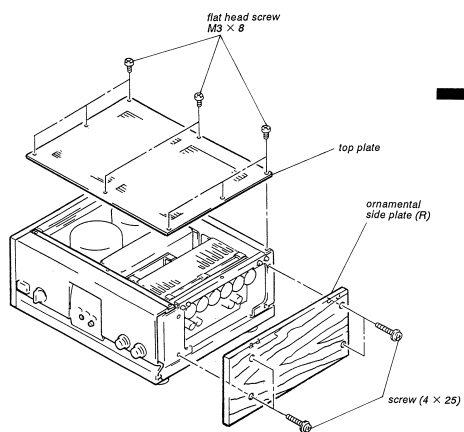

FRONT PANEL REMOVAL

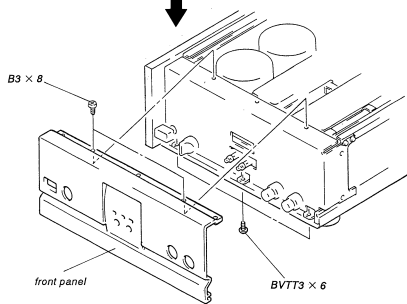

—7—

PROTECTOR BOARD REMOVAL

❶ Remove the top plate.

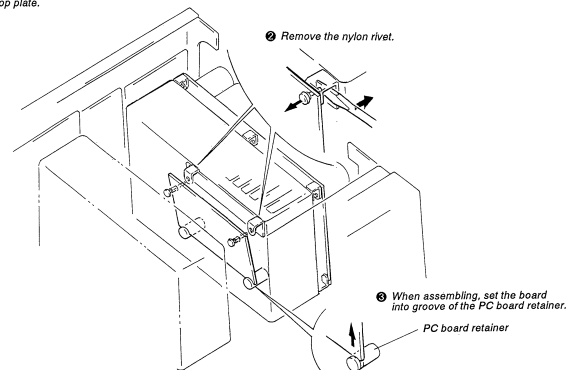

CHEMICAL CONDENSER ASSY REMOVAL

❶ Remove the top plate.

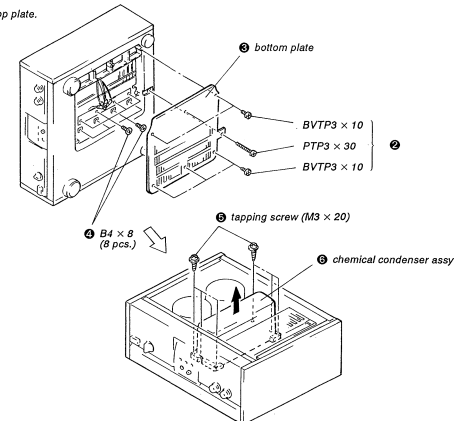

—8—

MAIN (A) BOARD OPEN

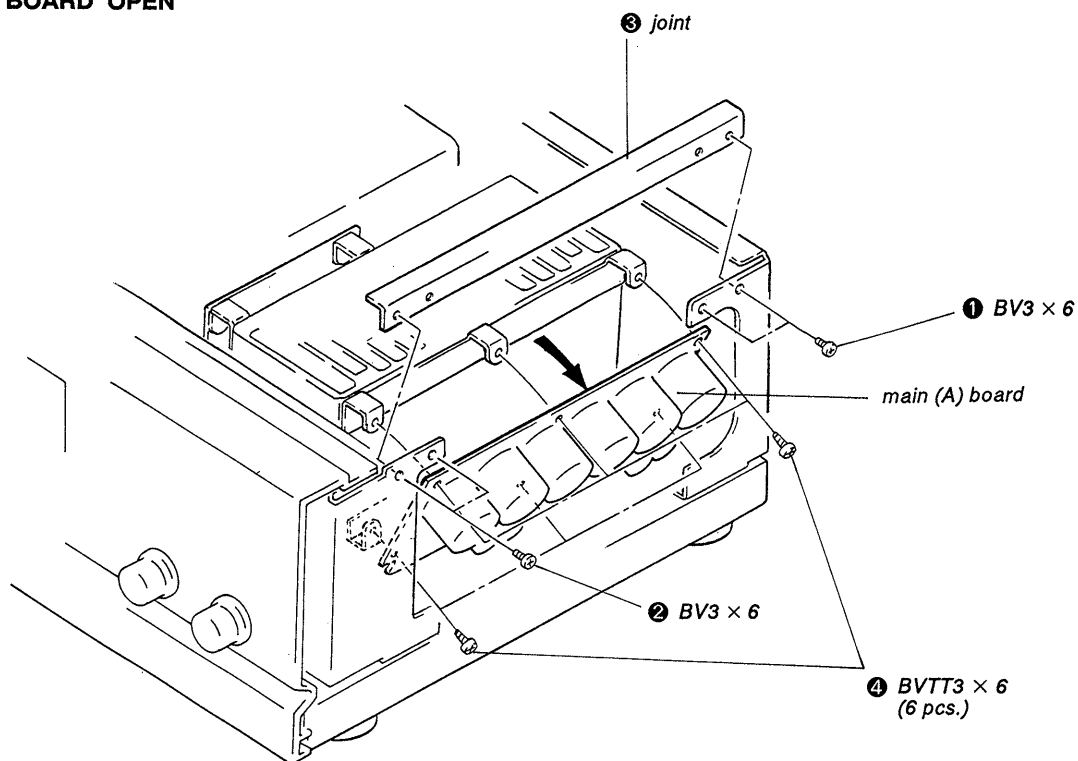

CIRCUIT BOARDS LOCATION

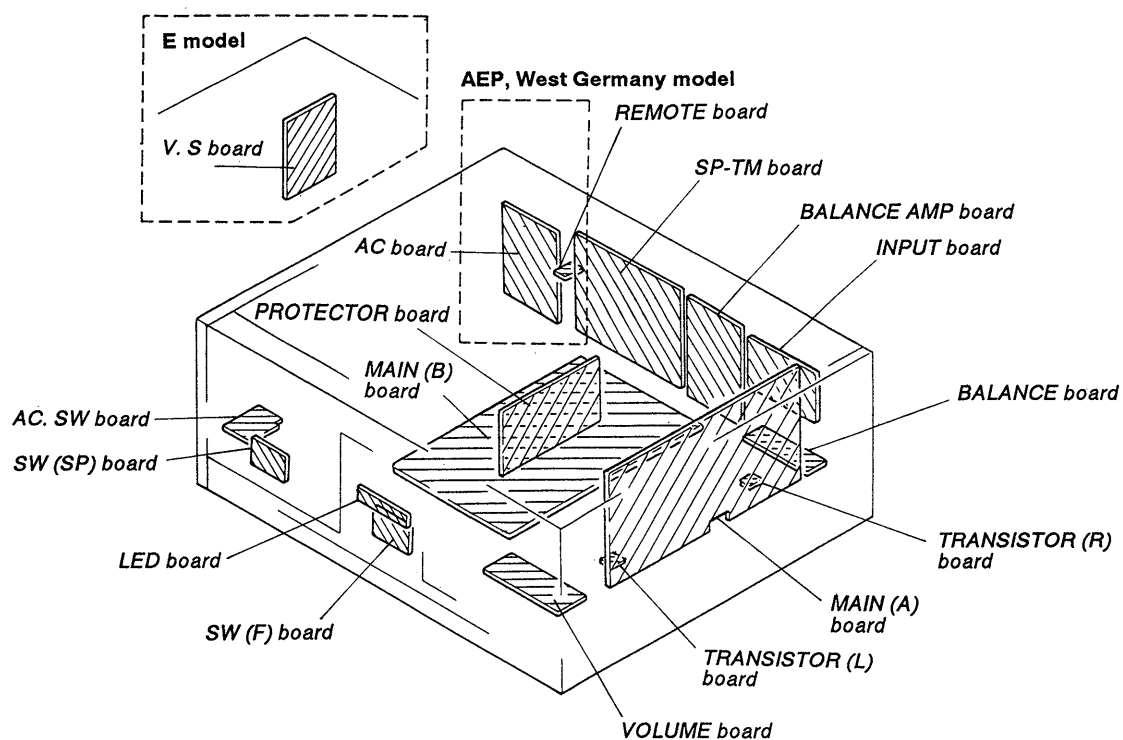

SECTION 3 ELECTRICAL ADJUSTMENTS

Note: Adjustment should be performed 5 minutes later, after the power switch is on.

Offset Adjustment

Setting:

OPERATION switch: STEREO
Input signal: No signal input

Procedure:

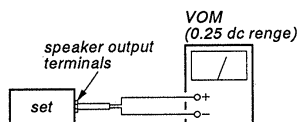

Adjust RT401 (L-CH) and RT-451 (R-CH) for 0 V reading on the VOM.

Adjustment Location: main (A) board

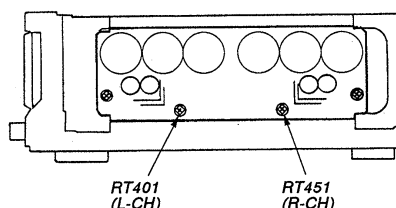

Bias Current Adjustment

Setting:

OPERATION switch: STEREO
Input signal: No signal input

Procedure:

Adjust RT302 (L-CH) and RT352 (R-CH) so that VOM readings of TP-A (L-CH), TP-B (R-CH) become 15 mV.

Adjustment Location: main (A) board and protector board

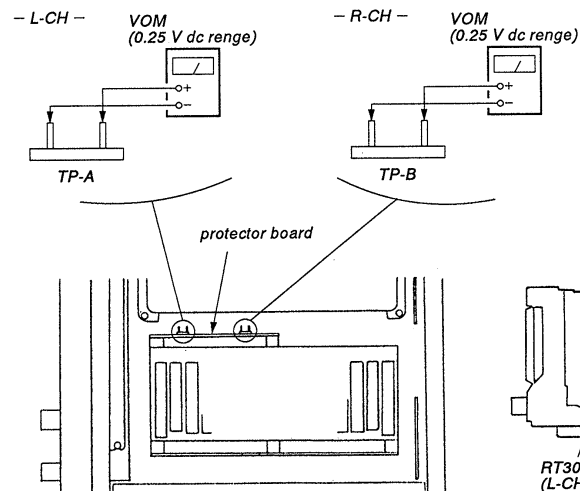

SECTION 4 DIAGRAMS

4-1. SEMICONDUCTOR LEAD LAYOUTS

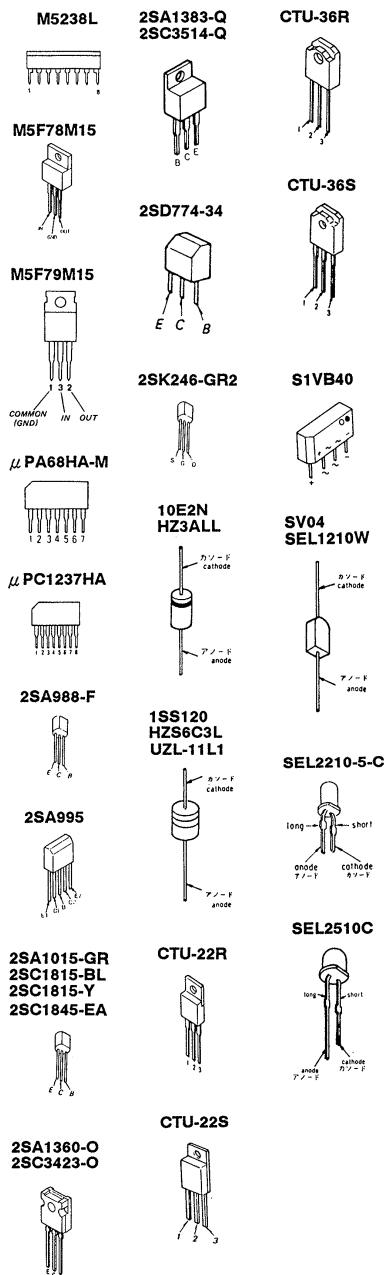

4-2. PRINTED WIRING BOARDS • See page 11 for Semiconductor Lead Layouts.
• See page 9 for Circuit Boards Location.

Note on Printed Wiring Board:
Note:
 * 0 — : parts extracted from the component side

- Semiconductor Location

Ref. No.	Location	Ref. No.	Location
0301	L19	0306	L23
0302	L19	0307	L23
0303	K22	0308	J22
0304	K22	0309	J22
0305	K22	0310	J22
0306	K22	0311	J22
0307	L15	0312	J22
0308	L15	0313	J22
0309	J23	0314	J18
0310	J23	0315	J18
0311	L24	0316	J18
0312	L24	0317	J18
0313	K17	0318	K17
0314	K17	0319	K17
0315	K18	0320	K17
0316	K18	0321	K17
0317	L15	0322	J17
0318	L15	0323	J17
0319	J17	0324	J17
0320	J17	0325	J17
0321	J17	0326	K18
0322	K18	0327	K18
0323	K18	0328	K18
0324	K18	0329	K18
0325	K18	0330	K18
0326	K18	0331	K18
0327	K18	0332	K18
0328	K18	0333	K18
0329	K18	0334	K18
0330	K18	0335	K18
0331	K18	0336	K18
0332	K18	0337	K18
0333	K18	0338	K18
0334	K18	0339	K18
0335	K18	0340	K18
0336	K18	0341	K18
0337	K18	0342	K18
0338	K18	0343	K18
0339	K18	0344	K18
0340	K18	0345	K18
0341	K18	0346	K18
0342	K18	0347	K18
0343	K18	0348	K18
0344	K18	0349	K18
0345	K18	0350	K18
0346	K18	0351	K18
0347	K18	0352	K18
0348	K18	0353	K18
0349	K18	0354	K18
0350	K18	0355	K18
0351	K18	0356	K18
0352	K18	0357	K18
0353	K18	0358	K18
0354	K18	0359	K18
0355	K18	0360	K18
0356	K18	0361	K18
0357	K18	0362	K18
0358	K18	0363	K18
0359	K18	0364	K18
0360	K18	0365	K18
0361	K18	0366	K18
0362	K18	0367	K18
0363	K18	0368	K18
0364	K18	0369	K18
0365	K18	0370	K18
0366	K18	0371	K18
0367	K18	0372	K18
0368	K18	0373	K18
0369	K18	0374	K18
0370	K18	0375	K18
0371	K18	0376	K18
0372	K18	0377	K18
0373	K18	0378	K18
0374	K18	0379	K18
0375	K18	0380	K18
0376	K18	0381	K18
0377	K18	0382	K18
0378	K18	0383	K18
0379	K18	0384	K18
0380	K18	0385	K18
0381	K18	0386	K18
0382	K18	0387	K18
0383	K18	0388	K18
0384	K18	0389	K18
0385	K18	0390	K18
0386	K18	0391	K18
0387	K18	0392	K18
0388	K18	0393	K18
0389	K18	0394	K18
0390	K18	0395	K18
0391	K18	0396	K18
0392	K18	0397	K18
0393	K18	0398	K18
0394	K18	0399	K18
0395	K18	0400	K18
0396	K18	0401	K18
0397	K18	0402	K18
0398	K18	0403	K18
0399	K18	0404	K18
0400	K18	0405	K18
0401	K18	0406	K18
0402	K18	0407	K18
0403	K18	0408	K18
0404	K18	0409	K18
0405	K18	0410	K18
0406	K18	0411	K18
0407	K18	0412	K18
0408	K18	0413	K18
0409	K18	0414	K18
0410	K18	0415	K18
0411	K18	0416	K18
0412	K18	0417	K18
0413	K18	0418	K18
0414	K18	0419	K18
0415	K18	0420	K18
0416	K18	0421	K18
0417	K18	0422	K18
0418	K18	0423	K18
0419	K18	0424	K18
0420	K18	0425	K18
0421	K18	0426	K18
0422	K18	0427	K18
0423	K18	0428	K18
0424	K18	0429	K18
0425	K18	0430	K18
0426	K18	0431	K18
0427	K18	0432	K18
0428	K18	0433	K18
0429	K18	0434	K18
0430	K18	0435	K18
0431	K18	0436	K18
0432	K18	0437	K18
0433	K18	0438	K18
0434	K18	0439	K18
0435	K18	0440	K18
0436	K18	0441	K18
0437	K18	0442	K18
0438	K18	0443	K18
0439	K18	0444	K18
0440	K18	0445	K18
0441	K18	0446	K18
0442	K18	0447	K18
0443	K18	0448	K18
0444	K18	0449	K18
0445	K18	0450	K18
0446	K18	0451	K18
0447	K18	0452	K18
0448	K18	0453	K18
0449	K18	0454	K18
0450	K18	0455	K18
0451	K18	0456	K18
0452	K18	0457	K18
0453	K18	0458	K18
0454	K18	0459	K18
0455	K18	0460	K18
0456	K18	0461	K18
0457	K18	0462	K18
0458	K18	0463	K18
0459	K18	0464	K18
0460	K18	0465	K18
0461	K18	0466	K18
0462	K18	0467	K18
0463	K18	0468	K18
0464	K18	0469	K18
0465	K18	0470	K18
0466	K18	0471	K18
0467	K18	0472	K18
0468	K18	0473	K18
0469	K18	0474	K18
0470	K18	0475	K18
0471	K18	0476	K18
0472	K18	0477	K18
0473	K18	0478	K18
0474	K18	0479	K18
0475	K18	0480	K18
0476	K18	0481	K18
0477	K18	0482	K18
0478	K18	0483	K18
0479	K18	0484	K18
0480	K18	0485	K18
0481	K18	0486	K18
0482	K18	0487	K18
0483	K18	0488	K18
0484	K18	0489	K18
0485	K18	0490	K18
0486	K18	0491	K18
0487	K18	0492	K18
0488	K18	0493	K18
0489	K18	0494	K18
0490	K18	0495	K18
0491	K18	0496	K18
0492	K18	0497	K18
0493	K18	0498	K18
0494	K18	0499	K18
0495	K18	0500	K18
0496	K18	0501	K18
0497	K18	0502	K18
0498	K18	0503	K18
0499	K18	0504	K18
0500	K18	0505	K18
0501	K18	0506	K18
0502	K18	0507	K18
0503	K18	0508	K18
0504	K18	0509	K18
0505	K18	0510	K18
0506	K18	0511	K18
0507	K18	0512	K18
0508	K18	0513	K18
0509	K18	0514	K18
0510	K18	0515	K18
0511	K18	0516	K18
0512	K18	0517	K18
0513	K18	0518	K18
0514	K18	0519	K18
0515	K18	0520	K18
0516	K18	0521	K18
0517	K18	0522	K18
0518	K18	0523	K18
0519	K18	0524	K18
0520	K18	0525	K18
0521	K18	0526	K18
0522	K18	0527	K18
0523	K18	0528	K18
0524	K18	0529	K18
0525	K18	0530	K18
0526	K18	0531	K18
0527	K18	0532	K18
0528	K18	0533	K18
0529	K18	0534	K18
0530	K18	0535	K18
0531	K18	0536	K18
0532	K18	0537	K18
0533	K18	0538	K18
0534	K18	0539	K18
0535	K18	0540	K18
0536	K18	0541	K18
0537	K18	0542	K18
0538	K18	0543	K18
0539	K18	0544	K18
0540	K18	0545	K18
0541	K18	0546	K18
0542	K18	0547	K18
0543	K18	0548	K18
0544	K18	0549	K18
0545	K18	0550	K18
0546	K18	0551	K18
0547	K18	0552	K18
0548	K18	0553	K18
0549	K18	0554	K18
0550	K18	0555	K18
0551	K18	0556	K18
0552	K18	0557	K18
0553	K18	0558	K18
0554	K18	0559	K18
0555	K18	0560	K18
0556	K18	0561	K18
0557	K18	0562	K18
0558	K18	0563	K18
0559	K18	0564	K18
0560	K18	0565	K18
0561	K18	0566	K18
0562	K18	0567	K18
0563	K18	0568	K18
0564	K18	0569	K18
0565	K18	0570	K18
0566	K18	0571	K18
0567	K18	0572	K18
0568	K18	0573	K18
0569	K18	0574	K18
0570	K18	0575	K18
0571	K18	0576	K18
0572	K18	0577	K18
0573	K18	0578	K18
0574	K18	0579	K18
0575	K18	0580	K18
0576	K18	0581	K18
0577	K18	0582	K18
0578	K18	0583	K18
0579	K18	0584	K18
0580	K18	0585	K18
0581	K18	0586	K18
0582	K18	0587	K18
0583	K18	0588	K18
0584	K18	0589	K18
0585	K18	0590	K18
0586	K18	0591	K18
0587	K18	0592	K18
0588	K18	0593	K18
0589	K18	0594	K18
0590	K18	0595	K18
0591	K18	0596	K18
0592	K18	0597	K18
0593	K18	0598	K18
0594	K18	0599	K18
0595	K18	0600	K18
0596	K18	0601	K18
0597	K18	0602	K18
0598	K18	0603	K18
0599	K18	0604	K18
0600	K18	0605	K18
0601	K18	0606	K18
0602	K18	0607	K18
0603	K18	0608	K18
0604	K18	0609	K18
0605	K18	0610	K18
0606	K18	0611	K18
0607	K18	0612	K18
0608	K18	0613	K18
0609	K18	0614	K18
0610	K18	0615	K18
0611	K18	0616	K18
0612	K18	0617	K18
0613	K18	0618	K18
0614	K18	0619	K18
0615	K18	0620	K18
0616	K18	0621	K18
0617	K18	0622	K18
0618	K18	0623	K18
0619	K18	0624	K18
0620	K18	0625	K18
0621	K18	0626	K18
0622	K18	0627	K18
0623	K18	0628	K18
0624	K18	0629	K18
0625	K18	0630	K18
0626	K18	0631	K18
0627	K18	0632	K18
0628	K18	0633	K18
0629	K18	0634	K18
0630	K18	0635	K18
0631	K18	0636	K18
0632	K18	0637	K18
0633	K18	0638	K18
0634	K18	0639	K18
0635	K18	0640	K18
0636	K18	0641	K18
0637	K18	0642	K18
0638	K18	0643	K18
0639	K18	0644	K18
0640	K18	0645	K18
0641	K18	0646	K18
0642	K18	0647	K18
0643	K18	0648	K18

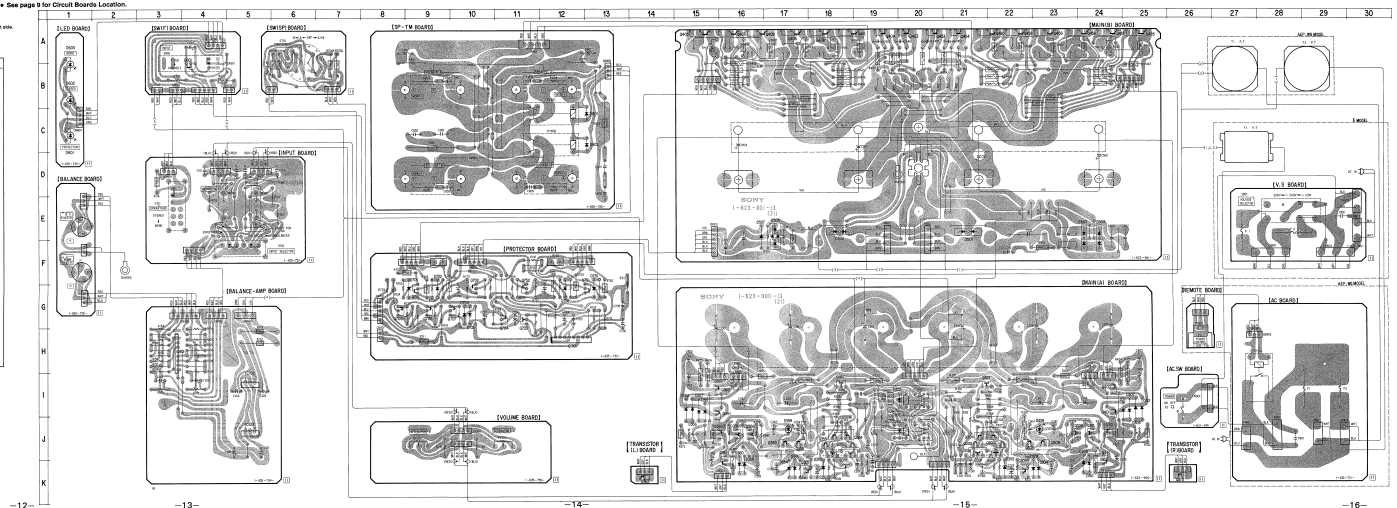

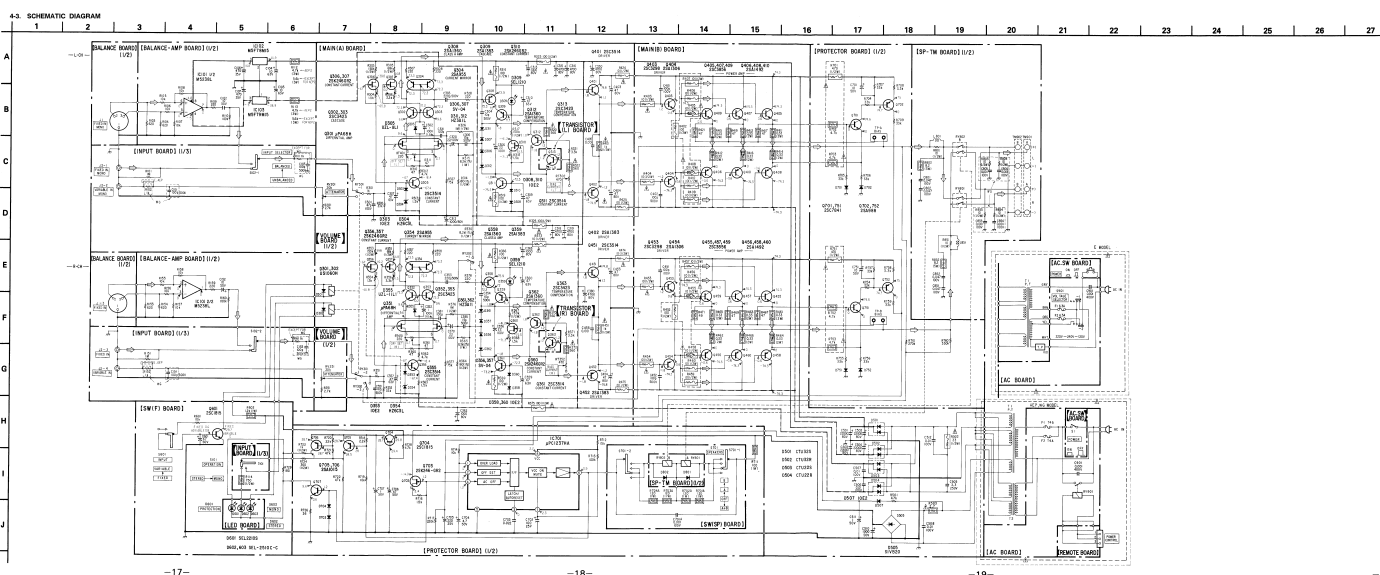
[illegible]

SECTION 5

EXPLODED VIEWS



NOTE:

- The mechanical parts with no reference number in the exploded views are not supplied.
- The construction parts of an assembled part are indicated with a collation number in the remark column.
- Items marked “★” are not stocked since they are seldom required for routine service. Some delay should be anticipated when ordering these items.

- Due to standardization, parts with part number suffix -XX and -X may be different from the parts specified in the components used on the set.
- Color Indication of Appearance Parts
Example:
(RED) ... KNOB, BALANCE (WHITE)

↑
Cabinet's Color

↑
Parts Color
- WG : West Germany

The components identified by mark  or dotted line with mark  are critical for safety. Replace only with part number specified.

(1) CABINET SECTION

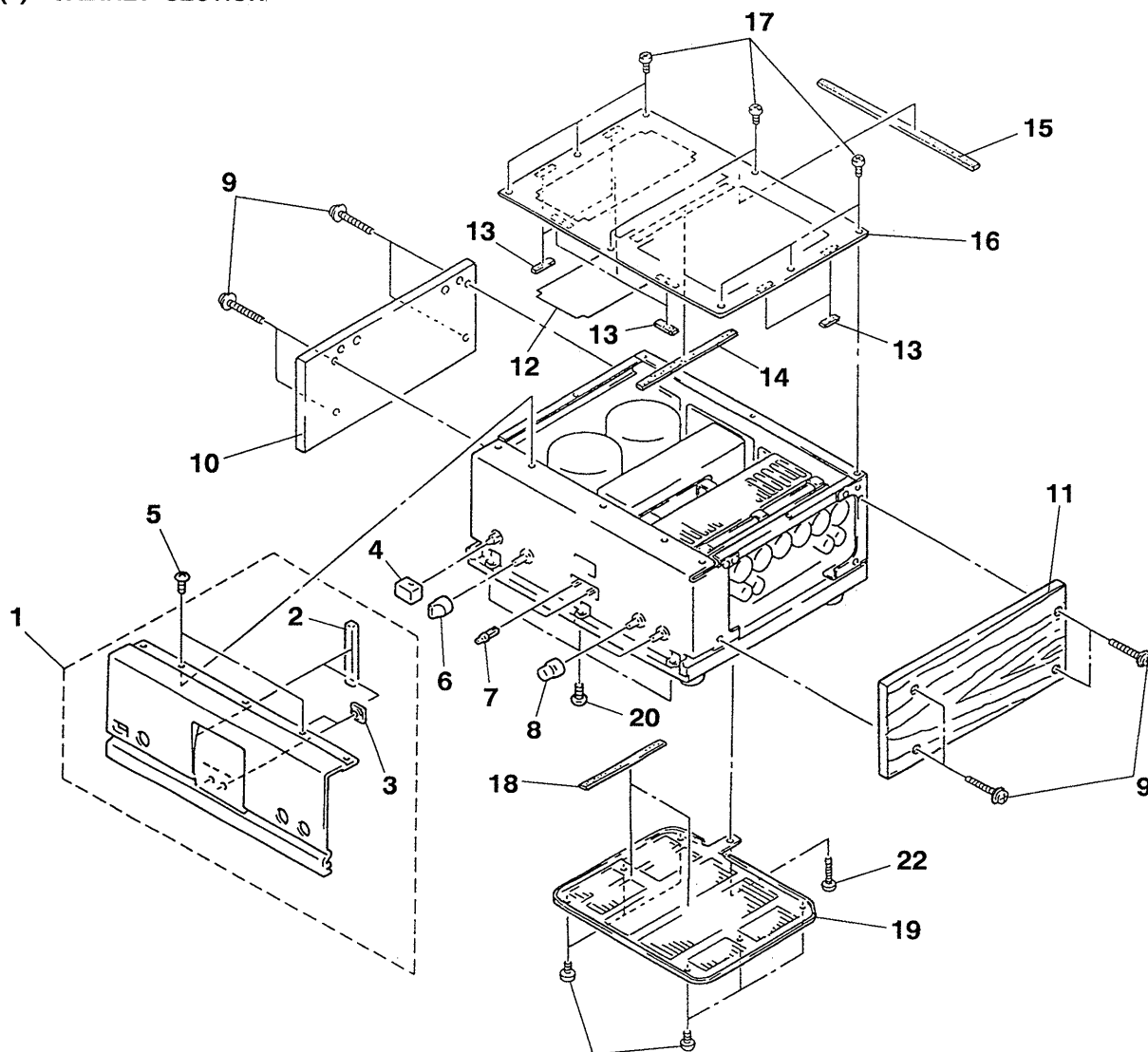



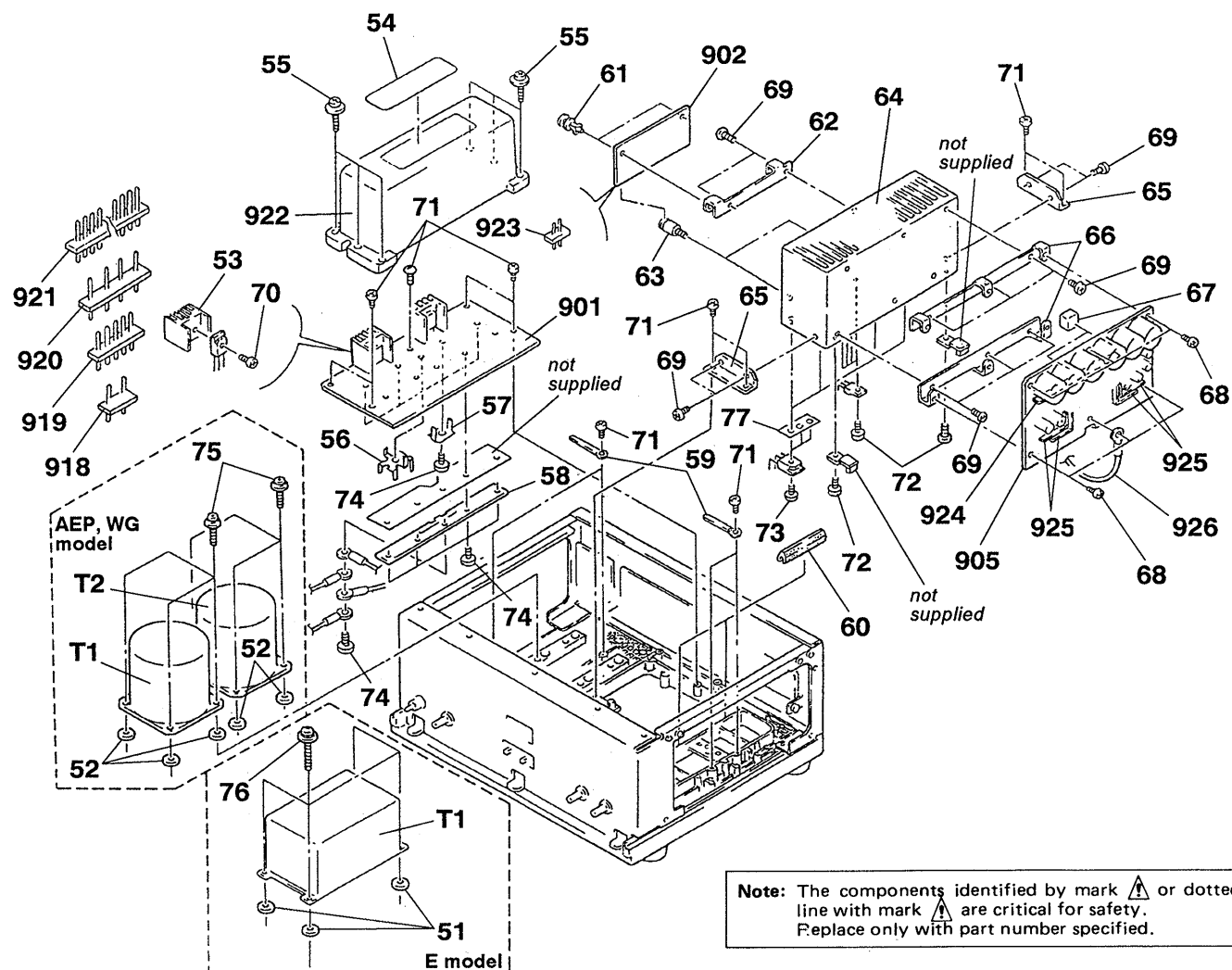

No.	Part No.	Description
1	A-4323-659-A	PANEL ASSY, FRONT
2	*4-922-258-01	CUSHION
3	4-931-928-01	ESCUTCHEON (C), KNOB
4	4-942-032-01	KNOB (POWER)
5	7-682-548-09	SCREW +B 3X8
6	4-933-031-01	KNOB
7	4-931-926-01	BUTTON (B)
8	4-933-032-01	KNOB
9	4-885-979-11	SCREW (4X25)
10	X-4933-006-1	(AEP,E)...PANEL (L) ASSY, SIDE
	X-4933-008-1	(WG).....PANEL (L) ASSY, SIDE
11	X-4933-007-1	(AEP,E)...PANEL (R) ASSY, SIDE
	X-4933-009-1	(WG).....PANEL (R) ASSY, SIDE

21				
Remarks	No.	Part No.	Description	Remarks
2,3	12	4-887-298-00	(AEP2)...PLATE, SHIELD	
	13	*4-921-410-01	CUSHION	
	14	*4-916-782-41	DAMPER	
	15	4-921-411-11	CUSHION	
	16	4-921-434-21	PLATE, TOP	
	17	4-921-439-01	SCREW (M3X8), FLAT HEAD	
	18	*4-916-782-21	DAMPER	
	19	*4-921-428-01	PLATE, BOTTOM	
	20	7-682-547-09	SCREW +BVTT 3X6 (S)	
	21	7-685-647-79	SCREW +BVTP 3X10 TYPE2 SLIT	
	22	7-685-513-19	SCREW +P 3X30 TYPE2 SLIT	

(2) MAIN CHASSIS SECTION

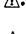

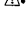
No.	Part No.	Description	Remarks	No.	Part No.	Description	Remarks
51	4-931-976-01	(E)...WASHER (BS)		76	7-682-669-09	(E)...SCREW +PSW 4X35	
52	4-916-751-01	(AEP)...WASHER		77	4-921-419-01	SHEET, INSULATING	
53	*4-921-402-01	HEAT SINK		901	*A-4341-090-A	(AEP1,E)...MOUNTED PCB, MAIN (B)	
54	*4-941-346-01	LABEL, CAPACITOR			*A-4341-101-A	(AEP2).....MOUNTED PCB, MAIN (B)	
55	4-921-437-01	SCREW (M3X20), TAPPING			*A-4341-108-A	(WG).....MOUNTED PCB, MAIN (B)	
56	*4-916-769-01	PLATE, GROUND, 4P		902	*A-4341-098-A	MOUNTED PCB, PROTECTOR	
57	*4-835-639-00	PLATE, GROUND		905	*A-4341-089-A	(AEP,E)...MOUNTED PCB, MAIN (A)	
58	*4-921-422-01	BAR, BUS			*A-4341-103-A	(WG).....MOUNTED PCB, MAIN (A)	
59	*4-908-882-01	CLAMP		918	1-535-135-11	BASE POST 14MM (10MM PITCH) 2P	
60	*4-921-413-01	RUBBER, DAMPING		919	*1-508-812-00	BASE POST (14MM) 5P	
61	4-812-134-00	RIVET NYLON, 3.5		920	*1-535-137-00	BASE POST 14MM (10MM PITCH)	
62	*4-921-424-21	BRACKET, PC BOARD		921	*1-508-817-00	14MM BASE POST	
63	*4-921-417-01	RETAINER, PC BOARD		922	 A-4323-662-A	CHEMICAL CONDENSER ASSY	
64	*4-921-430-01	HEAT SINK		923	*1-508-809-00	BASE POST (14MM) 2P	
65	*4-921-418-01	BRACKET, HEAT SINK		924	*3-311-617-01	REINFORCEMENT, PCB	
66	*4-921-424-01	BRACKET, PC BOARD		925	*1-560-242-21	BUS BAR 4P	
67	4-921-410-51	CUSHION		926	1-559-512-11	(AEP,WG)...CORD (WITH CONNECTOR)	
68	7-682-547-09	SCREW +BVTT 3X6 (S)		T1	 1-450-177-11	(E).....TRANSFORMER, POWER	
69	7-685-645-79	SCREW +BVTP 3X6 TYPE2 SLIT		T1	 1-450-179-11	(AEP1,WG)...TRANSFORMER, POWER	
70	7-682-549-09	SCREW +B 3X10		T1	 1-450-181-11	(AEP2).....TRANSFORMER, POWER	
71	7-685-647-79	SCREW +BVTP 3X10 TYPE2 SLIT		T2	 1-450-178-11	(AEP1,WG)...TRANSFORMER, POWER	
72	7-682-649-09	SCREW +PSW 3X10		T2	 1-450-180-11	(AEP2).....TRANSFORMER, POWER	
73	7-682-650-09	SCREW +PSW 3X12					
74	7-682-561-10	SCREW +B 4X8					
75	4-847-802-01	(WG)....SCREW					
	7-682-962-01	(AEP)...SCREW +PSW 4X10					

(3) FRONT CHASSIS SECTION

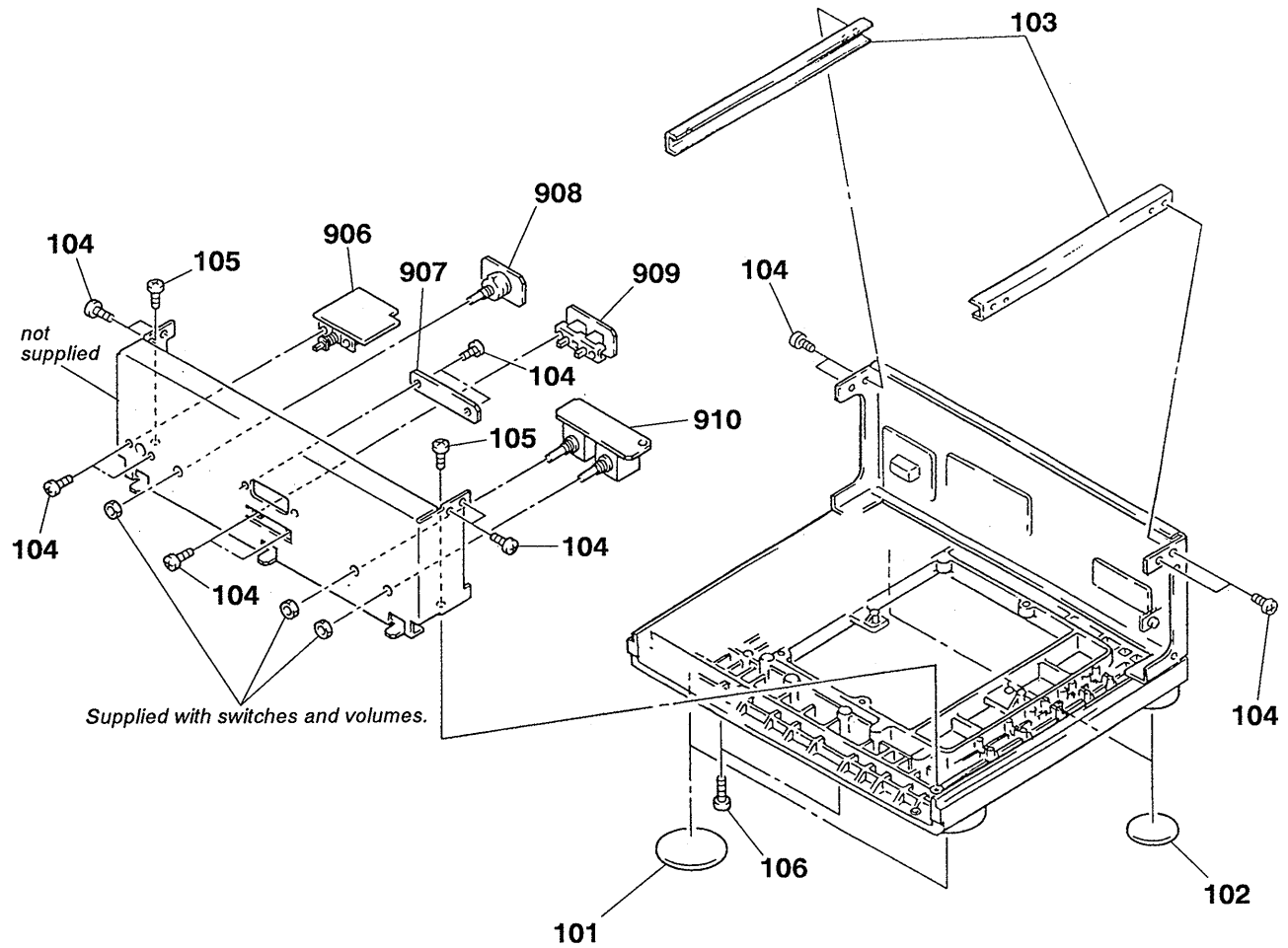



<u>No.</u>	<u>Part No.</u>	<u>Description</u>
101	4-91 6-704-11	FOOT
102	4-91 6-704-01	FOOT
103	*4-921-421-01	JOINT
104	7-682-547-09	SCREW +BVTT 3X6 (S)
105	7-685-647-79	SCREW +BVTP 3X10 TYPE2 SLIT
106	7-685-650-79	SCREW +BVTP 3X16 TYPE2 SLIT



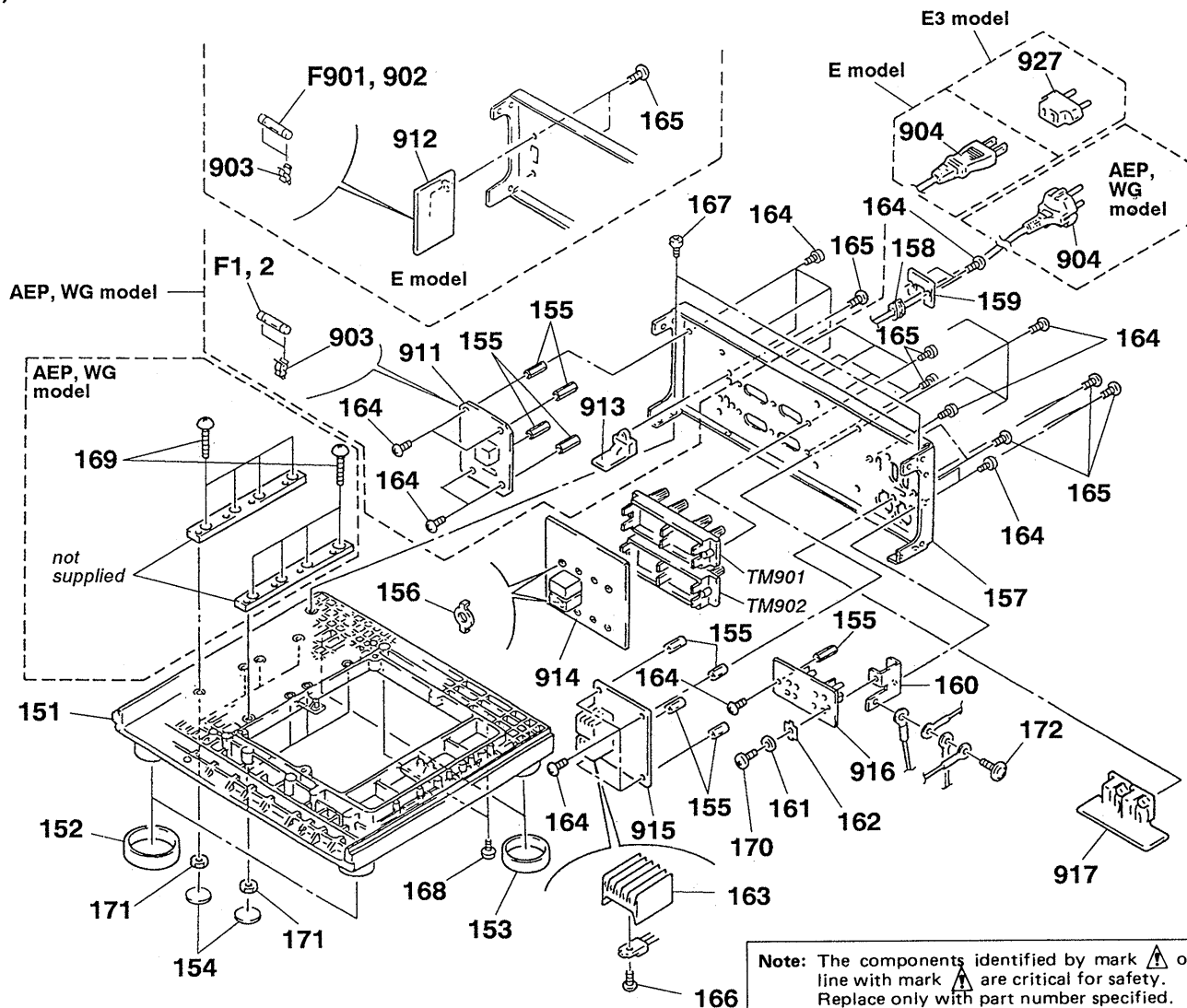



<u>Remarks</u>	<u>No.</u>	<u>Part No.</u>	<u>Description</u>
	906	*1-636-674-11	PC BOARD, AC.SW
	907	*1-635-735-11	PC BOARD, LED
	908	*1-635-736-11	PC BOARD, SW (SP)
	909	*1-635-737-11	PC BOARD, SW (F)
	910	*1-635-750-11	PC BOARD, VOLUME

(4) BACK CHASSIS SECTION

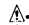

Note: The components identified by mark  or dotted line with mark  are critical for safety. Replace only with part number specified.

No.	Part No.	Description	Remarks
151	X-4941-088-1	CHASSIS ASSY, MAIN	152,153
152	4-923-882-02	RING (LARGE-16), ORNAMENTAL, FOOT	
153	4-923-883-02	RING (SMALL-14), ORNAMENTAL, FOOT	
154	*4-908-892-01	SPACER	
155	*4-876-607-21	COLLAR (E), PLATE, JACK	
156	*4-843-416-11	PLATE, FIXED, CAP	
157	*4-933-030-01	(AEP,WG)...PANEL, BACK	
	*4-933-030-11	(E).....PANEL, BACK	
158	2-352-626-01	BUSHING, CORD	
159	*4-923-873-01	BRACKET, CORD STOPPER	
160	*4-921-416-01	BRACKET	
161	4-908-961-11	WASHER	
162	*4-835-639-00	PLATE, GROUND	
163	*4-921-402-01	HEAT SINK	
164	7-682-547-09	SCREW +BVTT 3X6 (S)	
165	7-685-646-79	SCREW +BVTP 3X8 TYPE2 N-S	
166	7-682-548-09	SCREW +B 3X8	
167	7-685-647-79	SCREW +BVTP 3X10 TYPE2 SLIT	
168	7-685-650-79	SCREW +BVTP 3X16 TYPE2 SLIT	
169	7-682-668-09	(AEP,WG)...SCREW +PS 4X30	

No.	Part No.	Description	Remarks
170	7-682-148-15	SCREW, TR	
171	7-684-024-04	N 4, TYPE 2	
172	7-685-647-71	SCREW +BVT P 3X1 O	
903	 1-533-183-11	HOLDER, FUSE	
904	 1-559-297-31	(E).....CORD, POWER	
	 1-575-953-11	(AEP,WG)...CORD, POWER	
911	*1-635-731-11	(AEP,WG)...PC BOARD, AC	
912	*1-635-740-11	(E)...PC BOARD, V.S	
913	*1-635-738-11	(AEP,WG)...PC BOARD, REMOTE	
914	*1-635-730-11	PC BOARD, SP-TM	
915	*1-635-734-11	PC BOARD, BALANCE-AMP	
916	*1-635-733-11	PC BOARD, INPUT	
917	*1-635-739-11	PC BOARD, BALANCE	
927	 1-569-007-11	(E3)...ADAPTOR, CONVERSION 2P	
F1	 1-532-350-00	(AEP,WG)...FUSE, TIME-LAG	
F2	 1-532-350-00	(AEP,WG)...FUSE, TIME-LAG	
F901	 1-532-325-00	(E).....FUSE, TIME-LAG	
F902	 1-532-325-00	(E).....FUSE, TIME-LAG	
TM901	1-537-102-11	TERMINAL BOARD (SP)	
TM902	1-537-102-11	TERMINAL BOARD (SP)	

SECTION 6

ELECTRICAL PARTS LIST

NOTE:

- Due to standardization, replacements in the parts list may be different from the parts specified in the diagrams or the components used on the set.
- Items marked "★" are not stocked since they are seldom required for routine service. Some delay should be anticipated when ordering these items.
- If there are two or more same circuits in a set such as a stereophonic machine, only typical circuit parts may be indicated and capacitors and resistors in other same circuits may be omitted.

CAPACITORS:MF: μ F, PF: μ F.**RESISTORS**

- All resistors are in ohms.
- F: nonflammable

COILS

- MMH: mH, UH: μ H

SEMICONDUCTORSIn each case, U: μ , for example:UA....: μ A..., UPA....: μ PA...,UPC....: μ PC, UPD....: μ PD...

The components identified by mark Δ or dotted line with mark Δ are critical for safety. Replace only with part number specified.



- WG: West Germany

Ref.No.	Part No.	Description	Ref.No.	Part No.	Description
901	*A-4341-090-A	(AEP1,E)...MOUNTED PCB, MAIN (B)	C303	1-109-621-00	MICA 220PF 5% 500V
	*A-4341-101-A	(AEP2).....MOUNTED PCB, MAIN (B)	C304	1-107-202-00	MICA 10PF 0.5PF 500V
	*A-4341-108-A	(WG).....MOUNTED PCB, MAIN (B)	C305	1-107-206-00	MICA 15PF 5% 500V
902	*A-4341-098-A	MOUNTED PCB, PROTECTOR	C306	1-124-748-11	ELECT 22MF 20% 100V
903	Δ 1-533-183-11	HOLDER, FUSE	C307	1-124-918-11	ELECT 47MF 20% 63V
904	Δ 1-559-297-31	(E).....CORD, POWER	C309	1-124-918-11	ELECT 47MF 20% 63V
	Δ 1-575-953-11	(AEP,WG)...CORD, POWER	C310	1-124-918-11	ELECT 47MF 20% 63V
905	*A-4341-089-A	(AEP,E)...MOUNTED PCB, MAIN (A)	C312	1-126-370-11	ELECT 1000MF 20% 80V
	*A-4341-103-A	(WG).....MOUNTED PCB, MAIN (A)	C313	1-126-370-11	ELECT 1000MF 20% 80V
906	*1-636-674-11	PC BOARD, AC.SW	C315	1-125-488-11	ELECT(BLOCK) 4700MF 20% 80V
907	*1-635-735-11	PC BOARD, LED	C316	1-125-488-11	ELECT(BLOCK) 4700MF 20% 80V
908	*1-635-736-11	PC BOARD, SW (SP)	C318	1-125-488-11	ELECT(BLOCK) 4700MF 20% 80V
909	*1-635-737-11	PC BOARD, SW (F)	C319	1-125-488-11	ELECT(BLOCK) 4700MF 20% 80V
910	*1-635-750-11	PC BOARD, VOLUME	C320	1-124-748-11	ELECT 22MF 20% 100V
911	*1-635-731-11	(AEP,WG)...PC BOARD, AC	C330	1-125-488-11	ELECT(BLOCK) 4700MF 20% 80V
912	*1-635-740-11	(E)...PC BOARD, V.S	C331	1-162-282-11	(WG)...CERAMIC 100PF 10% 50V
913	*1-635-738-11	(AEP,WG)...PC BOARD, REMOTE	C351	1-107-163-00	MICA 47PF 5% 500V
914	*1-635-730-11	PC BOARD, SP-TM	C352	1-123-380-00	ELECT 1MF 20% 100V
915	*1-635-734-11	PC BOARD, BALANCE-AMP	C353	1-109-621-00	MICA 220PF 5% 500V
916	*1-635-733-11	PC BOARD, INPUT	C354	1-107-202-00	MICA 10PF 0.5PF 500V
917	*1-635-739-11	PC BOARD, BALANCE	C355	1-107-206-00	MICA 15PF 5% 500V
918	1-535-135-11	BASE POST 14MM (10MM PITCH) 2P	C356	1-124-748-11	ELECT 22MF 20% 100V
919	*1-508-812-00	BASE POST (14MM) 5P	C357	1-124-918-11	ELECT 47MF 20% 63V
920	*1-535-137-00	BASE POST 14MM (10MM PITCH)	C359	1-124-918-11	ELECT 47MF 20% 63V
921	*1-508-817-00	14MM BASE POST	C360	1-124-918-11	ELECT 47MF 20% 63V
922	Δ A-4323-662-A	CHEMICAL CONDENSER ASSY	C362	1-126-370-11	ELECT 1000MF 20% 80V
923	*1-508-809-00	BASE POST (14MM) 2P	C363	1-126-370-11	ELECT 1000MF 20% 80V
924	*3-311-617-01	REINFORCEMENT, PCB	C370	1-124-748-11	ELECT 22MF 20% 100V
925	*1-560-242-21	BUS BAR 4P	C380	1-125-488-11	ELECT(BLOCK) 4700MF 20% 80V
926	1-559-512-11	(AEP,WG)...CORD (WITH CONNECTOR)	C381	1-162-282-11	(WG)...CERAMIC 100PF 10% 50V
927	Δ 1-569-007-11	(E3)...ADAPTOR, CONVERSION 2P	C401	1-107-169-00	MICA 100PF 5% 500V
C101	1-107-169-00	(WG)...MICA 100PF 5% 500V	C402	1-107-169-00	MICA 100PF 5% 500V
C102	1-126-059-11	ELECT 10MF 20% 50V	C403	1-126-359-11	ELECT 47MF 20% 80V
C103	1-107-169-00	(WG)...MICA 100PF 5% 500V	C404	1-126-359-11	ELECT 47MF 20% 80V
C104	1-124-915-11	ELECT 10MF 20% 63V	C405	1-130-471-00	MYLAR 0.001MF 5% 50V
C105	1-124-915-11	ELECT 10MF 20% 63V	C451	1-107-169-00	MICA 100PF 5% 500V
C106	1-124-713-11	ELECT 470MF 20% 35V	C452	1-107-169-00	MICA 100PF 5% 500V
C107	1-124-713-11	ELECT 470MF 20% 35V	C453	1-126-359-11	ELECT 47MF 20% 80V
C151	1-107-169-00	(WG)...MICA 100PF 5% 500V	C454	1-126-359-11	ELECT 47MF 20% 80V
C152	1-126-059-11	ELECT 10MF 20% 50V	C455	1-130-471-00	MYLAR 0.001MF 5% 50V
C153	1-107-169-00	(WG)...MICA 100PF 5% 500V	C505	1-130-801-11	FILM 3.3MF 10% 250V
C301	1-107-163-00	MICA 47PF 5% 500V	C506	1-130-955-00	FILM 0.01MF 10% 100V
C302	1-123-380-00	ELECT 1MF 20% 100V	C507	1-130-955-00	FILM 0.01MF 10% 100V
			C508	1-130-955-00	FILM 0.01MF 10% 100V
			C510	1-124-637-11	ELECT 1000MF 20% 50V

Note: The components identified by mark Δ or dotted line with mark Δ are critical for safety. Replace only with part number specified.

Ref.No.	Part No.	Description			
C511	1-124-791-11	ELECT	1MF	20%	50V
C512	1-130-955-00	FILM	0.01MF	10%	100V
C601	1-124-927-11	ELECT	4.7MF	20%	50V
C701A	1-106-343-00	MYLAR	0.001MF	10%	100V
C701	1-123-875-11	ELECT	10MF	20%	50V
C702	1-124-478-11	ELECT	100MF	20%	25V
C703	1-136-157-00	FILM	0.022MF	5%	50V
C704	1-124-927-11	ELECT	4.7MF	20%	50V
C705	1-126-024-11	ELECT	220MF	20%	25V
C706	1-124-910-11	ELECT	47MF	20%	50V
C707	1-124-791-11	ELECT	1MF	20%	50V
C751	1-123-875-11	ELECT	10MF	20%	50V
C801	1-130-857-00	FILM	0.047MF	5%	100V
C802	1-130-857-00	FILM	0.047MF	5%	100V
C804	1-106-343-00	(WG)...MYLAR	0.001MF	10%	100V
C805	1-106-343-00	(WG)...MYLAR	0.001MF	10%	100V
C851	1-130-857-00	FILM	0.047MF	5%	100V
C852	1-130-857-00	FILM	0.047MF	5%	100V
C854	1-106-343-00	(WG)...MYLAR	0.001MF	10%	100V
C855	1-106-343-00	(WG)...MYLAR	0.001MF	10%	100V
C901	1-161-741-00	CERAMIC	0.001MF	10%	400V
CN001	*1-564-321-00	PIN, CONNECTOR 2P			
CN101	*1-564-518-11	PLUG, CONNECTOR 3P			
CN102	*1-564-519-11	PLUG, CONNECTOR 4P			
CN103	*1-564-519-11	PLUG, CONNECTOR 4P			
CN104	*1-564-104-00	PIN, CONNECTOR 3P			
CN105	*1-564-507-11	PLUG, CONNECTOR 4P			
CN106	*1-564-509-11	PLUG, CONNECTOR 6P			
CN201	*1-564-507-11	PLUG, CONNECTOR 4P			
CN301	*1-564-505-11	PLUG, CONNECTOR 2P			
CN302	*1-564-505-11	PLUG, CONNECTOR 2P			
CN303	*1-564-506-11	PLUG, CONNECTOR 3P			
CN304	*1-564-506-11	PLUG, CONNECTOR 3P			
CN305	*1-564-506-11	PLUG, CONNECTOR 3P			
CN306	*1-564-506-11	PLUG, CONNECTOR 3P			
CN307	*1-564-506-11	PLUG, CONNECTOR 3P			
CN308	*1-564-506-11	PLUG, CONNECTOR 3P			
CN309	*1-564-508-11	PLUG, CONNECTOR 5P			
CN310	*1-564-507-11	PLUG, CONNECTOR 4P			
CN501	*1-564-509-11	PLUG, CONNECTOR 6P			
CN502	*1-564-241-00	PIN, CONNECTOR 4P			
CN503	*1-564-241-00	PIN, CONNECTOR 4P			
CN601	*1-564-505-11	PLUG, CONNECTOR 2P			
CN602	*1-564-505-11	PLUG, CONNECTOR 2P			
CN603	*1-564-506-11	PLUG, CONNECTOR 3P			
CN604	*1-564-507-11	PLUG, CONNECTOR 4P			
CN701	*1-564-505-11	PLUG, CONNECTOR 2P			
CN702	*1-564-508-11	PLUG, CONNECTOR 5P			
CN703	*1-564-508-11	PLUG, CONNECTOR 5P			
CN704	*1-564-508-11	PLUG, CONNECTOR 5P			
CN705	*1-564-509-11	PLUG, CONNECTOR 6P			
CN706	*1-564-506-11	PLUG, CONNECTOR 3P			
CN801	*1-564-241-00	PIN, CONNECTOR 4P			
CN802	*1-564-506-11	PLUG, CONNECTOR 3P			
CN901	*1-564-687-11	(E).....PIN, CONNECTOR 3P			
CN901	*1-565-792-11	(AEP,WG)...PIN, CONNECTOR 2P			
CN902	*1-564-321-00	PIN, CONNECTOR 2P			
CN903	*1-564-321-00	PIN, CONNECTOR 2P			

Ref.No.	Part No.	Description
CN904	*1-564-321-00	(AEP,WG)...PIN, CONNECTOR 2P
CN904	*1-564-687-11	(E).....PIN, CONNECTOR 3P
CN905	*1-564-506-11	(AEP,WG)...PLUG, CONNECTOR 3P
CN907	*1-569-625-11	(AEP,WG)...SOCKET, CONNECTOR 3P
D301	8-719-912-20	DIODE 1SS120
D302	8-719-912-20	DIODE 1SS120
D303	8-719-200-77	DIODE 10E2N
D304	8-719-933-41	DIODE HZS6C3L
D305	8-719-001-33	DIODE UZL-11L1
D306	8-719-300-04	DIODE SV-04
D307	8-719-300-04	DIODE SV-04
D308	8-719-200-77	DIODE 10E2N
D309	8-719-303-13	DIODE SEL1210W
D310	8-719-200-77	DIODE 10E2N
D311	8-719-942-31	DIODE HZ3ALL
D312	8-719-942-31	DIODE HZ3ALL
D353	8-719-200-77	DIODE 10E2N
D354	8-719-933-41	DIODE HZS6C3L
D355	8-719-001-33	DIODE UZL-11L1
D356	8-719-300-04	DIODE SV-04
D357	8-719-300-04	DIODE SV-04
D358	8-719-200-77	DIODE 10E2N
D359	8-719-303-13	DIODE SEL1210W
D360	8-719-200-77	DIODE 10E2N
D361	8-719-942-31	DIODE HZ3ALL
D362	8-719-942-31	DIODE HZ3ALL
D501	8-719-300-49	DIODE CTU-36S
D502	8-719-300-48	DIODE CTU-36R
D503	8-719-300-27	DIODE CTU-22S
D504	8-719-300-25	DIODE CTU-22R
D505	8-719-511-40	DIODE 11VB40
D507	8-719-200-77	DIODE 10E2N
D601	8-719-301-38	DIODE SEL2210S-C
D602	8-719-303-00	DIODE SEL2510C
D603	8-719-303-00	DIODE SEL2510C
D701	8-719-912-20	DIODE 1SS120
D702	8-719-912-20	DIODE 1SS120
D703	8-719-912-20	DIODE 1SS120
D704	8-719-912-20	DIODE 1SS120
D751	8-719-912-20	DIODE 1SS120
D752	8-719-912-20	DIODE 1SS120
D801	8-719-912-20	DIODE 1SS120
D802	8-719-912-20	DIODE 1SS120
F1	1-532-350-00	(AEP,WG)...FUSE, TIME-LAG
F2	1-532-350-00	(AEP,WG)...FUSE, TIME-LAG
F901	1-532-325-00	(E).....FUSE, TIME-LAG
F902	1-532-325-00	(E).....FUSE, TIME-LAG
IC101	8-759-604-28	IC M5238L
IC102	8-759-604-40	IC M5F78M15
IC103	8-759-604-46	IC M5F79M15
IC701	8-759-111-68	IC UPC1237HA
J1	1-580-060-11	RECEPTACLE, CONNECTOR 3P (FIXED IN L)
J2	1-566-880-21	JACK, PIN 4P (FIXED IN/VARIABLE IN)
J3	1-580-060-11	RECEPTACLE, CONNECTOR 3P (FIXED IN R)
L801	*1-422-009-13	COIL, AIR-CORE
L851	*1-422-009-13	COIL, AIR-CORE

Note: The components identified by mark  or dotted line with mark  are critical for safety. Replace only with part number specified.

Ref.No.	Part No.	Description
Q301	8-759-108-01	TRANSISTOR UPA68HA-M
Q302	8-729-203-45	TRANSISTOR 2SC3423-0
Q303	8-729-203-45	TRANSISTOR 2SC3423-0
Q304	8-729-699-51	TRANSISTOR 2SA995
Q305	8-729-104-18	TRANSISTOR 2SC3514-Q
Q306	8-729-201-56	TRANSISTOR 2SK246-GR2
Q307	8-729-201-56	TRANSISTOR 2SK246-GR2
Q308	8-729-209-17	TRANSISTOR 2SA1360-0
Q309	8-729-104-91	TRANSISTOR 2SA1383-Q
Q310	8-729-201-56	TRANSISTOR 2SK246-GR2
Q311	8-729-104-18	TRANSISTOR 2SC3514-Q
Q312	8-729-209-17	TRANSISTOR 2SA1360-0
Q313	8-729-203-45	TRANSISTOR 2SC3423-0
Q351	8-759-108-01	TRANSISTOR UPA68HA-M
Q352	8-729-203-45	TRANSISTOR 2SC3423-0
Q353	8-729-203-45	TRANSISTOR 2SC3423-0
Q354	8-729-699-51	TRANSISTOR 2SA995
Q355	8-729-104-18	TRANSISTOR 2SC3514-Q
Q356	8-729-201-56	TRANSISTOR 2SK246-GR2
Q357	8-729-201-56	TRANSISTOR 2SK246-GR2
Q358	8-729-209-17	TRANSISTOR 2SA1360-0
Q359	8-729-104-91	TRANSISTOR 2SA1383-Q
Q360	8-729-201-56	TRANSISTOR 2SK246-GR2
Q361	8-729-104-18	TRANSISTOR 2SC3514-Q
Q362	8-729-209-17	TRANSISTOR 2SA1360-0
Q363	8-729-203-45	TRANSISTOR 2SC3423-0
Q401	8-729-104-18	TRANSISTOR 2SC3514-Q
Q402	8-729-104-91	TRANSISTOR 2SA1383-Q
Q403	8-729-208-72	TRANSISTOR 2SC3298B-Y
Q404	8-729-208-38	TRANSISTOR 2SA1306A-0
Q405	8-729-303-89	TRANSISTOR 2SC3856-Y
Q406	8-729-303-86	TRANSISTOR 2SA1492-Y
Q407	8-729-303-89	TRANSISTOR 2SC3856-Y
Q408	8-729-303-86	TRANSISTOR 2SA1492-Y
Q409	8-729-303-89	TRANSISTOR 2SC3856-Y
Q410	8-729-303-86	TRANSISTOR 2SA1492-Y
Q451	8-729-104-18	TRANSISTOR 2SC3514-Q
Q452	8-729-104-91	TRANSISTOR 2SA1383-Q
Q453	8-729-208-72	TRANSISTOR 2SC3298B-Y
Q454	8-729-208-38	TRANSISTOR 2SA1306A-0
Q455	8-729-303-89	TRANSISTOR 2SC3856-Y
Q456	8-729-303-86	TRANSISTOR 2SA1492-Y
Q457	8-729-303-89	TRANSISTOR 2SC3856-Y
Q458	8-729-303-86	TRANSISTOR 2SA1492-Y
Q459	8-729-303-89	TRANSISTOR 2SC3856-Y
Q460	8-729-303-86	TRANSISTOR 2SA1492-Y
Q601	8-729-281-54	TRANSISTOR 2SC1815-BL
Q701	8-729-184-53	TRANSISTOR 2SC1845-EA
Q702	8-729-108-14	TRANSISTOR 2SA988-F
Q703	8-729-201-56	TRANSISTOR 2SK246-GR2
Q704	8-729-281-52	TRANSISTOR 2SC1815-Y
Q705	8-729-201-53	TRANSISTOR 2SA1015GR
Q706	8-729-201-53	TRANSISTOR 2SA1015GR
Q707	8-729-140-96	TRANSISTOR 2SD774-34
Q751	8-729-184-53	TRANSISTOR 2SC1845-EA
Q752	8-729-108-14	TRANSISTOR 2SA988-F

Ref.No.	Part No.	Description				
R101	1-246-545-00	CARBON	1M	5%	1/4W	
R102	1-247-713-11	(WG)...CARBON	1K	5%	1/4W	
R103	1-249-547-11	CARBON	620	5%	1/4W	
R104	1-249-547-11	CARBON	620	5%	1/4W	
R105	1-247-725-11	CARBON	10K	5%	1/4W	
R106	1-247-725-11	CARBON	10K	5%	1/4W	
R107	1-247-725-11	CARBON	10K	5%	1/4W	
R108	1-247-725-11	CARBON	10K	5%	1/4W	
R109	1-247-704-11	CARBON	220	5%	1/4W	
R110	1-249-469-11	CARBON	100K	5%	1/4W	
R111	1-247-713-11	(WG)...CARBON	1K	5%	1/4W	
R112	1-215-921-51	(AEP2)...METAL OXIDE	4.7K	5%	3W	F
R112	1-216-485-11	(EXCEPT AEP2) ...METAL OXIDE	5.6K	5%	3W	F
R113	1-215-921-51	(AEP2)...METAL OXIDE	4.7K	5%	3W	F
R113	1-216-485-11	(EXCEPT AEP2) ...METAL OXIDE	5.6K	5%	3W	F
R114	1-247-237-00	CARBON	750	5%	1/2W	F
R151	1-246-545-00	CARBON	1M	5%	1/4W	
R152	1-247-713-11	(WG)...CARBON	1K	5%	1/4W	
R153	1-249-547-11	CARBON	620	5%	1/4W	
R154	1-249-547-11	CARBON	620	5%	1/4W	
R155	1-247-725-11	CARBON	10K	5%	1/4W	
R156	1-247-725-11	CARBON	10K	5%	1/4W	
R157	1-247-725-11	CARBON	10K	5%	1/4W	
R158	1-247-725-11	CARBON	10K	5%	1/4W	
R159	1-247-704-11	CARBON	220	5%	1/4W	
R160	1-249-469-11	CARBON	100K	5%	1/4W	
R161	1-247-713-11	(WG)...CARBON	1K	5%	1/4W	
R201	1-247-718-11	CARBON	2.7K	5%	1/4W	
R251	1-247-718-11	CARBON	2.7K	5%	1/4W	
R301	1-247-713-11	CARBON	1K	5%	1/4W	
R302	1-249-497-11	CARBON	33K	5%	1/4W	
R303	1-249-725-11	CARBON	150K	5%	1/2W	
R304	1-249-556-11	CARBON	1.5K	5%	1/4W	
R305	1-249-717-11	CARBON	68K	5%	1/2W	
R306	1-247-719-11	CARBON	3.3K	5%	1/4W	
R307	1-247-704-11	CARBON	220	5%	1/4W	
R308	1-247-704-11	CARBON	220	5%	1/4W	
R310	1-249-520-11	CARBON	47	5%	1/4W	
R311	1-249-520-11	CARBON	47	5%	1/4W	
R312	1-247-721-11	CARBON	4.7K	5%	1/4W	
R313	1-249-556-11	CARBON	1.5K	5%	1/4W	
R314	1-249-784-11	CARBON	180	1%	1/2W	
R315	1-259-698-11	CARBON	8.2K	2%	1W	
R316	△ 1-219-022-11	FUSIBLE	100	5%	1/2W	F
R317	1-249-725-11	CARBON	150K	5%	1/2W	
R318	1-249-556-11	CARBON	1.5K	5%	1/4W	
R319	△ 1-219-022-11	FUSIBLE	100	5%	1/2W	F
R320	△ 1-247-710-11	CARBON	560	5%	1/4W	F
R321	1-247-719-11	CARBON	3.3K	5%	1/4W	
R322	△ 1-247-710-11	CARBON	560	5%	1/4W	F
R323	△ 1-219-022-11	FUSIBLE	100	5%	1/2W	F
R325	△ 1-219-022-11	FUSIBLE	100	5%	1/2W	F
R326	1-214-937-00	CARBON	1M	5%	1/2W	
R327	1-249-597-11	CARBON	75K	5%	1/4W	

Note: The components identified by mark **△** or dotted line with mark **△** are critical for safety. Replace only with part number specified.

Ref.No.	Part No.	Description			
R328	1-247-704-11	CARBON	220	5%	1/4W
R330	1-249-824-11	CARBON	8.2K	1%	1/2W
R351	1-247-713-11	CARBON	1K	5%	1/4W
R352	1-249-497-11	CARBON	33K	5%	1/4W
R353	1-249-725-11	CARBON	150K	5%	1/2W
R354	1-249-556-11	CARBON	1.5K	5%	1/4W
R355	1-249-717-11	CARBON	68K	5%	1/2W
R356	1-247-719-11	CARBON	3.3K	5%	1/4W
R357	1-247-704-11	CARBON	220	5%	1/4W
R358	1-247-704-11	CARBON	220	5%	1/4W
R360	1-249-520-11	CARBON	47	5%	1/4W
R361	1-249-520-11	CARBON	47	5%	1/4W
R362	1-247-721-11	CARBON	4.7K	5%	1/4W
R363	1-249-556-11	CARBON	1.5K	5%	1/4W
R364	1-249-784-11	CARBON	180	1%	1/2W
R365	1-259-698-11	CARBON	8.2K	2%	1W
R366	△1-219-022-11	FUSIBLE	100	5%	1/2W F
R367	1-249-725-11	CARBON	150K	5%	1/2W
R368	1-249-556-11	CARBON	1.5K	5%	1/4W
R369	△1-219-022-11	FUSIBLE	100	5%	1/2W F
R370	△1-247-710-11	CARBON	560	5%	1/4W F
R371	1-247-719-11	CARBON	3.3K	5%	1/4W
R372	△1-247-710-11	CARBON	560	5%	1/4W F
R373	△1-219-022-11	FUSIBLE	100	5%	1/2W F
R375	△1-219-022-11	FUSIBLE	100	5%	1/2W F
R376	1-214-937-00	CARBON	1M	5%	1/2W
R377	1-249-597-11	CARBON	75K	5%	1/4W
R378	1-247-704-11	CARBON	220	5%	1/4W
R401	△1-247-240-51	CARBON	1K	5%	1/2W F
R402	△1-219-022-11	FUSIBLE	100	5%	1/2W F
R403	△1-217-997-11	FUSIBLE	10	5%	1/2W F
R404	△1-217-997-11	FUSIBLE	10	5%	1/2W F
R405	△1-217-997-11	FUSIBLE	10	5%	1/2W F
R406	△1-217-997-11	FUSIBLE	10	5%	1/2W F
R407	△1-217-997-11	FUSIBLE	10	5%	1/2W F
R408	△1-217-997-11	FUSIBLE	10	5%	1/2W F
R409	△1-217-997-11	FUSIBLE	10	5%	1/2W F
R410	△1-217-997-11	FUSIBLE	10	5%	1/2W F
R411	1-217-152-00	RES, METAL PLATE	0.33		
R412	1-217-152-00	RES, METAL PLATE	0.33		
R413	1-217-152-00	RES, METAL PLATE	0.33		
R414	1-217-152-00	RES, METAL PLATE	0.33		
R415	1-217-152-00	RES, METAL PLATE	0.33		
R416	1-217-152-00	RES, METAL PLATE	0.33		
R417	1-247-696-11	CARBON	47	5%	1/4W F
R419	1-247-696-11	CARBON	47	5%	1/4W F
R421	1-247-696-11	CARBON	47	5%	1/4W F
R424	△1-217-997-11	FUSIBLE	10	5%	1/2W F
R425	△1-217-997-11	FUSIBLE	10	5%	1/2W F
R451	△1-247-240-51	CARBON	1K	5%	1/2W F
R452	△1-219-022-11	FUSIBLE	100	5%	1/2W F
R453	△1-217-997-11	FUSIBLE	10	5%	1/2W F
R454	△1-217-997-11	FUSIBLE	10	5%	1/2W F
R455	△1-217-997-11	FUSIBLE	10	5%	1/2W F
R456	△1-217-997-11	FUSIBLE	10	5%	1/2W F
R457	△1-217-997-11	FUSIBLE	10	5%	1/2W F
R458	△1-217-997-11	FUSIBLE	10	5%	1/2W F



Ref.No.	Part No.	Description			
R459	△1-217-997-11	FUSIBLE	10	5%	1/2W F
R460	△1-217-997-11	FUSIBLE	10	5%	1/2W F
R461	1-217-152-00	RES, METAL PLATE	0.33		
R462	1-217-152-00	RES, METAL PLATE	0.33		
R463	1-217-152-00	RES, METAL PLATE	0.33		
R464	1-217-152-00	RES, METAL PLATE	0.33		
R465	1-217-152-00	RES, METAL PLATE	0.33		
R466	1-217-152-00	RES, METAL PLATE	0.33		
R467	1-247-696-11	CARBON	47	5%	1/4W F
R469	1-247-696-11	CARBON	47	5%	1/4W F
R471	1-247-696-11	CARBON	47	5%	1/4W F
R474	△1-217-997-11	FUSIBLE	10	5%	1/2W F
R475	△1-217-997-11	FUSIBLE	10	5%	1/2W F
R501	1-247-721-11	CARBON	4.7K	5%	1/4W
R502	△1-219-010-11	FUSIBLE	33	5%	1/2W F
R503	△1-249-452-11	CARBON	2.7	5%	1/4W F
R601	1-247-725-11	CARBON	10K	5%	1/4W
R602	1-216-433-00	METAL OXIDE	1.2K	5%	1W F
R701	△1-212-998-00	FUSIBLE	470	5%	1/2W F
R701A	1-216-427-00	METAL OXIDE	120	5%	1W F
R702	△1-247-721-11	CARBON	4.7K	5%	1/4W F
R702A	1-216-427-00	METAL OXIDE	120	5%	1W F
R703	△1-247-721-11	CARBON	4.7K	5%	1/4W F
R703A	1-216-427-00	METAL OXIDE	120	5%	1W F
R704	1-249-497-11	CARBON	33K	5%	1/4W
R704A	1-216-427-00	METAL OXIDE	120	5%	1W F
R705	1-249-497-11	CARBON	33K	5%	1/4W
R706	1-249-497-11	CARBON	33K	5%	1/4W
R707	1-249-497-11	CARBON	33K	5%	1/4W
R708	1-247-719-11	CARBON	3.3K	5%	1/4W
R709	1-249-497-11	CARBON	33K	5%	1/4W
R710	1-246-531-00	CARBON	270K	5%	1/4W
R711	1-215-863-11	METAL OXIDE	100	5%	1W F
R712	1-249-460-11	CARBON	15K	5%	1/4W
R713	1-249-469-11	CARBON	100K	5%	1/4W
R714	1-247-725-11	CARBON	10K	5%	1/4W
R716	1-249-556-11	CARBON	1.5K	5%	1/4W
R717	1-247-887-00	CARBON	220K	5%	1/4W
R718	1-247-717-11	CARBON	2.2K	5%	1/4W
R719	1-247-725-11	CARBON	10K	5%	1/4W
R720	1-249-462-11	CARBON	22K	5%	1/4W
R721	1-249-465-11	CARBON	47K	5%	1/4W
R722	1-249-465-11	CARBON	47K	5%	1/4W
R723	1-249-673-11	CARBON	1K	5%	1/2W
R724	1-249-662-11	CARBON	360	5%	1/2W
R726	1-249-517-11	CARBON	36	5%	1/4W
R728	1-247-721-11	CARBON	4.7K	5%	1/4W
R729	1-247-703-11	CARBON	180	5%	1/4W
R751	△1-212-998-00	FUSIBLE	470	5%	1/2W F
R752	△1-247-721-11	CARBON	4.7K	5%	1/4W F
R753	△1-247-721-11	CARBON	4.7K	5%	1/4W F
R754	1-249-497-11	CARBON	33K	5%	1/4W
R755	1-249-497-11	CARBON	33K	5%	1/4W
R756	1-249-497-11	CARBON	33K	5%	1/4W
R757	1-249-497-11	CARBON	33K	5%	1/4W
R758	1-247-719-11	CARBON	3.3K	5%	1/4W

Note: The components identified by mark △ or dotted line with mark △ are critical for safety. Replace only with part number specified.

Ref.No.	Part No.	Description
R759	1-249-497-11	CARBON 33K 5% 1/4W
R760	1-247-891-00	CARBON 330K 5% 1/4W
R801	1-247-727-11	CARBON 10 5% 1/2W
R802	1-216-420-11	METAL OXIDE 8.2 5% 5W F
R804	1-247-727-11	(WG)...CARBON 10 5% 1/2W
R805	1-247-727-11	(WG)...CARBON 10 5% 1/2W
R851	1-247-727-11	CARBON 10 5% 1/2W
R852	1-216-420-11	METAL OXIDE 8.2 5% 5W F
R854	1-247-727-11	(WG)...CARBON 10 5% 1/2W
R855	1-247-727-11	(WG)...CARBON 10 5% 1/2W
RT302	1-224-248-XX	RES, ADJ, SOLID 470
RT352	1-224-248-XX	RES, ADJ, SOLID 470
RT401	1-224-550-21	RES, ADJ, SOLID 220
RT451	1-224-550-21	RES, ADJ, SOLID 220
RV201	1-237-849-11	RES, VAR, CARBON 20K (ATTENUATOR L)
RV251	1-237-849-11	RES, VAR, CARBON 20K (ATTENUATOR R)
RY801	1-515-703-11	RELAY
RY802	1-515-703-11	RELAY
RY901	△ 1-515-617-11	(EXCEPT E)...RELAY
S1	△ 1-554-538-00	SWITCH, PUSH (AC POWER)(1 KEY)
S101	1-516-785-XX	SLIDE SWITCH (OPERATION)
S102	1-516-785-XX	SLIDE SWITCH (INPUT SELECTOR)
S601	1-572-424-11	SWITCH, PUSH (2 KEY)(INPUT)
S701	1-572-425-11	SWITCH, ROTARY (SPEAKERS)
S901	1-572-009-11	(E)...SELECTOR, VOLTAGE
T1	△ 1-450-177-11	(E).....TRANSFORMER, POWER
T1	△ 1-450-179-11	(AEP1,WG)...TRANSFORMER, POWER
T1	△ 1-450-181-11	(AEP2).....TRANSFORMER, POWER
T2	△ 1-450-178-11	(AEP1,WG)...TRANSFORMER, POWER
T2	△ 1-450-180-11	(AEP2).....TRANSFORMER, POWER
TM901	1-537-102-11	TERMINAL BOARD (SP)
TM902	1-537-102-11	TERMINAL BOARD (SP)

ACCESSORY & PACKING MATERIAL

1-575-952-11	(AEP,WG)...CABLE (WITH CONNECTOR)
3-752-341-11	(AEP,E)...MANUAL, INSTRUCTION (ENGLISH, FRENCH, SPANISH, PORTUGUESE)
3-752-341-41	(AEP,WG)...MANUAL, INSTRUCTION (DUTCH, SWEDISH, ITALIAN)
4-921-404-01	CUSHION
*4-941-754-01	INDIVIDUAL CARTON

Note: The components identified by mark  or dotted line with mark  are critical for safety. Replace only with part number specified.

TA-N80ES

SONY[®] SERVICE MANUAL

*AEP Model
E Model*

SUPPLEMENT-1

File this supplement with the service manual.

The gold color version is added to the TA-N80ES(AEP model) released lately, and therefore only the added parts are described. For the other parts, see TA-N80ES Service Manual(9-956-025-11).

SECTION 5 EXPLODED VIEWS (Service Manual See page 21~24)

(1) CABINET SECTION (Service Manual See page 21)

<u>Ref.No.</u>	<u>Part No.</u>	<u>Description</u>	<u>Remark</u>
1	A-4325-257-A	PANEL ASSY, FRONT	
4	4-942-032-11	KNOB (POWER)	
6	4-933-031-11	KNOB	
7	4-931-926-11	BUTTON (B)	
8	4-933-032-11	KNOB	
10	X-4941-848-1	PANEL (L) ASSY, SIDE	
11	X-4941-849-1	PANEL (R) ASSY, SIDE	
16	4-921-434-41	PLATE, TOP (AEP)	
16	4-921-434-51	PLATE, TOP (G)	

(4) BACK CHASSIS SECTION (Service Manual See page 24)

<u>Ref.No.</u>	<u>Part No.</u>	<u>Description</u>	<u>Remark</u>
151	X-4941-860-1	CHASSIS ASSY, MAIN	
157	* 4-933-030-31	PANEL, BACK	
159	* 4-923-873-11	BRACKET, CORD STOPPER	

SECTION 6 ELECTRICAL PARTS LIST (Service Manual See page 26)

<u>Ref.No.</u>	<u>Part No.</u>	<u>Description</u>	<u>Remark</u>
D602	8-719-301-52	LED SEL2810A-C (STEREO)	
D603	8-719-301-52	LED SEL2810A-C (MONO)	

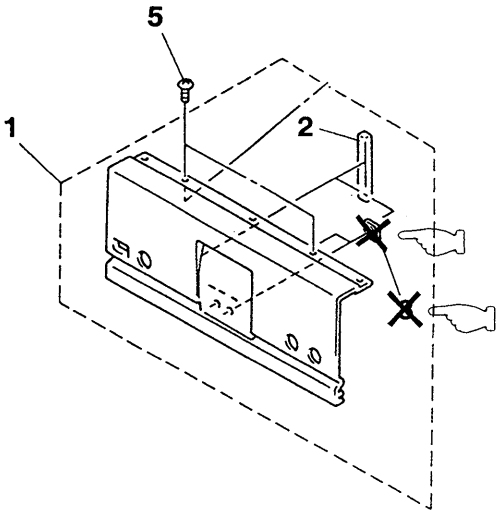

SECTION 5 EXPLODED VIEWS

(1) CABINET SECTION (Service Manual See page 21)





No.	Part No.	Description	Remarks
	3	4-931-928-01	ESCUTCHEON (C), KNOB

(2) MAIN CHASSIS SECTION (Service Manual See page 22)

No.	Part No.	Description	Remarks
	75	7-682-662-09	SCREW + PSW 4×10 (AEP)
	918	1-535-139-00	BASE POST (10MM PITCH) 2P

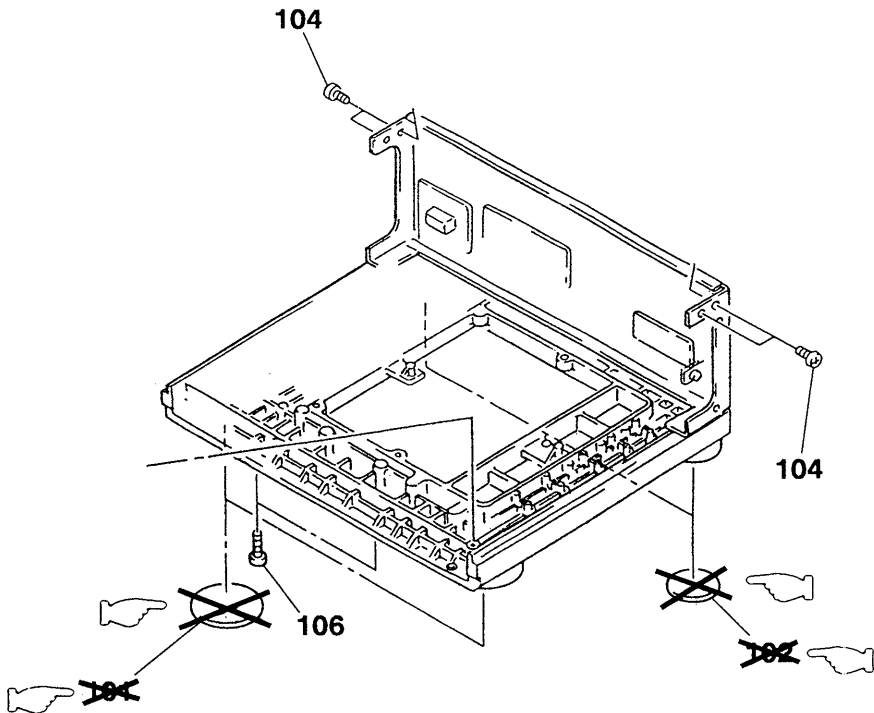
(3) FRONT CHASSIS SECTION (Service Manual See page 23)



No.	Part No.	Description	Remarks
	101	4-916-704-11	FOOT
	102	4-916-704-01	FOOT

(4) BACK CHASSIS SECTION (Service Manual See page 24)

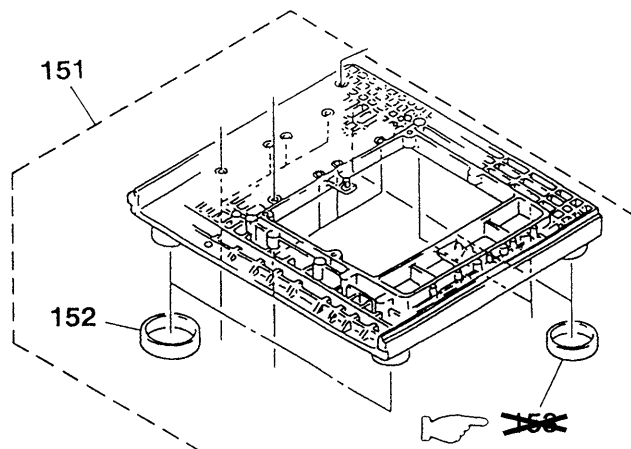

No.	Part No.	Description	Remarks
-----	----------	-------------	---------

	153	4-923-883-02	RING (SMALL-14) ORNAMENTAL, FOOT
--	----------------	-------------------------	---

SECTION 6 ELECTRICAL PARTS LIST

<u>Ref.No.</u>	<u>Part No.</u>	<u>Description</u>				
918	1-535-139-00	BASE POST 14MM(10MM)PITCH 2P				
C304	1-107-159-00	MICA	33PF	5%	500V	} (Service Manual See page 25)
C305	1-107-210-00	MICA	22PF	5%	500V	
C354	1-107-159-00	MICA	33PF	5%	500V	
C355	1-107-210-00	MICA	22PF	5%	500V	
C405	1-136-165-00	FILM	0.1MF	5%	50V	
C455	1-136-165-00	FILM	0.1MF	5%	50V	} (Service Manual See page 26)
C511	1-124-903-11	ELECT	1MF	20%	50V	
C701	1-124-907-11	ELECT	10MF	20%	50V	
C707	1-124-903-11	ELECT	1MF	20%	50V	
C751	1-124-907-11	ELECT	10MF	20%	50V	
CN001	* 1-565-792-11	PIN, CONNECTOR 2P				
Q702	8-729-108-14	TRANSISTOR		2SA988-PAFAEA		} (Service Manual See page 27)
Q752	8-729-108-14	TRANSISTOR		2SA988-PAFAEA		

TA-N80ES

SONY[®] SERVICE MANUAL

*AEP Model
E Model*

CORRECTION-1

Correct your service manual as shown below.

____ (Under line) : indicates corrected portion.

Page	INCORRECT			CORRECT		
29	<u>Ref. No.</u>	<u>Part No.</u>	<u>Description</u>	<u>Ref. No.</u>	<u>Part No.</u>	<u>Description</u>
	_____	_____	_____	<u>RY301</u>	<u>1-515-614-11</u>	<u>RELAY</u>
	_____	_____	_____	<u>RY302</u>	<u>1-515-614-11</u>	<u>RELAY</u>

(RPC-96018)