

Notes:  
Material: 709° [18mm] Plywood  
Width, ext.: 22° [559mm]  
(dimensions in inch/mm)

LengthS1=3.613  
LengthS2=3.630  
LengthS3=6.000  
LengthS4=15.191  
LengthS5=18.250

L12=7.015  
L23=46.839  
L34=33.680  
L45=6.410

4pyros\_2011\_Mar08.dwg

Redrow of Mod\_SS15, by 4pyros, Mar 08, 2011

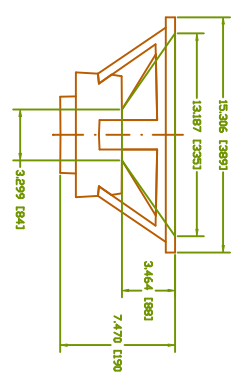

Volume of cone=207in^3

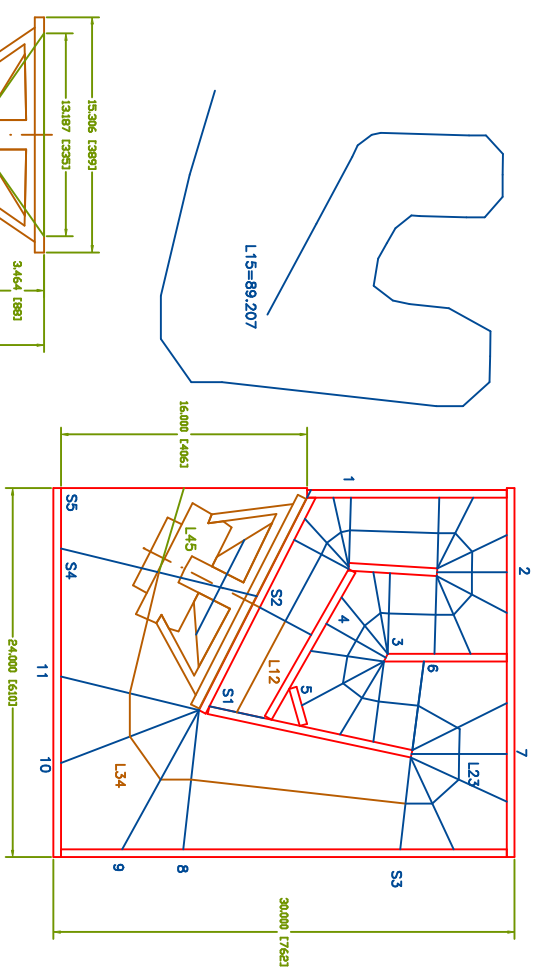

LengthS1=3.624  
LengthS2=3.791  
LengthS3=6.010  
LengthS4=13.111  
LengthS5=16.0(16.26)

L12=6.726  
L23=46.406  
L34=30.365  
L45=5.711

Drawing revised using sabo54's corner method.  
From: jbelia\_singleSheet\_new\_2010\_Aug18.dwg

