

- Note:**
- All capacitors are in μF unless otherwise noted, pF : μpF 50WV or less are not indicated except for electrolytics and tantalums.
 - All resistors are in Ω and $\frac{1}{4}\text{W}$ or less unless otherwise specified.
 - \triangle : internal component.









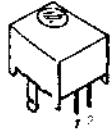
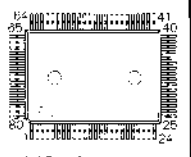
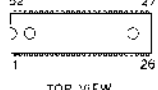

Note: The components identified by shading and mark \triangle are critical for safety. Replace only with part number specified.

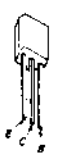
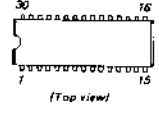
• Switch

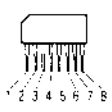
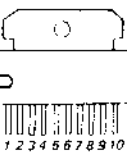
Ref. No.	Switch	Position
S251	LOADING	IN
S252	LIMIT IN	OFF
S801	KEY MATRIX	OFF
S830		
S832		
S839		
S841		
S842	POWER	STANDBY
S851		

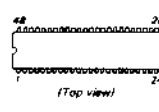
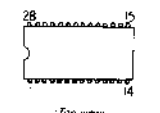
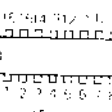
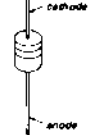
- All $\frac{1}{32}\text{W}$ or $\frac{1}{64}\text{W}$ resistors are printed resistors.
- --- : B+ Line
- --- : B- Line
- --- : adjustment for repair.
- Voltage and waveforms are dc with respect to ground under no-signal conditions.
- no mark : STOP
- () : PLAY
- Voltages are taken with a VOM (50 $\text{k}\Omega/\text{V}$).
- Voltage variations may be noted due to normal production tolerances.
- Waveforms are taken with a oscilloscope.
- Voltage variations may be noted due to normal production tolerances.
- Signal path.
- --- : CD
- --- : digital out

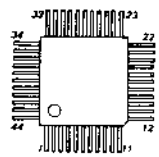
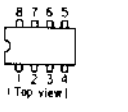
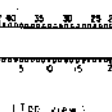
● Semiconductor Lead Layouts

BX-1387 	CXD1125Q CXP5058H-068Q  <small>BACK SIDE VIEW</small>	M50740A-424SP  <small>TOP VIEW</small>	NJM4556S 	2SB1013 	HZS4.3NB3 HZS9B2L 
CXA1081S  <small>(Top view)</small>	LA6520  <small>(Top View)</small>	M5230L-A 	TA7256P 	2SB1014 	10E2N 1SS132  <small>cathode</small> <small>anode</small>
CXA1182S  <small>(Top view)</small>	LC9600R-14S TDA1541-N5  <small>(Top view)</small>	M5290P-16  <small>(Top view)</small>	2SA134S 2SA1348 2SC3399 2SC3402 2SC3623TP-L  <small>cathode</small> <small>anode</small>	2SB1274SA 2SD1913SA 	
CXD1088Q 	M5219P M74HC6004P NJM4560D-D  <small>(Top view)</small>	MSM6408-26SS  <small>(Top view)</small>	2SB734 	2SC2021 	

● Circuit Boards Location

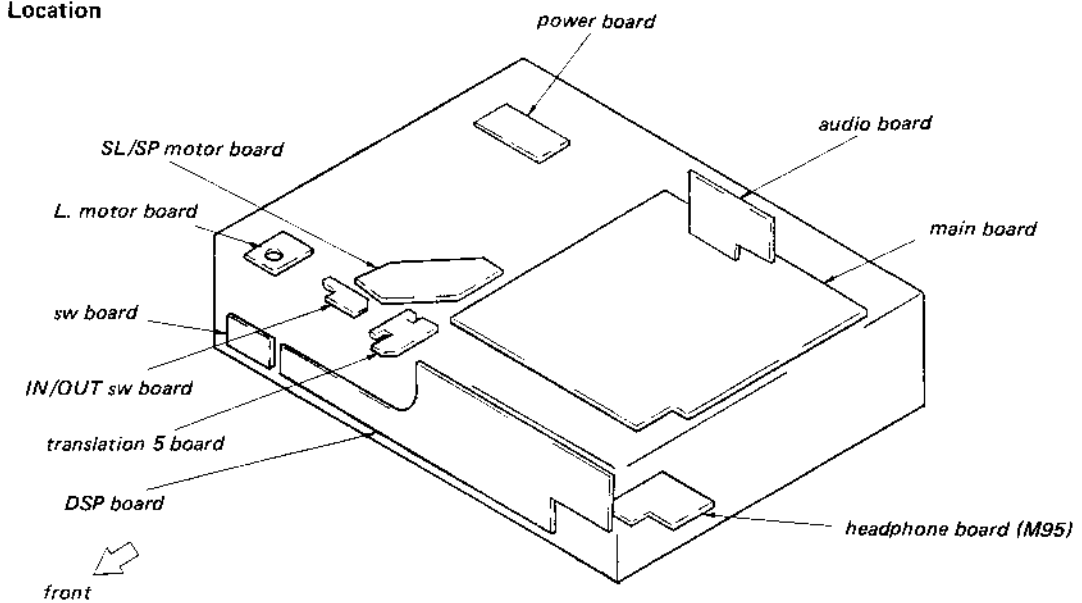



SECTION 3

EXPLODED VIEWS AND PARTS LIST

NOTE:

- The mechanical parts with no reference number in the exploded views are not supplied.
- The construction parts of an assembled part are indicated with a collation number in the remark column.
- Items marked "*" are not stocked since they are seldom required for routine service. Some delay should be anticipated when ordering these items.

- Due to standardization, parts with part number suffix -XX and -X may be different from the parts specified in the components used on the set.
- Color Indication of Appearance Parts
Example:
(RED)...KNOB, BALANCE (WHITE)
↑ Cabinet's Color ↑ Parts Color

The components identified by mark  or dotted line with mark  are critical for safety. Replace only with part number specified.

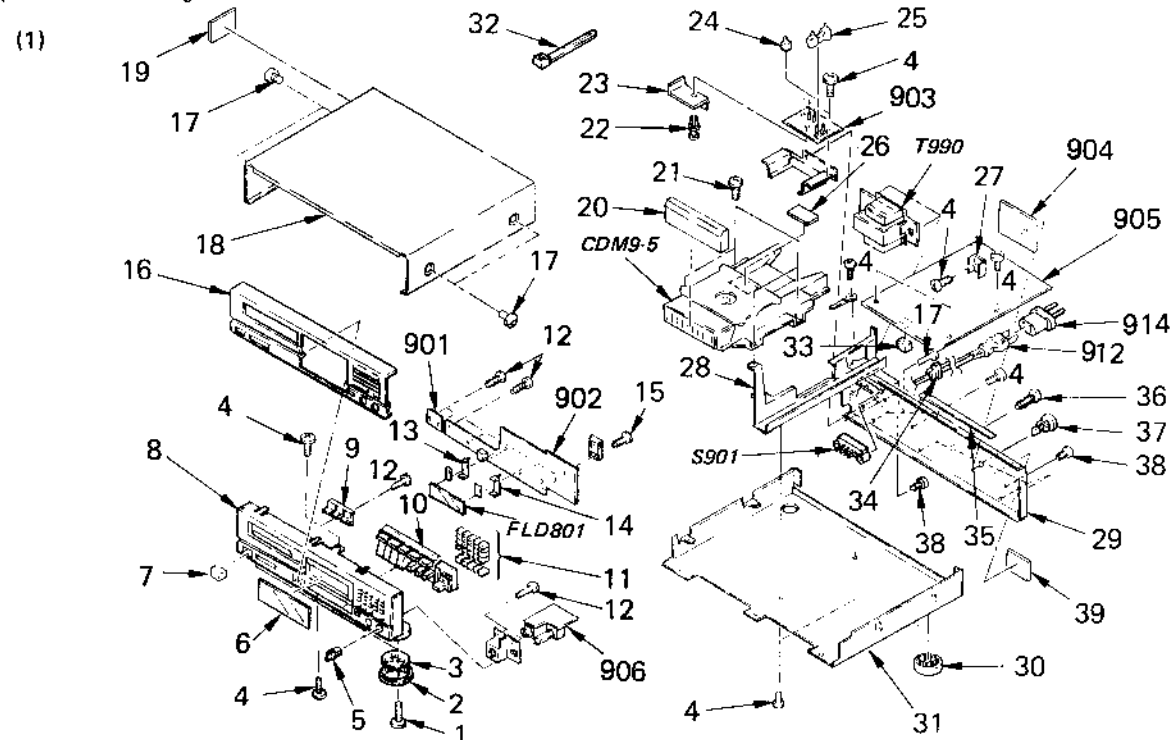

No.	Part No.	Description	Remarks	No.	Part No.	Description	Remarks
1	3-703-685-21	SCREW (+BV 3X8)		30	X-4922-001-1	FOOT ASSY	
2	4-921-918-11	PLATE, ORNAMENTAL		31	*4-921-903-51	CHASSIS	
3	4-921-906-01	FELT		32	3-655-653-21	BAND (TALTON), BINDING	
4	7-682-547-09	SCREW +BVTT 3X6 (S)		33	9-911-843-XX	RUBBER, CUSHION	
5	4-901-708-11	KNOB, LOW		34	*3-703-571-12	BUSHING (2104), CORD	
6	4-922-636-01	WINDOW		35	9-911-835-XX	CUSHION, F	
7	4-922-903-01	BUTTON (PW)		36	4-922-647-01	SCREW (PIN JACK) (M3X12)	
8	*X-4917-541-1	PANEL (BASE) ASSY	3	37	*4-912-181-21	SUPPORT, PC	
9	4-922-638-01	BUTTON (R)		38	7-685-646-79	SCREW +BVTP 3X8 TYPE2 N-S	
10	X-4917-542-1	BUTTON ASSY		39	*4-885-838-00	LABEL, CLASS 1	
11	4-922-639-11	BUTTON (MC)		40	3-703-079-21	(UK)...LABEL, CAUTION (BACK)	
12	7-685-134-19	SCREW +BTP 2.6X8 TYPE2 N-S		901	*1-625-980-11	PC BOARD, SW (PRC)	
13	*4-922-524-01	HOLDER (LEFT)		902	*1-625-978-11	PC BOARD, DISPLAY (PRC)	
14	*4-922-523-01	HOLDER (RIGHT)		903	*1-625-979-11	PC BOARD, POWER (PRC)	
15	7-685-537-19	SCREW +BTP 2.6X14 TYPE2 N-S		904	*1-625-981-11	PC BOARD, AUDIO	
16	*X-4917-548-1	PANEL ASSY, FRONT		905	*A-4651-139-A	MOUNTED PCB, MAIN	
17	3-704-366-01	SCREW (CASE) (M3X8)		906	*1-625-982-11	PC BOARD, HEADPHONE	
18	4-919-376-01	CASE		912	△1-551-188-XX	(E)....CORD, POWER	
19	3-703-079-21	{(UK)...LABEL (BACK), SUB CAUTION			△1-555-795-00	(AEP)...CORD, POWER, EULO PLUG	
20	4-922-635-21	PANEL (LOADING)			△1-556-035-00	(UK)...CORD, POWER	
21	7-682-548-04	SCREW +BVTT 3X8 (S)		913	*1-624-325-11	PC BOARD, TRANSLATION 5	
22	3-531-576-11	RIVET		914	△1-526-565-00	(E)...AC PLUG ADAPTOR	
23	4-922-632-01	SHEET, INSULATING		FLD801	1-519-428-21	INDICATOR TUBE, FLUORESCENT	
24	*4-912-962-01	COVER (1P), TERMINAL		S901	△1-570-046-21	(E)...SWITCH, VOLTAGE CHANGE	
25	*4-912-963-01	COVER (2P), TERMINAL		T990	△1-449-210-11	(AEP,UK)...TRANSFORMER, POWER	
26	4-885-843-02	LABEL, CAUTION, LASER		T990	△1-449-238-11	(E).....TRANSFORMER, POWER	
27	*4-854-790-00	HEAT SINK					
28	*4-922-911-01	CHASSIS (R)					
29	*4-922-642-21	(AEP)...PANEL, BACK					
	*4-922-642-31	(UK)...PANEL, BACK					
	*4-922-642-41	(E)....PANEL, BACK					

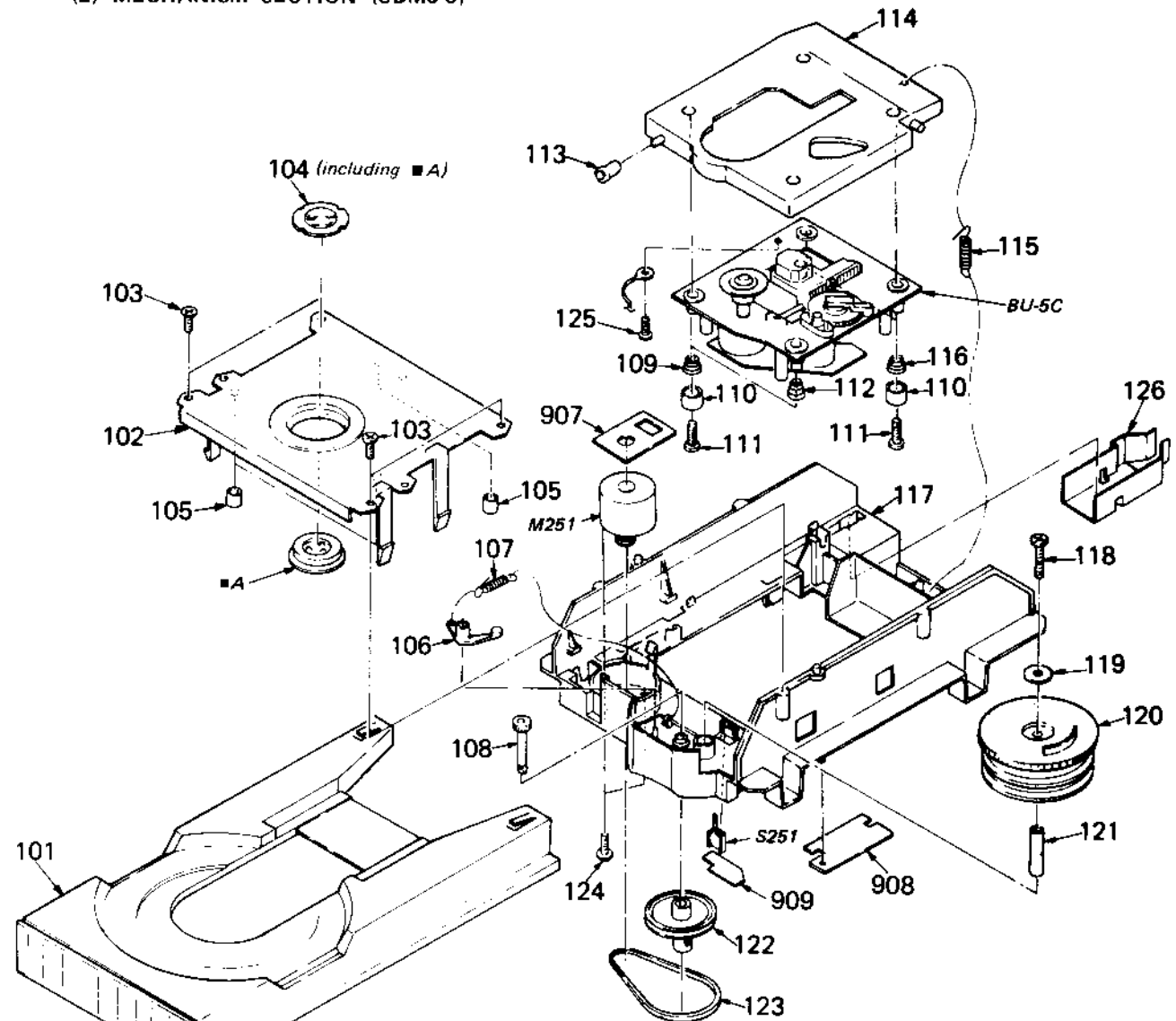
(2) MECHANISM SECTION (CDM9-5)

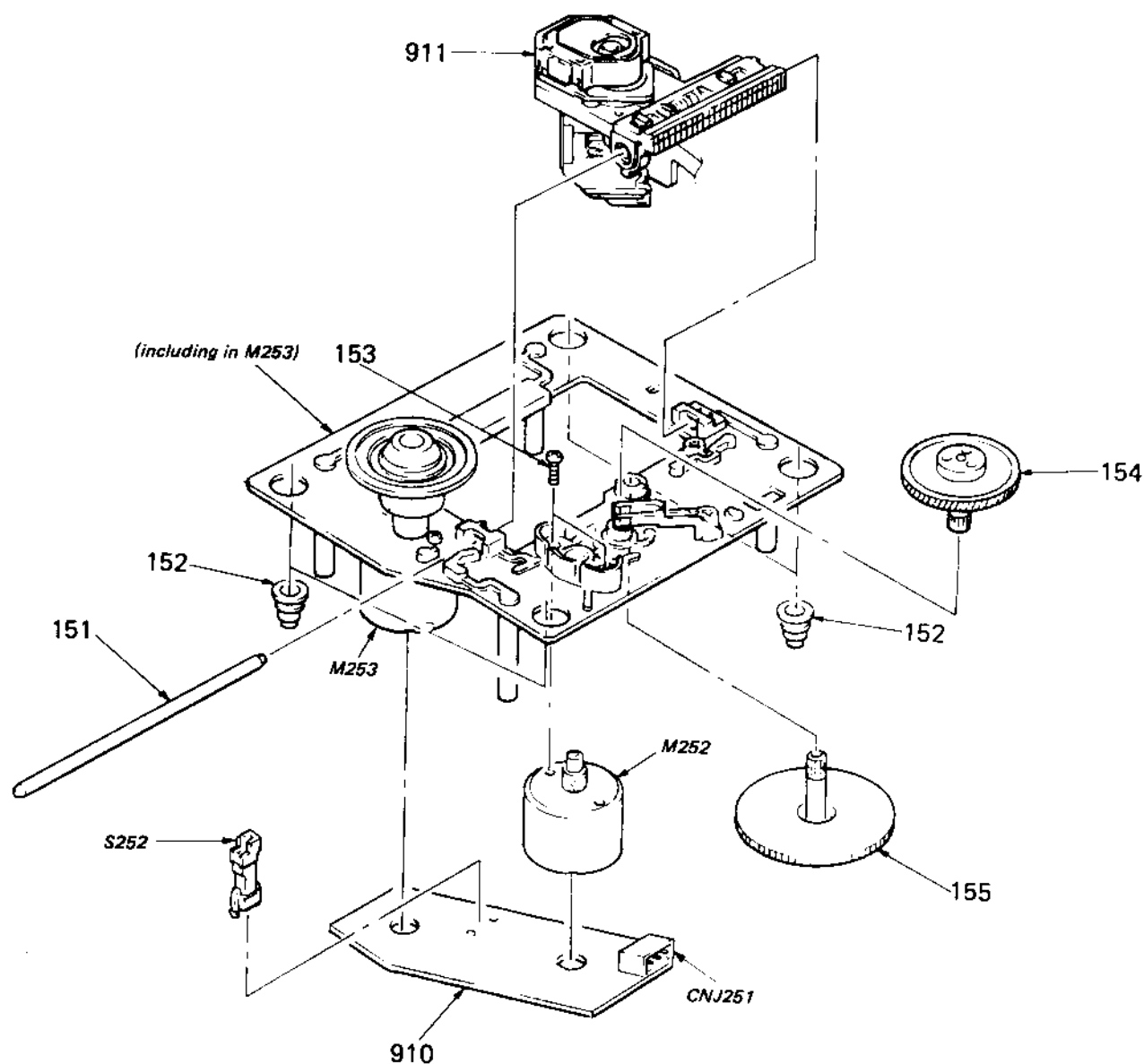

No.	Part No.	Description	Remarks	No.	Part No.	Description	Remarks
101	*4-922-515-01	TABLE, DISK		116	4-917-507-01	SPRING (H)	
102	*4-922-510-01	REINFORCEMENT		117	*4-922-516-01	CHASSIS (MD)	
103	7-685-646-79	SCREW +BTP 3X8 TYPE2 N-S		118	7-685-552-19	SCREW +BTP 3X25 TYPE2 N-S	
104	A-4665-012-C	MAGNET ASSY		119	0-056-028-00	WASHER, PLAIN, 14 DIA.	
105	*3-576-990-01	CUSHION		120	4-922-511-01	GEAR (LOADING)	
106	4-917-519-01	LEVER, SET		121	*4-917-523-01	COLLAR, CAM	
107	4-917-514-01	SPRING, TENSION		122	4-922-512-01	PULLEY	
108	4-922-508-01	GEAR (DRIVING)		123	4-917-522-01	BELT	
109	4-917-541-01	SPRING (B)		124	7-621-759-40	+PSW, 2.6X6	
110	4-917-508-01	HOLDER, SP		125	7-621-770-67	SCREW +BVTT 2.6X6 (S)	
111	7-685-535-19	SCREW +BTP 2.6X10 TYPE2 N-S		126	4-923-541-11	SPRING	
112	4-918-669-01	SPRING (W)		907	*1-624-324-11	PC BOARD, L.MOTOR	
113	4-917-515-01	ROLLER		908	*1-624-325-11	PC BOARD, TRANSLATION 5	
114	*4-922-514-01	BRACKET (BU-5)		909	*1-624-323-11	PC BOARD, IN/OUT SW	
115	4-917-526-01	SPRING, TENSION		M251	A-4608-346-A	MOTOR ASSY, L	
				S251	1-571-300-11	SWITCH, ROTARY (LOADING IN/OUT)	

(3) OPTICAL PICK-UP BLOCK (BU-5C)



No.	Part No.	Description
151	4-917-565-01	SHAFT, SLED
152	4-917-562-01	INSULATOR
153	7-621-255-15	SCREW +P 2X3
154	4-917-567-01	GEAR (M)
155	4-917-564-01	GEAR (P), FLATNESS

No.	Part No.	Description	Remarks
910	*1-624-322-11	PC BOARD, SL/SP MOTOR	
911	Δ 8-848-062-01	DEVICE, OPTICS (KSS-150A)	
CNJ251	*1-564-720-21	PIN, CONNECTOR (SMALL TYPE) 4P	
M252	X-4917-504-1	ASSY, MOTOR (SLED)	
M253	X-4917-523-1	ASSY, MOTOR (SPINDLE)	
S252	1-571-274-11	SWITCH, LEAF (LIMIT IN)	

Note: The components identified by mark  or dotted line with mark  are critical for safety. Replace only with part number specified.

SECTION 4

ELECTRICAL PARTS LIST

NOTE:

- Due to standardization, replacements in the parts list may be different from the parts specified in the diagrams or the components used on the set.
- Items marked "*" are not stocked since they are seldom required for routine service. Some delay should be anticipated when ordering these items.
- If there are two or more same circuits in a set such as a stereophonic machine, only typical circuit parts may be indicated and capacitors and resistors in other same circuits may be omitted.

CAPACITORS:MF: μ F, PF: μ F.**RESISTORS**

- All resistors are in ohms.
- F: nonflammable

COILS

- MMH: mH, UH: μ H

SEMICONDUCTORSIn each case, U: μ , for example:UA...: μ A..., UPA...: μ PA...,UPC...: μ PC, UPD...: μ PD...

The components identified by mark Δ or dotted line with mark Δ are critical for safety. Replace only with part number specified.

Ref.No.	Part No.	Description					Ref.No.	Part No.	Description				
901	*1-625-980-11	PC BOARD, SW (PRC)					C215	1-123-875-11	ELECT	10MF	20%	50V	
902	*1-625-978-11	PC BOARD, DISPLAY (PRC)					C217	1-136-165-00	FILM	0.1MF	5%	50V	
903	*1-625-979-11	PC BOARD, POWER (PRC)					C218	1-123-382-00	ELECT	3.3MF	20%	50V	
904	*1-625-981-11	PC BOARD, AUDIO					C219	1-136-159-00	FILM	0.033MF	5%	50V	
905	*A-4651-189-A	MOUNTED PCB, MAIN					C220	1-136-165-00	FILM	0.1MF	5%	50V	
906	*1-625-982-11	PC BOARD, HEADPHONE					C221	1-130-479-00	MYLAR	0.0047MF	5%	50V	
907	*1-624-324-11	PC BOARD, L.MOTOR					C222	1-124-499-11	ELECT	1MF	20%	50V	
909	*1-624-323-11	PC BOARD, IN/OUT SW					C223	1-124-927-11	ELECT	4.7MF	20%	50V	
910	*1-626-304-11	PC BOARD, SL/SP MOTOR					C224	1-124-477-11	ELECT	47MF	20%	16V	
911	Δ 8-848-062-01	PICKUP, OPTICS KSS-150A					C225	1-162-294-31	CERAMIC	0.001MF	10%	50V	
912	Δ 1-551-188-XX	(E)....CORD, POWER					C226	1-162-282-31	CERAMIC	100PF	10%	50V	
	Δ 1-555-795-00	(AEP)....CORD, POWER, EULO PLUG					C227	1-124-908-11	ELECT	22MF	20%	25V	
	Δ 1-556-035-00	(UK)....CORD, POWER					C228	1-162-851-11	CERAMIC	0.1MF	20%	16V	
913	*1-624-325-11	PC BOARD, TRANSLATION 5					C231	1-124-908-11	ELECT	22MF	20%	25V	
914	Δ 1-526-565-00	(E)....AC PLUG ADAPTOR					C251	1-136-157-00	FILM	0.022MF	5%	50V	
C101	1-162-294-31	CERAMIC	0.001MF	10%	50V		C252	1-106-351-00	MYLAR	0.0022MF	5%	50V	
C102	1-124-443-00	ELECT	100MF	20%	10V		C253	1-106-351-00	MYLAR	0.0022MF	5%	50V	
C103	1-162-199-31	CERAMIC	10PF	5%	50V		C301	1-161-375-00	CERAMIC	0.0022MF	30%	16V	
C104	1-162-199-31	CERAMIC	10PF	5%	50V		C302	1-124-908-11	ELECT	22MF	20%	25V	
C105	1-162-198-31	CERAMIC	8.2PF	10%	50V		C303	1-161-379-00	CERAMIC	0.01MF	30%	16V	
C106	1-124-477-11	ELECT	47MF	20%	16V		C304	1-124-902-00	ELECT	0.47MF	20%	50V	
C107	1-161-375-00	CERAMIC	0.0022MF	30%	16V		C305	1-136-159-00	FILM	0.033MF	5%	50V	
C108	1-136-159-00	FILM	0.033MF	5%	50V		C306	1-124-908-11	ELECT	22MF	20%	25V	
C109	1-162-851-11	CERAMIC	0.1MF	20%	16V		C307	1-162-851-11	CERAMIC	0.1MF	20%	16V	
C110	1-124-908-11	ELECT	22MF	20%	25V		C351	1-161-379-00	CERAMIC	0.01MF	30%	16V	
C111	1-136-159-00	FILM	0.033MF	5%	50V		C353	1-124-908-11	ELECT	22MF	20%	25V	
C112	1-136-153-00	FILM	0.01MF	5%	50V		C354	1-124-908-11	ELECT	22MF	20%	25V	
C113	1-124-908-11	ELECT	22MF	20%	25V		C361	1-161-494-00	CERAMIC	0.022MF		25V	
C114	1-162-851-11	CERAMIC	0.1MF	20%	16V		C380	1-124-908-11	ELECT	22MF	20%	25V	
C115	1-161-375-00	CERAMIC	0.0022MF	30%	16V		C381	1-162-282-31	CERAMIC	100PF	10%	50V	
C116	1-161-377-00	CERAMIC	0.0047MF	30%	16V		C390	1-124-908-11	ELECT	22MF	20%	25V	
C117	1-124-902-00	ELECT	0.47MF	20%	50V		C391	1-162-851-11	CERAMIC	0.1MF	20%	16V	
C200	1-161-379-00	CERAMIC	0.01MF	30%	16V		C400	1-162-851-11	CERAMIC	0.1MF	20%	16V	
C201	1-126-101-11	ELECT	100MF	20%	16V		C401	1-162-851-11	CERAMIC	0.1MF	20%	16V	
C202	1-126-101-11	ELECT	100MF	20%	16V		C402	1-162-851-11	CERAMIC	0.1MF	20%	16V	
C203	1-162-851-11	CERAMIC	0.1MF	20%	16V		C403	1-162-851-11	CERAMIC	0.1MF	20%	16V	
C204	1-162-851-11	CERAMIC	0.1MF	20%	16V		C404	1-162-851-11	CERAMIC	0.1MF	20%	16V	
C205	1-162-294-31	CERAMIC	0.001MF	10%	50V		C405	1-162-851-11	CERAMIC	0.1MF	20%	16V	
C206	1-162-294-31	CERAMIC	0.001MF	10%	50V		C406	1-162-851-11	CERAMIC	0.1MF	20%	16V	
C207	1-162-851-11	CERAMIC	0.1MF	20%	16V		C407	1-130-474-00	MYLAR	0.0018MF	5%	50V	
C208	1-136-169-00	FILM	0.22MF	5%	50V		C408	1-130-484-00	MYLAR	0.012MF	5%	50V	
C210	1-162-851-11	CERAMIC	0.1MF	20%	16V		C409	1-130-478-00	MYLAR	0.0039MF	5%	50V	
C211	1-162-851-11	CERAMIC	0.1MF	20%	16V		C410	1-130-474-00	MYLAR	0.0018MF	5%	50V	
C212	1-126-101-11	ELECT	100MF	20%	16V		C411	1-130-471-00	MYLAR	0.001MF	5%	50V	
C213	1-126-101-11	ELECT	100MF	20%	16V		C412	1-124-908-11	ELECT	22MF	20%	50V	

Note: The components identified by mark Δ or dotted line with mark Δ are critical for safety. Replace only with part number specified.

Ref.No.	Part No.	Description			
C420	1-126-101-11	ELECT	100MF	20%	16V
C421	1-126-101-11	ELECT	100MF	20%	16V
C450	1-123-661-00	ELECT	100MF	20%	6.3V
C451	1-123-661-00	ELECT	100MF	20%	6.3V
C452	1-161-494-00	CERAMIC	0.022MF		25V
C453	1-162-290-31	CERAMIC	470PF	10%	50V
C454	1-162-290-31	CERAMIC	470PF	10%	50V
C500	1-162-851-11	CERAMIC	0.1MF	20%	16V
C501	1-162-851-11	CERAMIC	0.1MF	20%	16V
C502	1-162-851-11	CERAMIC	0.1MF	20%	16V
C503	1-162-851-11	CERAMIC	0.1MF	20%	16V
C504	1-162-851-11	CERAMIC	0.1MF	20%	16V
C505	1-162-851-11	CERAMIC	0.1MF	20%	16V
C506	1-162-851-11	CERAMIC	0.1MF	20%	16V
C507	1-130-474-00	MYLAR	0.0018MF	5%	50V
C508	1-130-484-00	MYLAR	0.012MF	5%	50V
C509	1-130-478-00	MYLAR	0.0039MF	5%	50V
C510	1-130-474-00	MYLAR	0.0018MF	5%	50V
C511	1-130-471-00	MYLAR	0.001MF	5%	50V
C512	1-124-908-11	ELECT	22MF	20%	50V
C520	1-162-290-31	CERAMIC	470PF	10%	50V
C521	1-124-120-11	ELECT	220MF	20%	16V
C523	1-124-444-00	ELECT	220MF	20%	10V
C524	1-124-444-00	ELECT	220MF	20%	10V
C525	1-162-204-31	CERAMIC	16PF	5%	50V
C526	1-162-205-31	CERAMIC	18PF	5%	50V
C528	1-162-291-31	CERAMIC	560PF	10%	50V
C530	1-161-379-00	CERAMIC	0.01MF	30%	16V
C801	1-162-207-31	CERAMIC	22PF	5%	50V
C802	1-162-207-31	CERAMIC	22PF	5%	50V
C803	1-161-494-00	CERAMIC	0.022MF		25V
C804	1-123-661-00	ELECT	100MF	20%	6.3V
C805	1-161-379-00	CERAMIC	0.01MF	30%	16V
C900	1-124-898-11	ELECT	4700MF	20%	16V
C901	1-124-893-11	ELECT	2200MF	20%	10V
C902	1-123-875-11	ELECT	10MF	20%	50V
C903	1-123-875-11	ELECT	10MF	20%	50V
C904	1-126-244-51	ELECT	47000MF		5.5V
C905	1-124-360-00	ELECT	1000MF	20%	16V
C906	1-124-927-11	ELECT	4.7MF	20%	50V
C907	1-124-927-11	ELECT	4.7MF	20%	50V
C910	1-124-898-11	ELECT	4700MF	20%	16V
C911	1-124-472-11	ELECT	470MF	20%	10V
C921	1-124-911-11	ELECT	220MF	20%	50V
C922	1-124-913-11	ELECT	470MF	20%	50V
C923	1-124-360-00	ELECT	1000MF	20%	16V
C924	1-124-499-11	ELECT	1MF	20%	50V
C925	1-124-927-11	ELECT	4.7MF	20%	50V
C926	1-162-290-31	CERAMIC	470PF	10%	50V
C931	1-124-913-11	ELECT	470MF	20%	50V
C932	1-124-913-11	ELECT	470MF	20%	50V
C933	1-124-556-11	ELECT	2200MF	20%	16V
C941	1-124-122-11	ELECT	100MF	20%	50V
C942	1-124-122-11	ELECT	100MF	20%	35V
C990	1-162-578-00	CERAMIC	0.0047MF	20%	400V
CN101	*1-564-706-31	PIN, CONNECTOR (SMALL TYPE) 4P			
CN102	*1-564-710-11	PIN, CONNECTOR (SMALL TYPE) 8P			
CN201	*1-564-339-61	PIN, CONNECTOR 5P			

Ref.No.	Part No.	Description
CN203	*1-564-706-11	PIN, CONNECTOR (SMALL TYPE) 4P
CN204	*1-564-706-41	PIN, CONNECTOR (SMALL TYPE) 4P
CN256	*1-564-336-51	PIN, CONNECTOR 2P
CN258	*1-564-337-51	PIN, CONNECTOR 3P
CN260	*1-564-704-11	PIN, CONNECTOR (SMALL TYPE) 2P
CN302	*1-564-340-00	PIN, CONNECTOR 6P
CN303	*1-564-342-11	PIN, CONNECTOR 8P
CN390	1-464-878-11	TRANSMITTER UNIT, RAY
CN400	*1-564-709-11	PIN, CONNECTOR (SMALL TYPE) 7P
CN410	*1-564-723-11	PIN, CONNECTOR (SMALL TYPE) 7P
CN420	*1-564-719-11	PIN, CONNECTOR (SMALL TYPE) 3P
CN450	1-564-722-11	PIN, CONNECTOR (SMALL TYPE) 6P
CN810	*1-564-497-11	PIN, CONNECTOR 4P
CN900	*1-564-341-11	PIN, CONNECTOR 7P
CN920	*1-564-705-11	PIN, CONNECTOR (SMALL TYPE) 3P
CNJ252	*1-564-720-21	PIN, CONNECTOR (SMALL TYPE) 4P
D101	8-719-940-76	DIODE 1SS132
D904	8-719-940-76	DIODE 1SS132
D905	8-719-940-76	DIODE 1SS132
D906	8-719-940-76	DIODE 1SS132
D907	8-719-928-82	DIODE HZS4.3NB3
D908	8-719-200-77	DIODE 10E2N
D909	8-719-200-77	DIODE 10E2N
D910	8-719-200-77	DIODE 10E2N
D911	8-719-200-77	DIODE 10E2N
D912	8-719-940-76	DIODE 1SS132
D913	8-719-940-76	DIODE 1SS132
D914	8-719-940-76	DIODE 1SS132
D915	8-719-940-76	DIODE 1SS132
D920	8-719-200-77	DIODE 10E2N
D921	8-719-200-77	DIODE 10E2N
D922	8-719-200-77	DIODE 10E2N
D923	8-719-200-77	DIODE 10E2N
D943	8-719-200-77	DIODE 10E2N
D945	8-719-933-57	DIODE HZS9B2L
FLD801	1-519-428-21	INDICATOR TUBE, FLUORESCENT
IC101	8-752-031-80	IC CXA1081S
IC201	8-759-202-01	IC TA7256P
IC202	8-759-805-18	IC LA6520
IC204	8-752-032-33	IC CXA1182S
IC301	8-759-971-40	IC MSM6408-26SS
IC302	8-752-322-04	IC CXD1125Q
IC303	8-752-320-44	IC CXK5816M-10L
IC351	8-759-630-16	IC M50740A-424SP
IC352	8-759-820-64	IC LC9600R-183
IC380	8-759-605-44	IC M74HC6004P
IC400	8-759-745-61	IC NJM45600-D
IC450	8-759-700-74	IC NJM4556S
IC500	8-759-745-61	IC NJM45600-D
IC520	8-759-939-35	IC CX01080Q
IC521	8-759-939-94	IC TDA1541-N5
IC801	8-752-803-69	IC CXP5058H-068Q
IC802	8-741-138-70	IC BX-1387
IC900	8-759-630-21	IC M5290P-16
IC921	8-759-602-66	IC M5230L-A
IC940	8-759-602-02	IC M5219P

Note: The components identified by mark Δ or dotted line with mark Δ are critical for safety. Replace only with part number specified.

Ref.No.	Part No.	Description				
J380	1-566-922-11	JACK, PIN 1P (DIGITAL OUT)				
J400	1-563-867-11	JACK, PIN 2P (LINE OUT)				
J450	1-563-485-21	JACK, LARGE TYPE (HEADPHONES)				
L380	*1-410-858-11	INDUCTOR OUK				
M251	A-4608-346-A	MOTOR ASSY, L				
M252	X-4917-504-1	ASSY, MOTOR (SLED)				
M253	X-4917-523-1	ASSY, MOTOR (SPINDLE)				
PS201A	1-532-605-00	LINK, IC				
PS202A	1-532-605-00	LINK, IC				
PS205A	1-532-605-00	LINK, IC				
PS206A	1-532-605-00	LINK, IC				
PS901A	1-532-675-00	LINK, IC				
PS911A	1-532-675-00	LINK, IC				
PS920A	1-532-685-00	LINK, IC				
PS930A	1-532-685-00	LINK, IC				
Q101	8-729-801-83	TRANSISTOR 2SB1013				
Q205	8-729-806-38	TRANSISTOR 2SC3399				
Q206	8-729-806-28	TRANSISTOR 2SC3402				
Q400	8-729-107-77	TRANSISTOR 2SC3623-L				
Q401	8-729-107-77	TRANSISTOR 2SC3623-L				
Q402	8-729-107-77	TRANSISTOR 2SC3623-L				
Q500	8-729-107-77	TRANSISTOR 2SC3623-L				
Q501	8-729-107-77	TRANSISTOR 2SC3623-L				
Q502	8-729-107-77	TRANSISTOR 2SC3623-L				
Q520	8-729-115-15	TRANSISTOR BN1A4N				
Q521	8-729-115-15	TRANSISTOR BN1A4N				
Q522	8-729-806-38	TRANSISTOR 2SC3399				
Q523	8-729-806-38	TRANSISTOR 2SC3399				
Q801	8-729-902-11	TRANSISTOR 2SC2021				
Q900	8-729-808-72	TRANSISTOR 2SB1274SA				
Q901	8-729-806-38	TRANSISTOR 2SC3399				
Q910	8-729-808-76	TRANSISTOR 2SD1913SA				
Q911	8-729-806-20	TRANSISTOR 2SA1345				
Q912	8-729-806-38	TRANSISTOR 2SC3399				
Q913	8-729-806-20	TRANSISTOR 2SA1345				
Q920	8-729-806-38	TRANSISTOR 2SC3399				
Q931	8-729-103-43	TRANSISTOR 2SB734				
Q940	8-729-802-22	TRANSISTOR 2SB1014				
R101	1-215-396-00	CARBON	91	5%	1/4W	
R102	1-214-092-00	METAL	22	1%	1/4W	
R103	1-249-417-11	CARBON	1K	5%	1/4W	
R104	1-249-433-11	CARBON	22K	5%	1/4W	
R105	1-249-421-11	CARBON	2.2K	5%	1/4W	
R106	1-249-428-11	CARBON	8.2K	5%	1/4W	
R107	1-215-450-00	CARBON	16K	5%	1/4W	
R108	1-249-425-11	CARBON	4.7K	5%	1/4W	
R109	1-249-425-11	CARBON	4.7K	5%	1/4W	
R110	1-249-432-11	CARBON	18K	5%	1/4W	
R111	1-249-432-11	CARBON	18K	5%	1/4W	
R112	1-249-441-11	CARBON	100K	5%	1/4W	
R201	1-249-393-11	CARBON	10	5%	1/4W	
R203	1-249-393-11	CARBON	10	5%	1/4W	
R204	1-249-381-11	CARBON	1	5%	1/4W	
R205	1-247-881-00	CARBON	120K	5%	1/4W	
R206	1-215-472-00	CARBON	130K	5%	1/4W	
R207	1-249-381-11	CARBON	1	5%	1/4W	

Ref.No.	Part No.	Description				
R208	1-247-881-00	CARBON	120K	5%	1/4W	
R210	1-215-472-00	CARBON	130K	5%	1/4W	
R211	1-249-437-11	CARBON	47K	5%	1/4W	
R212	1-249-436-11	CARBON	39K	5%	1/4W	
R213	1-249-429-11	CARBON	10K	5%	1/4W	
R214	1-249-423-11	CARBON	3.3K	5%	1/4W	
R216	1-249-393-11	CARBON	10	5%	1/4W	
R217	1-249-438-11	CARBON	56K	5%	1/4W	
R219	1-249-424-11	CARBON	3.9K	5%	1/4W	
R220	1-249-425-11	CARBON	4.7K	5%	1/4W	
R222	1-215-472-00	CARBON	130K	5%	1/4W	
R223	1-249-393-11	CARBON	10	5%	1/4W	
R224	1-249-393-11	CARBON	10	5%	1/4W	
R228	1-215-486-00	CARBON	510K	5%	1/4W	
R229	1-249-435-11	CARBON	33K	5%	1/4W	
R230	1-215-479-00	CARBON	270K	5%	1/4W	
R231	1-249-440-11	CARBON	82K	5%	1/4W	
R232	1-249-429-11	CARBON	10K	5%	1/4W	
R233	1-249-414-11	CARBON	560	5%	1/4W	
R234	1-249-441-11	CARBON	100K	5%	1/4W	
R235	1-215-434-00	METAL	3.6K	1%	1/6W	
R236	1-249-433-11	CARBON	22K	5%	1/4W	
R237	1-249-441-11	CARBON	100K	5%	1/4W	
R301	1-249-405-11	CARBON	100	5%	1/4W	
R303	1-215-469-00	METAL	100K	1%	1/6W	
R304	1-215-469-00	METAL	100K	1%	1/6W	
R305	1-249-429-11	CARBON	10K	5%	1/4W	
R306	1-249-441-11	CARBON	100K	5%	1/4W	
R307	1-249-429-11	CARBON	10K	5%	1/4W	
R308	1-249-417-11	CARBON	1K	5%	1/4W	
R309	1-249-433-11	CARBON	22K	5%	1/4W	
R310	1-215-493-00	CARBON	1M	5%	1/4W	
R351	1-249-417-11	CARBON	1K	5%	1/4W	
R380	1-249-412-11	CARBON	390	5%	1/4W	
R381	1-215-396-00	CARBON	91	5%	1/4W	
R390	1-249-428-11	CARBON	8.2K	5%	1/4W	
R391	1-249-408-11	CARBON	180	5%	1/4W	
R400	1-247-838-00	CARBON	2K	5%	1/4W	
R401	1-249-418-11	CARBON	1.2K	5%	1/4W	
R402	1-215-493-00	CARBON	1M	5%	1/4W	
R403	1-249-425-11	CARBON	4.7K	5%	1/4W	
R404	1-215-430-00	CARBON	2.4K	5%	1/4W	
R405	1-215-430-00	CARBON	2.4K	5%	1/4W	
R406	1-249-441-11	CARBON	100K	5%	1/4W	
R407	1-249-409-11	CARBON	220	5%	1/4W	
R408	1-249-414-11	CARBON	560	5%	1/4W	
R409	1-249-421-11	CARBON	2.2K	5%	1/4W	
R410	1-249-433-11	CARBON	22K	5%	1/4W	
R411	1-249-421-11	CARBON	2.2K	5%	1/4W	
R412	1-249-409-11	CARBON	220	5%	1/4W	
R450	1-249-417-11	CARBON	1K	5%	1/4W	
R451	1-249-423-11	CARBON	3.3K	5%	1/4W	
R452	1-249-423-11	CARBON	3.3K	5%	1/4W	
R453	1-249-402-11	CARBON	56	5%	1/4W	
R500	1-247-838-00	CARBON	2K	5%	1/4W	
R501	1-249-418-11	CARBON	1.2K	5%	1/4W	
R502	1-215-493-00	CARBON	1M	5%	1/4W	

Note: The components identified by mark Δ or dotted line with mark Δ are critical for safety. Replace only with part number specified.

Ref.No.	Part No.	Description			
R503	1-249-425-11	CARBON	4.7K	5%	1/4W
R504	1-215-430-00	CARBON	2.4K	5%	1/4W
R505	1-215-430-00	CARBON	2.4K	5%	1/4W
R506	1-249-441-11	CARBON	100K	5%	1/4W
R507	1-249-409-11	CARBON	220	5%	1/4W
R508	1-249-414-11	CARBON	560	5%	1/4W
R509	1-249-421-11	CARBON	2.2K	5%	1/4W
R510	1-249-433-11	CARBON	22K	5%	1/4W
R511	1-249-421-11	CARBON	2.2K	5%	1/4W
R512	1-249-409-11	CARBON	220	5%	1/4W
R520	1-249-413-11	CARBON	470	5%	1/4W
R521	1-249-441-11	CARBON	100K	5%	1/4W
R522	1-249-429-11	CARBON	10K	5%	1/4W
R523	1-249-429-11	CARBON	10K	5%	1/4W
R524	1-249-413-11	CARBON	470	5%	1/4W
R525	1-249-413-11	CARBON	470	5%	1/4W
R526	1-249-441-11	CARBON	100K	5%	1/4W
R527	1-249-417-11	CARBON	1K	5%	1/4W
R528	1-249-416-11	CARBON	820	5%	1/4W
R550	1-249-417-11	CARBON	1K	5%	1/4W
R551	1-249-423-11	CARBON	3.3K	5%	1/4W
R552	1-249-423-11	CARBON	3.3K	5%	1/4W
R553	1-249-402-11	CARBON	56	5%	1/4W
R848	1-249-429-11	CARBON	10K	5%	1/4W
R901	1-249-425-11	CARBON	4.7K	5%	1/4W
R902	1-249-429-11	CARBON	10K	5%	1/4W
R903	1-249-405-11	CARBON	100	5%	1/4W
R904	1-249-413-11	CARBON	470	5%	1/4W
R910	1-249-429-11	CARBON	10K	5%	1/4W
R911	1-249-425-11	CARBON	4.7K	5%	1/4W
R912	1-249-425-11	CARBON	4.7K	5%	1/4W
R920	1-249-399-11	CARBON	33	5%	1/4W
R921	1-249-431-11	CARBON	15K	5%	1/4W
R922	1-215-493-00	CARBON	1M	5%	1/4W
R923	1-215-454-00	CARBON	24K	5%	1/4W
R924	1-249-423-11	CARBON	3.3K	5%	1/4W
R930	1-249-399-11	CARBON	33	5%	1/4W
R931	1-249-431-11	CARBON	15K	5%	1/4W
R932	1-249-414-11	CARBON	560	5%	1/4W
R941	△ 1-212-857-00	FUSIBLE	10	5%	1/4W F
R942	1-249-433-11	CARBON	22K	5%	1/4W
R943	1-249-429-11	CARBON	10K	5%	1/4W
R944	1-249-417-11	CARBON	1K	5%	1/4W
R945	1-249-434-11	CARBON	27K	5%	1/4W
R946	1-249-425-11	CARBON	4.7K	5%	1/4W
RV101	1-228-995-00	RES, ADJ, CARBON 22K			
RV102	1-228-995-00	RES, ADJ, CARBON 22K			
RV103	1-228-995-00	RES, ADJ, CARBON 22K			
RV104	1-228-993-00	RES, ADJ, CARBON 4.7K			
RV201	1-228-990-00	RES, ADJ, METAL GLAZE 1K			
RV450	1-237-438-11	RES, VAR, CARBON 20K/20K (HEADPHONES LEVEL)			
S251	1-571-300-11	SWITCH, ROTARY			
S252	1-571-274-11	SWITCH, LEAF			
S801	1-570-876-11	SWITCH, KEY BOARD (1A)			
S802	1-570-876-11	SWITCH, KEY BOARD (2B)			
S803	1-570-876-11	SWITCH, KEY BOARD (3C)			
S804	1-570-876-11	SWITCH, KEY BOARD (4D)			
S805	1-570-876-11	SWITCH, KEY BOARD (5E)			

Note: The components identified by mark △ or dotted line with mark △ are critical for safety. Replace only with part number specified.

Ref.No.	Part No.	Description
S806	1-570-876-11	SWITCH, KEY BOARD (6F)
S807	1-570-876-11	SWITCH, KEY BOARD (7)
S808	1-570-876-11	SWITCH, KEY BOARD (8)
S809	1-570-876-11	SWITCH, KEY BOARD (9)
S810	1-570-876-11	SWITCH, KEY BOARD (10)
S811	1-570-876-11	SWITCH, KEY BOARD (11)
S812	1-570-876-11	SWITCH, KEY BOARD (12)
S813	1-570-876-11	SWITCH, KEY BOARD (13)
S814	1-570-876-11	SWITCH, KEY BOARD (14)
S815	1-570-876-11	SWITCH, KEY BOARD (15)
S816	1-570-876-11	SWITCH, KEY BOARD (16)
S817	1-570-876-11	SWITCH, KEY BOARD (17)
S818	1-570-876-11	SWITCH, KEY BOARD (18)
S819	1-570-876-11	SWITCH, KEY BOARD (19)
S820	1-570-876-11	SWITCH, KEY BOARD (20)
S821	1-570-876-11	SWITCH, KEY BOARD (▶▶)
S822	1-570-876-11	SWITCH, KEY BOARD (ERASE)
S823	1-570-876-11	SWITCH, KEY BOARD (CONTINUE)
S824	1-570-876-11	SWITCH, KEY BOARD (SHUFFLE)
S825	1-570-876-11	SWITCH, KEY BOARD (PROGRAM)
S826	1-570-876-11	SWITCH, KEY BOARD (>20)
S827	1-570-876-11	SWITCH, KEY BOARD (CHECK)
S828	1-570-876-11	SWITCH, KEY BOARD (CLEAR)
S829	1-570-876-11	SWITCH, KEY BOARD (FILE)
S830	1-570-876-11	SWITCH, KEY BOARD (INDEX MODE)
S832	1-570-876-11	SWITCH, KEY BOARD (■)
S833	1-570-876-11	SWITCH, KEY BOARD (◀◀)
S834	1-570-876-11	SWITCH, KEY BOARD (▶▶)
S835	1-570-876-11	SWITCH, KEY BOARD (◀◀)
S836	1-570-876-11	SWITCH, KEY BOARD (TIME/MEMO)
S837	1-570-876-11	SWITCH, KEY BOARD (OPEN/CLOSE)
S838	1-570-876-11	SWITCH, KEY BOARD (AUTO PAUSE)
S839	1-570-876-11	SWITCH, KEY BOARD (REPEAT)
S841	1-570-876-11	SWITCH, KEY BOARD (▶)
S842	1-570-876-11	SWITCH, KEY BOARD ()
S851	1-571-305-11	SWITCH, PUSH (1 KEY)(POWER)
S901	△ 1-570-046-21	(E)...SWITCH, VOLTAGE CHANGE
T990	△ 1-449-210-11	(AEP,UK)...TRANSFORMER, POWER
T990	△ 1-449-238-11	(E)...TRANSFORMER, POWER
TB900	*1-535-120-00	TERMINAL
△ TB990	*1-535-139-00	(E).....BASE POST 19MM(1.0MM PITCH) 2P
△ TB990	*1-535-140-11	(AEP,UK)...BASE POST 19MM(1.0MM PITCH) 3P
TB991	△ 1-535-416-00	TERMINAL
TB992	△ 1-535-416-00	TERMINAL
X301	1-567-686-11	OSCILLATOR, CERAMIC (4MHz)
X520	1-567-926-11	VIBRATOR, CRYSTAL (16.9314MHz)
X801	1-567-192-11	OSCILLATOR, CERAMIC (4MHz)

ACCESSORY & PACKING MATERIAL

1-463-994-11	REMOTE COMMANDER (RM-D600)
1-558-543-11	CORD, CONNECTION
3-769-888-11	(UK,E)...MANUAL, INSTRUCTION
3-769-888-41	(AEP)...MANUAL, INSTRUCTION
3-795-629-15	(AEP)...INSTRUCTION
4-921-935-01	CUSHION
*4-922-631-11	INDIVIDUAL CARTON
7-632-650-75	SHEET PROTECTION (500MM)