

# SS-H70/H501

## SERVICE MANUAL

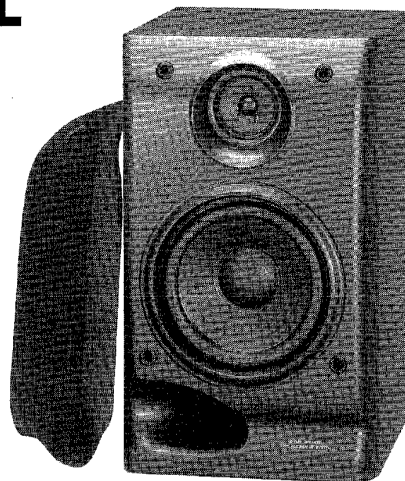

*US Model*  
*AEP Model*  
*UK Model*  
*E Model*  
*Australian Model*  
*Tourist Model*

This set is the speaker system in  
FH-A40K/CX35 and MHC-501/701/G50/G500.

### SPECIFICATIONS

|                           |  |
|---------------------------|--|
| Speaker system            | 2-way, Bass reffer type  |
| Speaker unit              | Woofer : 14 cm (5 $\frac{5}{8}$ in.), cone type<br>Tweeter : 5 cm (2 in.), cone type     |
| Sensitivity               | 87 dm/W/m  |
| Effective frequency range | 65 Hz to 20 kHz  |
| Rated impedance           | 6 ohms   |
| Dimensions                | 195 × 325 × 250 mm (w/h/d)<br>(7 $\frac{3}{4}$ × 12 $\frac{7}{8}$ × 9 $\frac{7}{8}$ in.) |
| Mass                      | Approx. 3.3 kg<br>(7 lb 4 oz.) net per speaker   |

Design and specifications are subject to change without notice.

SPEAKER SYSTEM  
**SONY®**

## EXPLODED VIEW AND PARTS LIST

NOTE :

- Items marked “ \* ” are not stocked since they are seldom required for routine service. Some delay should be anticipated when ordering these items.
- The mechanical parts with no reference number in the exploded views are not supplied.

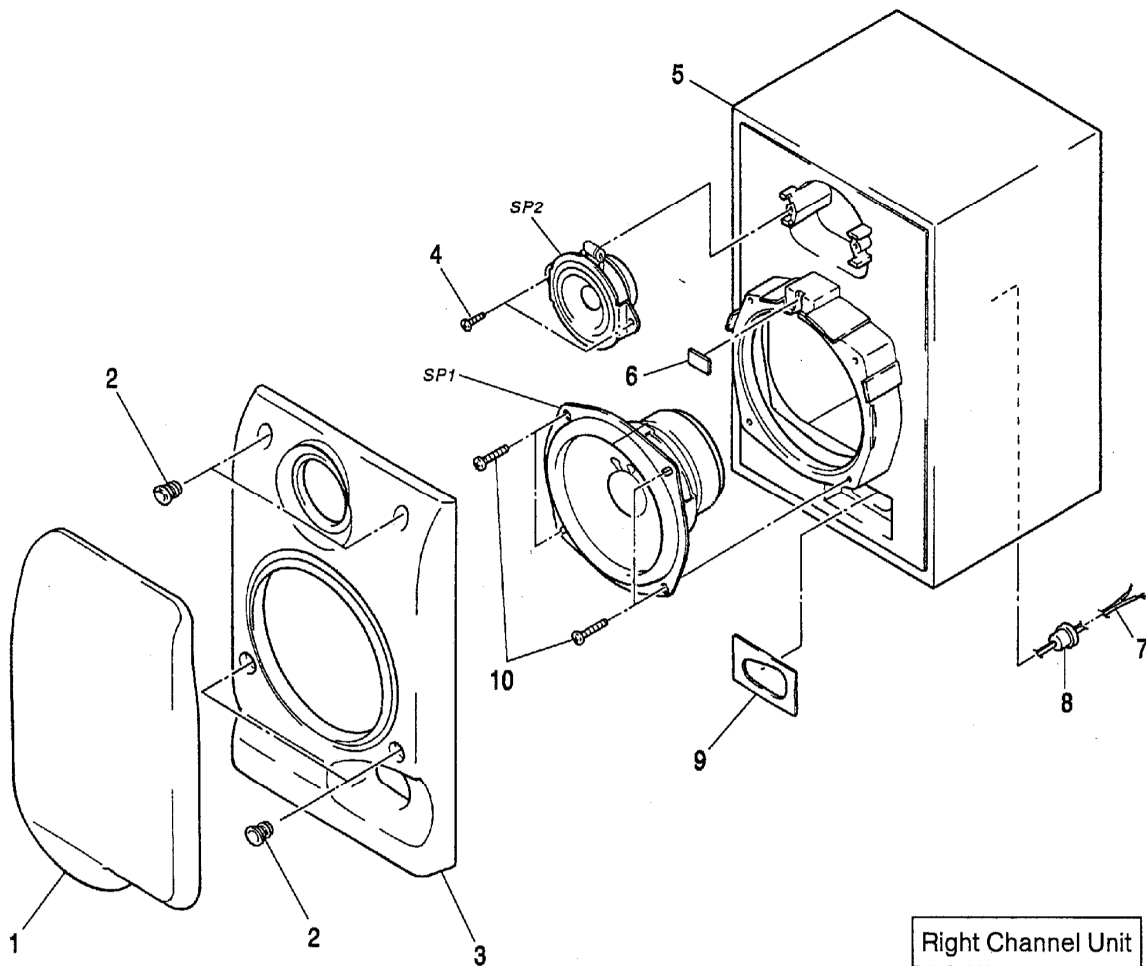

| Ref. No. | Part No.     | Description                      | Remark | Ref. No. | Part No.     | Description                        | Remark |
|----------|--------------|----------------------------------|--------|----------|--------------|------------------------------------|--------|
| 1        | X-4945-493-1 | FRAME (L) ASSY, GRILLE           |        | 8        | 4-942-138-01 | CLAMP                              |        |
| 1        | X-4945-494-1 | FRAME (R) ASSY, GRILLE           |        | 9        | 9-911-840-XX | PACKING                            |        |
| 2        | 4-951-733-01 | CATCHER                          |        | 10       | 4-874-614-11 | SCREW +BVTP 3.5×14                 |        |
| 3        | 4-971-332-01 | PANEL (L), FRONT                 |        | SP1      | 1-504-825-11 | SPEAKER (13CM)                     |        |
| 3        | 4-971-329-01 | PANEL (R), FRONT                 |        | SP2      | 1-504-827-11 | SPEAKER (5CM)                      |        |
| 4        | 7-685-646-21 | SCREW +BVTP 3×8 TYPE 2 SLIT      |        | *****    |              |                                    |        |
| * 5      | A-4361-275-A | CABINET (L) ASSY, SPEAKER (H70)  |        |          |              | ACCESSORIES & PACKING MATERIALS    |        |
| * 5      | A-4361-295-A | CABINET (R) ASSY, SPEAKER (H70)  |        |          |              | *****                              |        |
| * 5      | A-4361-422-A | CABINET (L) ASSY, SPEAKER (H501) |        |          |              |                                    |        |
| * 5      | A-4361-424-A | CABINET (R) ASSY, SPEAKER (H501) |        |          |              |                                    |        |
| * 6      | 4-971-211-01 | PACKING                          |        |          | 3-798-713-11 | MANUAL INSTRUCTION (ENGLISH) (H70) |        |
| 7        | 1-574-792-11 | CORD, SPEAKER                    |        | *        | 4-973-845-01 | INDIVIDUAL CARTON (H70)            |        |
|          |              |                                  |        | *        | 4-971-217-01 | CUSHION (H501)                     |        |

**Sony Corporation**  
Consumer A&V Products Company  
Home A&V Products Div.

9-960-091-11

English  
95B02113-1  
Printed in Japan  
© 1995.2  
Published by Home A&V Products Div.  
Quality Engineering Dept.