

# ACOUSTICS

## SB26ADC-C000-4

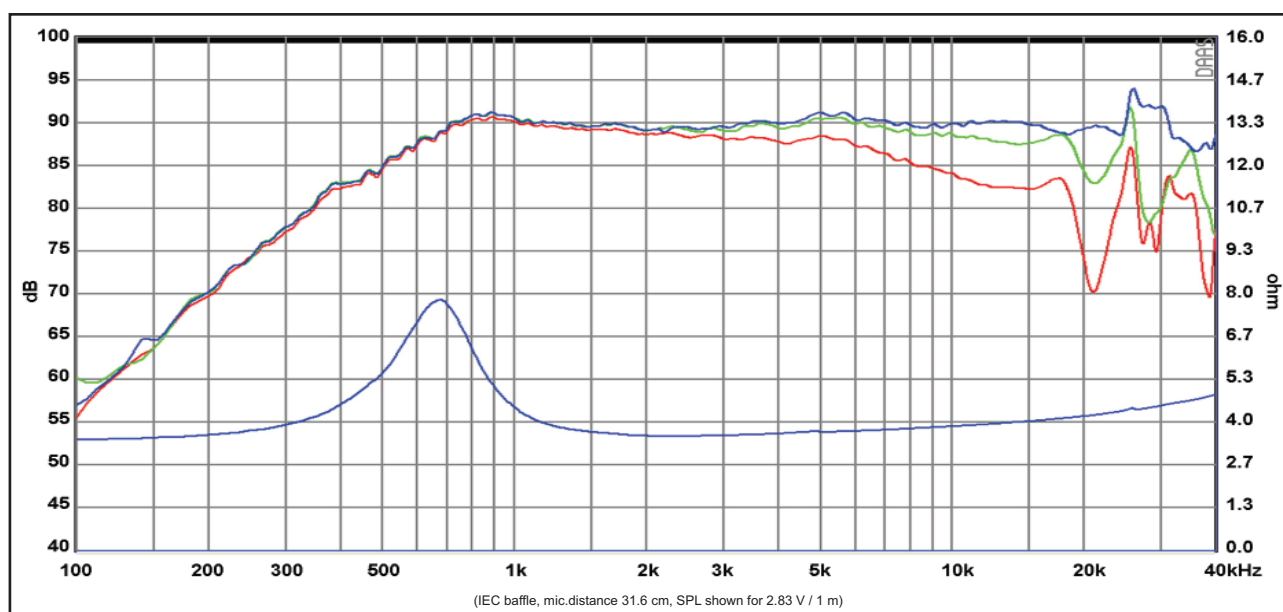
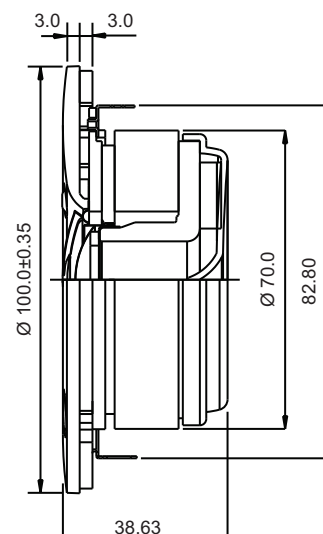
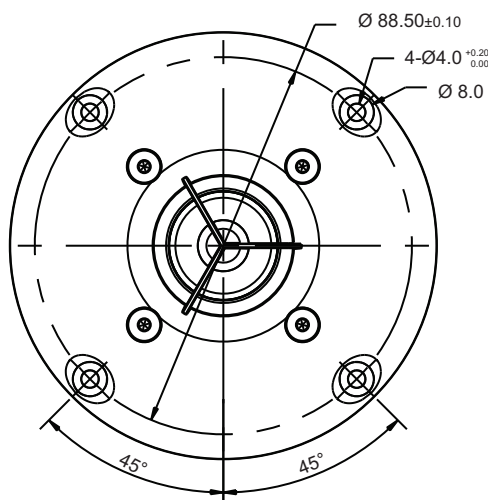

Response Curve :

— (Blue) : on axis      — (Green) : 30° off-axis      — (Red) : 60° off-axis

### Specs :

Nominal Impedance	4 $\Omega$	Free air resonance, $F_s$	680 Hz
DC resistance, $R_e$	3.2 $\Omega$	Sensitivity (2.83 V / 1 m)	90 dB
Voice coil inductance, $L_e$	0.04 mH	Mechanical Q-factor, $Q_{ms}$	2.7
Effective piston area, $S_d$	6.2 cm <sup>2</sup>	Electrical Q-factor, $Q_{es}$	1.88
Voice coil diameter	25.4 mm	Total Q-factor, $Q_{ts}$	1.11
Voice coil height	1.3 mm	Force factor, $Bl$	1.6 Tm
Air gap height	2.5 mm	Rated power handling*	120 W
Linear coil travel (p-p)	1.2 mm	Magnetic flux density	1.15 T
Moving mass incl. air, $M_{ms}$	0.38 g	Magnet weight	0.22 kg
		Net weight	0.5 kg

\* IEC 268-5, high-pass Butterworth, 2600 Hz, 12 dB/oct.