

ACOUSTICS

8" SB23NRXS45-8

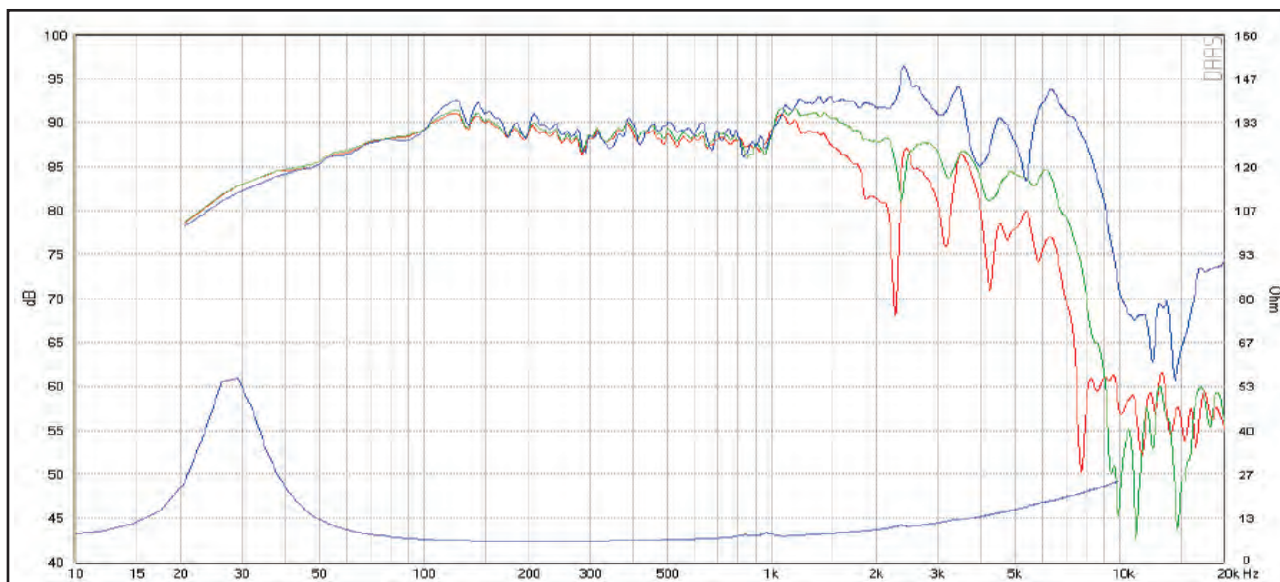
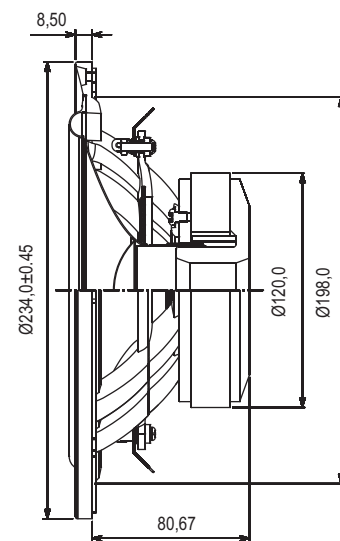
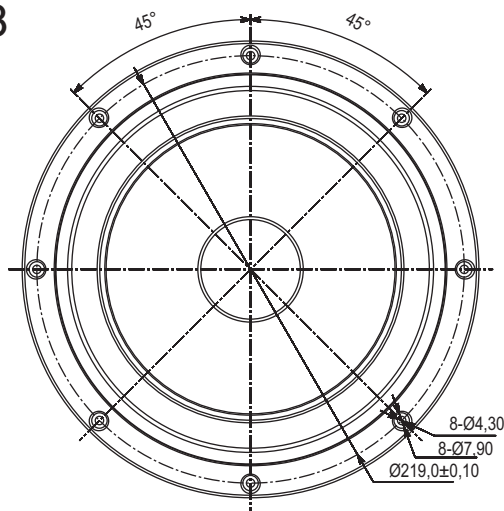

Response Curve :

— (Blue) : on axis

— (Green) : 30 off-axis

— (Red) : 60 off-axis

Specs :

| | | | |
|------------------------------|---------------------|-------------------------------|-----------|
| Nominal Impedance | 8 Ω | Free air resonance, F_s | 27 Hz |
| DC resistance, R_e | 5.6 Ω | Sensitivity (2.83 V/1m) | 88.5 dB |
| Voice coil inductance, L_e | 0.60 mH | Mechanical Q-factor, Q_{ms} | 5.4 |
| Effective piston area, S_d | 216 cm ² | Electrical Q-factor, Q_{es} | 0.41 |
| Voice coil diameter | 45.5 mm | Total Q-factor, Q_{ts} | 0.38 |
| Voice coil height | 19 mm | Moving mass incl.air, m_d | 24.5 g |
| Air gap height | 6 mm | Force factor, Bl | 7.5 Tm |
| Linear coil travel (p-p) | 13 mm | Equivalent volume, V_{as} | 94 liters |
| Magnetic flux density | 0.86 T | Compliance, C_{ms} | 1.42 mm/N |
| Magnet weight | 0.8 kg | Mechanical loss, R_m | 0.77 kg/s |
| Net weight | 2.74 kg | Rated power handling | 60 watt |

The parameter are measured on drive units that are broken in