

MIN VOLUME REQUIRED:
VAS 3.16 QF, 89.55 L

PROVIDED: 92.5L +/-
(WITHOUT PORT OR HAND
HOLD OR SPEAKER
VOLUME)

HAND HOLD VOLUME:
110X110X40 = 484000CM (.484L)
X2 =.968L TOTAL

MANUF PORT VOLUME:
80DIA X 183 =.92L X2= 1.84L

92.5L CABINET
-.968L HAND HOLDS
-1.84L PORTS

89.73L AVAILABLE VOLUME

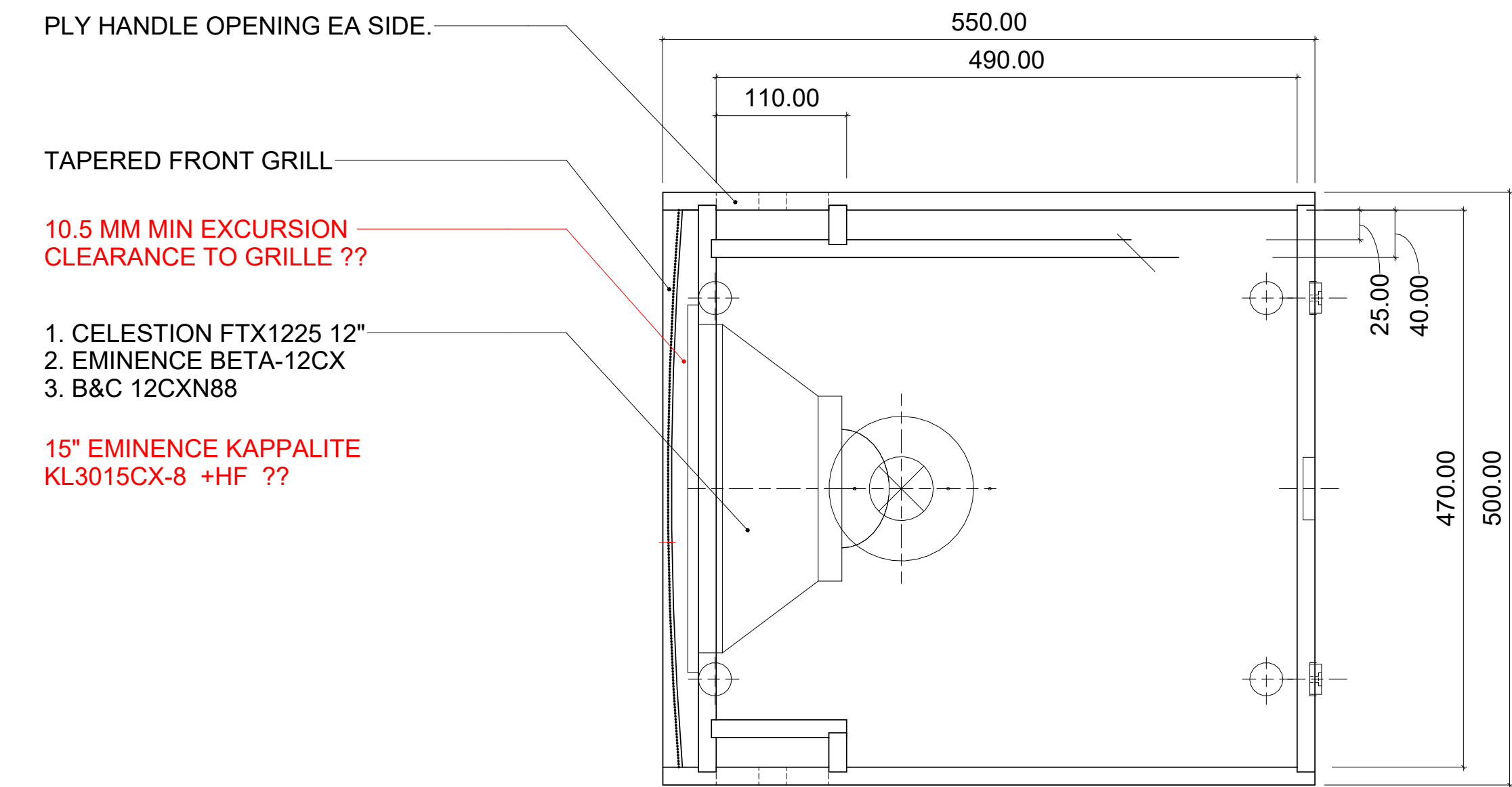

QUESTIONS

- WILL A SLOT PORT RESONATE AT ONE FREQUENCY HORIZONTALLY, AND A DIFFERENT FREQUENCY VERTICAL IN A COHEARENT WAY?
- FLAT TO 80hz GOAL WITHOUT EQ POSSIBLE AS DRAWN? OR BETTER?

GENERAL NOTES

- ADD CORNER BULL NOSE TO CNC?? TRIM AFTER ASSEMBLED??
- 15 MM PLYWOOD
- 4MM CNC DADO FIT TYP
- CNC HIGH LOW LABLE INTO CAB FOR SPEAKONS
- MICKY MOUSE CNC DADO CORNERS

COATING

- [HTTPS://WWW.WB-COATINGS.DE/PRODUKTE-EN-GB/WB-WARNEX-EN-GB/](https://www.wb-coatings.de/produkte-en-gb/wb-warnex-en-gb/)
- [HTTPS://WWW.ALDCROFTS.COM/SPEAKER-PAINT](https://www.aldcrofts.com/speaker-paint)
- EXOHYDE

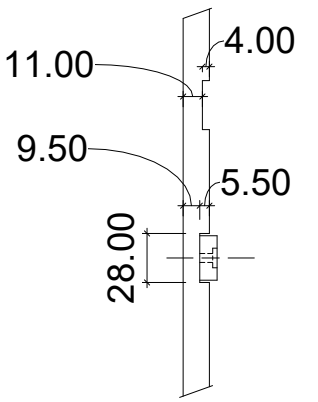
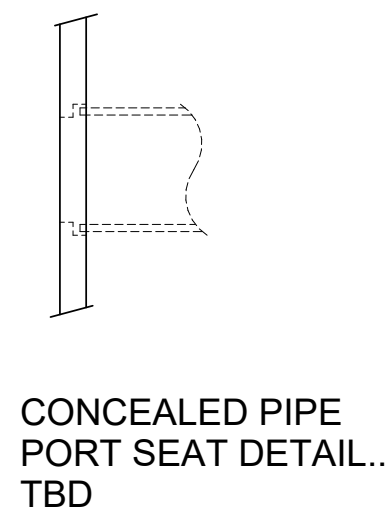
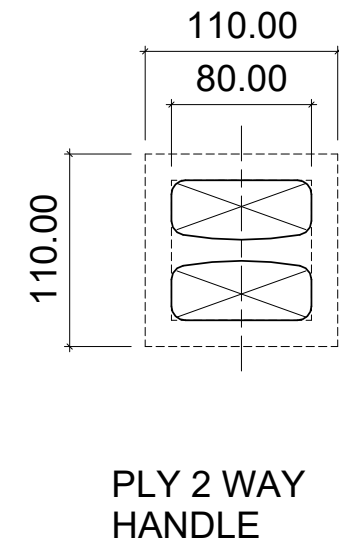
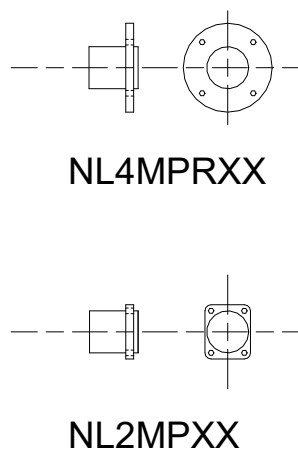
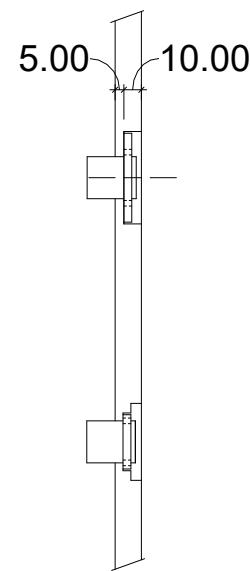
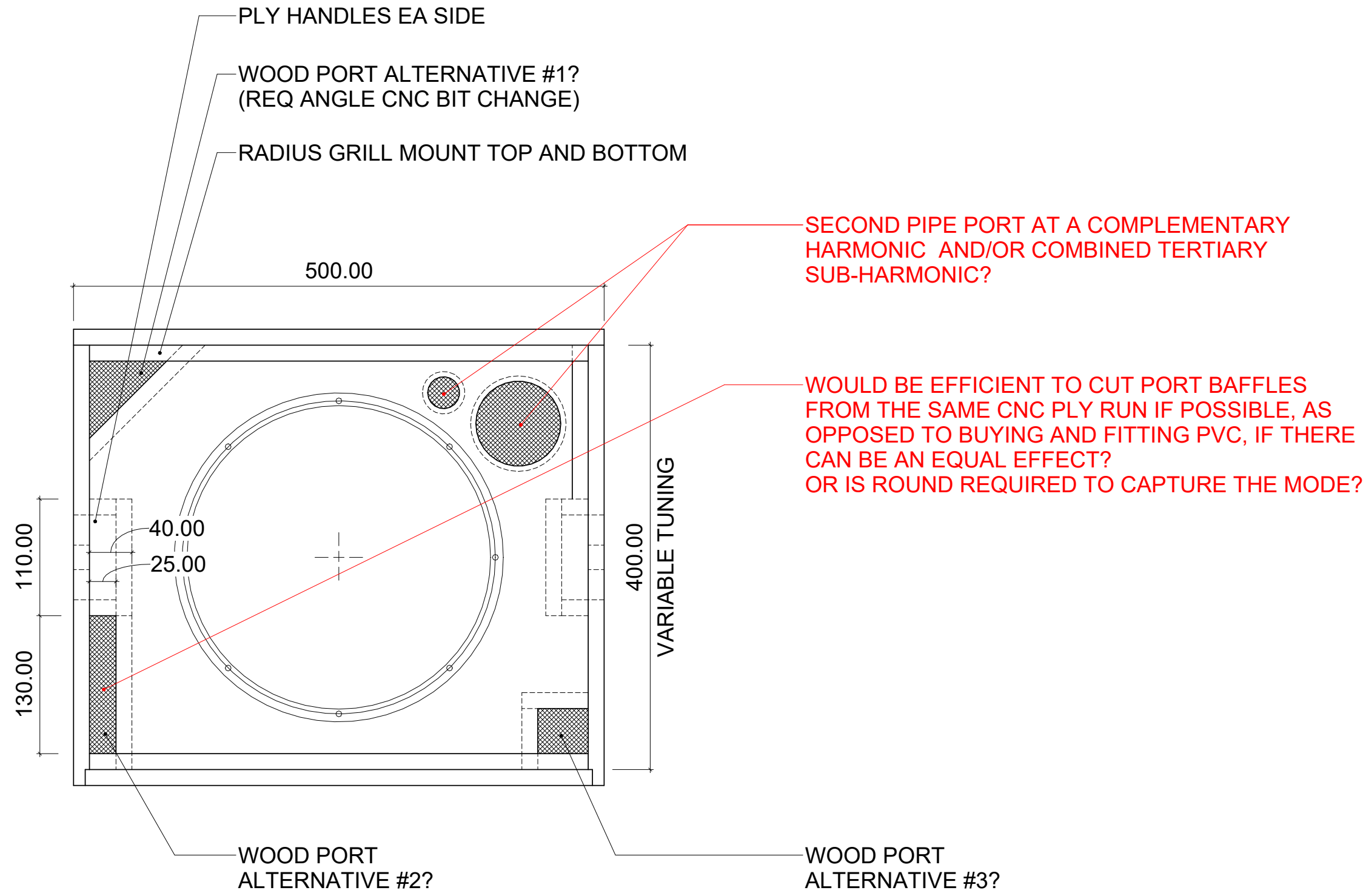

4-PACK RUBBER CABINET FEET 1"
DIA. X 0.375" H
PARTS EXPRESS PART #260-7513