

EXPLODED VIEW - B

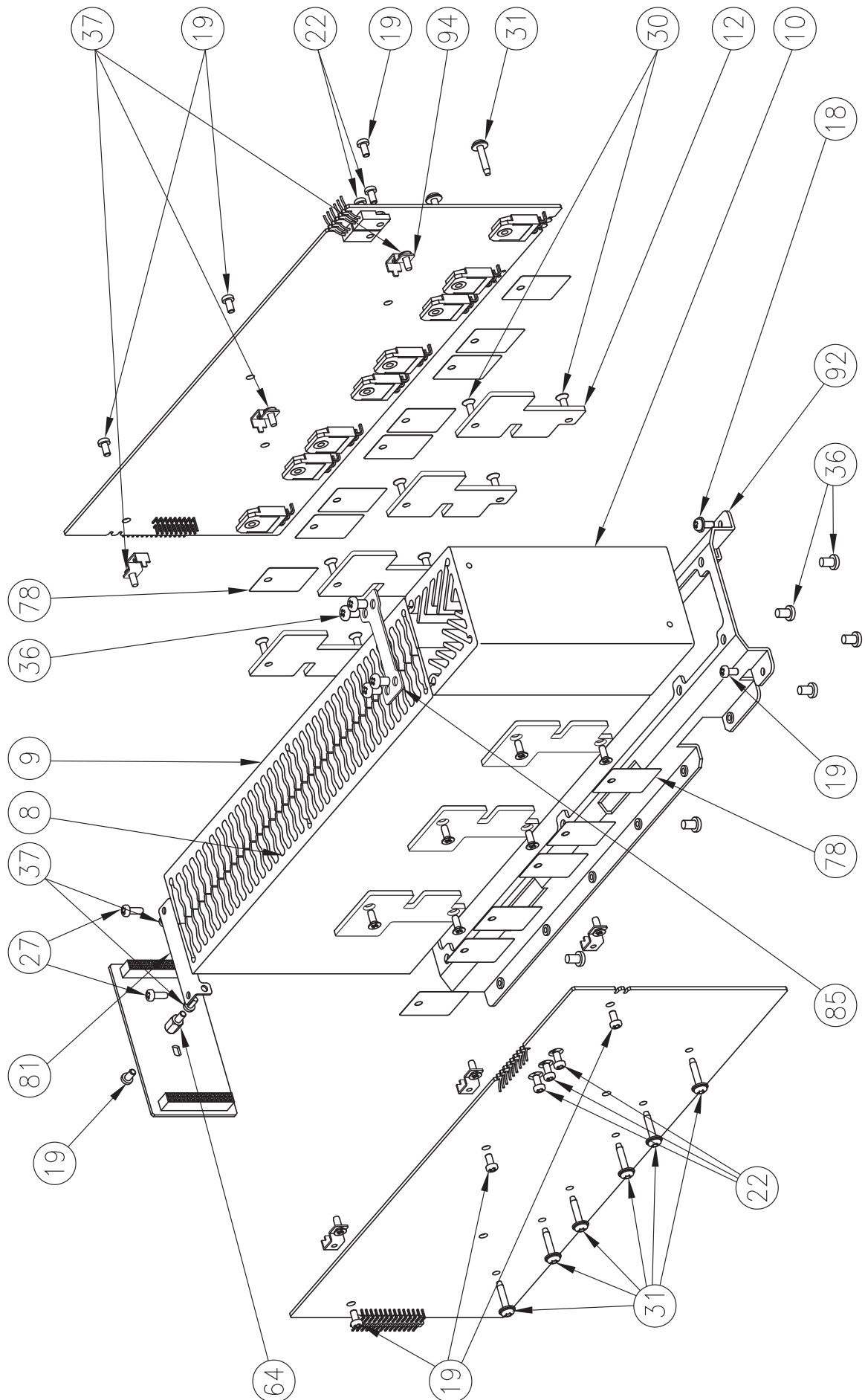

EXPLODED VIEW PARTS LIST

ITEM	PART NO.	DESC.	QTY
1	08-002-0067-90	FAN DC 60x20mm 12V 0.18A 3800RPM DF126020SL L=430mm w/ 2.5P CONNECTOR (RoHS)	2
2	08-002-0068-90	FAN DC 60x20mm 12V 0.18A 3800RPM DF126020SL L=330mm w/ 2.5P CONNECTOR (RoHS)	3
3	10-005-0272-90	TRANSFORMER PW TOROIDAL 120V T775 AT4.531.0098 TA-1000 (RoHS) [FOR 120V VERSION]	1
	10-005-0273-90	TRANSFORMER PW TOROIDAL 230V T775 AT4.531.0098/2 TA-1000 (RoHS) [FOR 230V VERSION]	1
4	11-001-0062-90	SWITCH ROCKER 1P1T BLK/BLK 10A/250VAC TV-5 UL/CSA/VDE/SEMKO (RoHS)	1
5	15-004-0074-90	AC SOCKET IEC 10A 250V JR-101 (RoHS) [FOR 120V VERSION]	1
	15-004-0075-90	AC INLET 10A 250V R-301 RICH BAY UL/CCC/VDE/N/S (RoHS) [FOR 230V VERSION]	1
6	15-004-0078-90	AC OUTLET 3 PINS US POLARIZED SS-6B-1-NY (RoHS) [FOR 120V VERSION]	1
	15-004-0076-90	AC OUTLET EURO CEE 7 2.5A/250V A302D0060P (RoHS) [FOR 230V VERSION]	1
7	15-016-0001-90	AM/FM TUNER MIDULE KST-MB114MA0-23 (RoHS)	1
8	19-001-0088-91	EXT. HTSK LEFT T775 (ROHS)	1
9	19-001-0089-91	EXT. HTSK RIGHT T775 (RoHS)	1
10	19-001-0090-90	U-SHAPE EXT. HTSK T775 (RoHS)	1
11	19-001-0093-91	HEATSINK-RECTIFIER T762 (RoHS)	1
12	19-001-0116-90	HEATSINK PLATE TRANSISTOR 2.5MM ALUMINIUM (RoHS)	7
13	21-001-0030-90	NEW VOLUME KNOB ASSY T175 GRAPHITE (RoHS) [FOR GRAPHITE VERSION]	1
	21-001-0031-90	NEW VOLUME KNOB ASSY T175 TITANIUM (RoHS) [FOR TITANIUM VERSION]	1
14	21-002-0155-90	POWER BUTTON TACT ACTIVE T765 GRAPHITE (RoHS) [FOR GRAPHITE VERSION]	1
	21-002-0156-90	POWER BUTTON TACT ACTIVE T765 TITANIUM (RoHS) [FOR TITANIUM VERSION]	1
15	21-002-0157-90	2X BUTTON SET T765 GRAPHITE (RoHS) [FOR GRAPHITE VERSION]	2
	21-002-0158-90	2X BUTTON SET T765 TITANIUM (RoHS) [FOR TITANIUM VERSION]	2
16	21-002-0159-90	4 WAYS BUTTON T765 GRAPHITE (RoHS) [FOR GRAPHITE VERSION]	1
	21-002-0160-90	4 WAYS BUTTON T765 TITANIUM (RoHS) [FOR TITANIUM VERSION]	1
17	21-002-0161-90	CENTER BUTTON T765 GRAPHITE (RoHS) [FOR GRAPHITE VERSION]	1
	21-002-0162-90	CENTER BUTTON T765 TITANIUM (RoHS) [FOR TITANIUM VERSION]	1
18	22-001-0043-00	SCREW MACHINE M3 x 6 P/H WASHER HEAD NI PLT (RoHS)	3
19	22-001-0367-00	SCREW MACHINE M3 x 6 P/H NI PLT (RoHS)	11
20	22-001-0376-90	MACHINE SCREW M3 x 6 P/H BLK (RoHS)	3
21	22-001-0379-90	MACHINE SCREW M4 x 8 WASHER HEAD BLK (RoHS)	6
22	22-001-0381-90	MACHINE SCREW M3 x 10 PAN HEAD NI PLT (RoHS)	18
23	22-001-0384-90	MACHINE SCREW M4 x 14 WASHER HEAD BLK (RoHS)	1
24	22-001-0409-90	SCREW MACHINE M3 x 15 WASHER HEAD W/ STOPPER NI PLT (RoHS)	20

25	22-001-0410-90	SCREW MACHINE M2.6 X 6 K/H BLK PLT (RoHS)	4
26	22-001-0469-90	HEX BOLT M8 LENGTH=100mm ZN PLATED (RoHS)	1
27	22-003-0030-00	TAPTITE SCREW 3x8 P/H TYPE "B" ZN/NI PLT (RoHS)	69
28	22-003-0049-00	SCREW TAPTITE 3x8 B/H TYPE "B" BLK PLT (RoHS)	48
29	22-003-0107-00	SCREW TAPTITE 3.5x8 B/H TYPE "B" BLK PLT (RoHS)	6
30	22-003-0129-00	SCREW TAPTITE 3x8 SMALL K/H TYPE "B" BLK PLT (RoHS)	19
31	22-003-0169-00	SCREW TAPTITE 3x15 B/H TYPE "B" CHROME TORX T10 W/ COMPRESS (RoHS)	14
32	22-003-0141-90	TAPTITE SCREW 3 X 6 B/H TYPE "B" BLK PLT (RoHS)	6
33	22-003-0172-90	SCREW TAPTITE 3 X 10 B/H TYPE "B" BLK PLT (RoHS)	12
34	22-003-0144-90	TAPTITE SCREW 3.5x8 B/H TYPE "B" NI PLT (RoHS)	4
35	22-003-0145-90	SELF TAPPING SCREW 2.6x8 B/H TYPE "A" NI PLT (RoHS)	4
36	22-003-0147-90	TAPTITE SCREW 4 X 8 C/H TYPE-B BLK (RoHS)	13
37	22-003-0149-90	TAPTITE SCREW 3X6 PAN HEAD TYPE "B" NI PLT (RoHS)	21
38	22-003-0159-90	SCREW TAPTITE 3x5 B/H TYPE "B" NI PLT (RoHS)	22
39	22-003-0161-90	SCREW TAPTITE 3.5x10 B/H TYPE "B" NI PLT (RoHS)	1
40	22-005-0032-00	SPRING WASHER ID3.2 x OD5.6 x 0.9 THK. (RoHS)	26
41	22-005-0033-00	SPRING WASHER ID8.5 x OD12.5 x 1.9 THK. (RoHS)	1
42	NSP***	WASHER SPRING ID4 x OD7 x 1 THK. (RoHS)	
43	22-006-0081-00	WASHER STEEL ID3.5 x OD8 x 0.4 THK. ZN PLT (RoHS)	12
44	22-006-0082-00	WASHER METAL ID8.5 x OD30 x 2 THK. (RoHS)	1
45	22-006-0089-00	WASHER METAL ID8.5 x OD16 x 1 NI PLT (RoHS)	1
46	22-006-0091-90	WASHER PVC ID4.2 x OD8.2 x 0.5mm (RoHS)	6
47	22-006-0111-90	WASHER RUBBER ID8.5x28x2.0mm BLACK (RoHS)	1
48	NSP***	NUT M4 X 3.2mm 0.7p (RoHS)	
49	22-007-0079-00	HEX NUT M8 x 6.5 THK (RoHS)	1
50	22-007-0081-00	NUT M3 X 2.4mm (RoHS)	7
51	22-008-0027-90	WASHER EXTERNAL TOOTH M3 ID3.2 x OD6.5x0.4 THK NI PLT (RoHS)	4
52	NSP***	WASHER OUTER TOOTH ID4.2xOD8.2x0.4 THK. NI PLT (RoHS)	
53	23-232-0010-92	BOTTOM CABINET T775 (RoHS)	1
54	23-236-0007-92	TOP COVER T775 (NEW PAINTED PPG GREY) (RoHS) [FOR GRAPHITE VERSION]	1
	23-236-0016-90	TOP COVER T775 (PAINTED NAD SILVER) (RoHS) [FOR TITANIUM VERSION]	1
55	23-237-0015-90	PANEL - SVIDEO T775 (RoHS)	1
56	23-237-0016-90	PANEL - VOLUME T775 (RoHS)	1
57	23-237-0017-90	PANEL - PRE-OUT T775 (RoHS)	1
58	23-237-0012-94	REAR PANEL T775 (AH) (RoHS) [FOR 120V VERSION]	1
	23-237-0011-94	REAR PANEL T775 (C) (RoHS) [FOR 230V VERSION]	1
59	23-237-0032-92	FASCIA T775 GRAPHITE (RoHS) [FOR GRAPHITE VERSION]	1
	23-237-0048-90	FASCIA T775 TITANIUM (RoHS) [FOR TITANIUM VERSION]	1
60	23-237-0013-90	PANEL - DIGITAL & HDMI T775 (RoHS)	1

61	23-237-0007-92	PLASTIC INNER PANEL T775 GRAPHITE (RoHS) [FOR GRAPHITE VERSION]	1
	23-237-0008-92	PLASTIC INNER PANEL T775 TITANIUM (RoHS) [FOR TITANIUM VERSION]	1
62	23-237-0057-90	PANEL - COMPONENT VIDEO / iPOD T175/785 (RoHS)	1
63	24-031-0007-90	STATIC COVER T775 (PET)(RoHS)	1
64	25-005-0118-90	HEX SPACER AF5.5 H8+6 (RoHS)	1
65	25-005-0124-90	HEX SPACER AF5.5 H9.5+6 (RoHS)	2
66	25-005-0122-90	HEX SPACER AF5.5 H19.8 (RoHS)	2
67	25-006-0043-90	PCB SUPPORTER "KSS" (H=9.6mm PCB HOLE 4mm) CS-0610 (RoHS)	3
68	25-006-0047-90	PCB CARD GUIDE CG-250(RoHS)	6
69	25-006-0050-90	PCB WIRE HOLDER NYLON MIS-2 (RoHS)	1
70	25-008-0404-90	FRONT LENS TINT COLOR TXX5 AH (RoHS) [FOR 120V VERSION]	1
	25-008-0405-90	FRONT LENS TINT COLOR TXX5 CE (RoHS) [FOR 230V VERSION]	1
71	25-008-0409-90	POWER LED LENS - ROUND #2 MILKY WHITE (RoHS)	1
72	25-014-0030-90	RUBBER FOOT ID14xOD26x3 PORON HH-48C (RoHS)	4
73	25-016-0033-90	FOAM 100x7x8mm BLK (UL GRADE) W/NITTO500 (RoHS)	2
74	25-017-0278-90	BUSHING NYLON OD 16.5 X 9.3 X 3.5mm (RoHS)	1
75	25-018-0052-90	TRANSFORMER INSULATOR DIA.110 X 1.5mm (RoHS)	1
76	25-020-0431-90	FIBRE PAPER 226x48x0.8mm (RoHS)	1
77	25-020-0441-92	FIBRE PAPER 210x140x0.8mm UL GRADE (RoHS)	1
78	25-020-0475-90	INSULATOR TO-3P MICA 22x27x0.125 W/HOLE (RoHS)	14
79	25-020-0483-90	INSULATOR - PC SHEET DSP BD TXX5 (RoHS)	1
80	25-021-0004-90	RUBBER KEYPAD TXX5 (RoHS)	1
81	25-022-1244-90	HEATSINK MOUNTING BRACKET (RoHS)	1
82	25-022-1247-93	MAIN BOARD BRACKET T775 (RoHS)	1
83	25-022-1248-90	PHONE BRACKET T775 (RoHS)	1
84	25-022-1249-90	REAR HTSK SUPPORT BRACKET (RoHS)	1
85	25-022-1250-90	HTSK HANDLE PLATE (RoHS)	1
86	25-022-1279-90	X'FORMER SUPPORT BRACKET T762 (RoHS)	1
87	25-022-1280-90	SIDE CAP - L T775 GRAPHITE (RoHS) [FOR GRAPHITE VERSION]	1
	25-022-1392-90	SIDE CAP - L T775 TITANIUM (RoHS) [FOR TITANIUM VERSION]	1
88	25-022-1281-90	SIDE CAP - R T775 GRAPHITE (RoHS) [FOR GRAPHITE VERSION]	1
	25-022-1393-90	SIDE CAP - R T775 TITANIUM (RoHS) [FOR TITANIUM VERSION]	1
89	25-022-1282-90	PCB GUIDE BRACKET T775/T785 (RoHS)	1
90	25-022-1283-90	SUBFASCIA T775(RoHS)	1
91	25-022-1284-92	FAN MOUNTING COVER T775 (RoHS)	1
92	25-022-1285-91	LARGE FAN MOUNTING BRACKET T772 (RoHS)	1
93	25-022-1287-90	L-SHAPE BRACKET 13 X 10mm (RoHS)	1
94	25-022-1326-90	SPACER BRACKET 5.0mm (RoHS)	6
95	25-022-1341-90	FAN SCREW BRACKET 4.5mm (RoHS)	20
96	25-022-1381-90	FAN GUARD 60mm 40G00002 (RoHS)	5
97	25-024-0315-90	PLASTIC FOOT DOME SHAPE (RoHS)	4

98	25-024-0322-90	DUAL BUTTON T765 GRAPHITE (RoHS) [FOR GRAPHITE VERSION]	4
	25-024-0323-90	DUAL BUTTON T765 TITANIUM (RoHS) [FOR TITANIUM VERSION]	4
99	25-024-0324-90	VIDEO COVER T765 GRAPHITE (RoHS) [FOR GRAPHITE VERSION]	1
	25-024-0325-90	VIDEO COVER T765 TITANIUM (RoHS) [FOR TITANIUM VERSION]	1
100	25-024-0326-90	RUBBER BRACKET T765 (MOLD BLACK) (RoHS)	1
101	25-024-0330-90	FAN RUBBER (RoHS)	20
102	16-004-0888-90	BINDING POST CAP BLACK T765 (RoHS) [FOR 230V VERSION]	9
103	NSP***	BINDING POST RED T765 (RoHS) [FOR 230V VERSION]	
104	25-006-0053-90	PCB CARD GUIDE CG-38 (RoHS)	6
105	25-022-1601-90	SIDE SUPPORT BRACKET T765 BLACK (RoHS)	1
106	25-022-1603-90	CARD GUIDE BRACKET - TOP (RoHS)	1
107	25-022-1409-90	SHIELDING PLATE 0.6MM T775 (RoHS)	1
108	NSP***	BINDING POST BASE 4P BLACK T775 / T785 (RoHS)	
109	NSP***	BINDING POST KNOB ASSY BLACK T775 / T785 (RoHS)	
110	NSP***	BINDING POST KNOB ASSY RED T775 / T785 (RoHS)	

***NOTE: Binding Post assembly Exploded View locations: 42, 48, 103, 108, 109 & 110
Part number: 50-927-0775-90

Enlarged in detail on next page

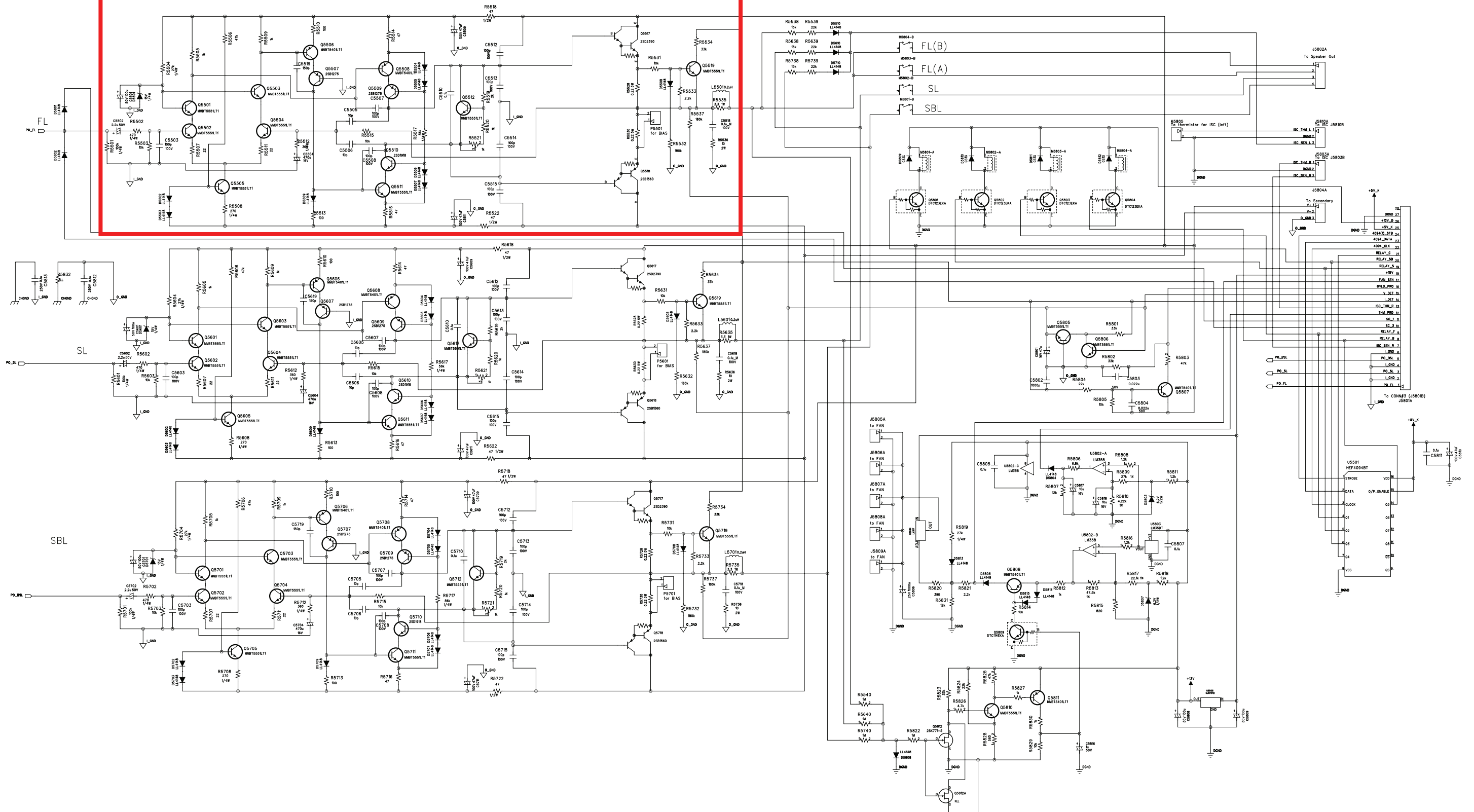

Components in the red boxes are included in the spare part kit part number 52-940-0765-90

T775 Power amplifier components (single channel)		
Part Number	Description	Qty
02-005-0063-90	RES WW 0.22 OHM 5% 5W	2
02-007-0328-90	RES SMD 47 OHM 5% 1/2W	2
03-009-0137-90	CAP ELEC SMD 100uF 50V +/-20%	1
03-009-0141-90	CAP ELEC SMD 2.2uF 50V +/-20%	1
03-009-0144-90	CAP ELEC SMD 470uF 16V +/-20%	1
03-009-0145-90	CAP ELEC SMD 47uF 100V +/-20%	2
04-006-0021-90	SMD DIODE LL4148 SOD80	8
04-007-0035-90	DIODE ZENER SMD 15V 500mW 5% SOD123 MMSZ5245B	1
05-001-0100-90	TRANSISTOR PW DARLINGTON PNP 10A/150V HFE P 6500-20000 TO-3PB 2SB1560 (w/ MICAx1)	1
05-001-0101-90	TRANSISTOR PW DARLINGTON NPN 10A/150V HFE P 6500-20000 TO-3PB 2SD2390 (w/ MICAx1)	1
05-004-0018-90	SMD Transistor MMBT5551LT1G NPN SOT-23	8
05-004-0019-90	SMD Transistor MMBT5401LT1G PNP SOT-23	2
05-004-0030-90	XTR 2SD1918 NPN POWER 160V/1.5A 80MHz HFE 120-390	1
05-004-0031-90	XTR 2SB1275 PNP POWER 160V/1.5A 50MHz HFE 82-180	2

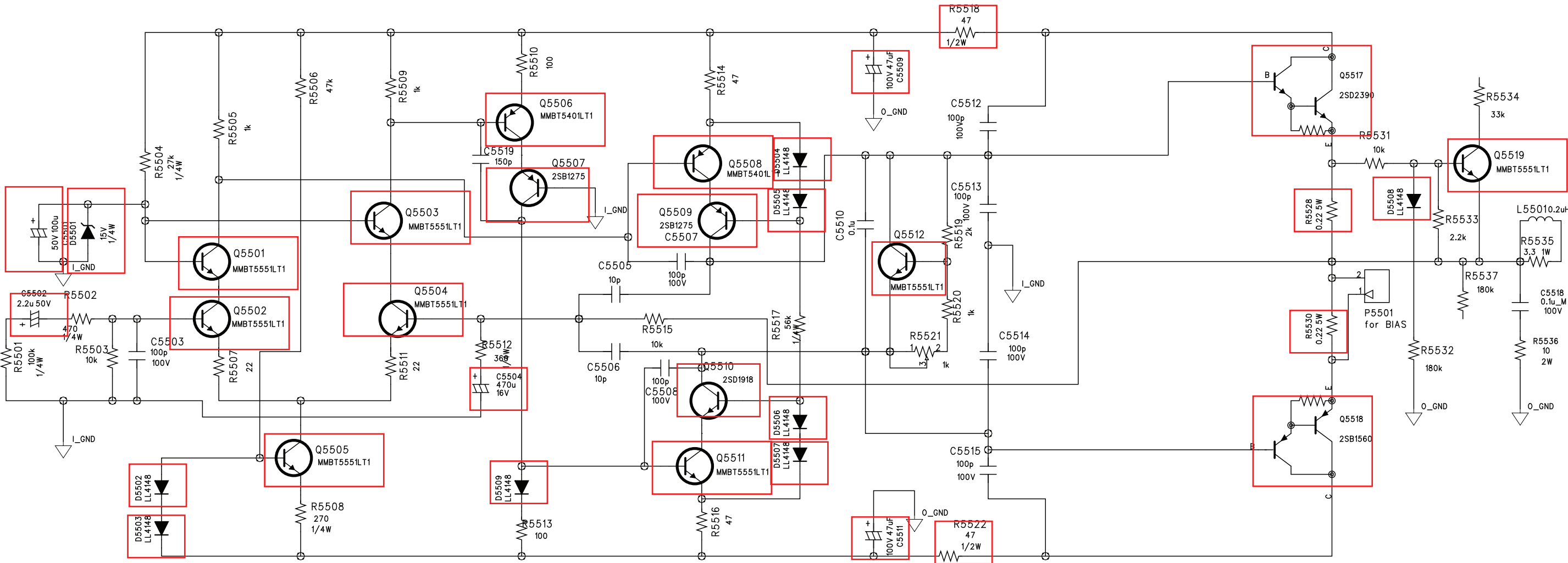

PACKING DIAGRAM & PARTS LIST

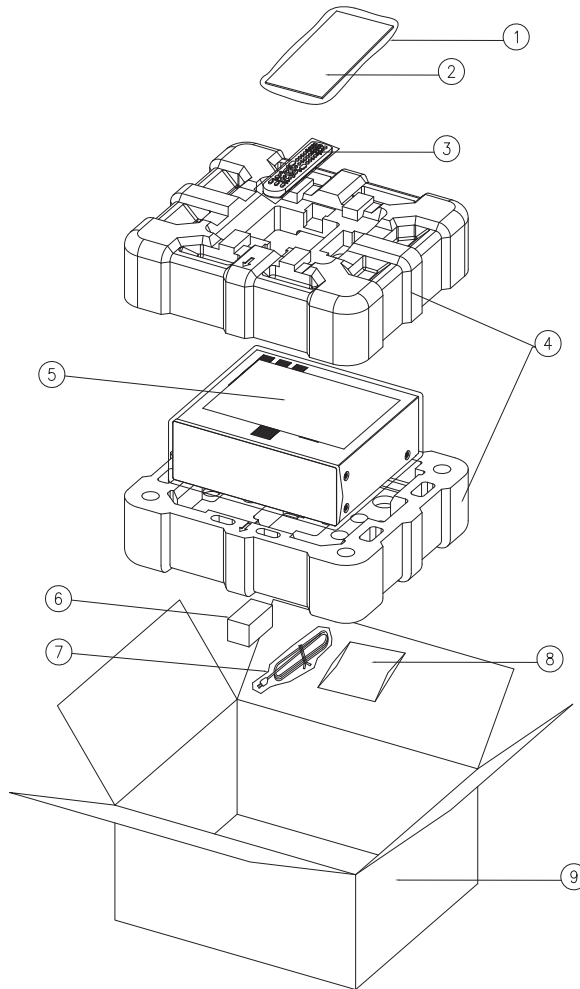

ITEM	PART NO.	DESCRIPTION	QTY
1	24-003-0127-90	POLYBAG MAUNAL (RoHS)	
2	24-004-1958-90	T775 OWNER'S MANUAL GB/F/D/NL W/WEEE (RoHS)	1
2	24-004-1959-90	T775 OWNER'S MANUAL E/I/P/S W/WEEE (RoHS)	1
2	24-004-2098-90	T775 QUICK START MANUAL A3 SIZE (RoHS)	1
3	28-008-0004-92	REMOTE CONTROLLER NAD HTR-3 (RoHS)	1
4	24-006-0721-90	POLYFOAM TOP/BOTTOM T775 (RoHS)	2
5	24-003-0130-90	POLYBAG MAIN UNIT (RoHS)	1
5	24-003-0131-90	PROTECTIVE COVER (RoHS)	1
5	24-005-0890-90	A3 WHITE PAPER 80G (RoHS)	1
5	40-001-0108-90	DESSICANT BAG 20g	1
6	09-001-0005-90	MICROPHONE SET WITH PACKING AUDYSSEY(RoHS)	1
6	24-005-1015-90	LABEL TAG 'AUDYSSEY MICROPHONE' (RoHS)	1
7	17-004-0007-00	AC Cord 110V 3PINS 125V/13A SJT AWG16/3C UL/CSA L=2M [FOR AH VERSION]	1
	17-004-0008-00	AC CORD CE 3 PINS 16A 250V LF L=6'7" LP-34 H05VV-F 3C LS- 60 [FOR C, CT VERSION]	1
7	24-003-0120-90	POLYBAG CORD (RoHS)	1
8	15-015-0001-90	ANTENNA ADAPTER 300 TO 75 OHM (RoHS)	1
8	24-003-0122-90	Polybag Manual J9 (RoHS)	1
8	24-004-1936-90	WARRANTY CARD (RoHS)	1
8	25-027-0001-90	FM WIRE ANTENNA W/Y-TERMINALS (RoHS)	1
8	25-027-0002-90	ANTENNA AM LOOP ASSY W/STAND S0160BL-04 (RoHS)	1
8	28-008-0005-90	REMOTE CONTROLLER NAD ZR-4 (RoHS)	1
9	24-001-0664-90	MASTER CARTON BOX T765 (RoHS)	1