

Side view
(flipped up vertically from view below)

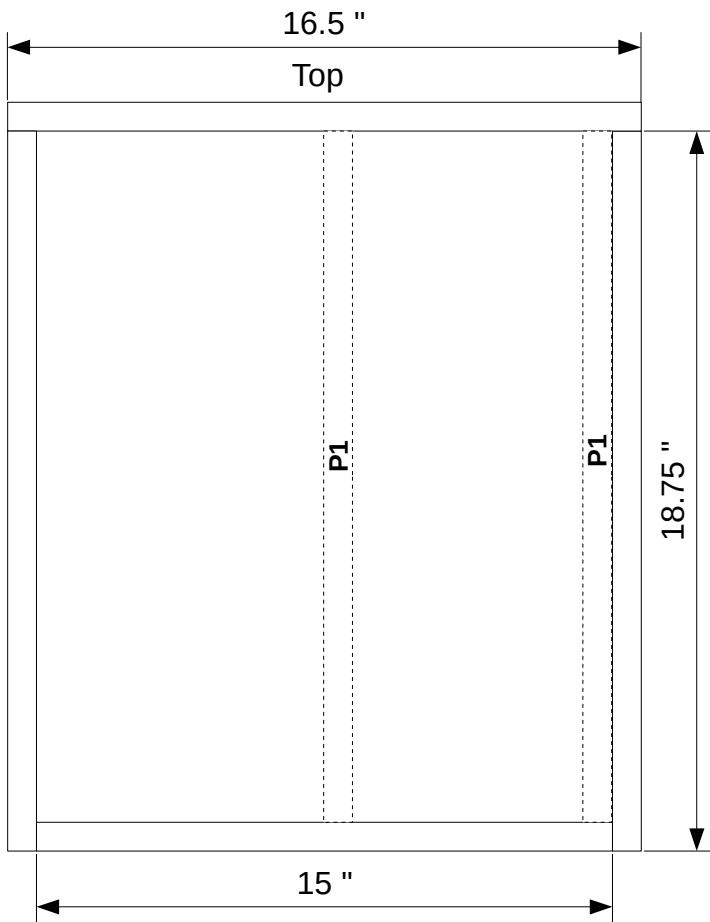

Side view
(rotated 90 degrees from view to the left)

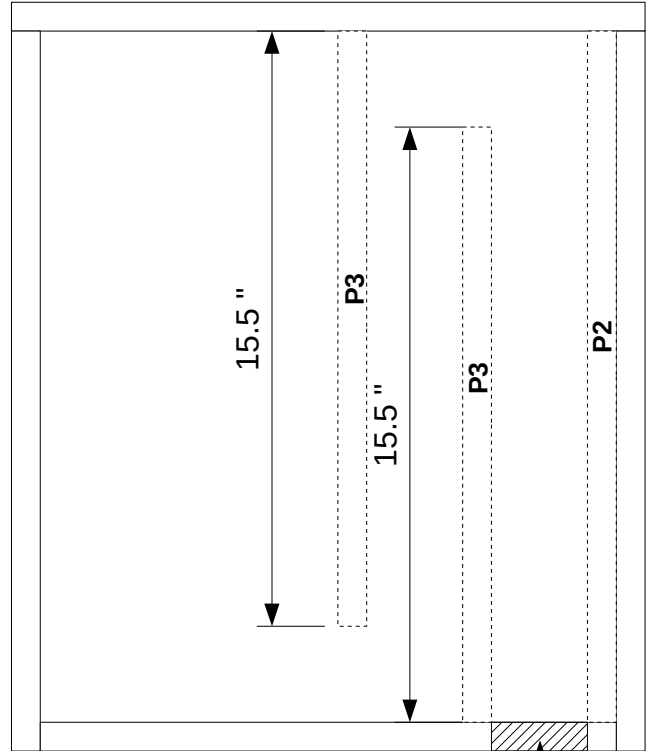

Port opening

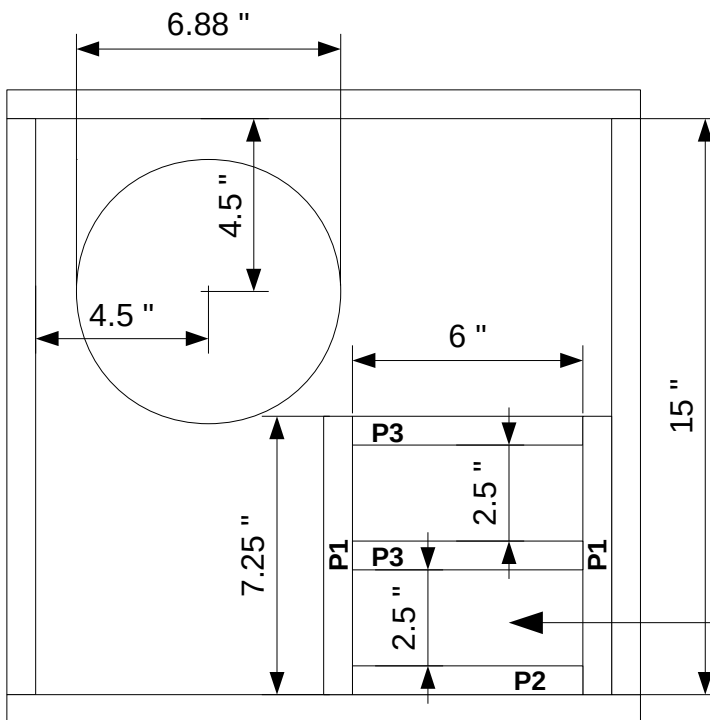

Port opening

Bottom view

Cuts required:

- 1 – top 16.5" x 16.5"
- 1 – bottom 15" x 15"
- 2 – sides 15" x 18.75"
- 2 – sides 16.5" x 18.75"
- 2 – P1 18" x 7.25"
- 1 – P2 18" x 6"
- 2 – P3 15.5" x 6"