

PCB-mounting filter

- 0.5-10A current ratings
- PCB-mounting
- Low profile
- Nennströme von 0,5 bis 10A
- Printmontage
- Raumsparender Aufbau
- Courants de service de 0,5 à 10A
- Montage sur circuit imprimé
- Hauteur réduite

FN 405

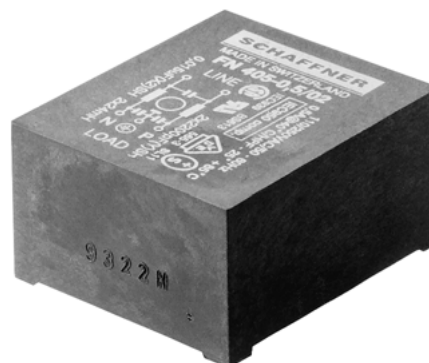

Filter selection table

Choose the family **FN xxx** with the required current rating and features, and add **/??** to determine input/output (line/load) connection style. Example: FN 405-6/02 is a 6A filter with pin connections.

Approvals



Family	Connections	Current ratings	Inductance	Housing	Weight
	I	A at 40°C (25°)	L mH		g
FN 405 -0.5 /??	/02	0.5 (0.6)	24	KA4	40
FN 405 -1 /??	/02	1 (1.2)	10	KA4	40
FN 405 -3 /??	/02	3 (3.6)	2	KA4	40
FN 405 -6 /??	/02	6 (6.9)	0.8	KA4	40
FN 405 -10 /??	/02	10 (11.5)	0.5	KA4	40

Additional specifications

Filter type	Capacitance Cx nF Cy nF		Maximum leakage μA/phase	Maximum operating voltage VAC Hz		Operating frequency Hz	Hipot test voltage PN→E P→N VAC VDC	
Standard types	15	2.2	190	250	50/60	DC to 400	2000	1100

MTBF at 40°C, 230V, per Mil-HB-217F: 1,600,000 hours.

Electrical schematic

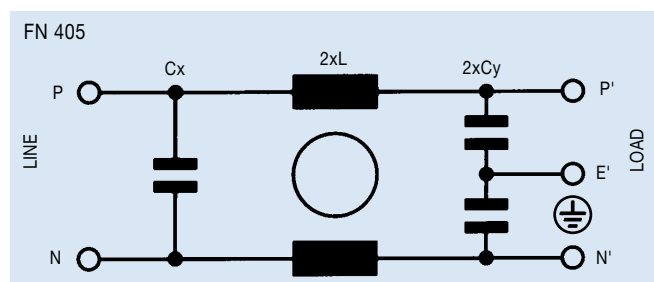

See tables for component values.

FN 405 insertion loss

Per CISPR 17; A = 50Ω/50Ω sym, B = 50Ω/50Ω asym, C = 0.1Ω/100Ω sym, D = 100Ω/0.1Ω sym

0.5 amp types

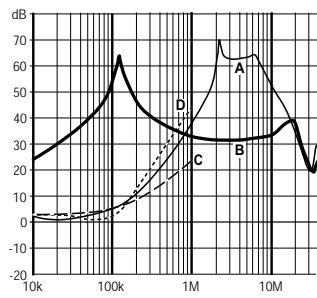

1 amp types

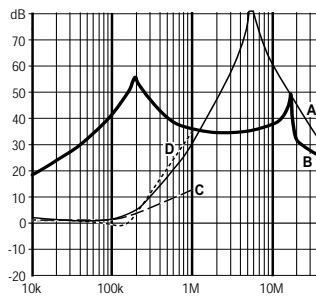

3 amp types

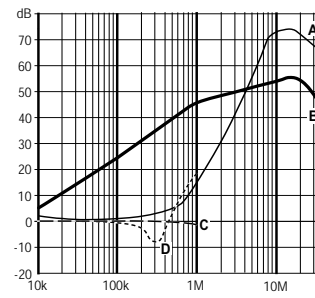

6 amp types

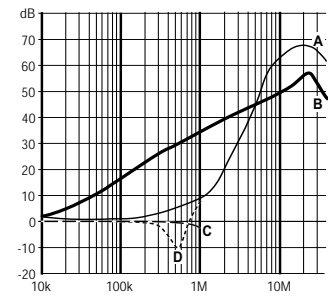

10 amp types

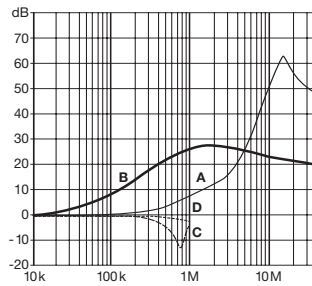

Mechanical data

		Tol. mm
A	36	± 0.5
B	31	± 0.5
C	19.5	± 0.5
E	15	± 0.2
F	17.5	± 0.2
G	0	± 0.2
H	7.5	± 0.2
J	Ø0.7	± 0.1
K	15	± 0.2
Y	5.8	± 0.5

Side view

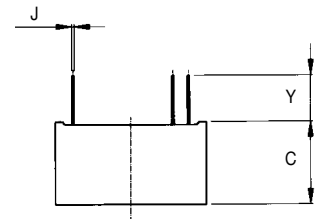

Bottom view

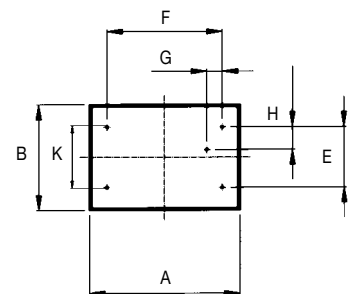

All dimensions in mm; 1 inch = 25.4 mm