

Model No.: C13WH09-08
Product Line: Tymphany

Rev: 1
Last Update: 2017-05-10 14:56:48

Product Description

This is a 5.25 inch 8ohm woofer. Design features in this driver include a damped coated paper cone and cloth dust cap, with rubber surround. Also features a ferrite magnet motor and steel basket. The driver operates effective frequency response between 100Hz-8KHz. It designed to be a high performance transducer.



Mechanical Drawing

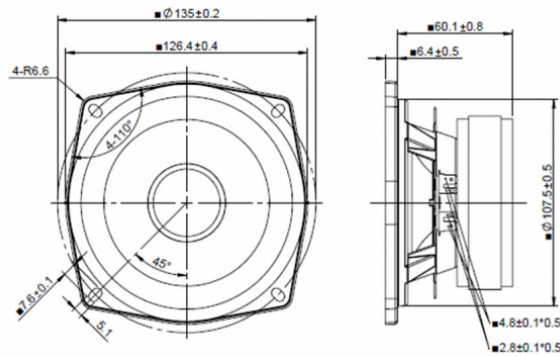

Specifications

DC Resistance	Revc	Ohms	5.4	5.0%	Energy Bandwidth Product	EBP	(1/Qes)*fs	
Minimum Impedance	Zmin	Ohms	6.9	7.5%	Moving Mass	Mms	g	5.8
Voice Coil Inductance	Le	mH	0.32		Suspension Compliance	Cms	um/N	327.6
Resonant Frequency	Fs	Hz	115.44	15%	Effective Cone diameter	D	cm	10.11
Mechanical Q Factor	Qms		0.96		Effective Piston Area	Sd	cm^2	80.2
Electrical Q Factor	Qes	0.5			Effective Volume	Vas	L	2.95
Total Q Factor	Qts	0.33			Motor Force Factor	BL	Tm	6.72
Ratio Fs/Qts	F	Fs/Qts	349.81		Motor Efficiency Factor	β	(T*M^2)/Ohms	8.4
Half Space Sensitivity @2.83V	db@2.83V/1M	dB	90.95	+/- 1.0db	Voice coil former Material	VCfm		ASV
Half Space Sensitivity @1W/1M	db@1W/1M	dB	90.3	+/- 1.0db	Voice coil inner diameter	VCd	mm	25.86
Gap Height	Gh	mm	6		Rated Noise Power	P	W	30
Maximum Linear Excursion	Xmax	mm	2		Test Spectrum Bandwidth		100Hz-8KHz	
Ferrofluid Type	FF				Driver Size	Inch	5.25 in	
Driver Mass	Kg	1.14						

Frequency and Impedance Response

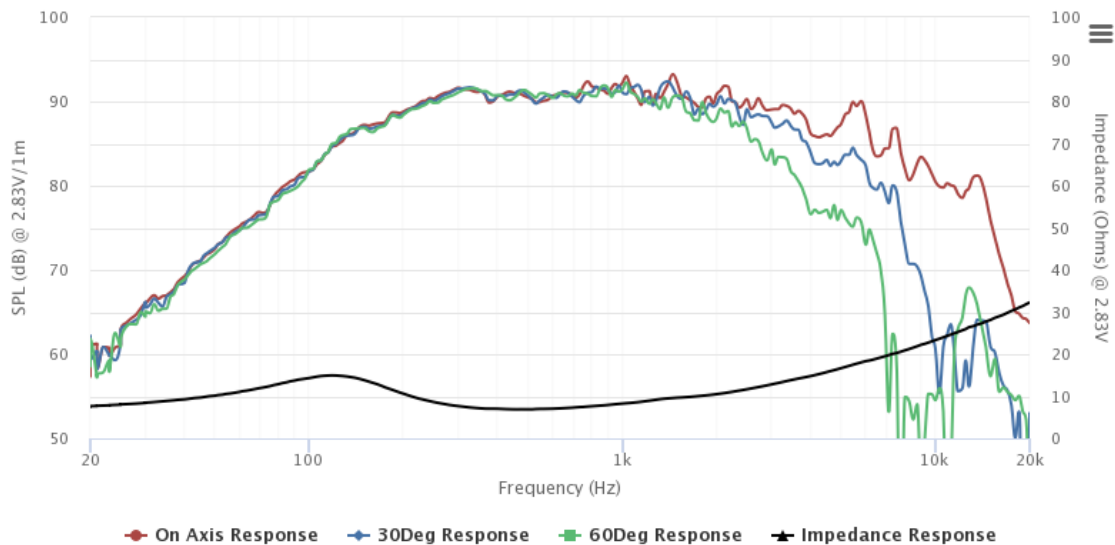

Highcharts.com