

Total Height: 855mm

Total Width: 468mm

Total Depth: 373mm

Difficulty: Moderate

Suitability: Medium / Large Rooms

All interior panels are made from 12mm MDF unless otherwise stated.
External panels are made from 18mm MDF.
All visible surfaces should be veneered.
All joints must be airtight.

Overview

Lowther Loudspeaker Systems Ltd.			
Acousta 116			
Sheet Number:	Date:	Drawing Number:	Material:
1 of 26	10/02/2010	RQ/A3/A116/0002	
Sheet Size:	Drawn By:	Drawing Units:	
A3	R. Quinton	Millimeters	

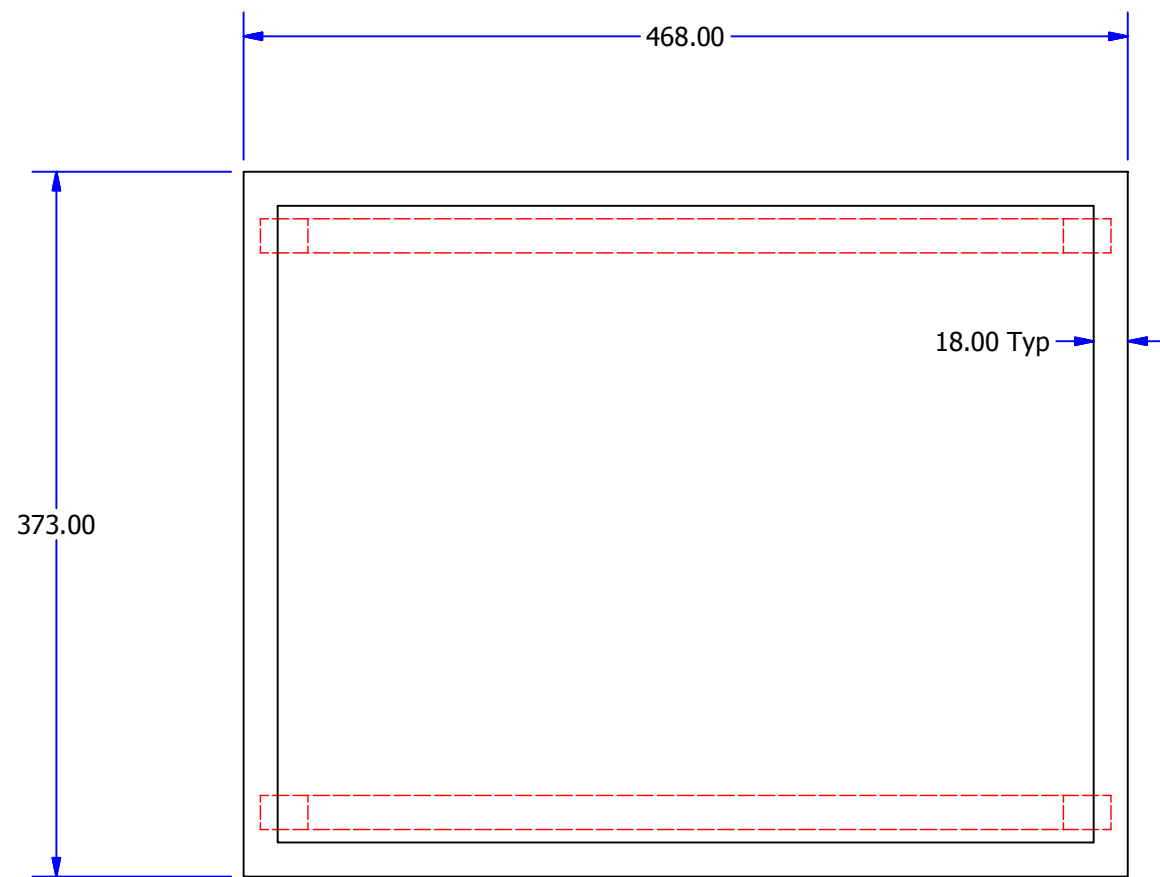

SCALE 1 / 4

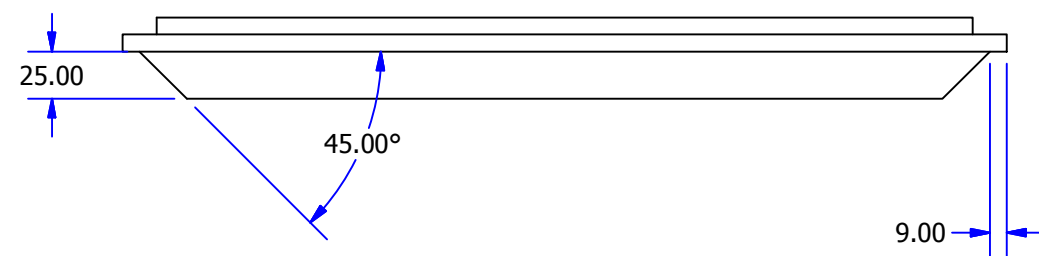
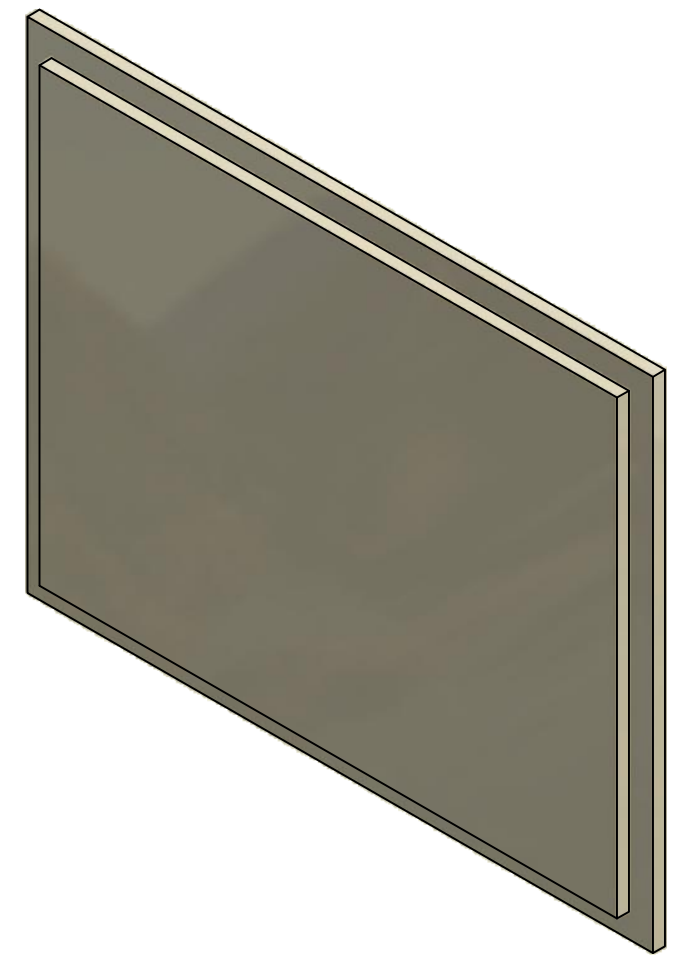
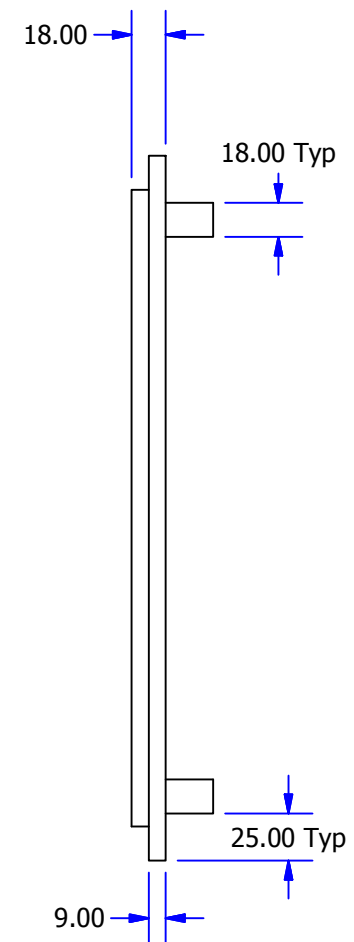

Base Panel & Runners

Lowther Loudspeaker Systems Ltd.			
Acousta 116			
Sheet Number: 2 of 26	Date: 10/02/2010	Drawing Number: RQ/A3/A116/0002	Material: 18mm MDF
Sheet Size: A3	Drawn By: R. Quinton	Drawing Units: Millimeters	

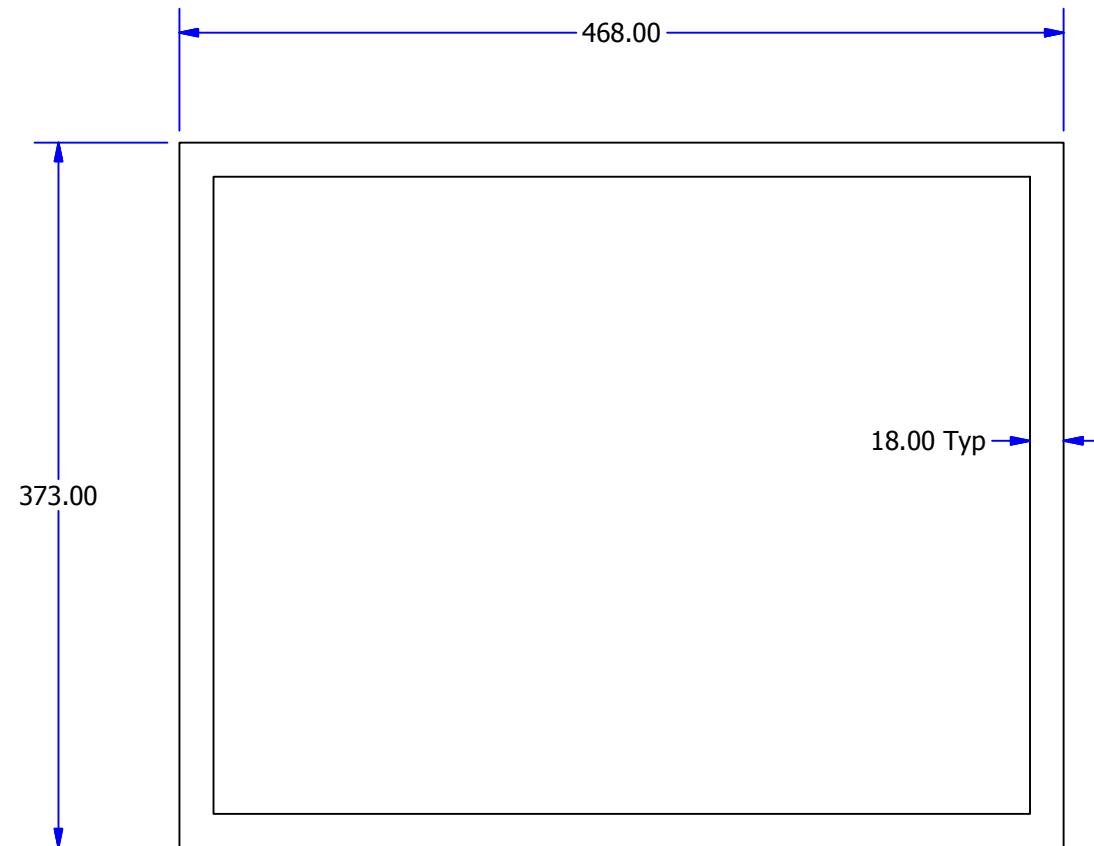

SCALE 1 / 4

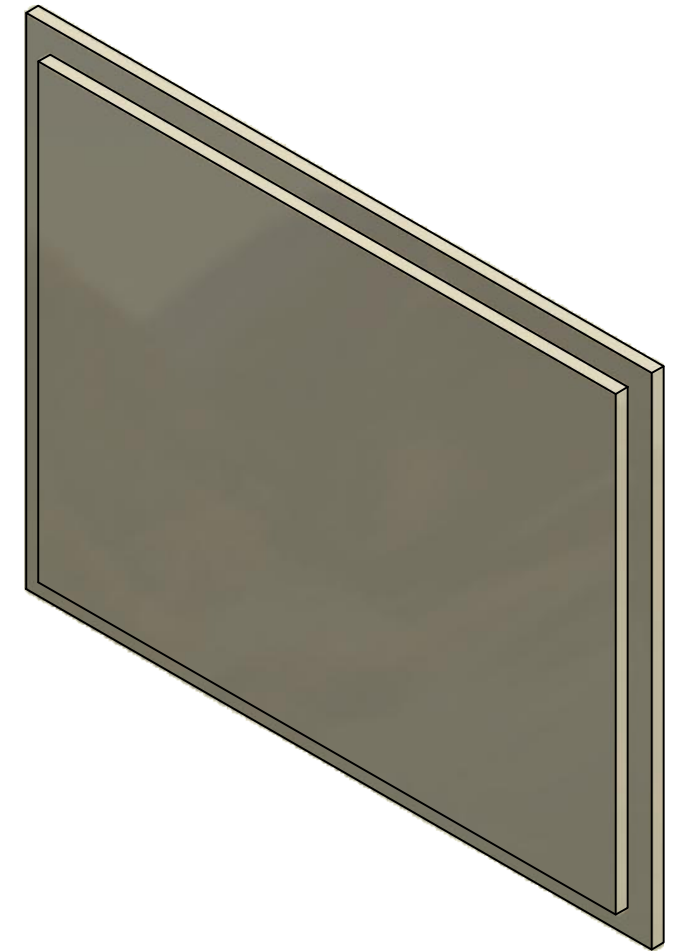
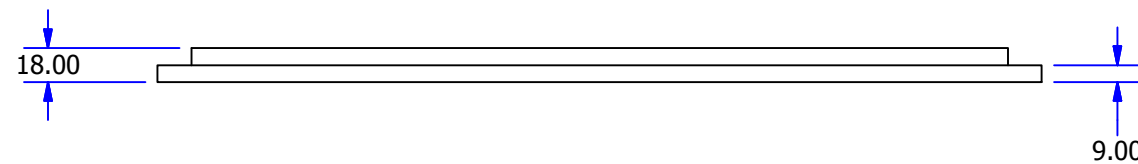

Top Panel

Lowther Loudspeaker Systems Ltd.			
Acousta 116			
Sheet Number: 3 of 26	Date: 10/02/2010	Drawing Number: RQ/A3/A116/0002	Material: 18mm MDF
Sheet Size: A3	Drawn By: R. Quinton	Drawing Units: Millimeters	

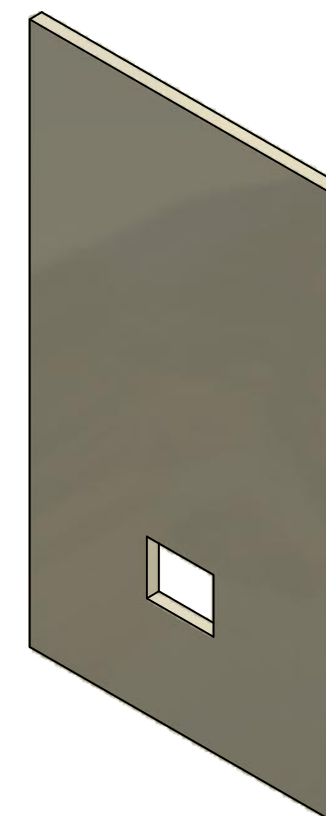
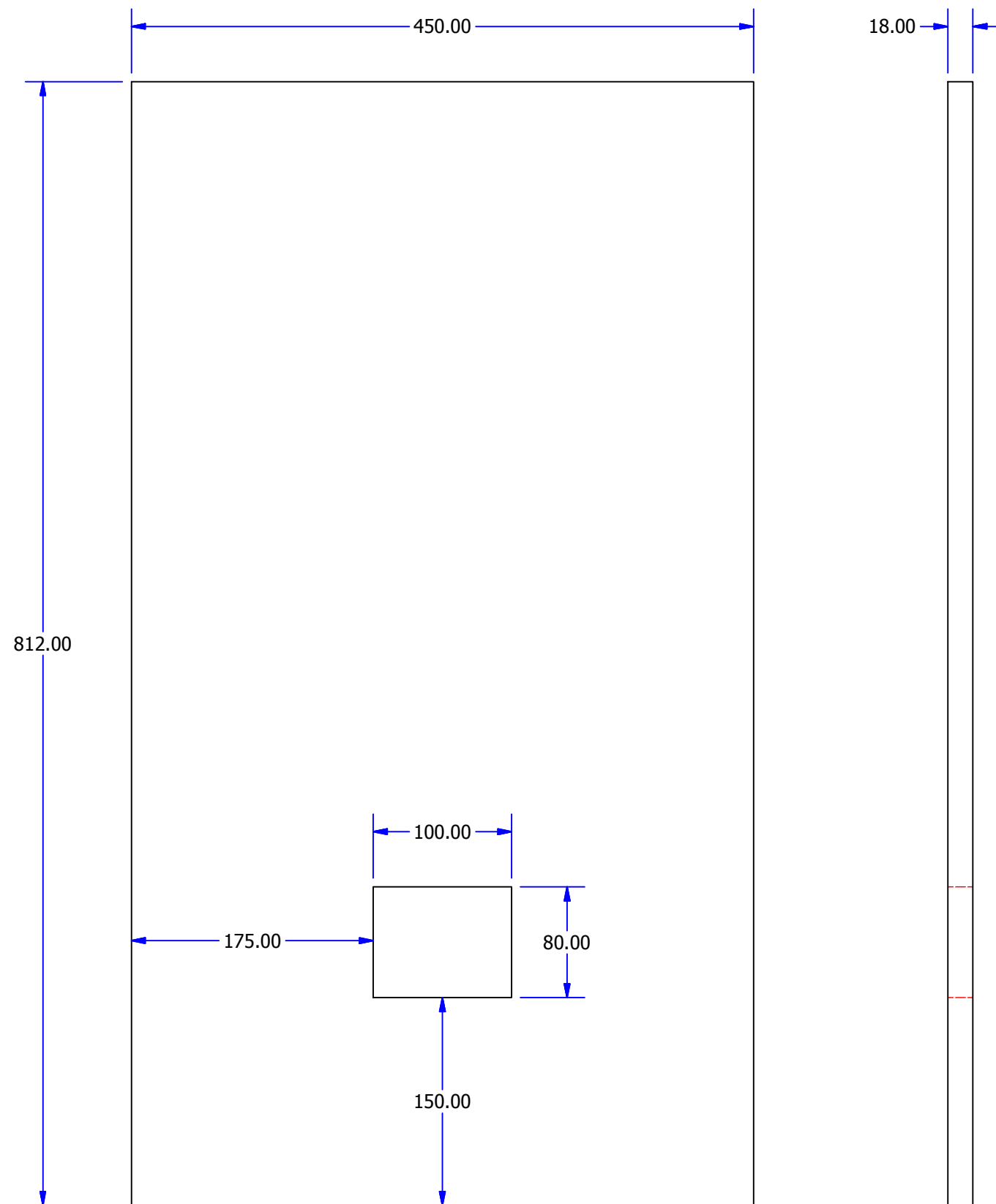

Rear Panel

SCALE 1 / 4

Lowther Loudspeaker Systems Ltd.			
Acousta 116			
Sheet Number: 4 of 26	Date: 10/02/2010	Drawing Number: RQ/A3/A116/0002	Material: 18mm MDF
Sheet Size: A3	Drawn By: R. Quinton	Drawing Units: Millimeters	

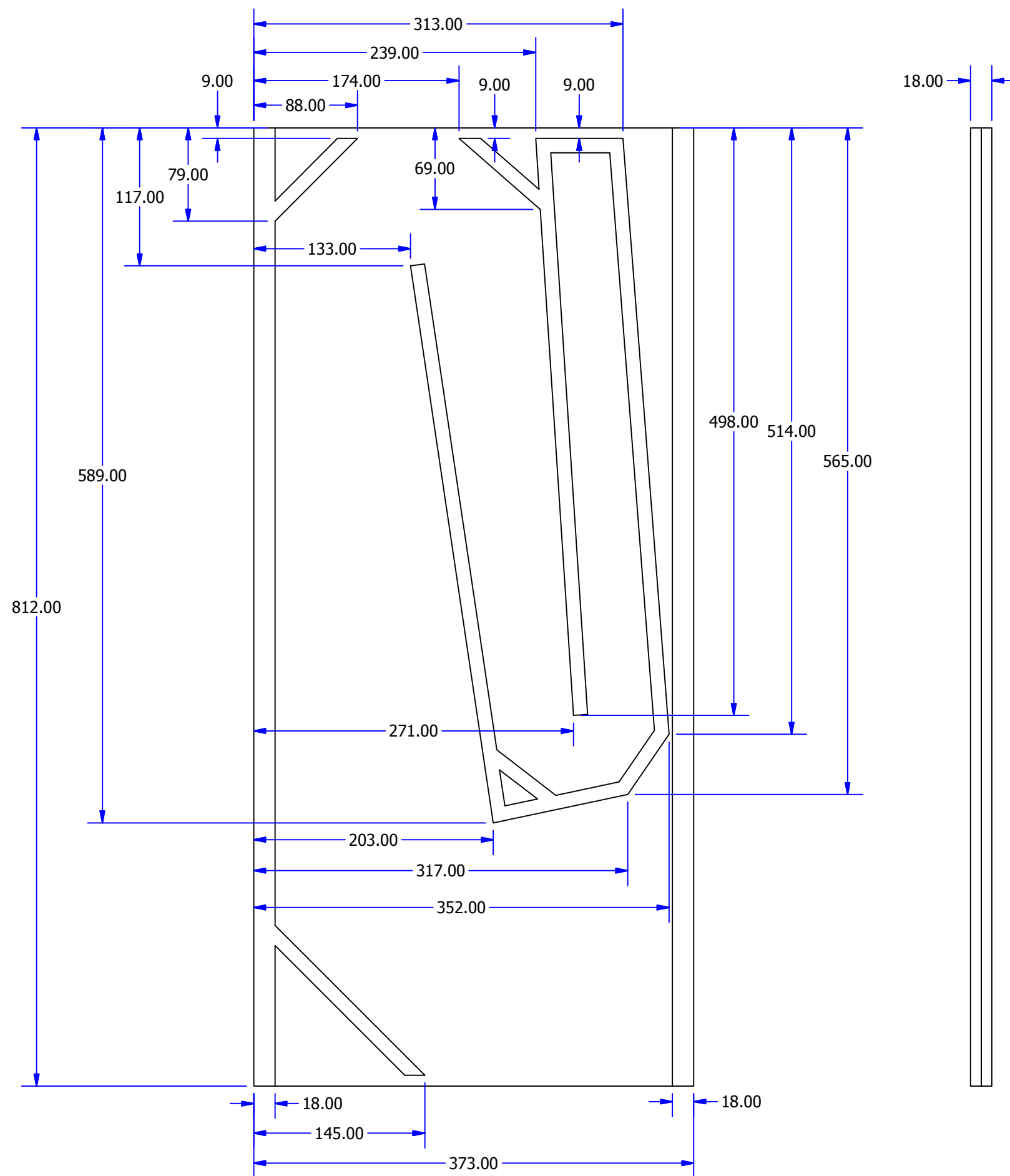

SCALE 1 / 4



All interior panel rebates are at 12mm wide x 9mm deep.
Front & Grill panel rebates are at 18mm wide x 9mm deep.

It is permissible to omit the interior panel rebates and use battens instead. If this is done the width of the full width interior panels should be reduced by 18mm.

Side Panel

Lowther Loudspeaker Systems Ltd.

Acousta 116

Sheet Number: 5 of 26	Date: 10/02/2010	Drawing Number: RQ/A3/A116/0002	Material: 18mm MDF
Sheet Size: A3	Drawn By: R. Quinton	Drawing Units: Millimeters	

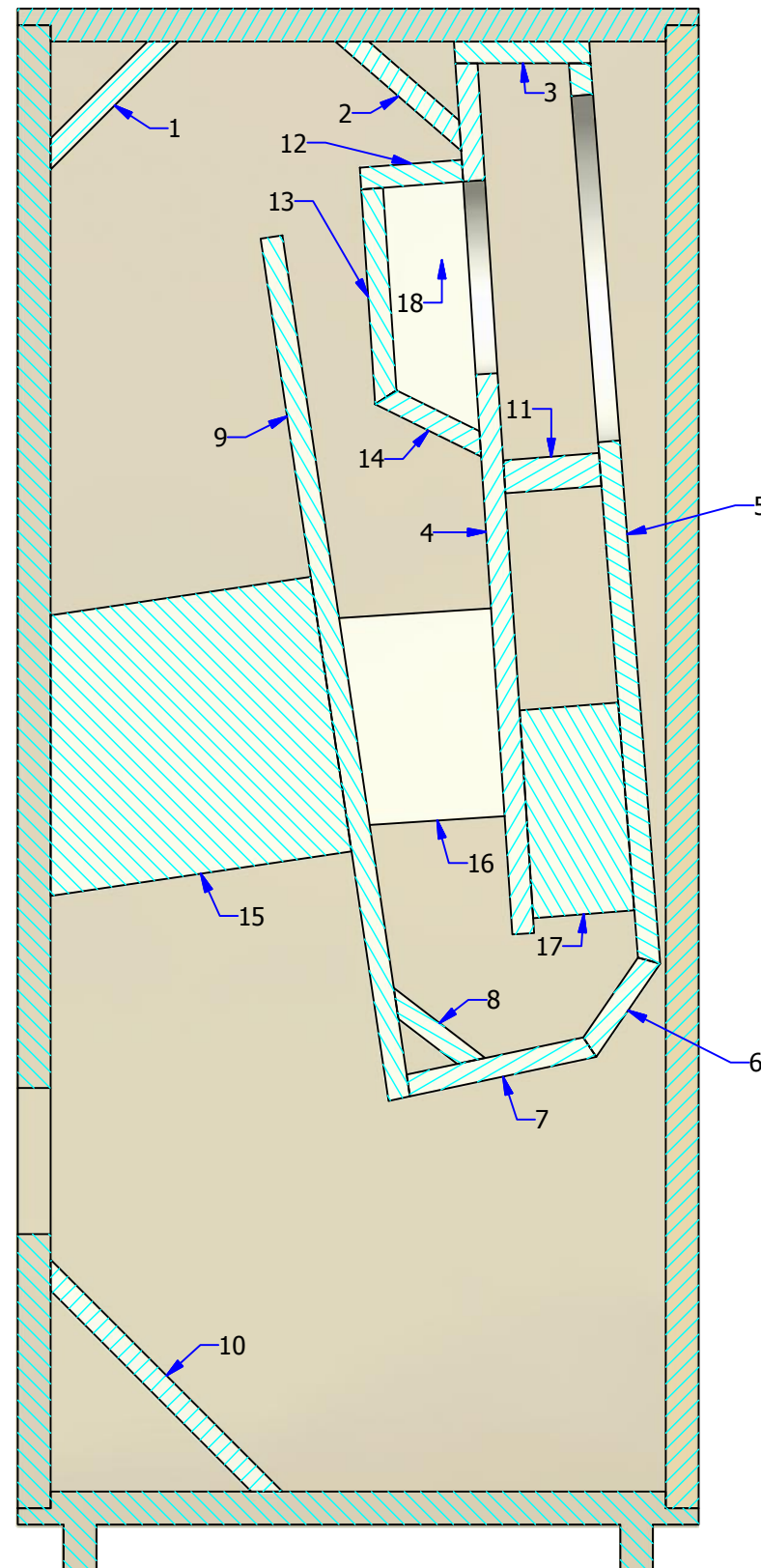

Interior Panels Reference

Lowther Loudspeaker Systems Ltd.			
Acousta 116			
Sheet Number:	Date:	Drawing Number:	Material:
6 of 26	10/02/2010	RQ/A3/A116/0002	
Sheet Size:	Drawn By:	Drawing Units:	
A3	R. Quinton	Millimeters	

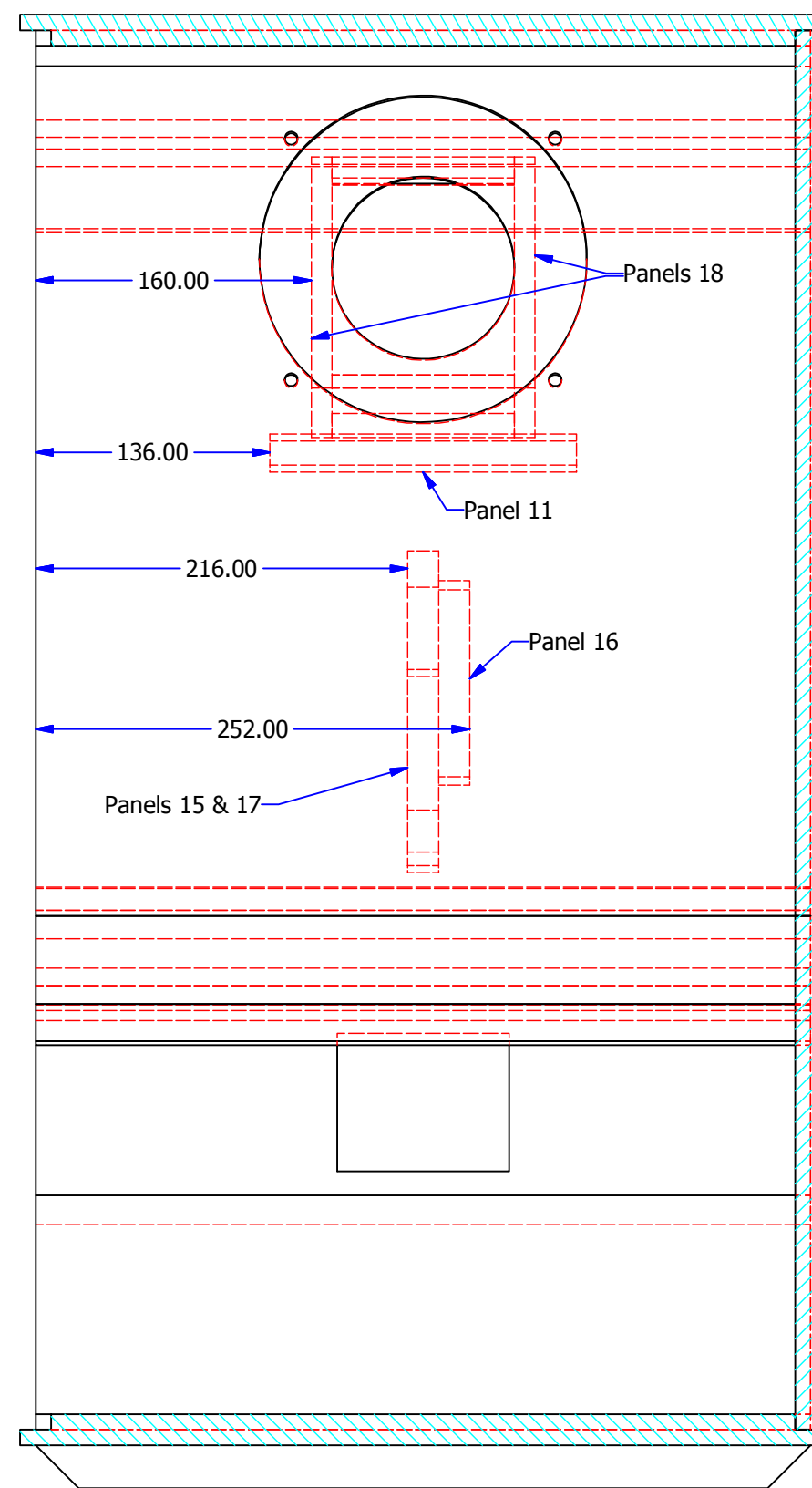
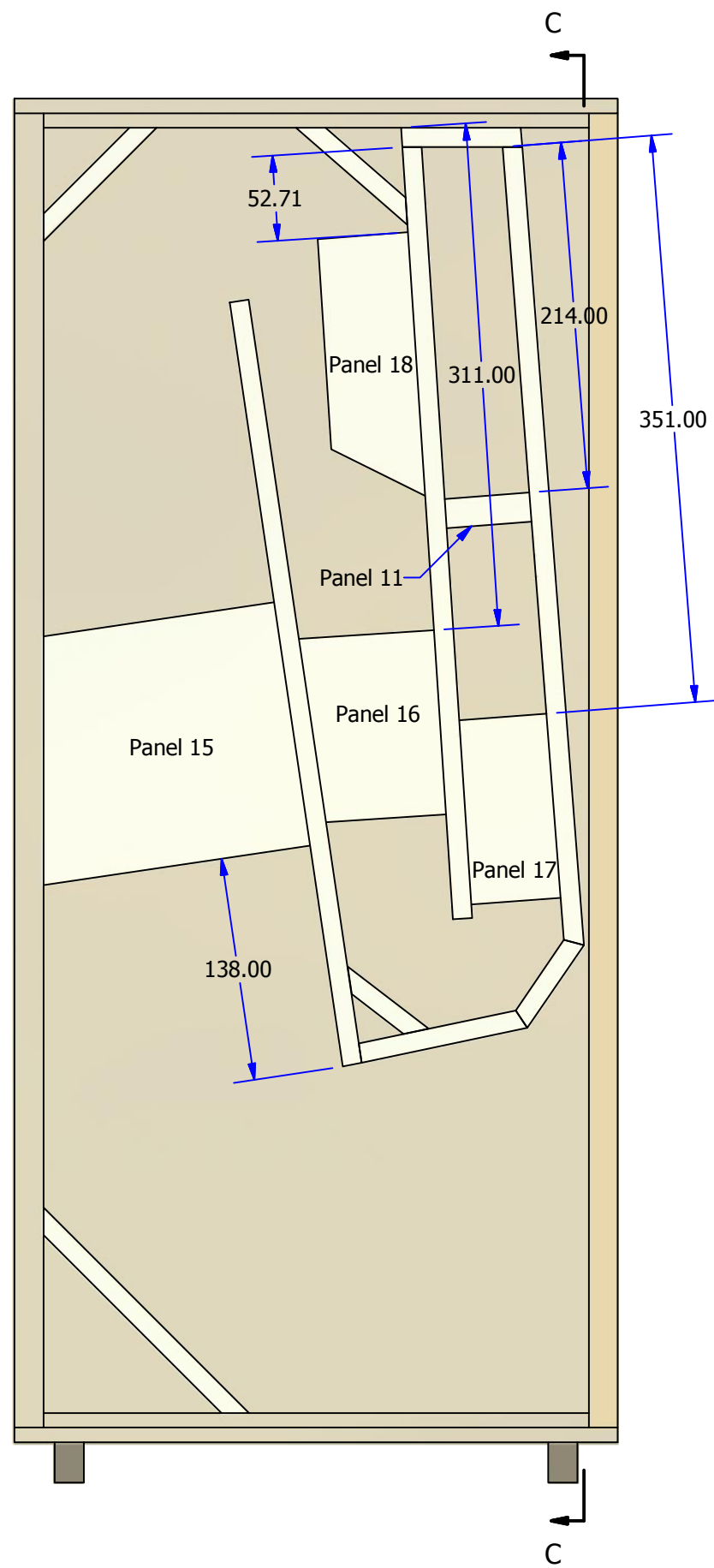

SECTION C-C

Dividers & Box Reference

Lowther Loudspeaker Systems Ltd.			
Acousta 116			
Sheet Number: 7 of 26	Date: 10/02/2010	Drawing Number: RQ/A3/A116/0002	Material:
Sheet Size: A3	Drawn By: R. Quinton	Drawing Units: Millimeters	

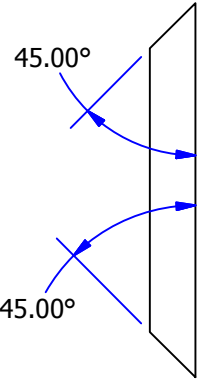
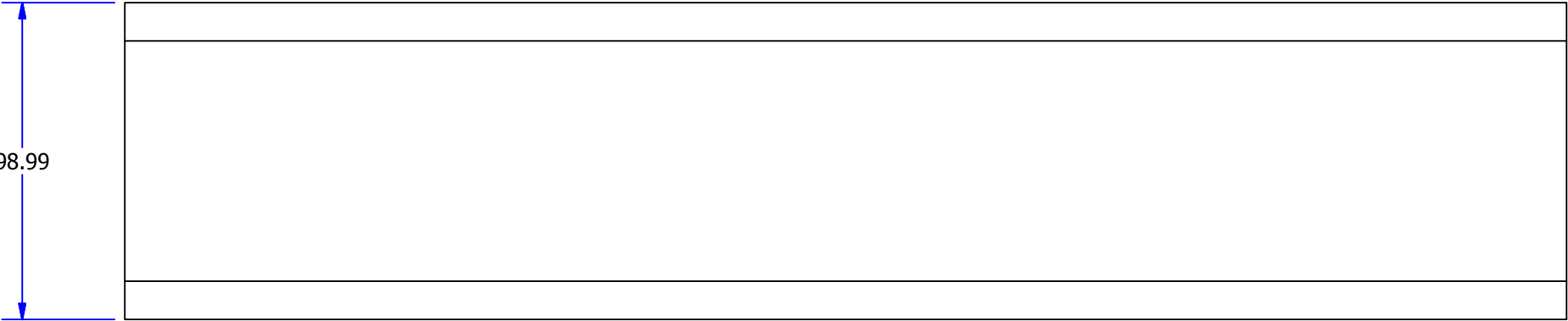
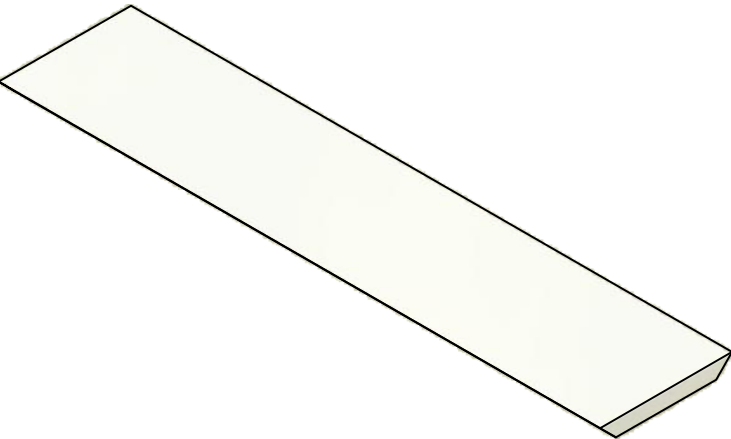
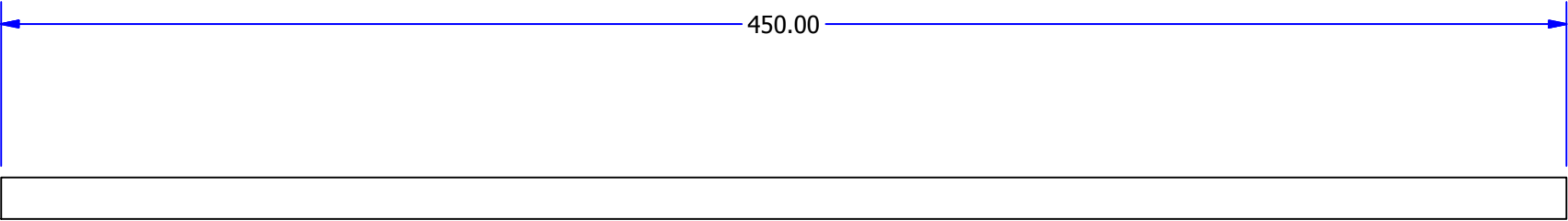

SCALE 1 / 2

Panel 1

Lowther Loudspeaker Systems Ltd.			
Acousta 116			
Sheet Number: 8 of 26	Date: 10/02/2010	Drawing Number: RQ/A3/A116/0002	Material: 12mm MDF
Sheet Size: A3	Drawn By: R. Quinton	Drawing Units: Millimeters	

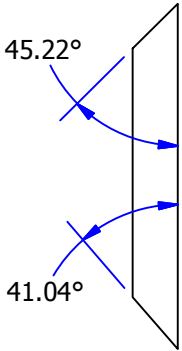
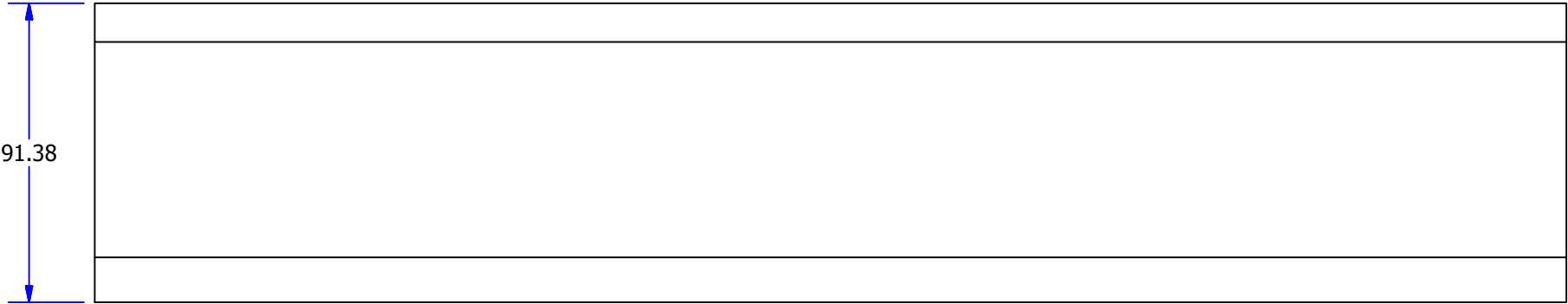
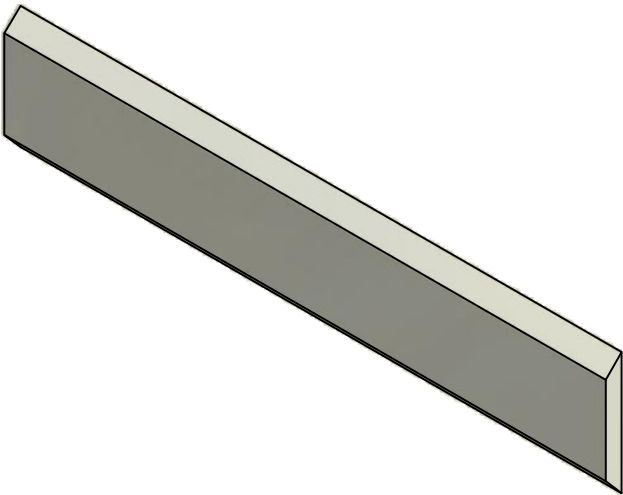
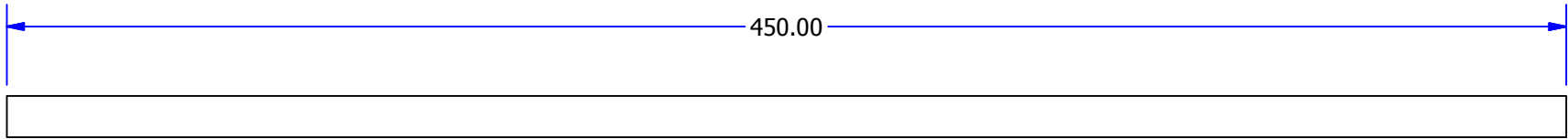

SCALE 1 / 2

Panel 2

Lowther Loudspeaker Systems Ltd.			
Acousta 116			
Sheet Number: 9 of 26	Date: 10/02/2010	Drawing Number: RQ/A3/A116/0002	Material: 12mm MDF
Sheet Size: A3	Drawn By: R. Quinton	Drawing Units: Millimeters	

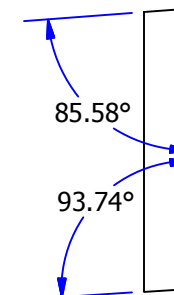
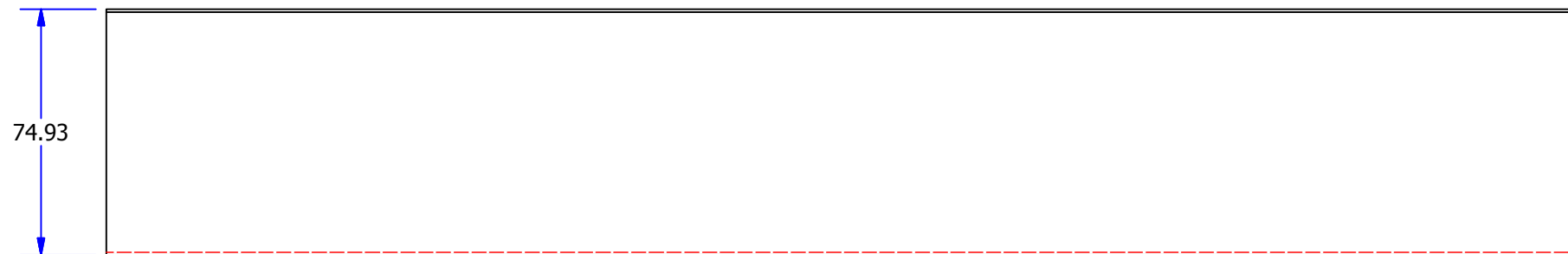
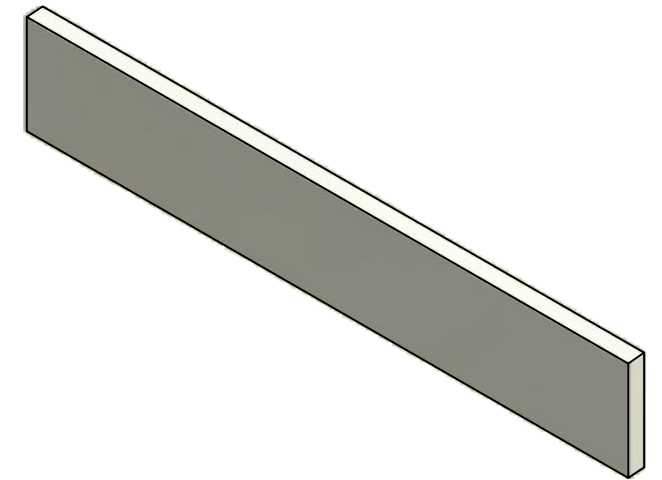
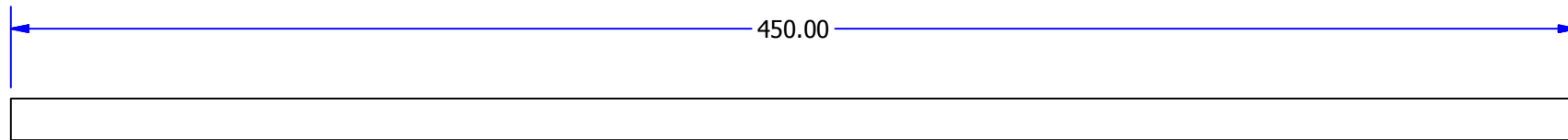

SCALE 1 / 2

Panel 3

Lowther Loudspeaker Systems Ltd.			
Acousta 116			
Sheet Number: 10 of 26	Date: 10/02/2010	Drawing Number: RQ/A3/A116/0002	Material: 12mm MDF
Sheet Size: A3	Drawn By: R. Quinton	Drawing Units: Millimeters	

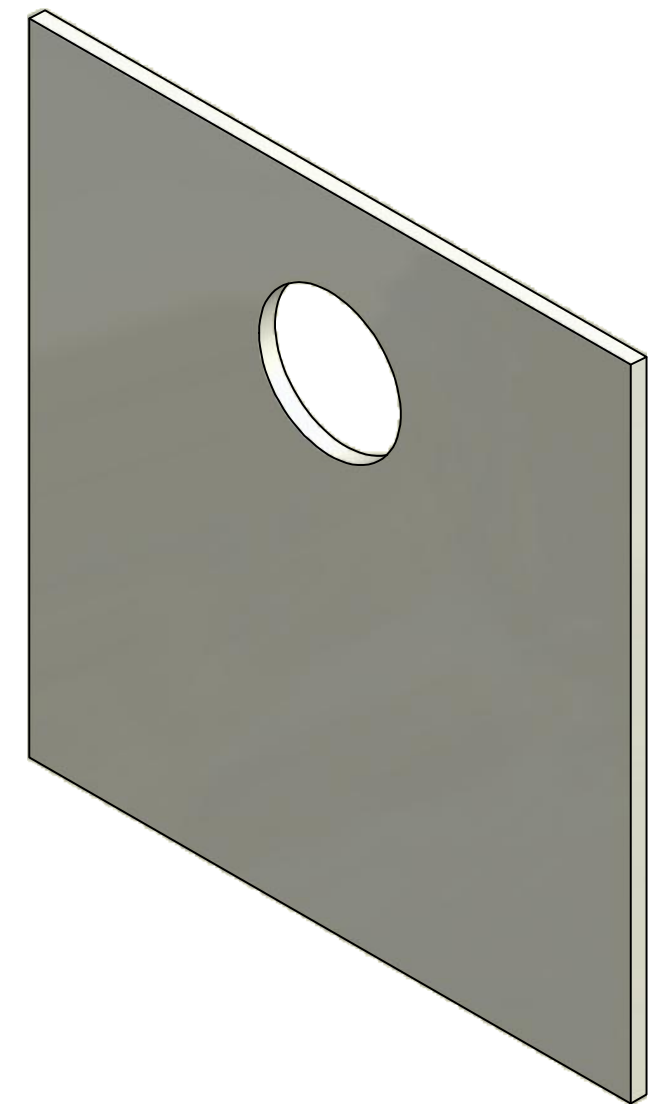
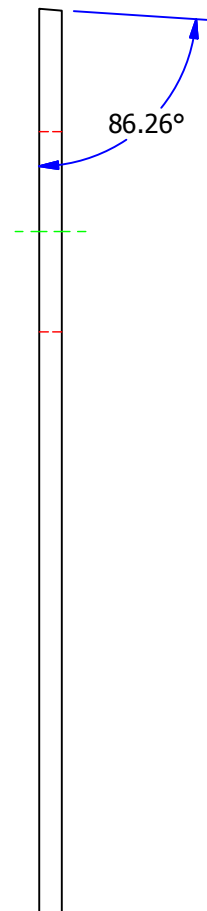
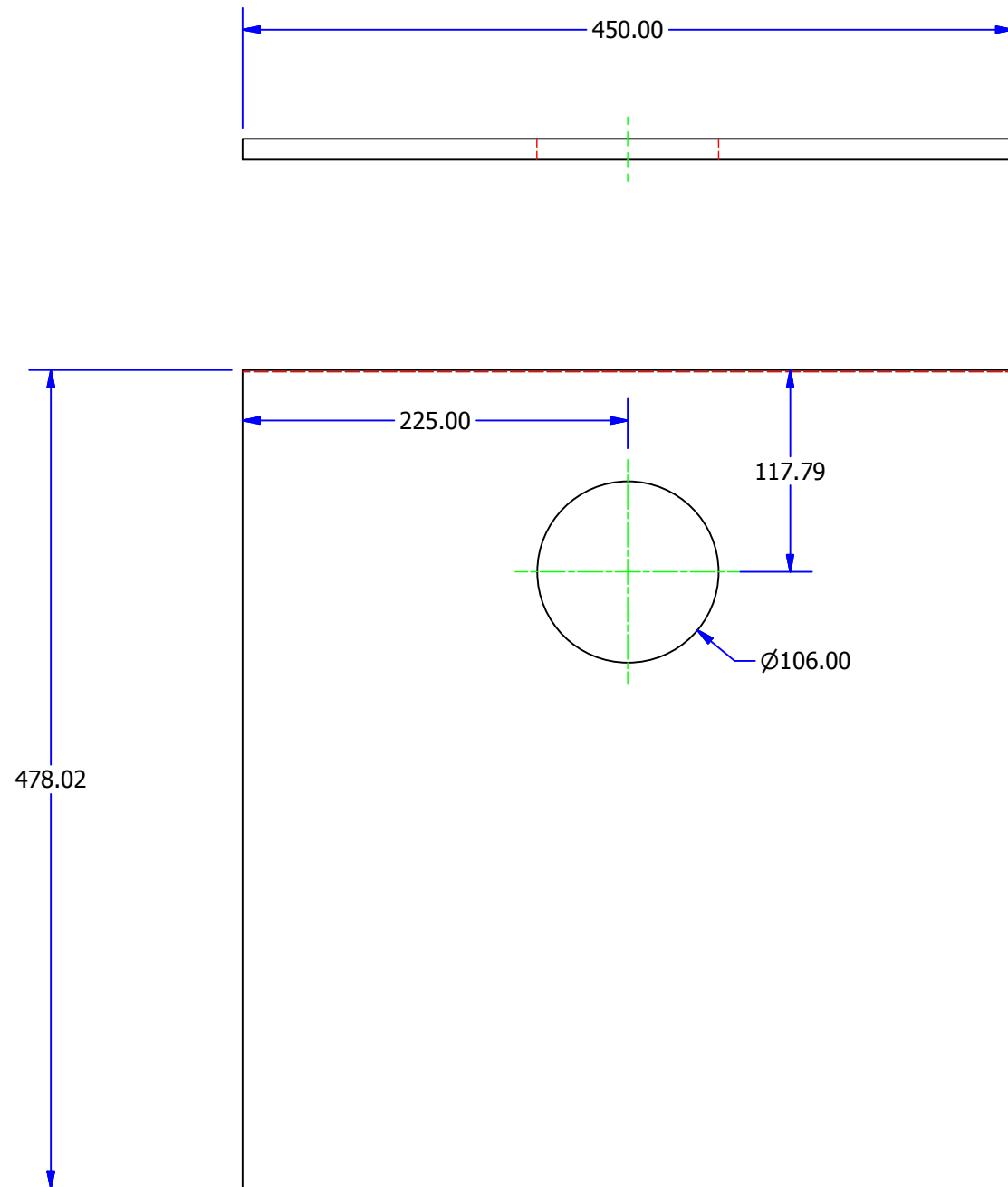

SCALE 1 / 4

Panel 4

Lowther Loudspeaker Systems Ltd.			
Acousta 116			
Sheet Number: 11 of 26	Date: 10/02/2010	Drawing Number: RQ/A3/A116/0002	Material: 12mm MDF
Sheet Size: A3	Drawn By: R. Quinton	Drawing Units: Millimeters	

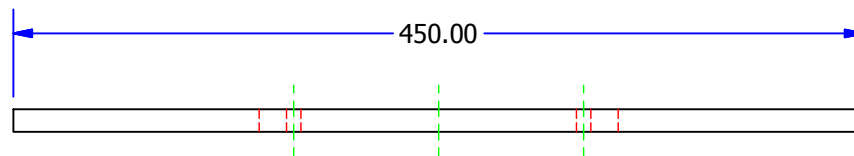

Ø7.50 THRU Typ
To accept brass inserts threaded at M6

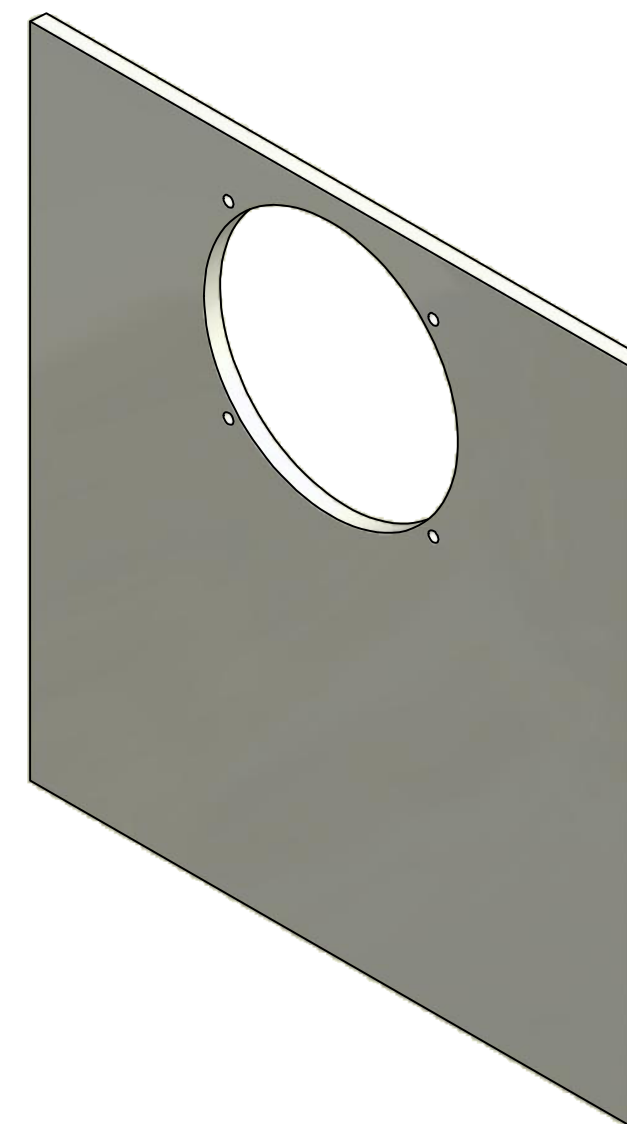
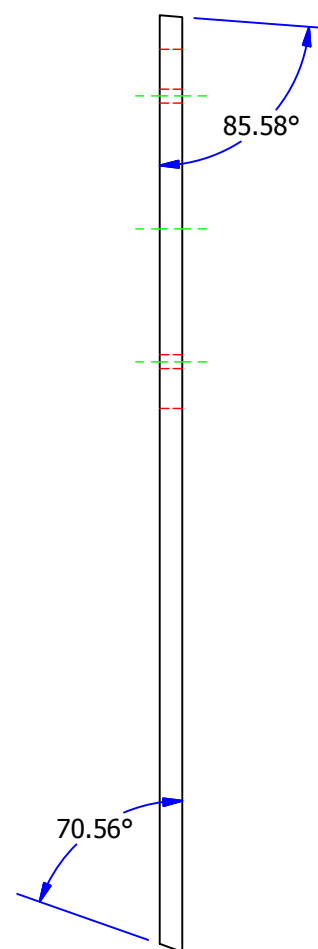
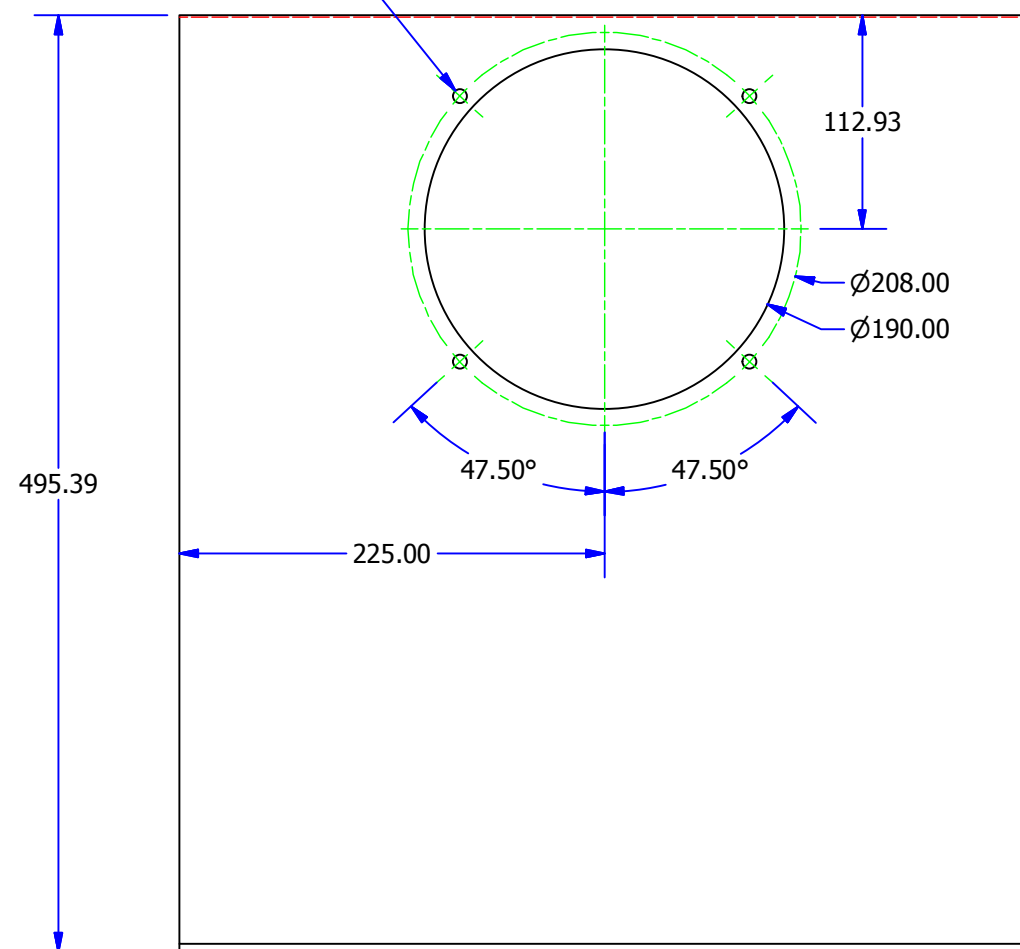

SCALE 1 / 4

Panel 5

Lowther Loudspeaker Systems Ltd.			
Acousta 116			
Sheet Number: 12 of 26	Date: 10/02/2010	Drawing Number: RQ/A3/A116/0002	Material: 12mm MDF
Sheet Size: A3	Drawn By: R. Quinton	Drawing Units: Millimeters	

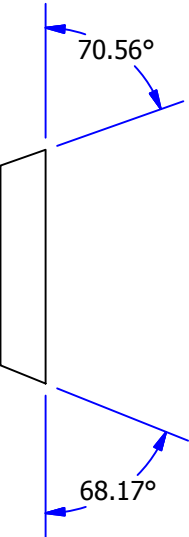
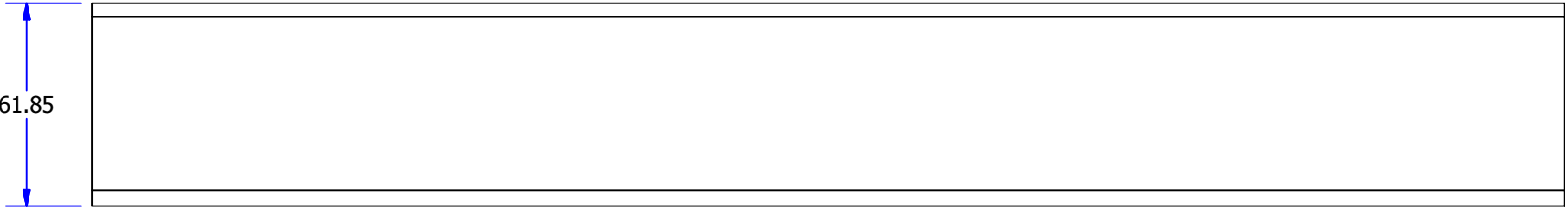
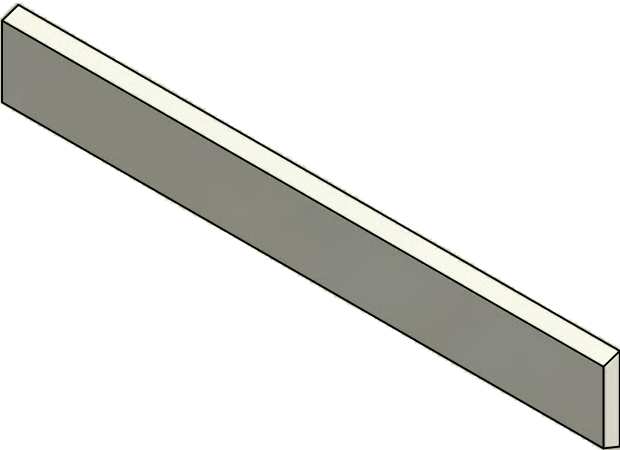
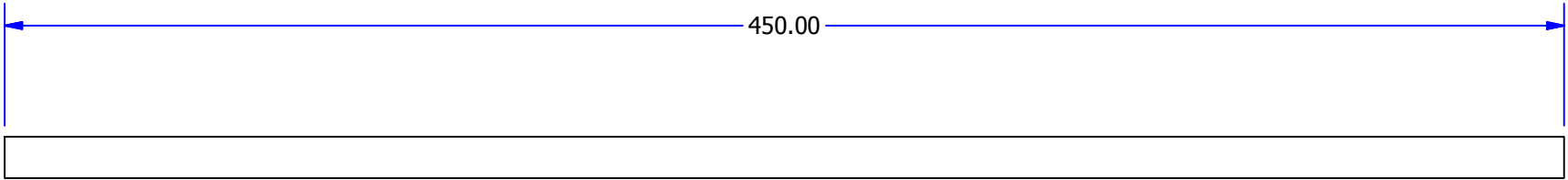

SCALE 1 / 2

Panel 6

Lowther Loudspeaker Systems Ltd.			
Acousta 116			
Sheet Number: 13 of 26	Date: 10/02/2010	Drawing Number: RQ/A3/A116/0002	Material: 12mm MDF
Sheet Size: A3	Drawn By: R. Quinton	Drawing Units: Millimeters	

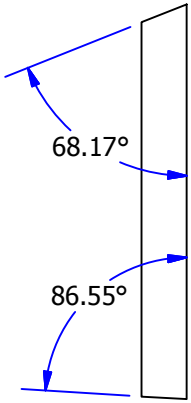
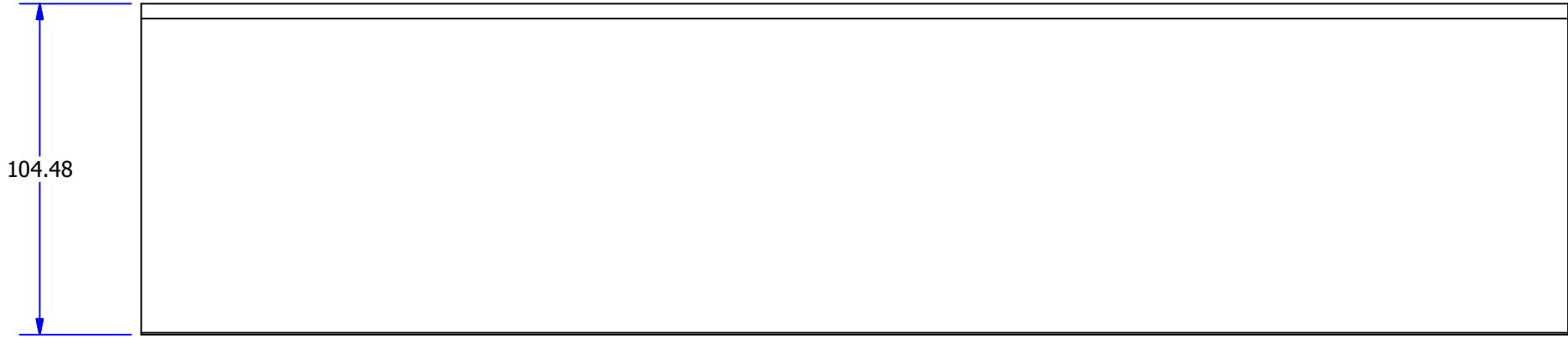
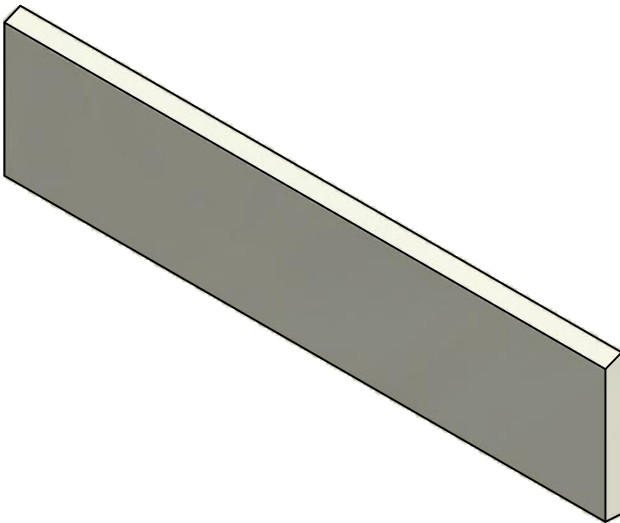
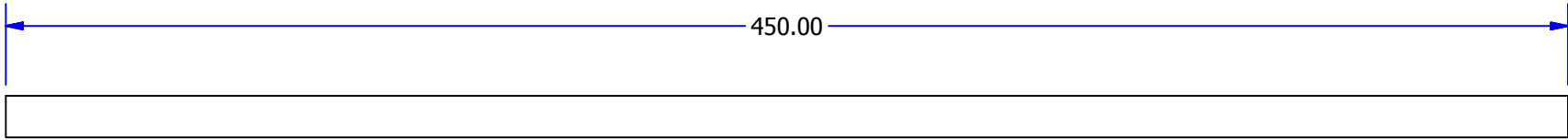

SCALE 1 / 2

Panel 7

Lowther Loudspeaker Systems Ltd.			
Acousta 116			
Sheet Number: 14 of 26	Date: 10/02/2010	Drawing Number: RQ/A3/A116/0002	Material: 12mm MDF
Sheet Size: A3	Drawn By: R. Quinton	Drawing Units: Millimeters	

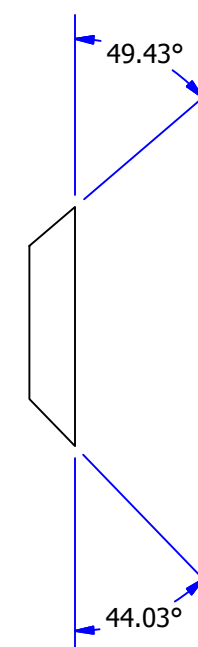
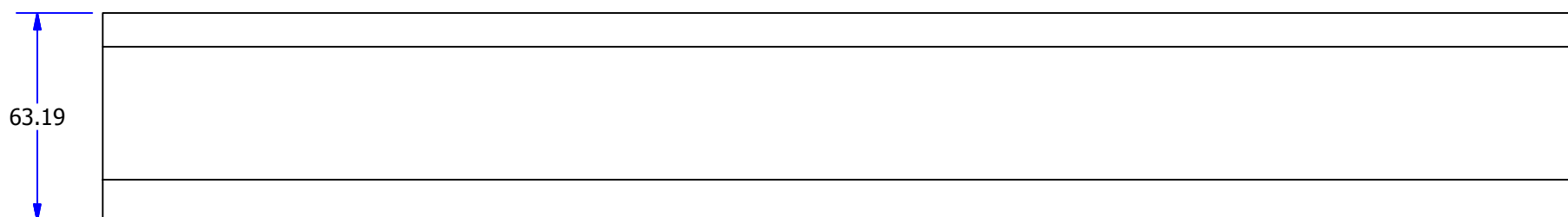
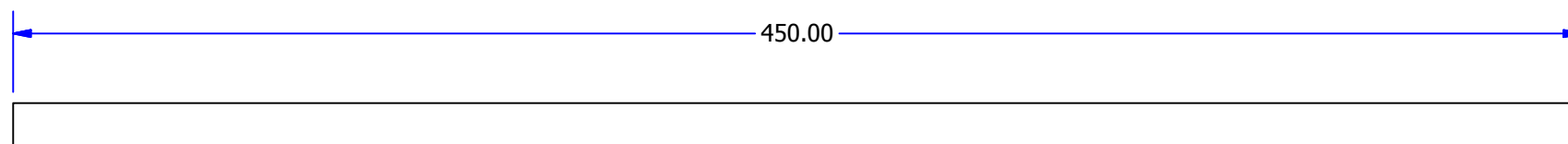
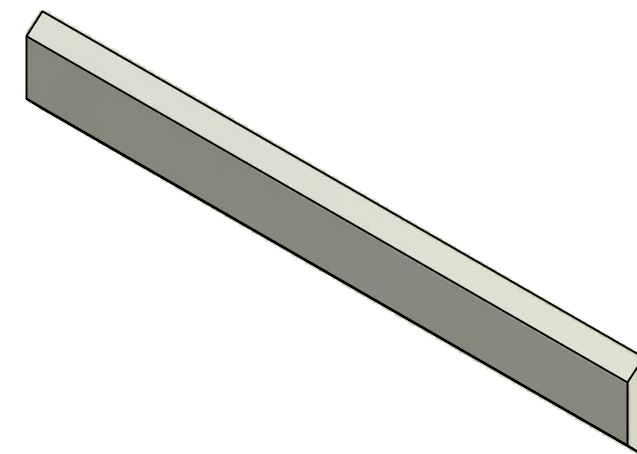

SCALE 1 / 2

Panel 8

Lowther Loudspeaker Systems Ltd.			
Acousta 116			
Sheet Number: 15 of 26	Date: 10/02/2010	Drawing Number: RQ/A3/A116/0002	Material: 12mm MDF
Sheet Size: A3	Drawn By: R. Quinton	Drawing Units: Millimeters	

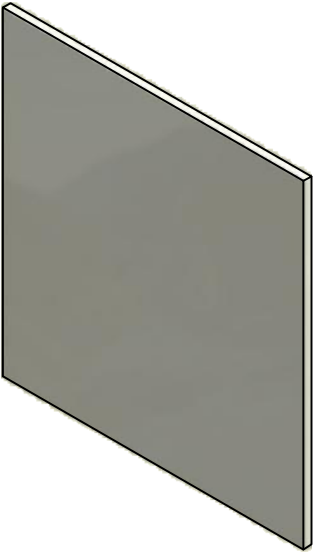
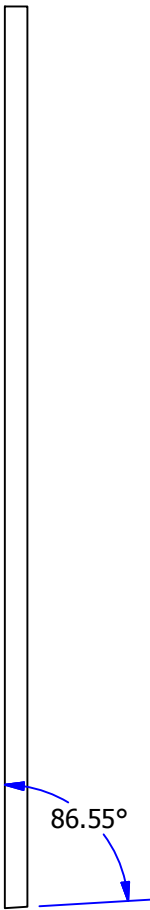
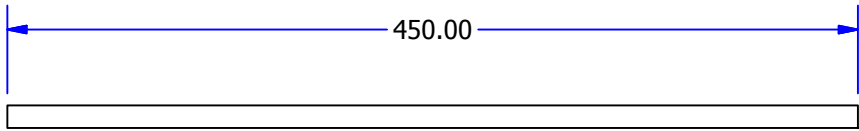

SCALE 1 / 4

Panel 9

Lowther Loudspeaker Systems Ltd.			
Acousta 116			
Sheet Number: 16 of 26	Date: 10/02/2010	Drawing Number: RQ/A3/A116/0002	Material: 12mm MDF
Sheet Size: A3	Drawn By: R. Quinton	Drawing Units: Millimeters	

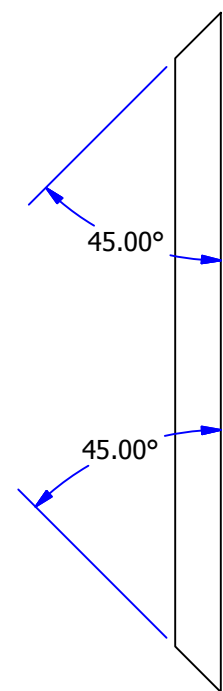
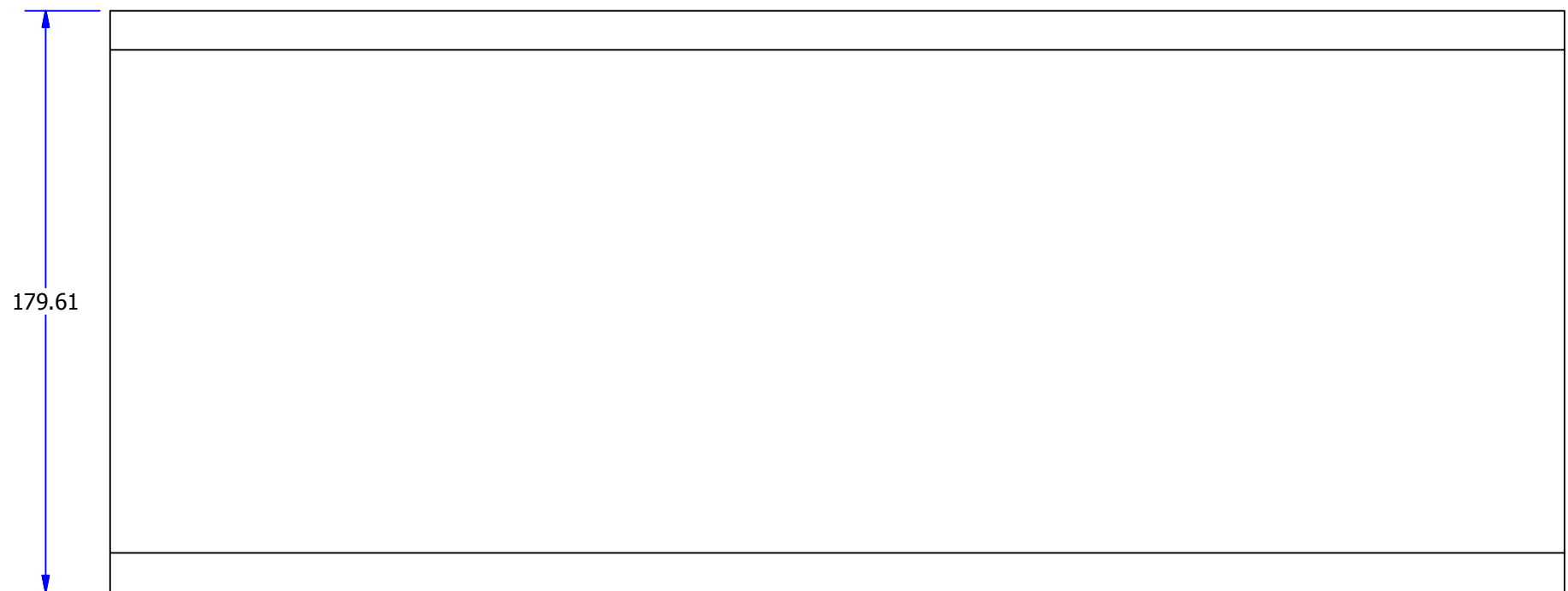
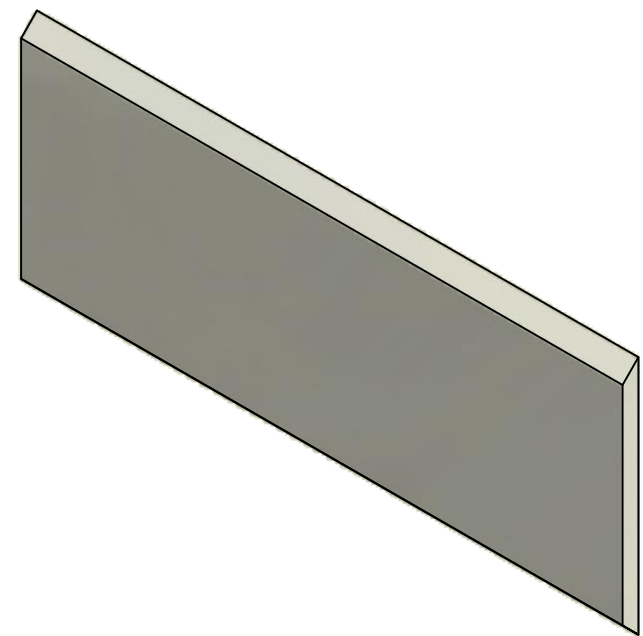
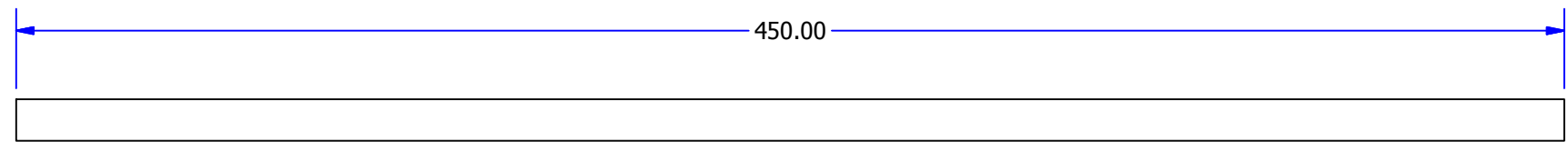

SCALE 1 / 2

Panel 10

Lowther Loudspeaker Systems Ltd.			
Acousta 116			
Sheet Number: 17 of 26	Date: 10/02/2010	Drawing Number: RQ/A3/A116/0002	Material: 12mm MDF
Sheet Size: A3	Drawn By: R. Quinton	Drawing Units: Millimeters	

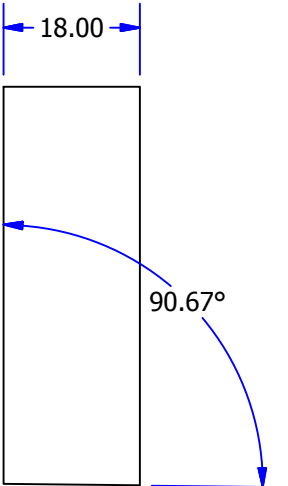
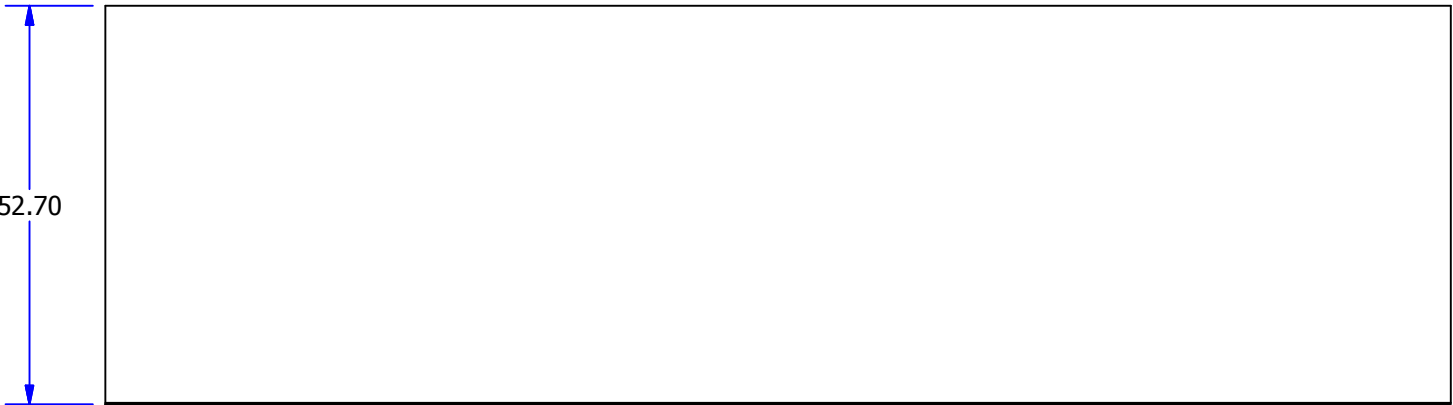
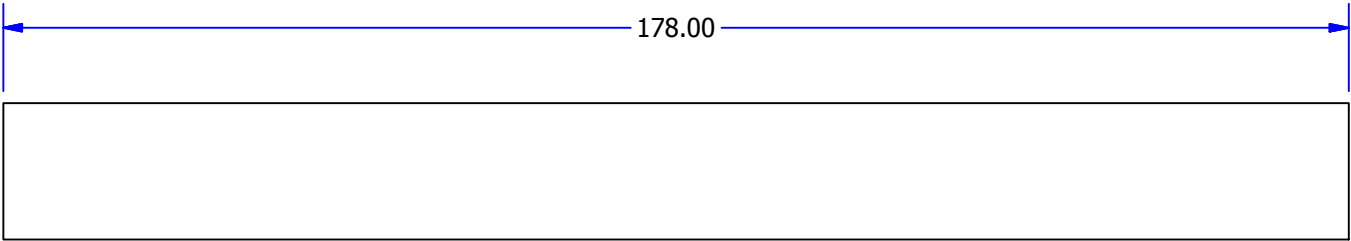
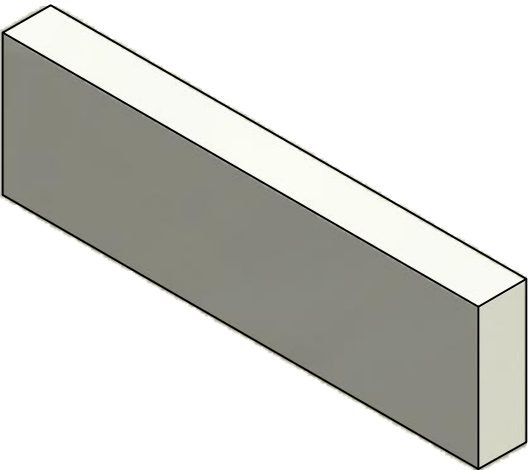

SCALE 1 : 1

Panel 11

Lowther Loudspeaker Systems Ltd.			
Acousta 116			
Sheet Number: 18 of 26	Date: 10/02/2010	Drawing Number: RQ/A3/A116/0002	Material: 18mm MDF
Sheet Size: A3	Drawn By: R. Quinton	Drawing Units: Millimeters	

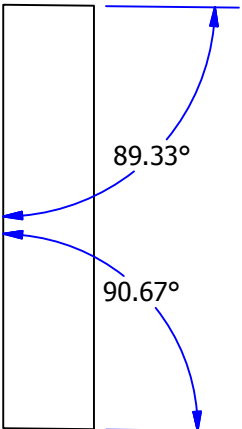
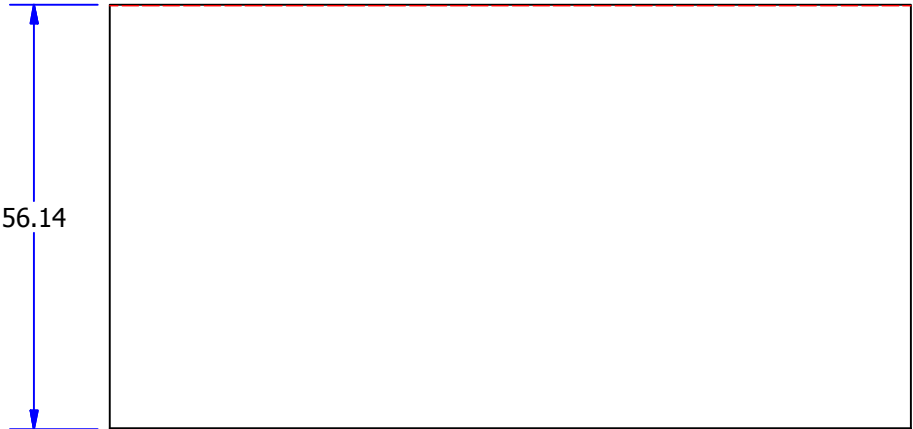
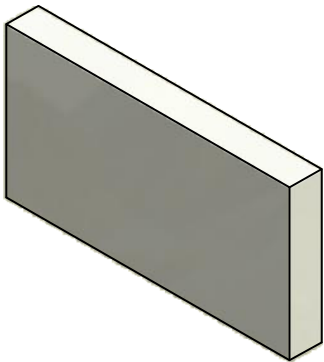
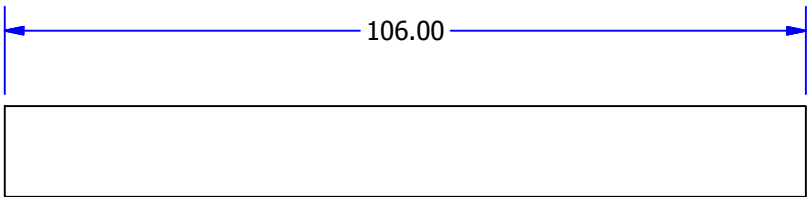

SCALE 1 : 1

Panel 12

Lowther Loudspeaker Systems Ltd.			
Acosta 116			
Sheet Number: 19 of 26	Date: 10/02/2010	Drawing Number: RQ/A3/A116/0002	Material: 12mm MDF
Sheet Size: A3	Drawn By: R. Quinton	Drawing Units: Millimeters	

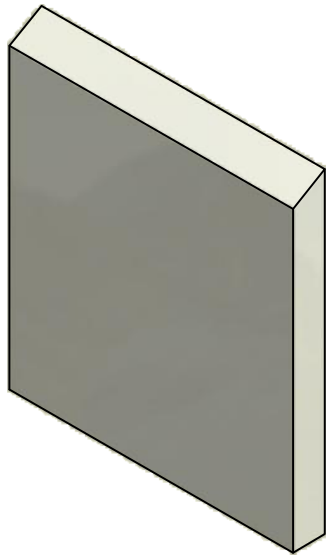
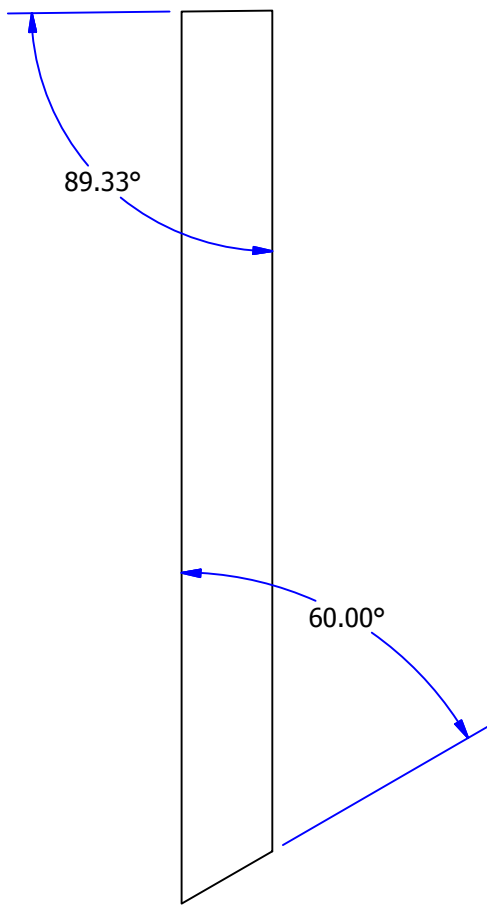
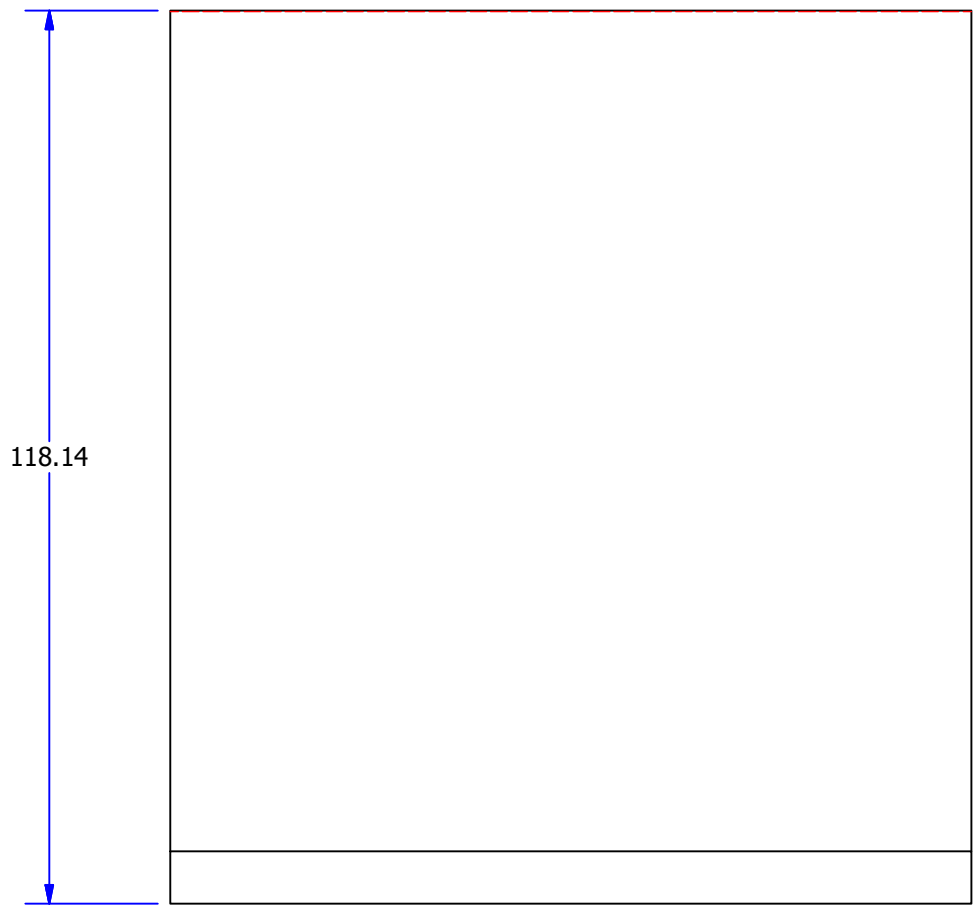
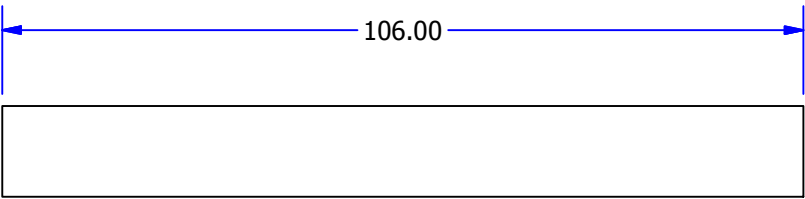

SCALE 1 : 1

Panel 13

Lowther Loudspeaker Systems Ltd.			
Acousta 116			
Sheet Number: 20 of 26	Date: 10/02/2010	Drawing Number: RQ/A3/A116/0002	Material: 12mm MDF
Sheet Size: A3	Drawn By: R. Quinton	Drawing Units: Millimeters	

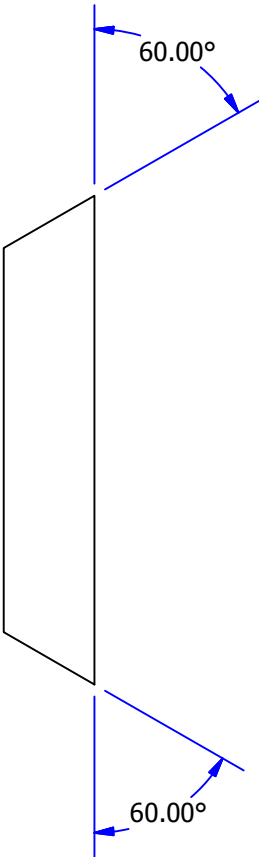
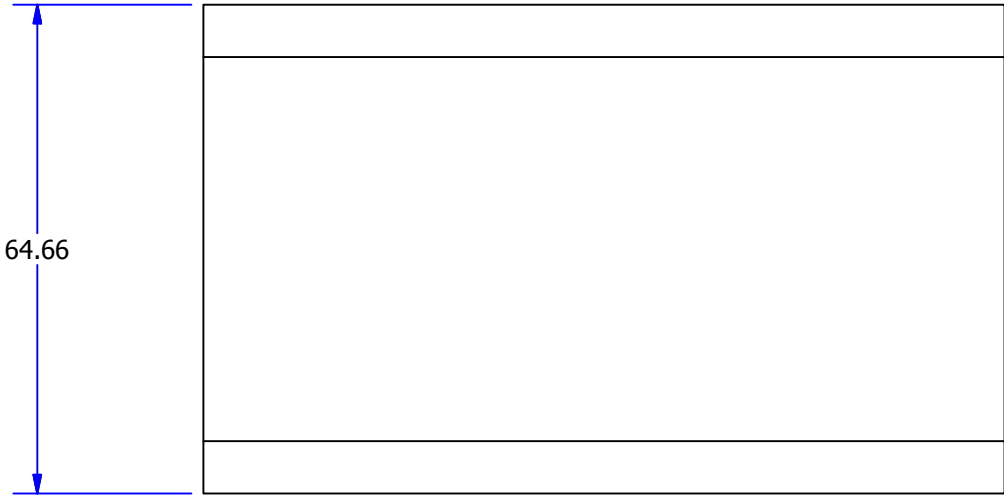
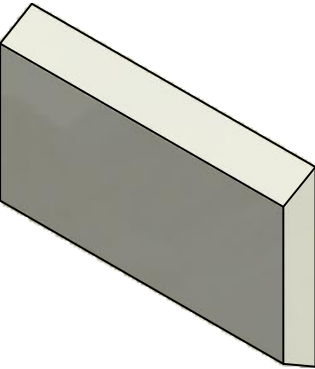
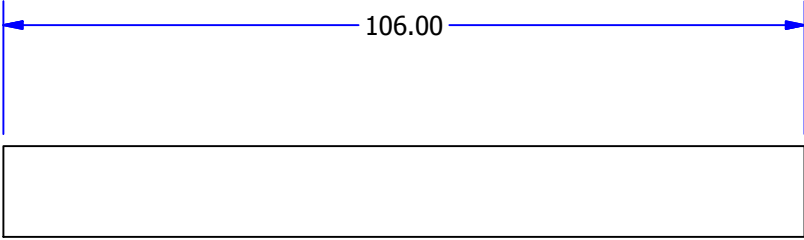

SCALE 1 : 1

Panel 14

Lowther Loudspeaker Systems Ltd.			
Acousta 116			
Sheet Number: 21 of 26	Date: 10/02/2010	Drawing Number: RQ/A3/A116/0002	Material: 12mm MDF
Sheet Size: A3	Drawn By: R. Quinton	Drawing Units: Millimeters	

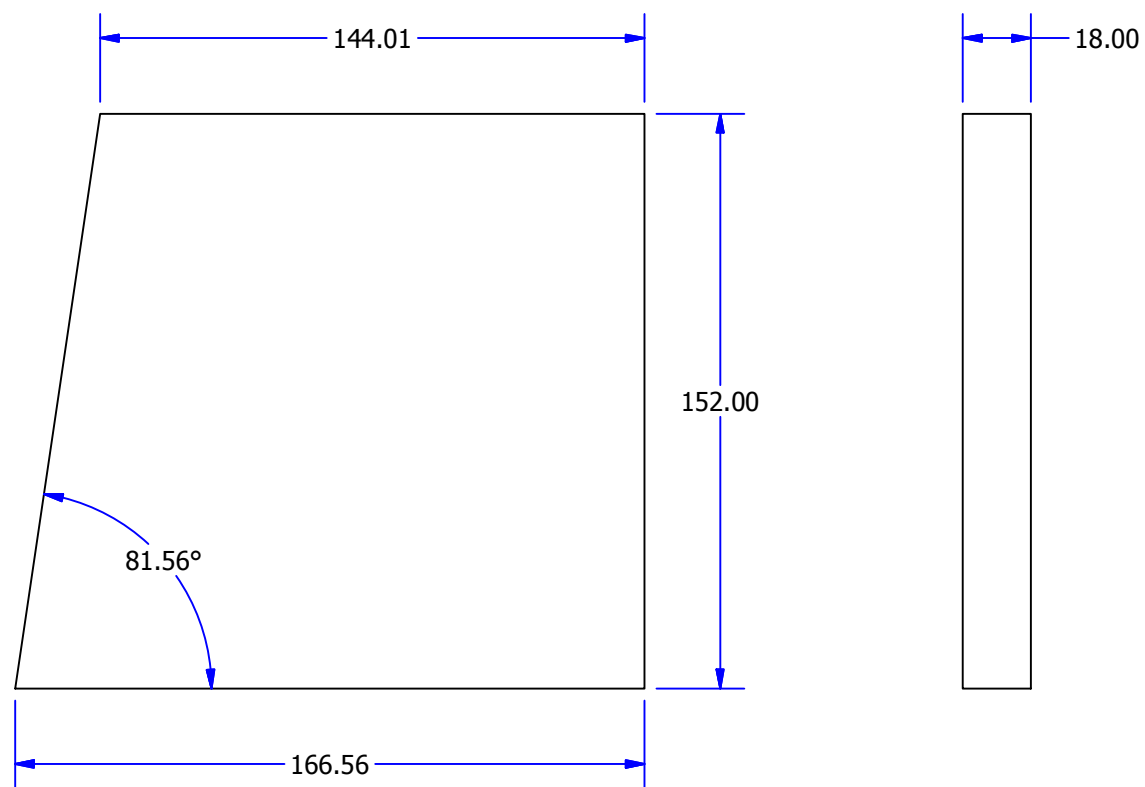
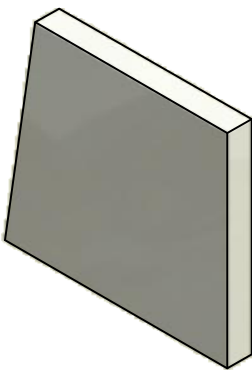

SCALE 1 / 2

Panel 15

Lowther Loudspeaker Systems Ltd.			
Acousta 116			
Sheet Number: 22 of 26	Date: 10/02/2010	Drawing Number: RQ/A3/A116/0002	Material: 18mm MDF
Sheet Size: A3	Drawn By: R. Quinton	Drawing Units: Millimeters	

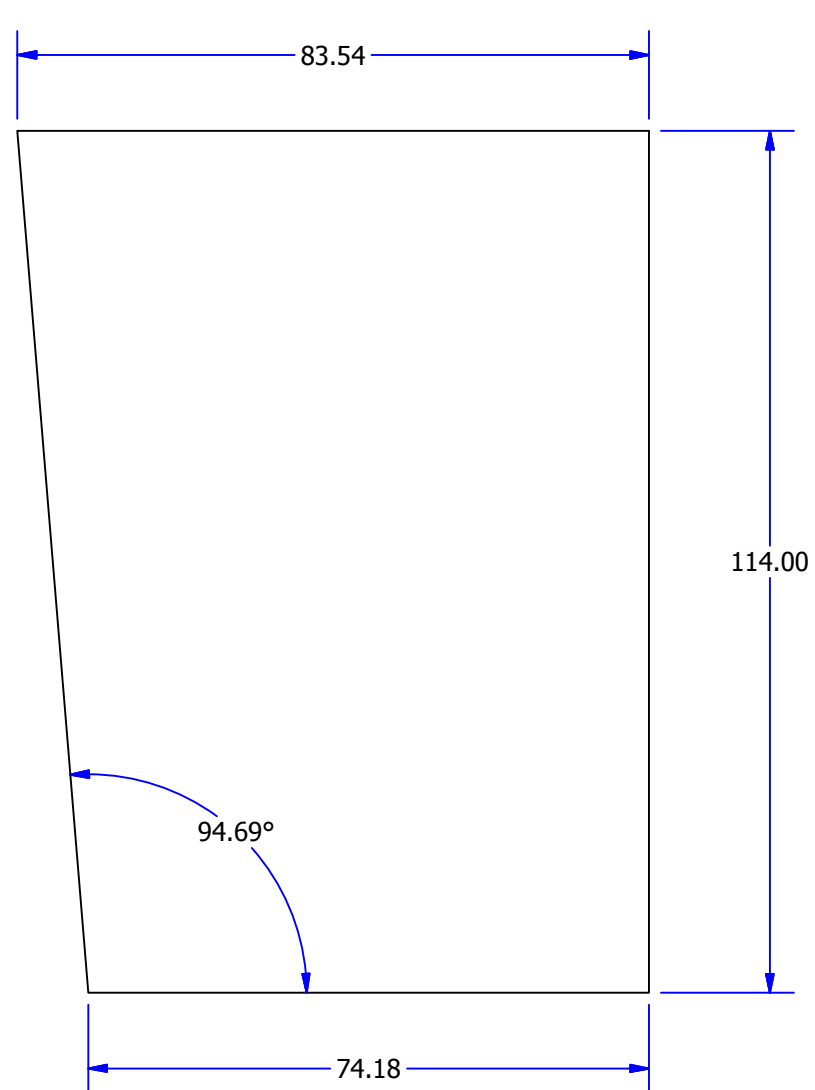

SCALE 1 : 1

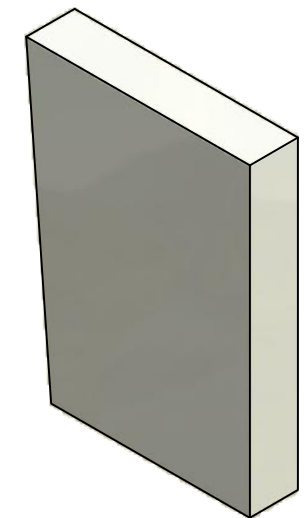
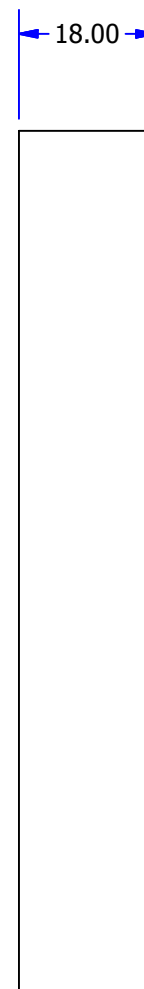

Panel 16

Lowther Loudspeaker Systems Ltd.			
Acousta 116			
Sheet Number: 23 of 26	Date: 10/02/2010	Drawing Number: RQ/A3/A116/0002	Material: 18mm MDF
Sheet Size: A3	Drawn By: R. Quinton	Drawing Units: Millimeters	

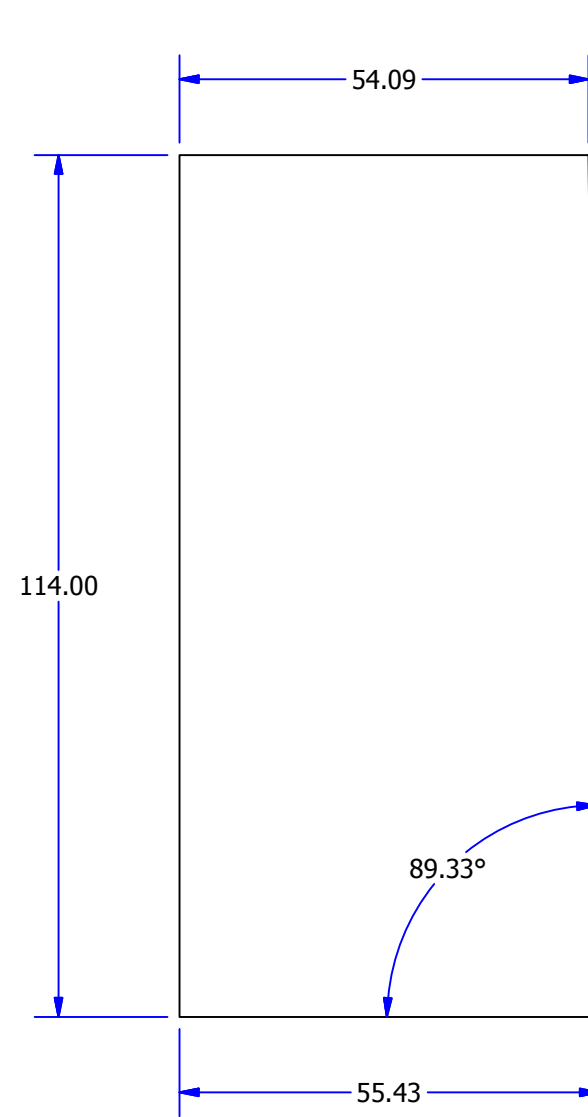

SCALE 1 : 1

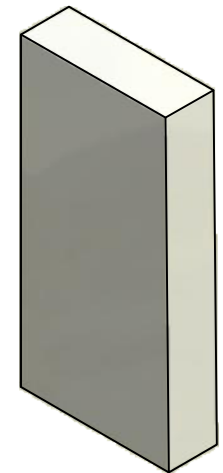
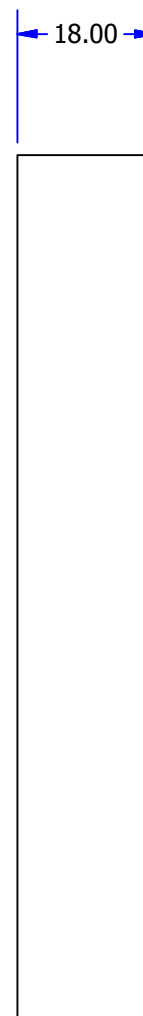

Panel 17

Lowther Loudspeaker Systems Ltd.			
Acousta 116			
Sheet Number: 24 of 26	Date: 10/02/2010	Drawing Number: RQ/A3/A116/0002	Material: 18mm MDF
Sheet Size: A3	Drawn By: R. Quinton	Drawing Units: Millimeters	



SCALE 1 : 1

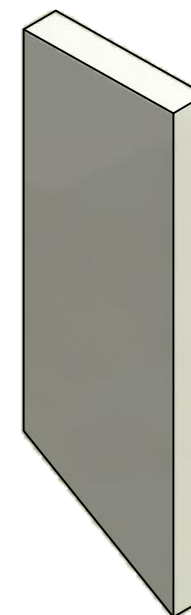
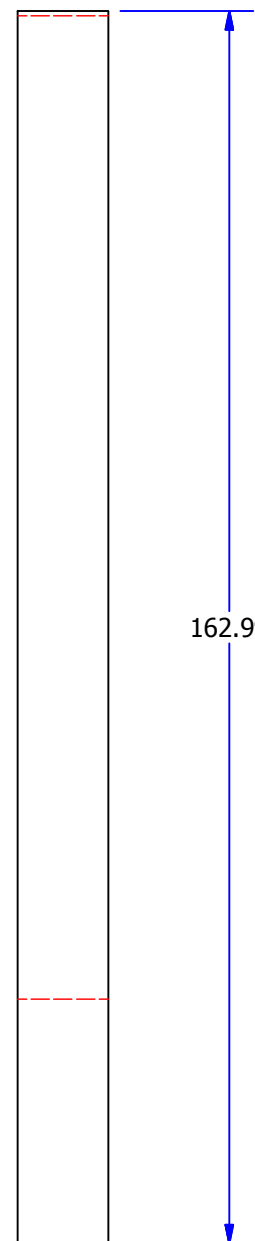

Two of these panels are required.

Panel 18

Lowther Loudspeaker Systems Ltd.			
Acousta 116			
Sheet Number: 25 of 26	Date: 10/02/2010	Drawing Number: RQ/A3/A116/0002	Material: 12mm MDF
Sheet Size: A3	Drawn By: R. Quinton	Drawing Units: Millimeters	

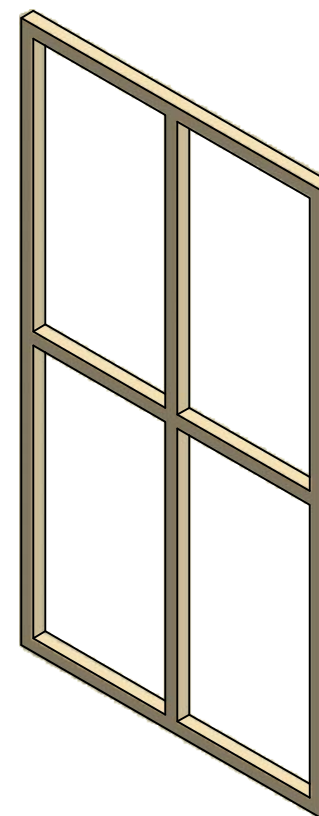
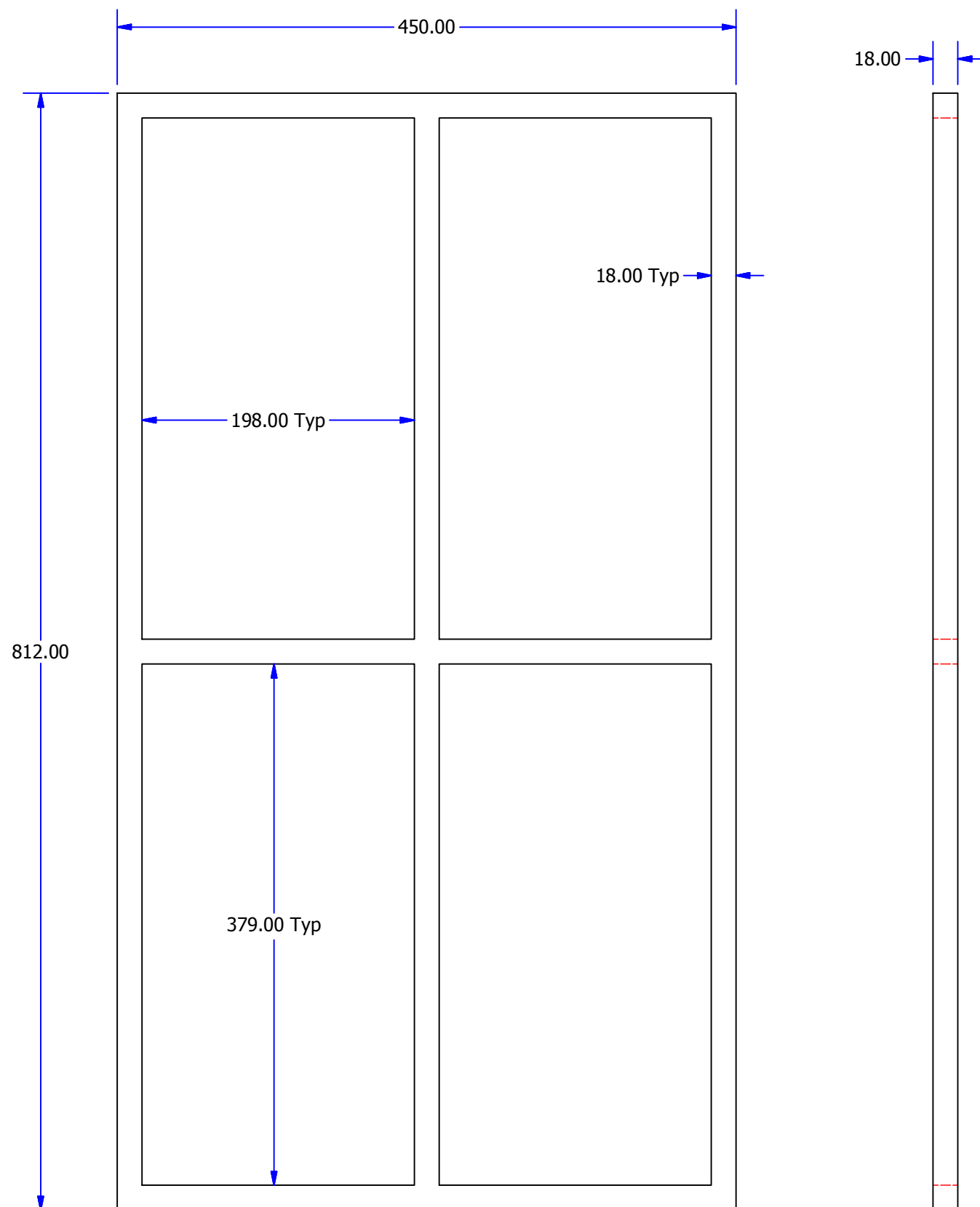

The Grill Panel should be covered with an acoustially transparent cloth and fitted with velcro pads.

Grill Panel

Lowther Loudspeaker Systems Ltd.

Acousta 116

Sheet Number: 26 of 26	Date: 10/02/2010	Drawing Number: RQ/A3/A116/0002	Material: 18mm MDF
Sheet Size: A3	Drawn By: R. Quinton	Drawing Units: Millimeters	

SCALE 1 / 4