

ALL RIGHTS RESERVED. NO PORTION OF THIS PUBLICATION, WHETHER IN WHOLE OR IN PART CAN BE REPRODUCED WITHOUT THE EXPRESS WRITTEN CONSENT OF SPC TECHNOLOGY.

REVISIONS									DOC. NO. SPC-F005 * Effective: 12/21/98 * DCP No: 680			
DCP #	REV	DESCRIPTION	DRAWN	DATE	CHECKD	DATE	APPRVD	DATE				
522	A	Released	JWM	5/20/99	JC	6/6/01	DJC	06/06/01				

Features

Digital Display for temperature control
Temperature range: 300°F to 900°F (±10°F)
Input Power: 117V AC
Low voltage (24Volts) is used to power heating element
Tip is isolated from AC line by transformer
Electronic switching protects voltage and current sensitive components against transient spikes

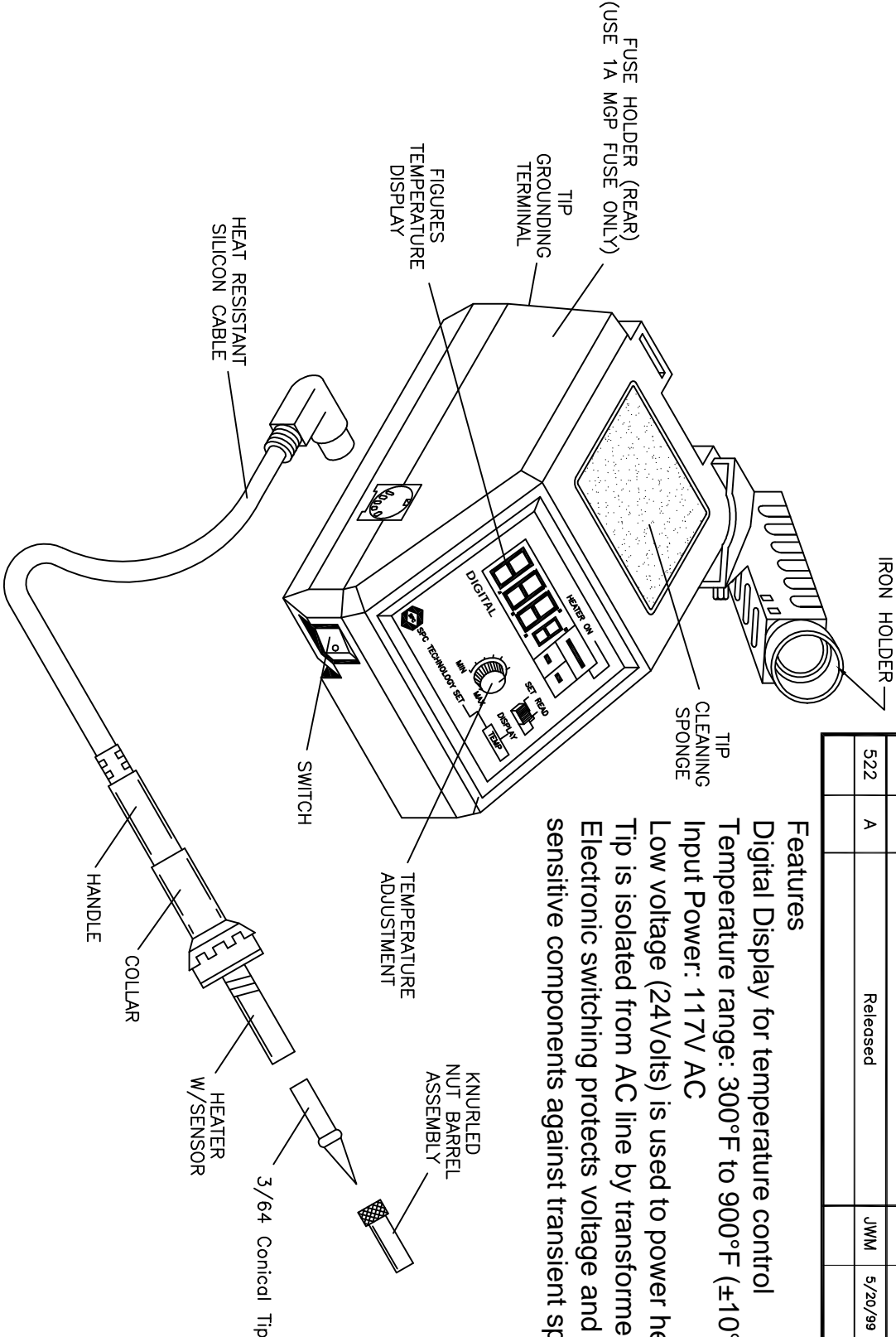

DISCLAIMER:
ALL STATEMENTS AND TECHNICAL INFORMATION CONTAINED HEREIN ARE BASED UPON INFORMATION AND/OR TESTS WE BELIEVE TO BE ACCURATE AND RELIABLE. SINCE CONDITIONS OF USE ARE BEYOND OUR CONTROL, THE USER SHALL DETERMINE THE SUITABILITY OF THE PRODUCT FOR THE INTENDED USE AND ASSUME ALL RISK AND LIABILITY WHATSOEVER IN CONNECTION THEREWITH.



SPC TECHNOLOGY

UNLESS OTHERWISE SPECIFIED, DIMENSIONS ARE FOR REFERENCE PURPOSES ONLY.				DRAWING TITLE: Adjustable Temperature Solder Station							
DRAWN BY:		DATE:		SIZE		DWG. NO.		ELECTRONIC FILE		REV	
Jeff McVicker		5/20/99		A		4004		84N1044.dwg		A	
CHECKED BY:		DATE:		A		4004		84N1044.dwg		A	
John Cole		6/6/01		A		4004		84N1044.dwg		A	
APPROVED BY:		DATE:		SCALE:		NTS		U.O.M.: INCHES [mm]		SHEET: 1 OF 1	
Daniel Carey		6/6/01		SCALE:		NTS		U.O.M.: INCHES [mm]		SHEET: 1 OF 1	