

# GERMANIUM POWER TRANSISTORS

Type Number	Min. Derate J to C W/°C	I <sub>C</sub> A	ABSOLUTE MAX. RATINGS				Max. I <sub>CEO</sub> @ Max. V <sub>CE</sub> @ 25°C A	h <sub>FE</sub>			Max.	f <sub>sw</sub> (Hz)	Max. Sat. Res. Ω	Max. P <sub>C</sub> Free Air @ 25°C W
			I <sub>B</sub> A	V <sub>CEO</sub> V	V <sub>EB</sub> V	V <sub>CE</sub> V		Bias V <sub>CB</sub> V	I <sub>C</sub> A	Min.				
GERMANIUM PNP DAP TRANSISTORS TO-3														
MP1612	1	20		70	2	50			10	25	100		.03	85
MP1612A	1	20		110	2	75			10	25	100		.03	85
MP1612B	1	20		13	2	100			10	25	100		.03	85
MP1613	1	7	2	100	50	75	5.0m	2	1	40	70			85
2N2147	660m	5	1	75	1.5	50	10m	2	1	100	300	3.0m	250m	12
2N2148	660m	5	1	60	1.0	40	10m	2	1	40	160	2.0m	250m	12
40612	167m	5	1		5.0		3.0μ	2	1	30	150			12
40623	167m	5	1		5.0		500μ	2	1	50	170			12
40626	167m	5	1		5.0		500μ	2	1	50	170			12
2N1905	667m	6	1	100	1.5	50	10m	2	1	50	150	2.0m	200m	12
2N1906	667m	6	1	130	1.5	60	10m	2	1	75	250	3.0m	100m	30
2N3730	303m	3	500m	200	.5	200	200μ	4	50m	10	200	1.0m	880m	30
2N3731	167m	10	4	320	2.0	320	200μ	3	6	15			250m	10
2N3732	100m	3	500m	100	.5	100	200μ	4	700m	35	500	1.0m	350m	3
40439	666m	10	4	320	2.0	320	200μ						250m	5
40440	666m	10	4	200	2.0	200	200μ						120m	5
40442	666m	10	4		2.0	60							130m	5
2N4346	167m	5	1	75	1.5	50	1.0m	2	1	62	175	4.0m		12
40421	660m	5	1	40	5.0	40	500μ	2	1	50	90	600k	200m	12
40462	666m	5	1											
2N2526	1	10		80	2.0	80	3m	2	3	20	50			85
2N2527	1	10		120	2.0	120	3m	2	3	20	50			85
2N2528	1	10		160	2.0	160	3m	2	3	20	50			85
2N2832	1	20	5	80	2.0	50	10m	2	10	25	100			85
2N2833	1	20	5	120	2.0	75	10m	2	10	25	100			85
2N2834	1	20	5	140	2.0	100	10m	2	10	25	100			85
2N5155	1.25	25	5	140	1.5	120	10m	2	8	25	100			106
2N5324	0.67	10	3	250	2.0	150	7m	2	5	20	60			56
2N5325	0.67	10	3	325	2.0	200	7m	2	5	20	60			56
2N5435	1.43	60	12	80	2.5	60	10m	2	25	20	60	350k		120
2N5436	1.43	60	12	110	2.5	90	10m	2	25	20	60	350k		120
2N5437	1.43	60	12	140	2.5	120	10m	2	25	20	60	350k		120
2N5438	1.43	60	12	80	2.5	60	10m	2	25	40	120	350k		120
2N5439	1.43	60	12	110	2.5	90	10m	2	25	40	120	350k		120
2N5440	1.43	60	12	140	2.5	120	10m	2	25	40	120	350k		120
1N4785 (Diode)		PRV 320V max.; Peak Forward Current 10A. max; Average Forward Current 7A.												

t<sub>r</sub>  
1 750 nano sec  
2 1.2 μsec

## CASE OUTLINE DRAWINGS & DIMENSIONS

UNDERCUT 1.0° .093±.010

1/2-20 UNF 2A

NOTE 1

1.500 MIN.

.500 .550  
±.015 MAX.

100±.010

.025±.003

E

.200±.010

.100±.010

B

C

.875 MAX.

.750±.010

NOTE 1:  
THREAD RELIEF  
IS .000 MAX.  
BY .430 DIA.  
NOMINAL.

Technical drawing of a mechanical part with dimensions and tolerances:

- Top view dimensions:
  - Overall width:  $.875 \text{ MAX}$
  - Overall height:  $.450$
  - Base thickness:  $.250$
  - Seating plane offset:  $.135 \text{ MAX}$
  - Internal hole diameter:  $.043$
  - Internal hole tolerance:  $.038$
  - Internal hole depth:  $.312 \text{ MIN}$
- Side view dimensions:
  - Overall width:  $1.197$
  - Overall height:  $.675$
  - Internal hole diameter:  $.655$
  - Internal hole tolerance:  $.655$
  - Internal hole depth:  $.440$
  - Internal hole tolerance:  $.420$
  - Internal hole offset:  $.225$
  - Internal hole tolerance:  $.205$
  - Internal hole diameter:  $.188 \text{ MAX}$
  - Internal hole tolerance:  $.161$
  - Internal hole tolerance:  $.151$
  - Internal hole diameter:  $.525 \text{ R MAX}$
  - Internal hole diameter:  $.188 \text{ MAX}$
  - Internal hole tolerance:  $.161$
  - Internal hole tolerance:  $.151$

Technical drawing of a mechanical part with dimensions and tolerances:

- Top view dimensions:
  - Overall width: .875 MAX
  - Width of central feature: .450
  - Width of base: .250
  - Width of base (bottom): .312 MIN
  - Width of base (bottom): .062
  - Width of base (bottom): .058
- Left side view dimensions:
  - Overall height: .440
  - Height of central feature: .420
  - Height of base: .225
  - Height of base: .205
- Right side view dimensions:
  - Overall width: 1.88 MAX BOTH ENDS
  - Width of central feature: .161
  - Width of base: .151
- Bottom view dimensions:
  - Overall width: 1.197
  - Width of central feature: 1.177
  - Width of base: .675
  - Width of base: .656
- Other features:
  - SEATING PLANE
  - 525 R MAX.

# GERMANIUM POWER TRANSISTORS

## CASE OUTLINE DRAWINGS & DIMENSIONS

TO-13

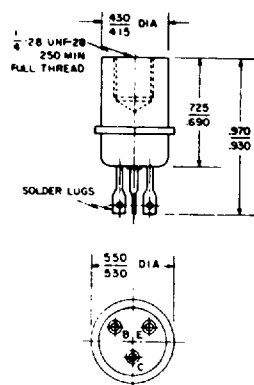

TO-66

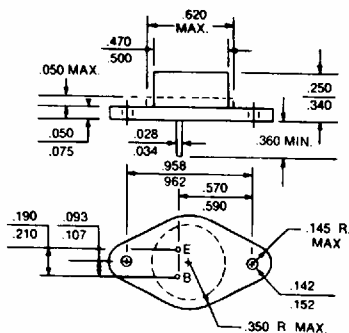

MS-7

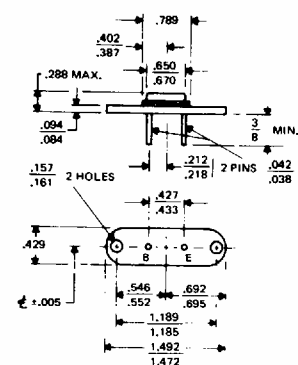

MT-22

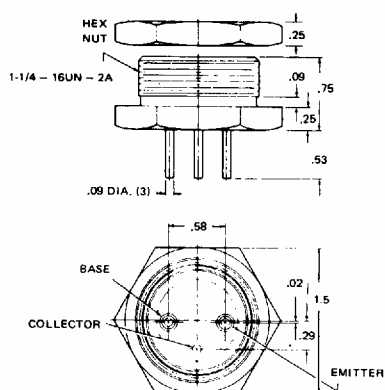

MT-23

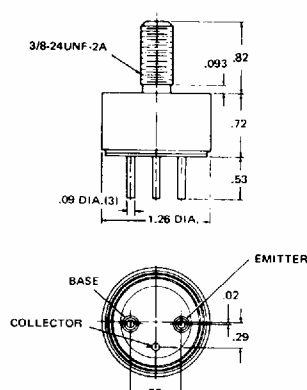

MT-7

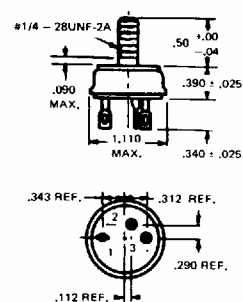

TO-68

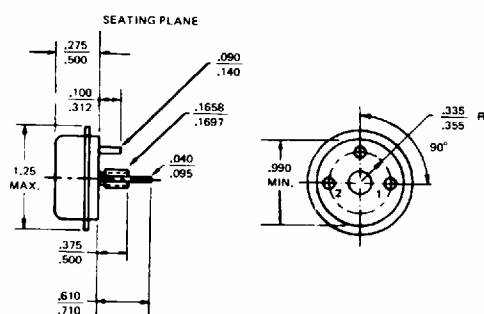

MT-36

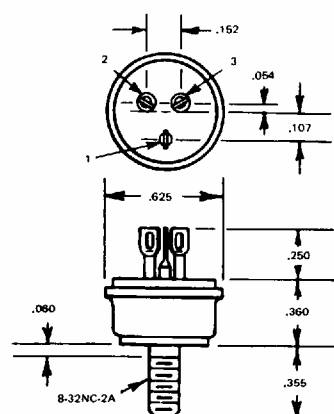

# GERMANIUM POWER TRANSISTORS

## CASE OUTLINE DRAWINGS & DIMENSIONS

NS257

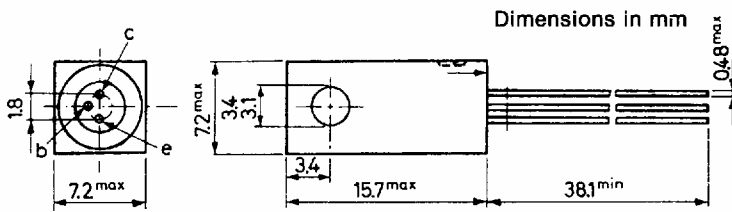

TO-1

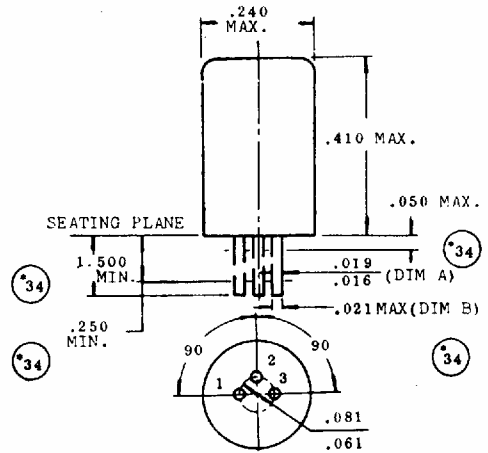

TO-18

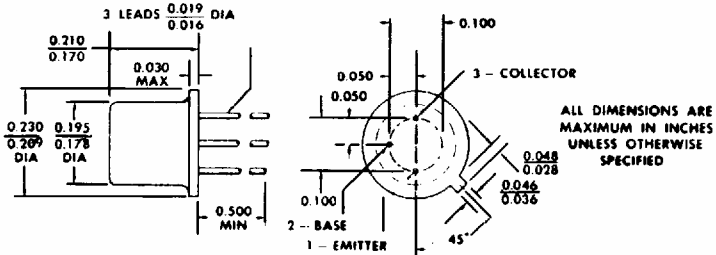

THE COLLECTOR IS ELECTRICAL  
CONTACT WITH THE CASE.

ALL JEDEC TO-18 DIMENSIONS  
AND NOTES ARE APPLICABLE.

This datasheet has been downloaded from:

[www.DatasheetCatalog.com](http://www.DatasheetCatalog.com)

Datasheets for electronic components.