

Technical Manual

JBL 3730-M/HF

SPECIFICATIONS



ACOUSTIC & ELECTRICAL SPECIFICATIONS:

- Nominal Impedance: 4 Ohms
MF: 8 Ohms, HF: 8 Ohms
- Input Power Rating: 125W AES, 300W recommended amplifier
- System Sensitivity: 105 dB, 2.83V @ 1 m (3.3 ft)
MF: 110 dB SPL, 2.83V @ 1 m (3.3 ft)
HF: 112 dB SPL, 2.83V @ 1 m (3.3 ft)

SYSTEM COMPONENTS:

- Mid Frequency Transducer: 195H; 165.1 mm (6.5 in) dia., 38 mm (1.5 in) voice coil
- DC Resistance: 5.20 ohm $\pm 10\%$
- High Frequency Transducer: 2414H; 25 mm (1 in) polymer diaphragm, neodymium compression driver
- DC Resistance: 3.60 ohm $\pm 0.2\%$
- Network Assembly: 445207-001

AURAL SWEEP TEST SPECIFICATIONS:

- A. System Aural Sweep Test: 7.0V Input, 200 Hz to 20 kHz
- B. M.F. Aural Sweep Test: 4.0V Input, 50 Hz to 500 Hz
- C. H.F. Aural Sweep Test: 0.75V Input, 500 Hz to 1.5 kHz

PHYSICAL SPECIFICATIONS:

- Enclosure Dimensions: 852 x 762 x 360 mm D (33.5 x 30 x 14.1 in. D)
- Net Weight: 24 lb (11.1 kg)
- Shipping Weight: 30 lb (13.6 kg)

WARRANTY INFORMATION:

- Refer to Warranty Statement packed with each product.

PACKAGE

Warranty Card
59660

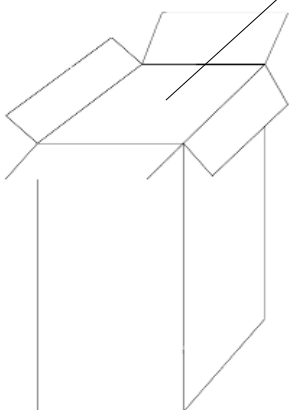

- Carton 445214-001
- Filler, Top 445215-001
- Filler, Bottom 445216-001
- Tray, Front 445218-001
- Filler, Back 445217-001
- Label, Barcode 445264-001
- Corner Brace (4) 446067-001
- Filler, Corner (4) 446068-001
- Bag 446069-001

WIRING DIAGRAM

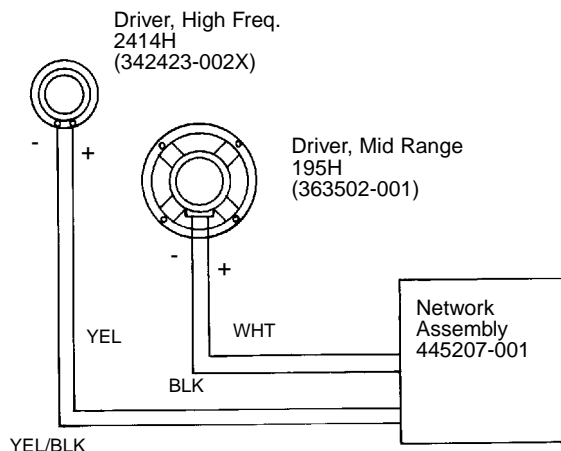

SEE NETWORK SCHEMATIC PAGE 2

NOTE: INDIVIDUAL PARTS FOR THE ABOVE CROSSOVER ARE NOT AVAILABLE.
A COMPLETE REPLACEMENT ASSEMBLY SHOULD BE ORDERED.

JBL 3730-M/HF

SCHEMATIC (445207-001)

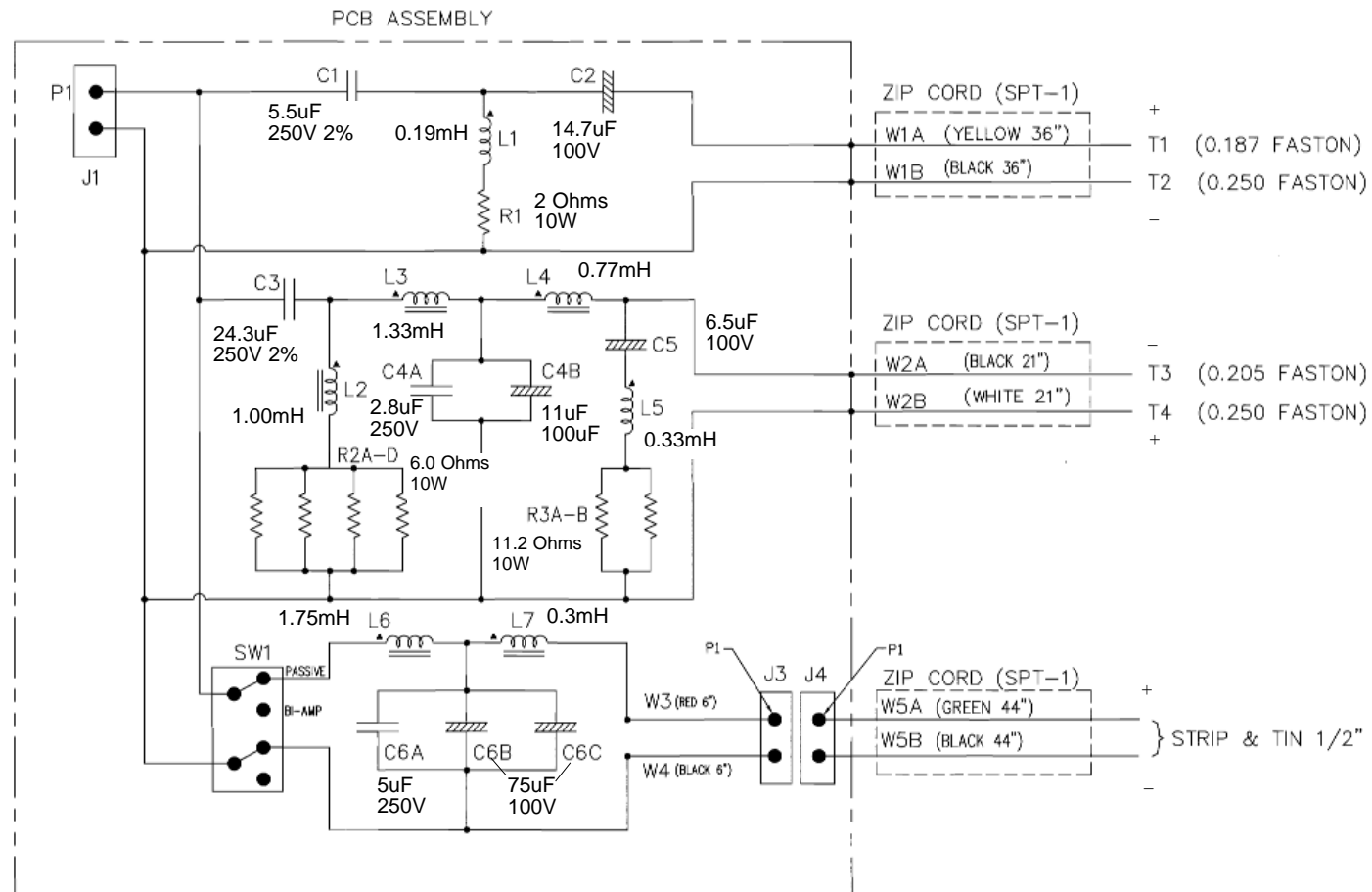

Individual Parts for the above crossover are not available.
A complete replacement assembly should be ordered.

JBL 3730-M/HF

COMPONENT EXPLODED VIEW

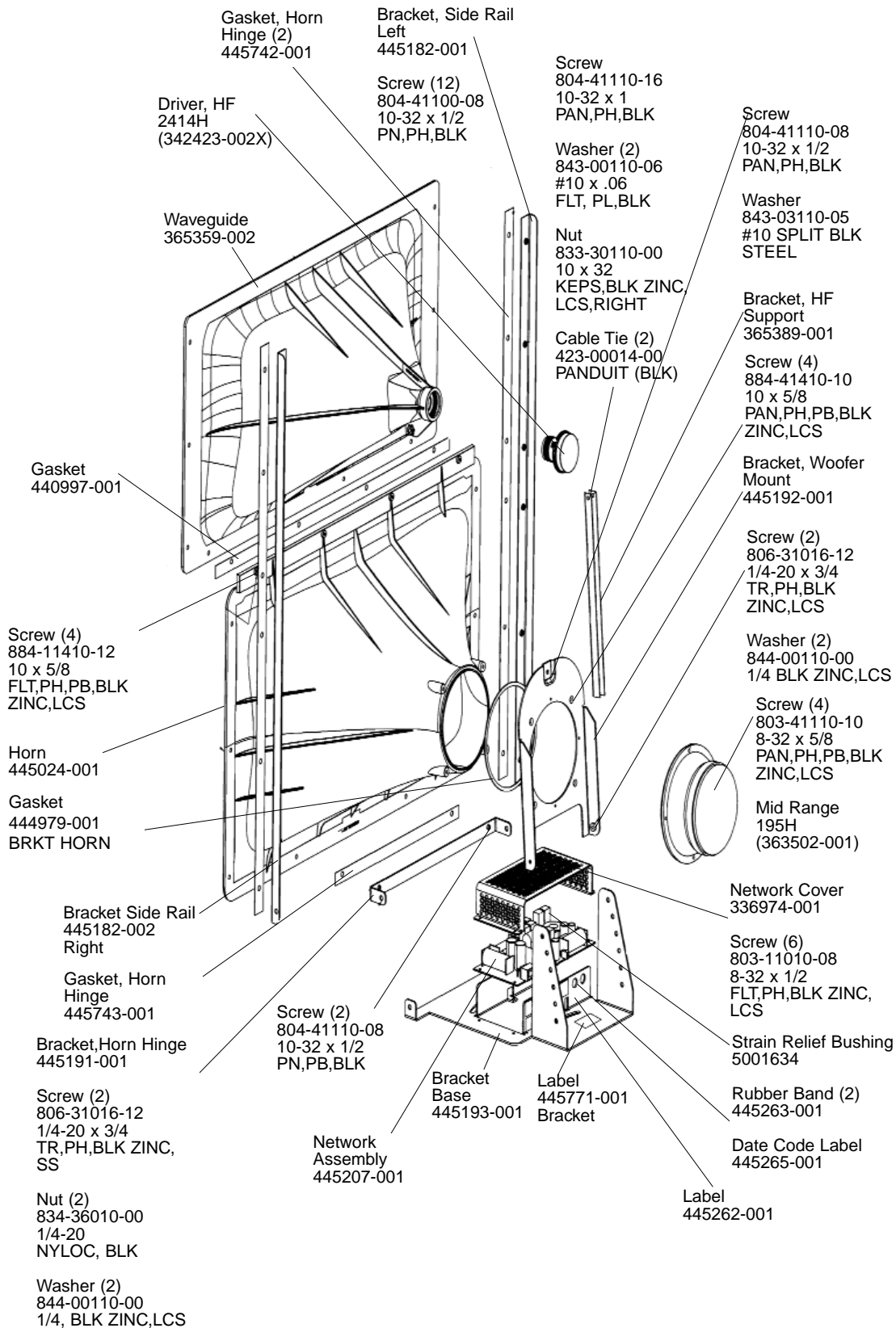

JBL 3730-M/HF