

A

B

C

D

5-3.

1

2

3

4

5

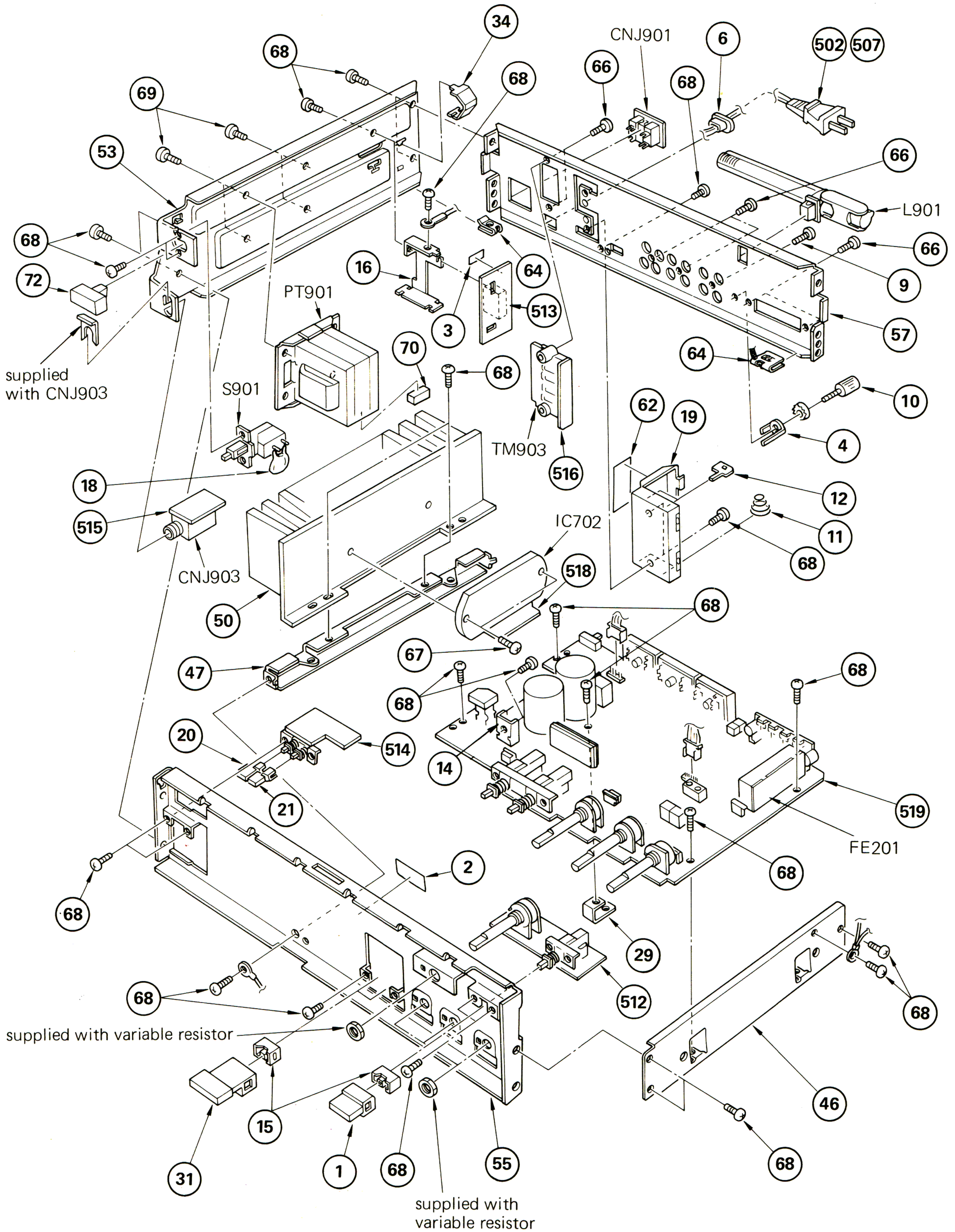

GENERAL SECTION

No.	Part No.	Description
1	2-363-012-00	KNOB (6X14), CORNER
2	3-701-030-00	LABEL, SERIAL NUMBER
3	♣;3-701-946-25	(Canadian)...LABEL, FUSE
4	3-701-993-00	SPACER, TERMINAL
5	3-703-079-21	LABEL, CAUTION (BACK)
6	3-703-244-00	BUSHING, CORD
7	3-703-249-01	SCREW, S TIGHT, +PTTWH 3X6
8	3-703-354-11	SCREW (OS), CASE, CLAW
9	3-703-473-00	SCREW, TERMINAL
10	3-706-165-00	SCREW
11	3-883-424-00	SPRING
12	3-883-428-00	PLATE, TERMINAL (POSITIVE)
13	♣;4-844-449-00	LABEL
14	♣;4-857-562-00	HEAT SINK, TR
15	4-864-307-00	RING
16	♣;4-868-906-00	BRACKET, BREAKER
17	4-871-324-00	ESCUTCHEON, POWER KNOB
18	4-875-455-21	COVER (DIA. 20), CAPACITOR
19	4-875-530-00	CASE, BATTERY
20	4-876-722-01	KNOB (4X10), SQUARE
21	4-876-722-11	KNOB (4X10), SQUARE
22	4-881-520-01	KNOB (DIA. 18)
23	4-881-702-01	PANEL (A)
24	4-881-704-01	KNOB (5X16), SQUARE
25	4-881-704-11	KNOB (5X16), SQUARE
26	4-881-704-21	KNOB (5X16), SQUARE
27	4-881-705-01	KNOB (5X6), SQUARE
28	♣;4-881-706-00	HOLDER (B), LED
29	♣;4-881-707-00	BRACKET, PC BOARD
30	♣;4-881-708-00	BRACKET (LEFT), PANEL
31	4-881-709-00	KNOB (5X19), SQUARE
32	4-881-710-00	HOLDER, STATION
33	♣;4-881-713-00	BRACKET (RIGHT), PANEL
34	♣;4-881-714-00	PROTECTOR
35	4-881-718-11	LABEL, STATION
36	4-881-720-01	CAP, KNOB (12X25), SQUARE
37	4-881-720-11	CAP, KNOB (12X25), SQUARE
38	4-881-720-21	CAP, KNOB (12X25), SQUARE
39	4-881-720-31	CAP, KNOB (12X25), SQUARE
40	4-881-720-41	CAP, KNOB (12X25), SQUARE
41	4-881-720-51	CAP, KNOB (12X25), SQUARE
42	4-881-720-61	CAP, KNOB (12X25), SQUARE
43	4-881-720-71	CAP, KNOB (12X25), SQUARE
44	4-881-720-81	CAP, KNOB (12X25), SQUARE
45	4-881-720-91	CAP, KNOB (12X25), SQUARE

GENERAL SECTION

No.	Part No.	Description
46	♣;4-881-721-00	PLATE (RIGHT), SIDE
47	♣;4-881-722-00	BRACKET, HEAT SINK
48	4-881-724-21	PLATE, ORNAMENTAL
49	4-881-725-00	RING (TACT), FLEXIBLE
50	♣;4-881-726-00	HEAT SINK (B)
51	♣;4-881-727-00	HOLDER (A), LED
52	4-881-728-00	BASE, KNOB (12X25), SQUARE
53	♣;4-881-729-00	PLATE (LEFT), SIDE
54	♣;4-881-730-00	PLATE, BOTTOM
55	♣;4-881-731-00	PANEL (A), SUB
56	4-881-733-01	PANEL, 10 KEY
57	♣;4-881-734-01	(US).....PLATE, JACK
57	♣;4-881-734-12	(Canadian)...PLATE, JACK
58	4-881-736-00	CASE
59	4-881-737-00	FILTER
60	♣;4-881-743-00	HOLDER, DISPLAY
61	♣;4-881-744-00	HOLDER, FL TUBE
62	♣;4-881-747-00	LABEL, BATTERY
63	♣;4-881-751-02	CASE, SHIELD
64	♣;4-881-752-00	NUT, PLATE, SPECIAL
65	7-685-134-11	SCREW +P 2.6X8 TYPE2 NON-SLIT
66	7-685-646-11	SCREW +BVTP 3X8 TYPE2 N-S
67	7-685-649-11	SCREW +BVTP 3X14 TYPE2 N-S
68	7-685-871-01	SCREW +BVTT 3X6 (S)
69	7-685-880-01	SCREW +BVTT 4X6 (S)
70	9-911-846-XX	CUSHION
71	X-4864-303-0	FOOT ASSY
72	X-4875-108-0	KNOB ASSY, POWER
73	X-4881-701-0	KNOB (DIA. 34) ASSY, R

NOTE:

- Items with no part number and no description are not stocked because they are seldom required for routine service.
- Items marked "♣" are not stocked since they are seldom required for routine service. Some delay should be anticipated when ordering these items.
- Due to standardization, parts with part numbers (Δ-ΔΔΔ-ΔΔΔ-XX or Δ-ΔΔΔΔ-ΔΔΔ-X) may be different from those used in the set.

CAPACITORS:

- All capacitors are in μF . Common capacitors are omitted. Refer to the following lists for their part numbers.
MF: μF , PF: $\mu\mu\text{F}$.

RESISTORS

- All resistors are in ohms. Common 1/4W, 1/8W and 1/16W carbon resistors are omitted. Refer to the following lists for their part numbers.
- F : nonflammable

SEMICONDUCTORS

In each case, U : μ , for example:
 UA...: μA ..., UPA...: μPA ..., UPC...: μPC ,
 UPD...: μPD ...

COILS

- MMH : mH, UH : μH

ACCESSORY & PACKING MATERIAL

No.	Part No.	Description
101	1-501-184-00	ANTENNA, FEEDER
102	1-528-027-11	BATTERY, NEW SUPER (SUM-3)(NS)
103	3-701-630-00	BAG, POLYETHYLENE
104	3-703-390-01	(US).....INSTRUCTION
105	3-783-972-21	MANUAL, INSTRUCTION
106	3-783-972-31	(Canadian)...MANUAL, INSTRUCTION
107	3-795-424-11	(Canadian)...CARD, CONTROL
108	3-795-424-21	(US).....CARD, CONTROL
109	4-858-078-00	SHEET, PROTECTION
110	4-881-738-00	CUSHION, UPPER
111	4-881-739-00	CUSHION, LOWER
112	4-881-740-00	INDIVIDUAL CARTON
113	X-4881-702-0	LABEL ASSY (UC), STATION

ELECTRICAL PARTS

Ref.No.	Part No.	Description
501	♣;1-508-994-00	PIN, CONNECTOR
502	△.1-534-986-XX	(US).....CORD, POWER
503	♣;1-535-115-00	TERMINAL
504	♣;1-535-116-00	TERMINAL
505	♣;1-535-117-00	TERMINAL
506	♣;1-535-137-00	BASE POST 14MM (10MM PITCH)
507	△.1-551-511-00	(Canadian)...CORD, POWER
508	♣;1-560-060-00	PIN, CONNECTOR 2P
509	♣;1-560-282-00	CONNECTOR PIN 7P
510	♣;1-561-439-00	SOCKET, CONNECTOR 3P
511	♣;1-561-443-00	SOCKET, CONNECTOR 7P
512	♣;1-607-502-00	PC BOARD, VOLUME
513	♣;1-607-503-00	PC BOARD, BREAKER
514	♣;1-607-504-00	PC BOARD, SPEAKER SW
515	♣;1-607-505-00	PC BOARD, HEADPHONE
516	♣;1-607-506-00	PC BOARD, SPEAKER TERMINAL
517	♣;1-607-507-00	PC BOARD, LED
518	♣;1-607-508-00	PC BOARD, IC
519	♣;A-4409-625-A	MOUNTED PCB, MAIN
520	♣;A-4472-093-A	MOUNTED PCB, DISPLAY
C601	1-161-318-00	CERAMIC 390PF 10% 50V
C651	1-161-318-00	CERAMIC 390PF 10% 50V
C805	△ 1-125-292-00	ELECT(BLOCK) 8200MF 20% 50V
C806	△ 1-123-513-00	ELECT 100MF 20% 50V
C807	△ 1-125-292-00	ELECT(BLOCK) 8200MF 20% 50V
C901	△.1-161-749-00	CAP, CERAMIC 10000PF
△CB902	.1-532-522-00	BREAKER, CIRCUIT
CF201	1-527-307-XX	FILTER, CERAMIC
CF203	1-527-307-XX	FILTER, CERAMIC
CF401	1-527-599-00	FILTER, MECHANICAL
△CNJ901	.1-561-161-00	OUTLET, AC (2-GANG)
CNJ903	1-507-669-00	JACK
△CP801	.1-102-394-00	CERAMIC (0.01MF+0.01MF) 250V
△CP802	.1-102-394-00	CERAMIC (0.01MF+0.01MF) 250V
△CP803	.1-102-394-00	CERAMIC (0.01MF+0.01MF) 250V
CT401	1-141-180-00	CAP, TRIMMER
CT402	1-141-180-00	CAP, TRIMMER
D201	8-719-815-55	DIODE 1S1555
D301	8-719-815-55	DIODE 1S1555
D302	8-719-936-25	DIODE EQA01-25R
D304	8-719-815-55	DIODE 1S1555
D305	8-719-912-00	DIODE MV-12N
D306	8-719-815-55	DIODE 1S1555

NOTE:

- Items with no part number and no description are not stocked because they are seldom required for routine service.
- Items marked "♣" are not stocked since they are seldom required for routine service. Some delay should be anticipated when ordering these items.
- Due to standardization, parts with part numbers (△-△△△-△△△-XX or △-△△△△-△△△-X) may be different from those used in the set.

SEMICONDUCTORS

In each case, U : μ, for example:
 UA...: μA..., UPA...: μPA..., UPC...: μPC,
 UPD...: μPD...

CAPACITORS:

- All capacitors are in μF. Common capacitors are omitted. Refer to the following lists for their part numbers.
 MF: μF, PF: μμF.

RESISTORS

- All resistors are in ohms. Common 1/4W, 1/8W and 1/16W carbon resistors are omitted. Refer to the following lists for their part numbers.
- F : nonflammable

COILS

- MMH : mH, UH : μH

The components identified by shading and mark △ are critical for safety. Replace only with part number specified.

Les composants identifiés par une trame et une marque △ sont critiques pour la sécurité. Ne les remplacer que par une pièce portant le numéro spécifié.

ELECTRICAL PARTS

Ref.No.	Part No.	Description
D307	8-719-815-55	DIODE 1S1555
D308	8-719-815-55	DIODE 1S1555
D309	8-719-815-55	DIODE 1S1555
D310	8-719-815-55	DIODE 1S1555
D311	8-719-815-55	DIODE 1S1555
D312	8-719-815-55	DIODE 1S1555
D313	8-719-815-55	DIODE 1S1555
D314	8-719-815-55	DIODE 1S1555
D316	8-719-909-18	DIODE GL-9PR9
D401	8-719-912-27	DIODE KV1226
D403	8-719-815-55	DIODE 1S1555
D404	8-719-912-00	DIODE MV-12N
D406	8-719-815-55	DIODE 1S1555
D501	8-719-815-55	DIODE 1S1555
D701	8-719-815-55	DIODE 1S1555
D702	8-719-200-02	DIODE 10E-2
D801	8-719-931-28	DIODE EQB01-28
D802	8-719-100-43	DIODE RD7.5EB1
D803	8-719-931-16	DIODE EQB01-16
D804	8-719-931-16	DIODE EQB01-16
D805	8-719-931-21	DIODE EQB01-21
D806	8-719-200-02	DIODE 10E-2
D807	8-719-200-02	DIODE 10E-2
D808	8-719-504-40	DIODE S4VB40
D901	8-719-909-19	DIODE GL-9NG9
D902	8-719-909-19	DIODE GL-9NG9
FE201	A-4344-027-A	FRONT END
IC201	8-759-812-35	IC LA1235
IC202	8-759-833-90	IC LA3390
IC301	8-759-200-66	IC TCP4621BP-6502
IC302	8-759-617-78	IC CX-778A
IC401	8-759-812-45	IC LA1245
IC501	8-759-700-05	IC NJM2043S-D
IC502	8-759-307-70	IC CX-770A
IC601	8-759-700-05	IC NJM2043S-D
IC701	8-749-930-41	IC STK-3041
IC702	8-759-822-30	IC STK-2230ST
FIP301	1-519-256-00	INDICATOR TUBE, FLUORESCENT
J501	1-507-788-00	JACK, PIN 4P
J502	1-507-788-00	JACK, PIN 4P
J503	1-507-788-00	JACK, PIN 4P
J504	1-507-788-00	JACK, PIN 4P
J505	1-507-788-00	JACK, PIN 4P
J506	1-507-788-00	JACK, PIN 4P

NOTE:

- Items with no part number and no description are not stocked because they are seldom required for routine service.
- Items marked "▲" are not stocked since they are seldom required for routine service. Some delay should be anticipated when ordering these items.
- Due to standardization, parts with part numbers (Δ-ΔΔΔ-ΔΔΔ-XX or Δ-ΔΔΔΔ-ΔΔΔ-X) may be different from those used in the set.

SEMICONDUCTORS

In each case, U : μ, for example:
 UA... : μA..., UPA... : μPA..., UPC... : μPC,
 UPD... : μPD...

CAPACITORS:

- All capacitors are in μF. Common capacitors are omitted. Refer to the following lists for their part numbers.
 MF: μF, PF: μμF.

RESISTORS

- All resistors are in ohms. Common 1/4W, 1/8W and 1/16W carbon resistors are omitted. Refer to the following lists for their part numbers.
- F : nonflammable

COILS

- MMH : mH, UH : μH

ELECTRICAL PARTS

Ref.No.	Part No.	Description
J551	1-507-788-00	JACK, PIN 4P
J552	1-507-788-00	JACK, PIN 4P
J553	1-507-788-00	JACK, PIN 4P
J554	1-507-788-00	JACK, PIN 4P
J555	1-507-788-00	JACK, PIN 4P
J556	1-507-788-00	JACK, PIN 4P
L301	1-408-183-00	MICRO INDUCTOR 10UH
L302	1-408-183-00	MICRO INDUCTOR 10UH
L401	1-408-202-00	MICRO INDUCTOR 390UH
L402	1-408-195-00	MICRO INDUCTOR 100UH
L701	1-420-872-00	COIL, AIRE CORE
L751	1-420-872-00	COIL, AIRE CORE
L801	1-408-183-00	MICRO INDUCTOR 10UH
L901	1-401-887-41	ANTENNA, FERRITE-ROD (MW)
LPF202	1-235-062-00	FILTER, LOW PASS
PT901	1-447-300-00	TRANSFORMER, POWER
Q201	8-729-671-14	TRANSISTOR 2SC710-14
Q202	8-729-671-14	TRANSISTOR 2SC710-14
Q205	8-729-245-83	TRANSISTOR 2SC2458GR
Q206	8-729-245-83	TRANSISTOR 2SC2458GR
Q207	8-729-245-83	TRANSISTOR 2SC2458GR
Q301	8-729-245-83	TRANSISTOR 2SC2458GR
Q302	8-729-204-82	TRANSISTOR 2SA1048
Q303	8-729-204-82	TRANSISTOR 2SA1048
Q304	8-729-204-82	TRANSISTOR 2SA1048
Q305	8-729-245-83	TRANSISTOR 2SC2458GR
Q306	8-729-203-05	TRANSISTOR 2SK30A-GR3
Q307	8-729-665-47	TRANSISTOR 2SC1362
Q406	8-729-204-82	TRANSISTOR 2SA1048
Q407	8-729-245-83	TRANSISTOR 2SC2458GR
Q501	8-729-245-83	TRANSISTOR 2SC2458GR
Q502	8-729-204-82	TRANSISTOR 2SA1048
Q503	8-729-245-83	TRANSISTOR 2SC2458GR
Q504	8-729-204-82	TRANSISTOR 2SA1048
Q505	8-729-245-83	TRANSISTOR 2SC2458GR
Q506	8-729-204-82	TRANSISTOR 2SA1048
Q701	8-729-204-82	TRANSISTOR 2SA1048
Q702	8-729-245-83	TRANSISTOR 2SC2458GR
Q703	8-729-245-83	TRANSISTOR 2SC2458GR
Q704	8-729-245-83	TRANSISTOR 2SC2458GR
Q705	8-729-245-83	TRANSISTOR 2SC2458GR
Q706	8-729-245-83	TRANSISTOR 2SC2458GR
Q707	8-729-245-83	TRANSISTOR 2SC2458GR

The components identified by shading and mark ▲ are critical for safety. Replace only with part number specified.

Les composants identifiés par une trame et une marque ▲ sont critiques pour la sécurité. Ne les remplacer que par une pièce portant le numéro spécifié.