

1650HA

HI-FI AUDIO OUTPUT MULTIPLE SECONDARY TRANSFORMER

- NEW & improved version of our 1608-1650 Series multiple secondary output transformers (Re-designed secondaries for easy hook-up of secondary loads).
- Designed for push-pull tube output circuits.
- Units are designed to provide ample "headroom" at bass frequencies (Note the weight of each transformer).
- All models have a secondary tapped for 4, 8 or 16 ohm outputs.
- Enclosed (shielded), 4 slot, above chassis Type "X" mounting.
- Manufactured with plastic coil forms for coil support and insulation.
- Frequency response 30Hz. to 30Khz. at full rated power (+/- 1db max. - ref. 1Khz) minimum.
- Insulated flexible leads 8" min.
- Included 40% screen taps for Ultra-Linear operation (if desired).
- Typical applications - Push-Pull: triode, Ultra-Linear pentode, pentode and tetrode connected audio output.

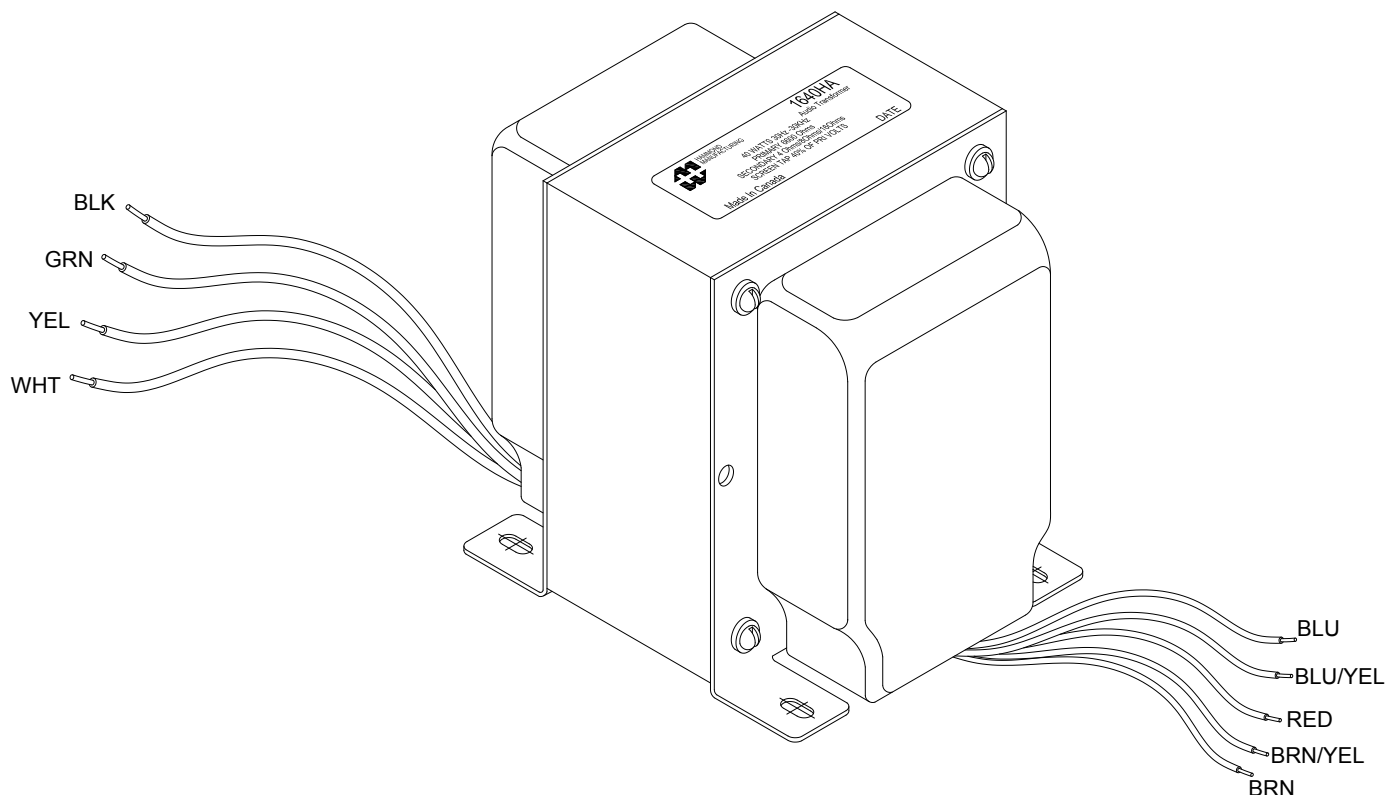

*For Full Dimensional Details see page 4

1650HA ELECTRICAL SPECIFICATIONS****Schematic and Hook Up Data**

<u>Characteristic</u>	<u>Typical</u>
Input Impedance	6600 Ω
Output Impedance	4 Ω /8 Ω /16 Ω
Output Power	40Watts
Primary - DCR	
Blue – Brown	146.5 Ω
Secondary DCR	
Black – Green	225m Ω
Black – Yellow	259m Ω
Black – White	319m Ω
Leakage Inductance	@ 1.0kHz, 1.0V SC
Primary – Blue – Brown	297.7mH
Inductance	@ 1.0kHz, 1.0V OC
Primary – Blue – Brown	11.3Hy
Black – Green	158.6mH
Black – Yellow	214.5mH
Black – White	283.6mH
Impedance	@ 1.0kHz, 1.0V OC
Primary – Blue – Brown	70K Ω
Black – Green	217.6 Ω
Black – Yellow	403.9 Ω
Black – White	710.2 Ω
Frequency Response	See graphs for specific response, Typ. ± 1.0 db from 30Hz to 30KHz
Dielectric Strength	2000Vrms
Temperature Range	-40 To 105°C

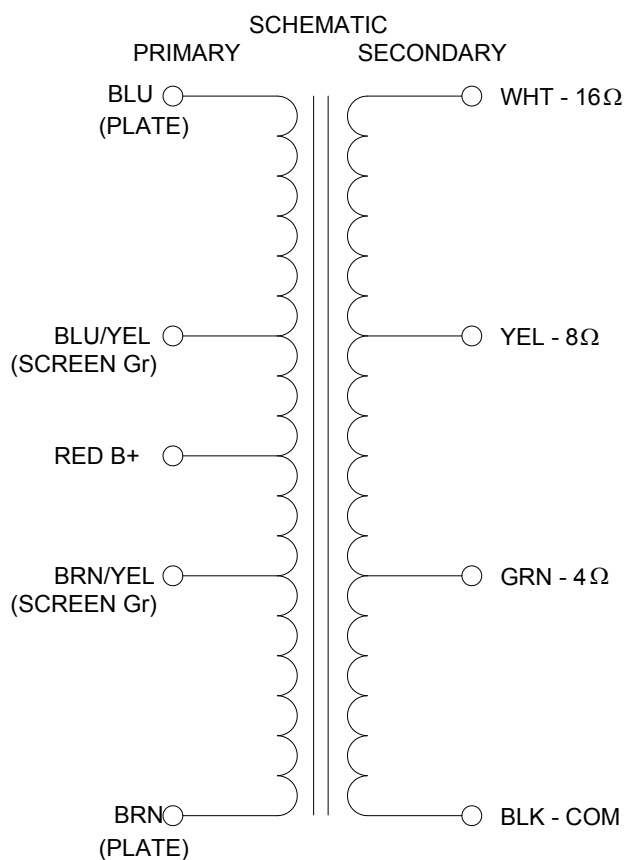

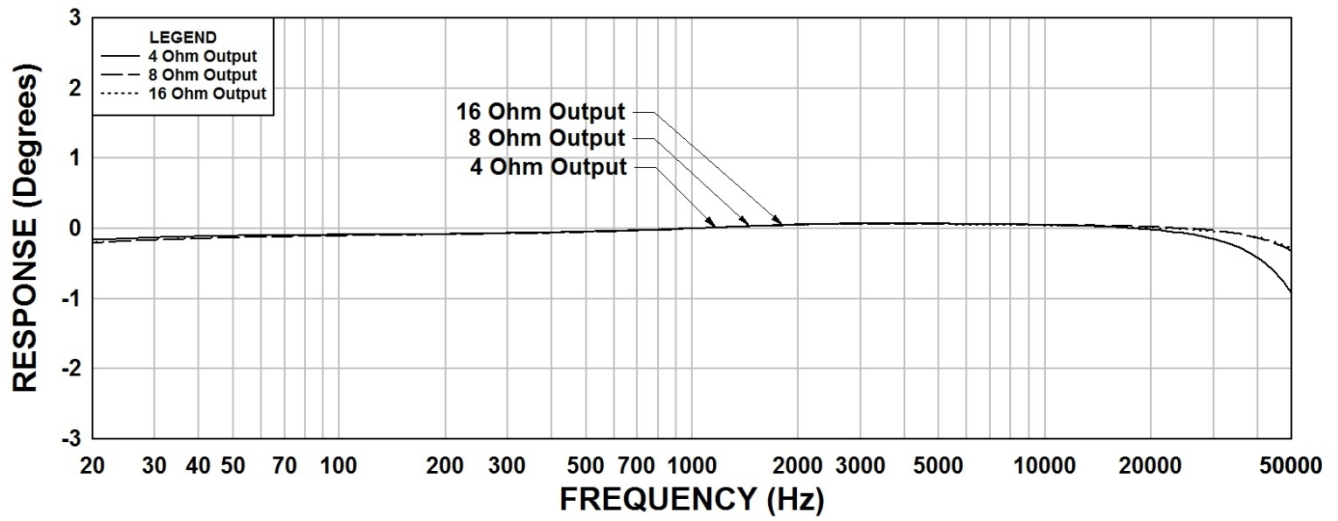
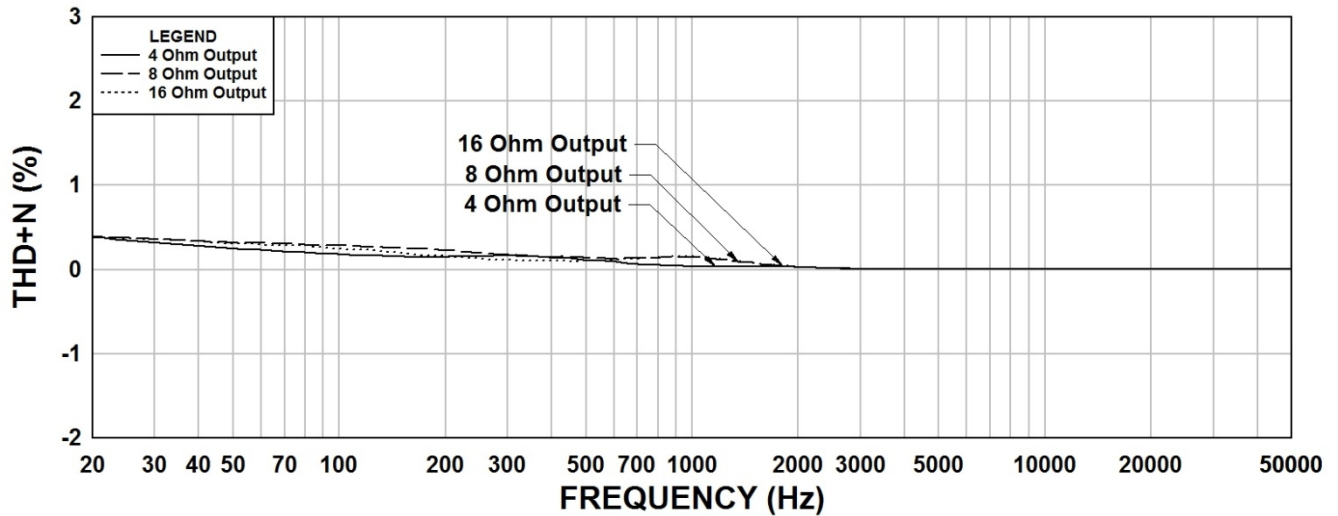
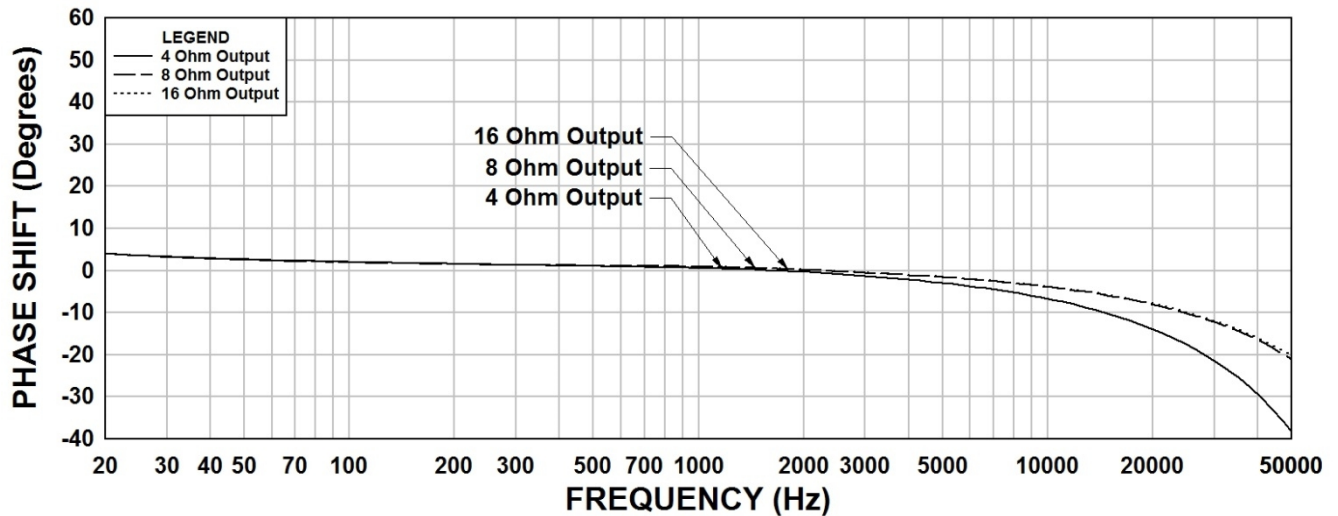
1650HA Frequency Response $R_s = 6.6K$ Ohms**1650HA THD+N $R_s = 6.6K$ Ohms****1650HA Phase Shift $R_s = 6.6K$ Ohms**

Dimensional Details:

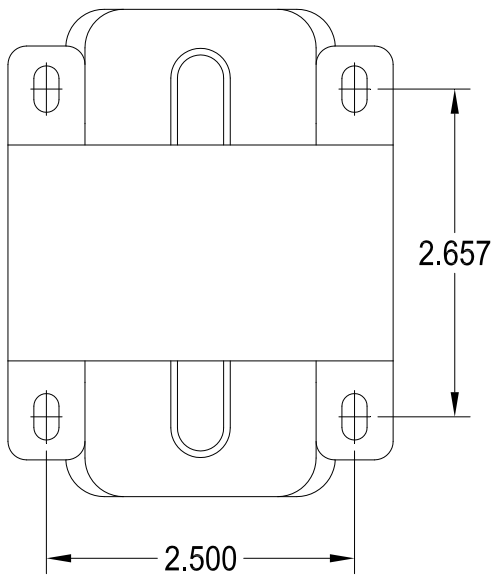
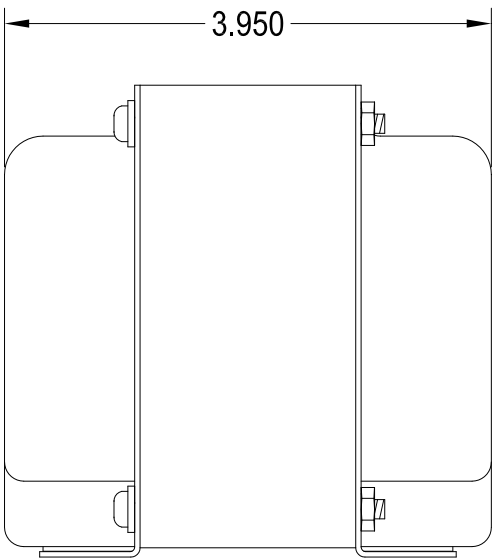
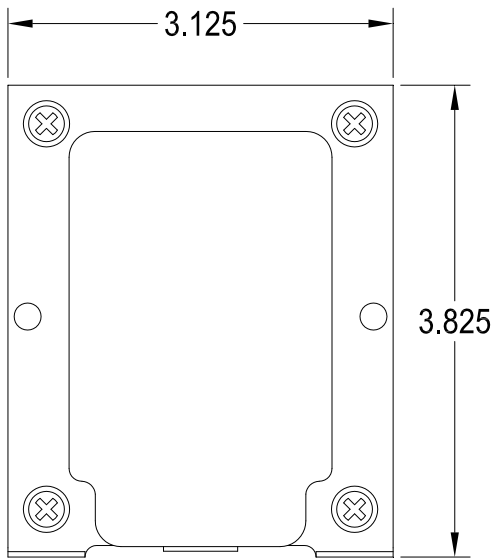

Label:



HAMMOND
MANUFACTURING.

1650HA

40WATTS 30Hz - 30KHz

BLK - GRN - YEL - WHT
COM - 4OHM - 8OHM - 16OHM
BLU - RED - BRN: 6600 OHMS CT
BRN/YEL & BLU/YEL
SCREEN TAPS 40% OF PRI VOLTS

Made In CanadaDATE

TYPICAL TEST CIRCUIT

Measurement instruments
Hp4192a impedance analyzer
Hp3456a DVM
Keithley 2002 DVM
D scope series iii audio analyzer
Wayne Kerr 3255B with a 3265B

* All graphs input level 20dbu.
** The results are typical and are subject to normal manufacturing and electrical tolerances.

This drawing and the information in it is the property of Hammond Manufacturing. It may not be reproduced, transmitted or used in any manner whatsoever without the written permission of Hammond Manufacturing. Data subject to change without notice.

