

(Using the midpoints for the lines going to the corners introduces a deviation from the path length arrived at using scho54's method.)

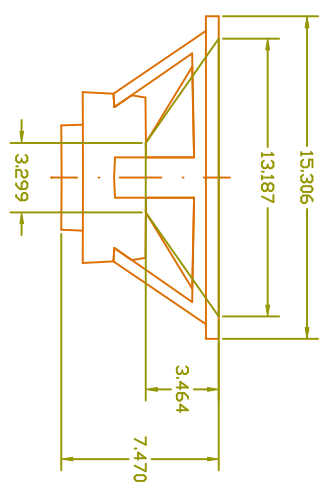

Volume of cone=207in³

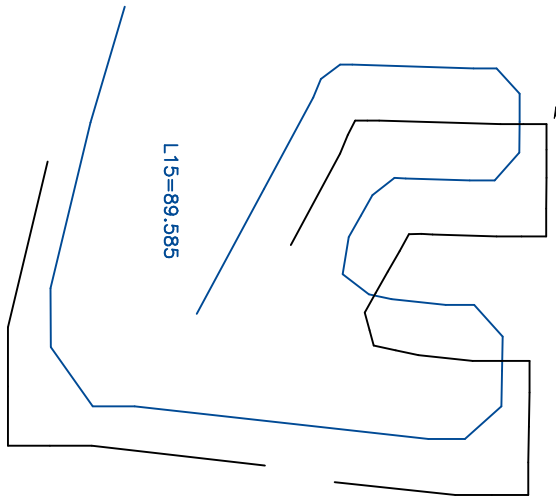
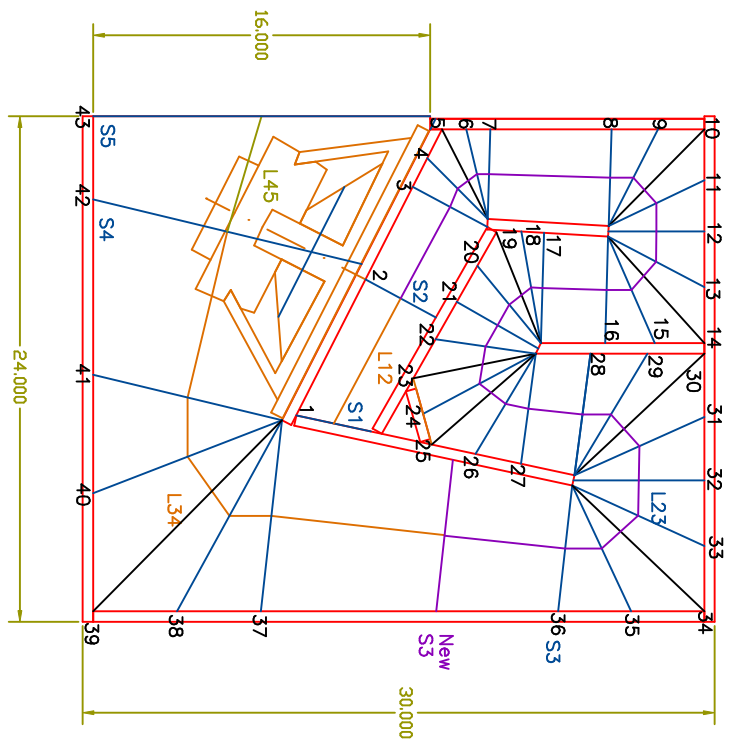

- Length@S1=3.624
- Length@S2=3.791
- Length@S3=7.235
- Length@S4=13.104
- Length@S5=16.0(16.26)
- L12=6.726
- L23=52.5393
- L34=24.5935
- L45=5.726
- L23=56.5164
- L34=25.9482