

Notes:

0/ drawn using 3/4" (19mm) material

1/ the mouth deflectors can be built using stepped strips or a single piece deflector (as shown).

2/ mandatory main box bracing is not shown

3/ damp as you would a bass reflex cabinet

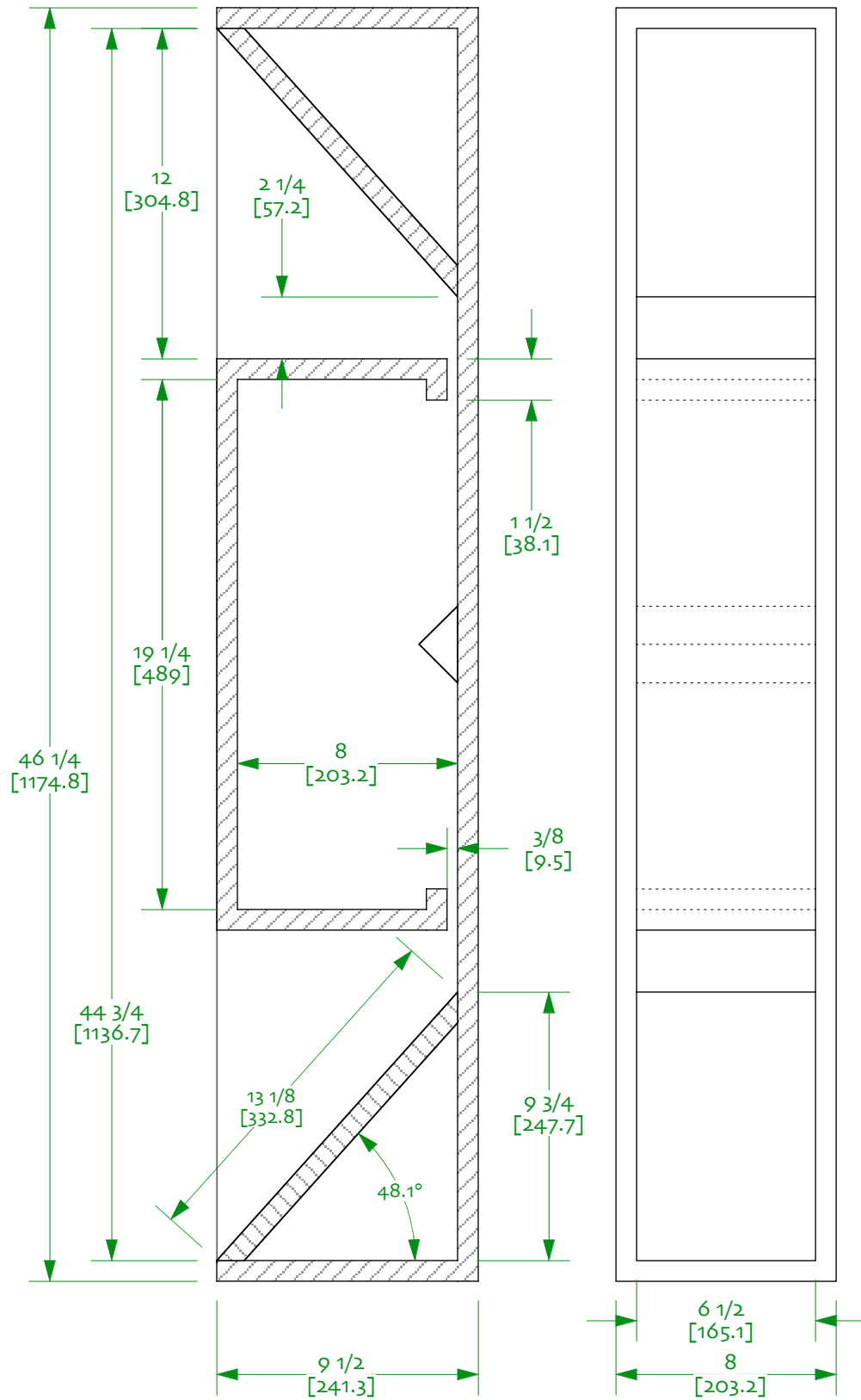

X Chang – Fostex FE138eSR MooseBVR
Double Mouth Horn ov91
Sheet 0 -- panel placement
designed by Scott Lindgren
drawn by did
20-april-2008 / updated 27-december-2008