

Top View:
Note: VSAC Baffles used curved instead of straight tapers.
Curves look a little nicer, and are a lot more work.

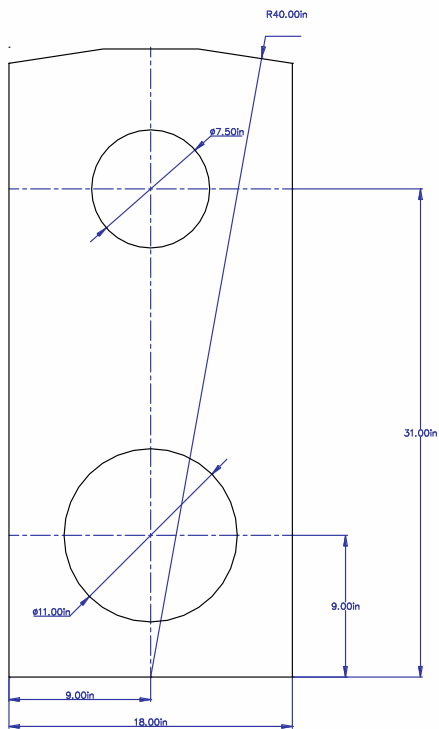

Front View

For clarity, only the through holes are shown

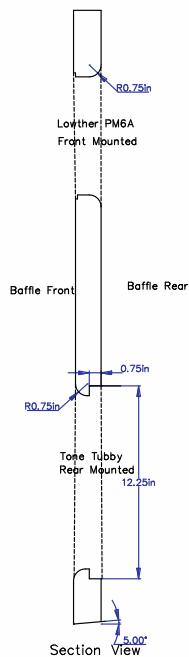

Section View
Looking at baffle as if you cut it in half

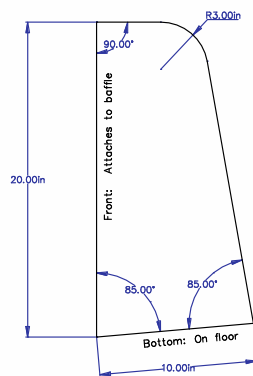

Support Wings

1-1/4" Thick Material

Rear and top have 3/4" roundover on both inside and outside surfaces