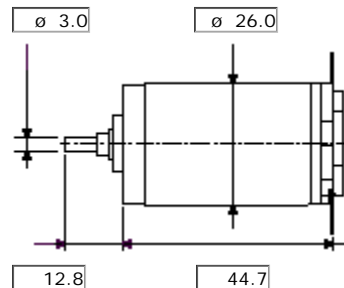

**A-max 26****Ø 26 mm, Precious Metal Brushes CLL, 7 Watt****High Power**

Dimensions in mm.  
This schematic is not drawn to scale.

**Order no.****110191****Motor data**

Power rating	W	7.0
Nominal voltage	Volt	48.0
No load speed	min <sup>-1</sup>	6050
Stall torque	mNm	51.4
Speed/torque gradient	min <sup>-1</sup> mNm <sup>-1</sup>	119
No load current	mA	6
Starting current	mA	683
Terminal resistance	Ohm	70.2
Max. permissible speed	min <sup>-1</sup>	11000
Max. continuous current	mA	204
Max. continuous torque	mNm	15.0
Max. power output at nominal voltage	mW	8110
Max. efficiency	%	83.0
Torque constant	mNm A <sup>-1</sup>	75.2
Speed constant	min <sup>-1</sup> V <sup>-1</sup>	127
Mechanical time constant	ms	15
Rotor inertia	gcm <sup>2</sup>	12.0
Terminal inductance	mH	6.68
Thermal resistance housing-ambient	KW <sup>-1</sup>	13
Thermal resistance rotor-housing	KW <sup>-1</sup>	3.2
Thermal time constant winding	s	11

W	7.0
Volt	48.0
min <sup>-1</sup>	6050
mNm	51.4
min <sup>-1</sup> mNm <sup>-1</sup>	119
mA	6
mA	683
Ohm	70.2
min <sup>-1</sup>	11000
mA	204
mNm	15.0
mW	8110
%	83.0
mNm A <sup>-1</sup>	75.2
min <sup>-1</sup> V <sup>-1</sup>	127
ms	15
gcm <sup>2</sup>	12.0
mH	6.68
KW <sup>-1</sup>	13
KW <sup>-1</sup>	3.2
s	11

**Specifications**

- Axial play 0.1- 0.2 mm
- Max. load of **sleeve bearings**
  - axial (dynamic) 1.7 N
  - radial ( 5 mm from flange ) 5.5 N
  - Press-fit force (static) 80 N
- Max. load of **ball bearings**
  - axial (dynamic) 5.0 N
  - radial ( 5 mm from flange ) 21 N
  - Press-fit force (static) 75 N
- Radial play **sleeve bearings** 0.012 mm
- Radial play **ball bearings** 0.025 mm
- Ambient temperature range -30/+ 65 °C

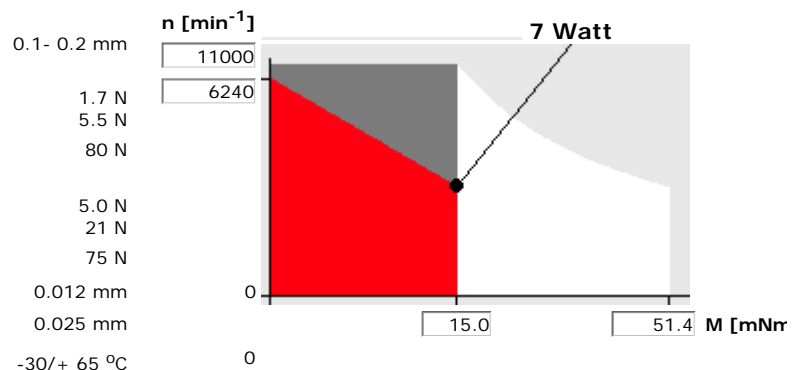
**Operating range**

- Max. rotor temperature + 85 °C
- Number of commutator segments 13
- Weight of motor 117 g
- Values listed in the table are nominal.
- CLL = Capacitor Long Life.

**Option**

Ball bearings in place of sleeve bearings  
Pigtails in place of terminals  
Without CLL

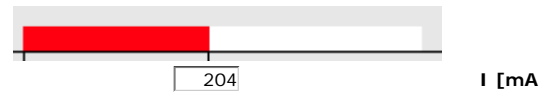

**Recommended operating range**

**Continuous operation**

**Short term operation**

**This graph is not drawn to scale.**



© Copyright by maxon motor ag. All rights reserved.