

BRASS

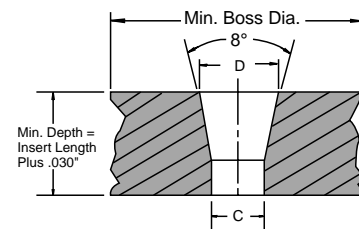
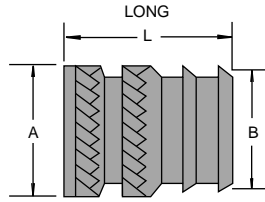
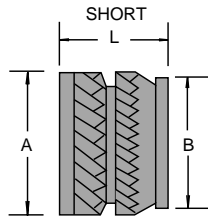

Ultrasert II Inch

- Diagonal knurls & under cuts provide superior assembly strength in plastics
- Excellent design for automated systems
- Installed ultrasonically or with heat
- Two lengths to choose from allowing design flexibility

INSERT SPECIFICATIONS					HOLE SIZE RECOMMENDATIONS			
SPAENAU No.	Internal Thread Size	Diameter (Inch)		Lgth. (Inch)	Diameter (Inch)		Min. Boss Dia. (Inch)	Unit Pkg Qty.
		A ±.005	B ±.005	L ±.004	C ±.001	D ±.001		
628-570	0-80	.141	.123	.115	.118	.123	.282	P.O.R.
628-571	0-80	.141	.112	.188	.107	.123	.282	P.O.R.
628-572	2-56	.141	.123	.115	.118	.123	.282	100
628-573	2-56	.141	.112	.188	.107	.123	.282	P.O.R.
628-574	4-40	.172	.157	.135	.153	.159	.344	100
628-575	4-40	.172	.146	.219	.141	.159	.344	100
628-576	6-32	.219	.203	.150	.199	.206	.438	100
628-577	6-32	.219	.190	.250	.185	.206	.438	100
628-578	8-32	.250	.230	.185	.226	.234	.500	100
628-579	8-32	.250	.213	.312	.208	.234	.500	100
628-580	10-24	.297	.272	.225	.267	.277	.594	100
628-581	10-24	.297	.251	.375	.246	.277	.594	100
628-582	10-32	.297	.272	.225	.267	.277	.594	100
628-583	10-32	.297	.251	.375	.246	.277	.594	100
628-584	1/4-20"	.375	.354	.300	.349	.363	.750	100
628-585	1/4-20"	.375	.332	.500	.321	.363	.750	100
628-586	1/4-28"	.375	.354	.300	.349	.363	.750	P.O.R.
628-587	1/4-28"	.375	.332	.500	.321	.363	.750	P.O.R.
628-588	5/16-18"	.469	.439	.335	.431	.448	.938	100
628-589	5/16-18"	.469	.406	.562	.401	.448	.938	100
628-590	5/16-24"	.469	.439	.335	.431	.448	.938	100
628-591	5/16-24"	.469	.406	.562	.401	.448	.938	P.O.R.
628-592	3/8-16"	.563	.532	.375	.523	.540	1.126	P.O.R.
628-593	3/8-16"	.563	.493	.625	.488	.540	1.126	P.O.R.
628-594	3/8-24"	.563	.532	.375	.523	.540	1.126	P.O.R.
628-595	3/8-24"	.563	.493	.625	.488	.540	1.126	P.O.R.

Ultrasert II Metric

NOTE:
Bold Type SPAENAU No's.
 in stock.
 Light Type SPAENAU No's.
 available - P.O.R.

SPAENAU No.	Internal Thread Size (mm)	Diameter (mm)		Lgth. (mm)	Diameter (mm)		Min. Boss Dia. (mm)	Unit Pkg Qty.
		A ± 0.13	B ± 0.13	L ± 0.10	C ± 0.03	D ± .03		
628-610	M2.2 x 0.45	3.58	3.12	2.9	3.00	3.12	7.16	100
628-611	M2.2 x 0.45	3.58	2.84	4.8	2.72	3.12	7.16	P.O.R.
628-612	M2.5 x 0.45	4.37	3.99	3.4	3.89	4.04	8.74	P.O.R.
628-613	M2.5 x 0.45	4.37	3.71	5.6	3.58	4.04	8.74	P.O.R.
628-614	M3 x 0.5	5.56	5.16	3.8	5.05	5.23	11.13	P.O.R.
628-615	M3 x 0.5	5.56	4.38	6.4	4.70	5.23	11.23	P.O.R.
628-616	M3.5 x 0.6	5.56	5.16	3.8	5.05	5.23	11.23	P.O.R.
628-617	M3.5 x 0.6	5.56	4.83	6.4	4.70	5.23	11.23	P.O.R.
628-618	M4 x 0.7	6.35	5.84	4.7	5.74	5.94	12.70	100
628-619	M4 x 0.7	6.35	5.41	7.9	5.28	5.94	12.70	100
628-620	M5 x 0.8	8.33	7.82	6.7	7.70	8.00	16.66	100
628-621	M5 x 0.8	8.33	7.19	11.1	7.06	8.00	16.66	100
628-622	M6 x 1	9.53	8.99	7.6	8.86	9.22	19.06	100
628-623	M6 x 1	9.53	8.43	12.7	8.15	9.22	19.06	100
628-624	M8 x 1.25	11.91	11.15	8.5	10.95	11.38	23.83	P.O.R.
628-625	M8 x 1.25	11.91	10.31	14.3	10.19	11.38	23.83	P.O.R.