

WIRING LAYOUT

Parts marked with *vary according to destinations. For details, refer to the part list.

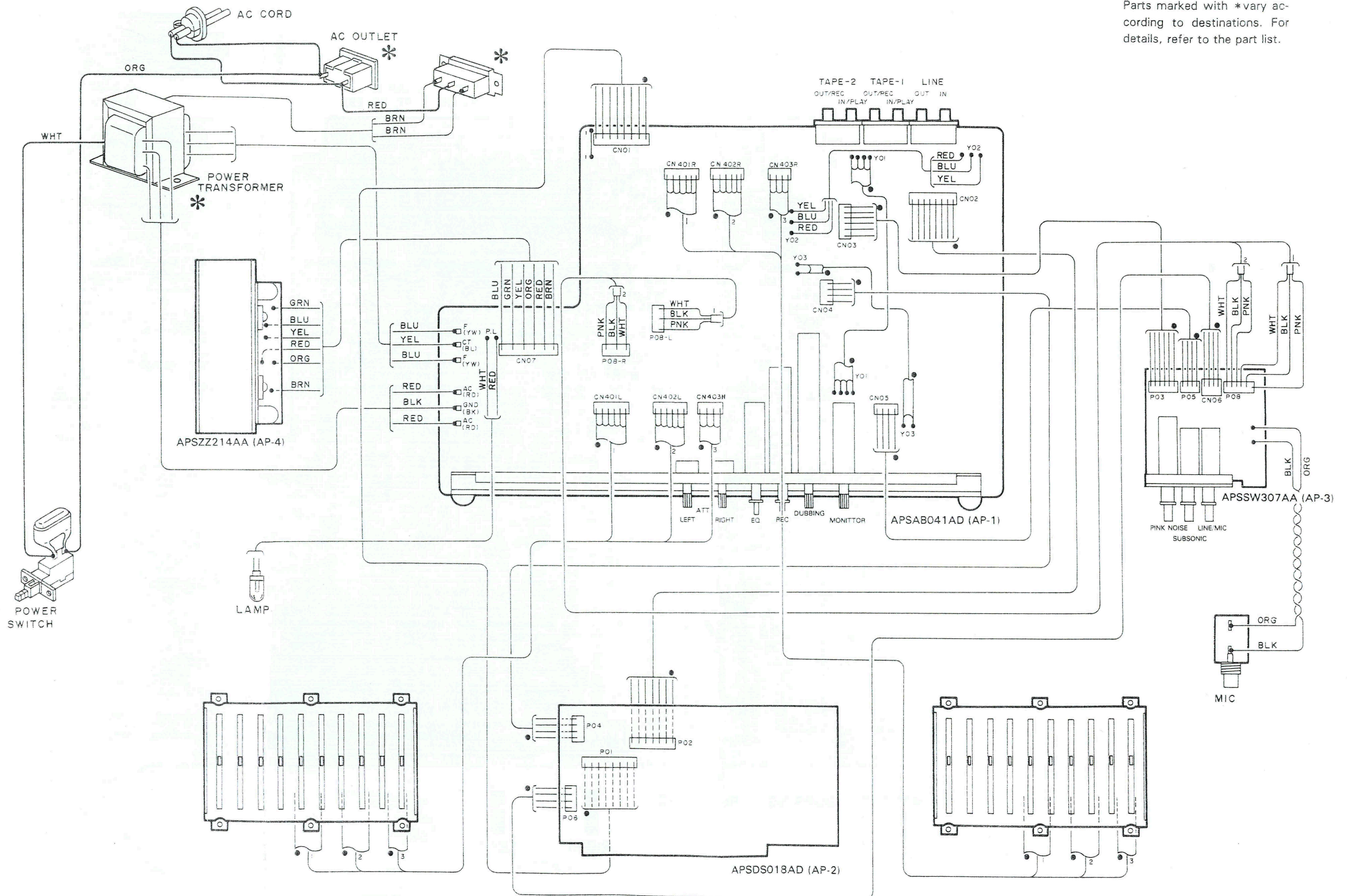

SCHEMATIC DIAGRAM

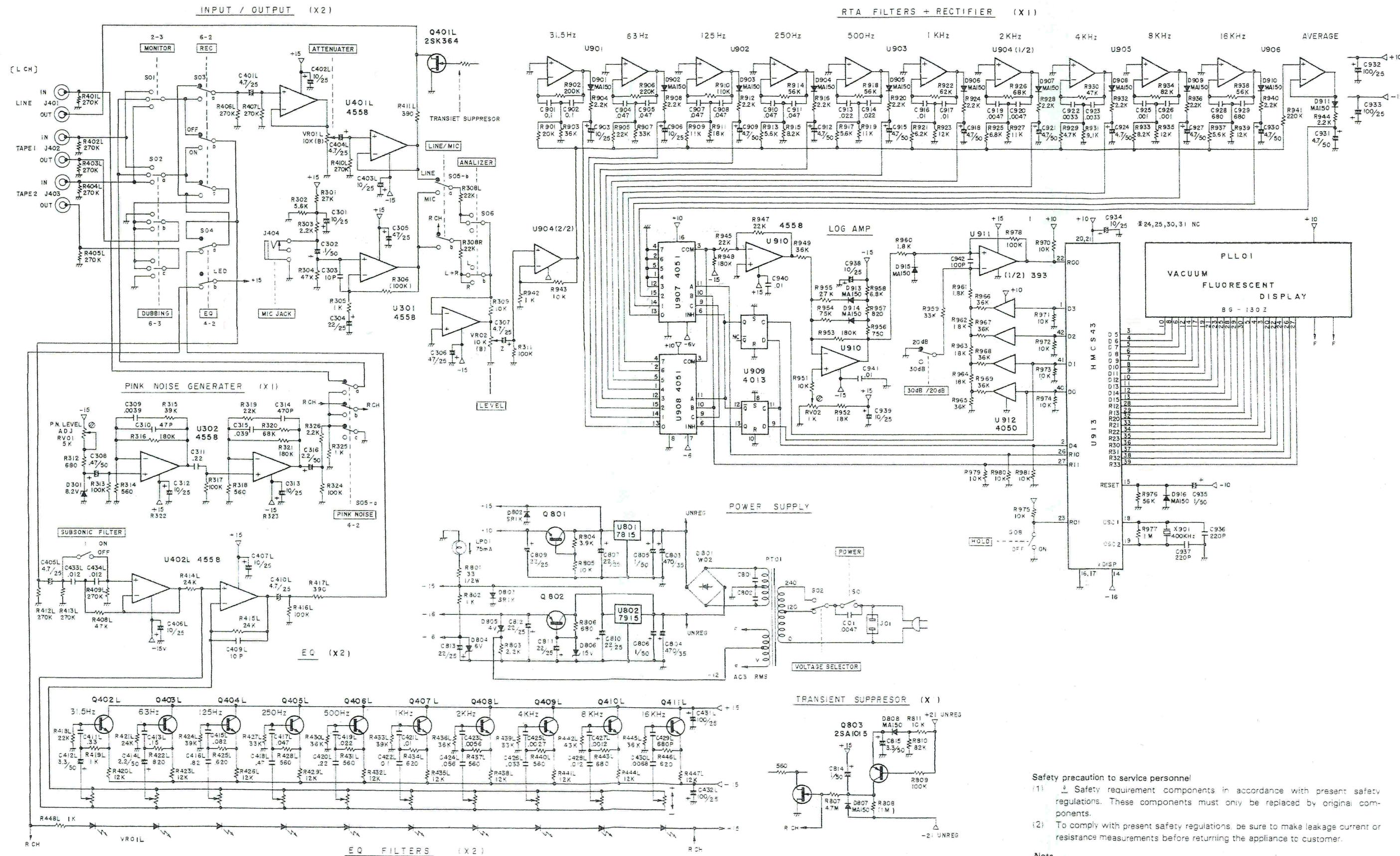

Safety precaution to service personnel

(1) Safety requirement components in accordance with present safety regulations. These components must only be replaced by original components.

(2) To comply with present safety regulations, be sure to make leakage current or resistance measurements before returning the appliance to customer.

Note

All resistors are 1/4 watt unless otherwise noted.

Resistor values are in ohm (1K = 1000 ohm).

All capacitor values are in micro-farad (p = pico-farad)

EXPLODED VIEW

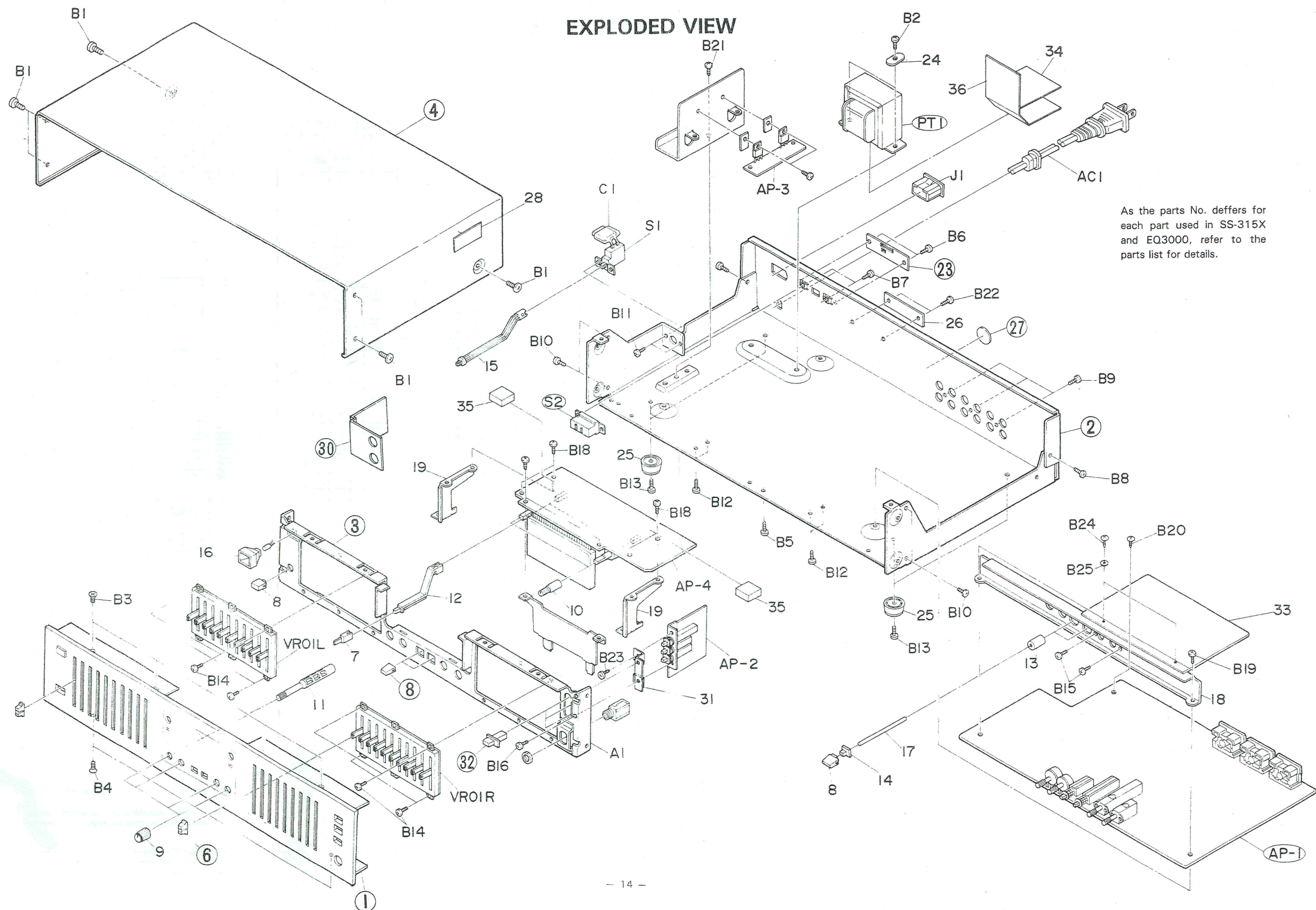

As the parts No. deffers for each part used in SS-315X and EQ3000, refer to the parts list for details.