

JFET Tests Based on Kirchhoff's Junction & Loop Rule

✓Xy Mar. 2007

» Test A «

» Test B «

Assumed as a current source
because J310 has much higher
self-bias current than 2SJ108GR

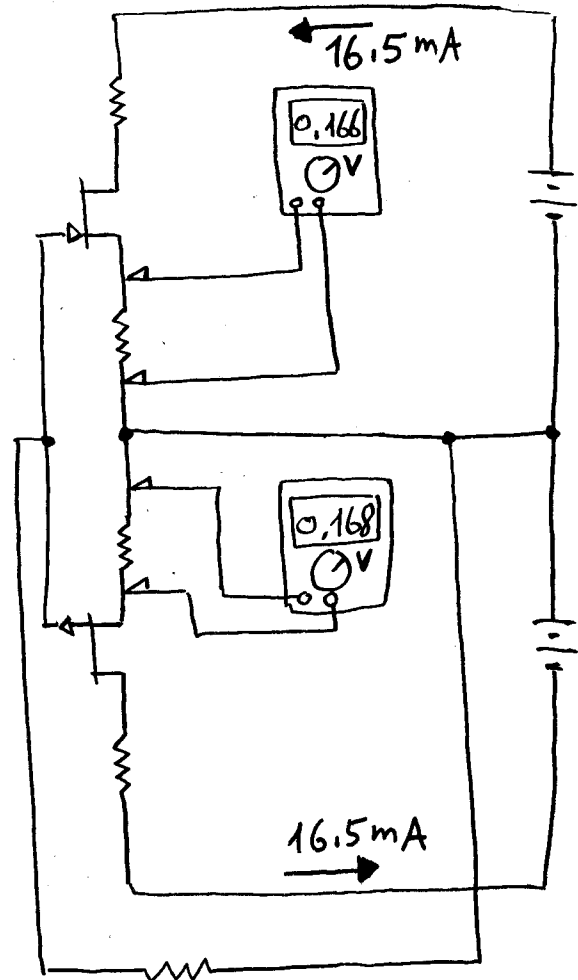
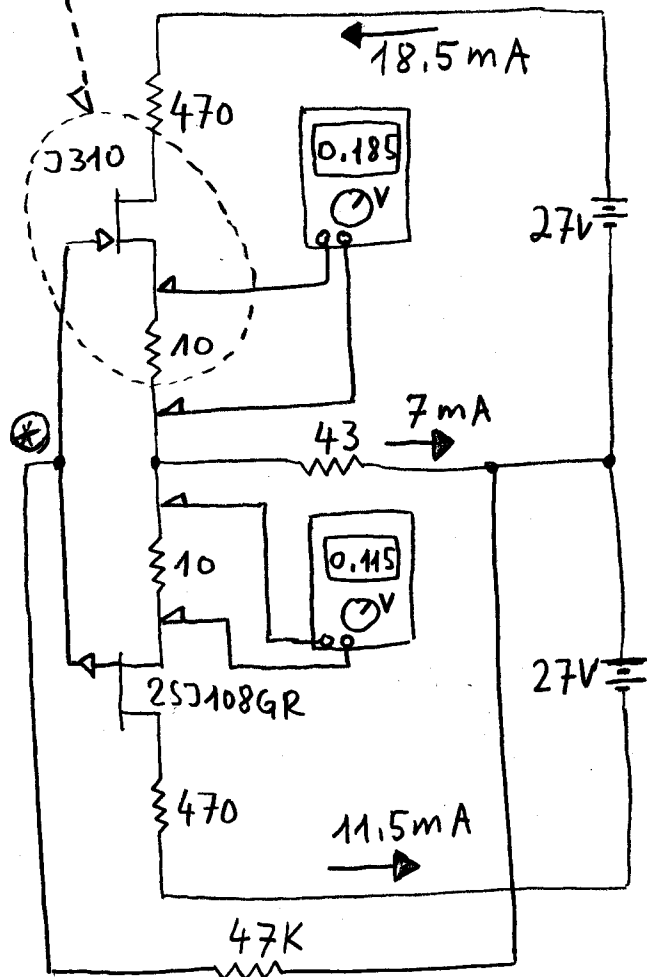

J310 (N-ch, I_{dss} 12~30mA)

2SJ108GR (P-ch, I_{dss} -2.6mA ~ -6.5mA)

Observation.

JFET (2SJ108GR) acts as a simple resistor
in these test circuits, and at the same
time as a current amplifier being
controlled by input ac signal given at the
point marked "X".