

Volume of cone=207in³

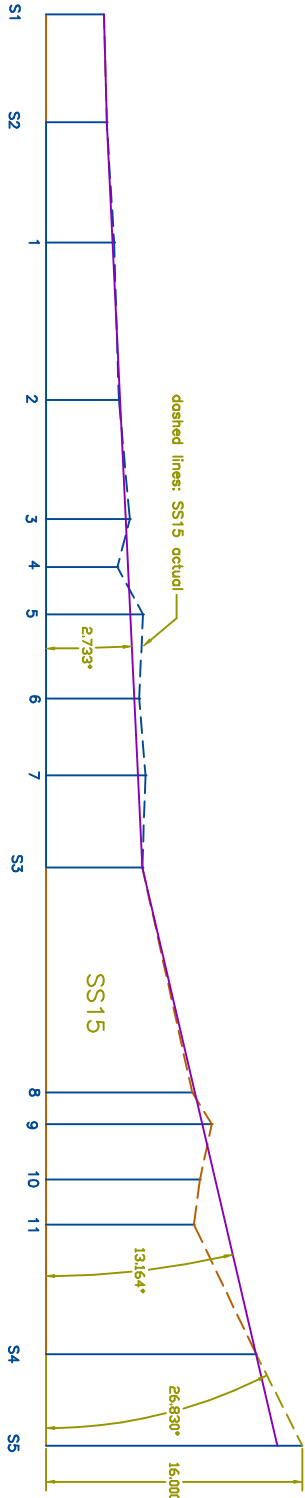

mod_4

SS15

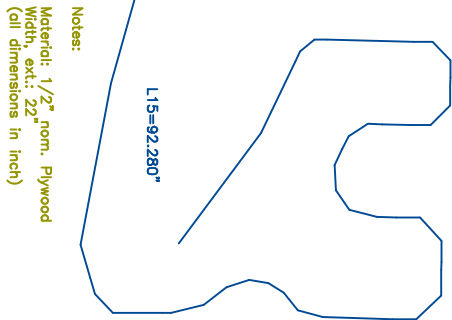

Notes:
Material: 1/2" nom. Plywood
Width, etc.: 32"nom.
(all dimensions in inch)

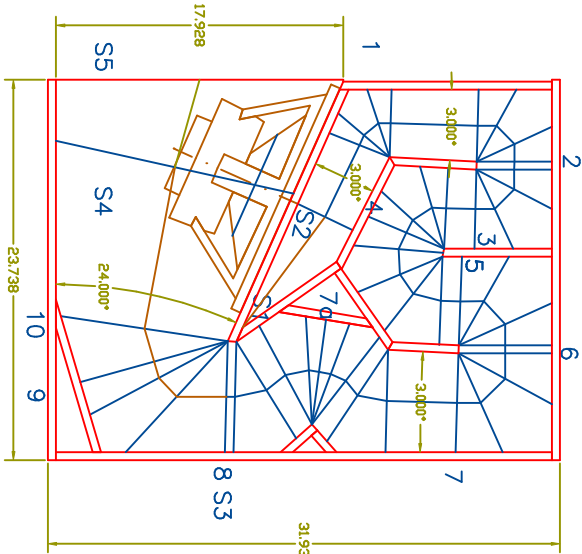

LengthS1=0.1
LengthS2=3.788
LengthS3=6.925
LengthS4=15.177
LengthS5=17.928

L12=8.586
L23=59.851
L34=18.157
L45=5.686

jbelis_singlesheet_new_2011_Feb23_mod_4.dwg

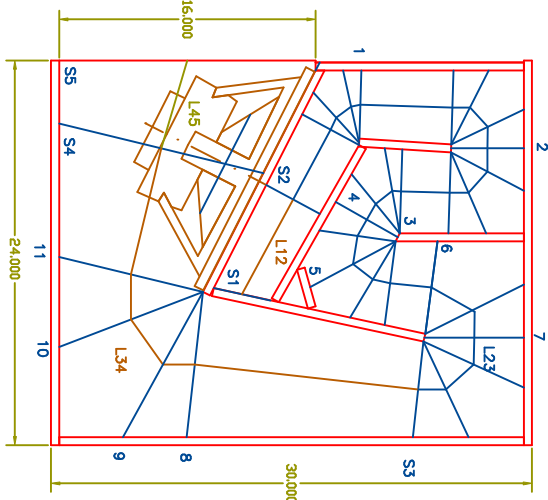
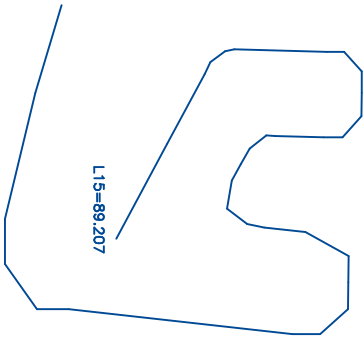

LengthS1=3.624
LengthS2=3.791
LengthS3=6.010
LengthS4=13.111
LengthS5=16.0(16.26)

L12=6.726
L23=46.406
L34=30.385
L45=5.711

Drawing revised using soh54's corner method.
From: jbelis_singlesheet_new_2010_Aug18.dwg

